

- NOTE:
- 1 MATERIAL:
HOUSING: 30% GLASS FILLED PBT, THERMOPLASTIC, BLACK.
CONTACT: PHOS BRONZE
 - 2 FINISH: CONTACT PLATING: TIN-LEAD (60μ INCHES MIN.)
SOLDERABILITY :95% COVERAGE MIN.;
TEST TEMPERATURE=230°C±5°C
TEST TIME = 5±5 SECONDS.
 3. MECHANICAL SPECS:
DURABILITY: 50 CYCLES MIN.
INSERTION FORCE:300 GRAMS MAX.
WITHDRAWAL FORCE: 20 GRAMS MIN.
CONTACT RETENTION: 500 GRAMS MIN.
ACCEPTS: 0.20-0.30 [.008-.012] LEADS
 4. ELECTRICAL SPECS:
VOLTAGE RATING: 250V AC,DC
CONTACT RESISTANCE: 20 MILLOHMS MAX.
CURRENT RATING: 1 AMPERE AC,DC
INSULATION RESISTANCE: 1000 MEGOHMS MIN.
DIELECTRIC WITHSTANDING VOLTAGE: AC 1000 V MIN.
 5. OPERATING TEMPERATURE: -40°C TO +105°C
 - 6 AMP LOGO
 - 7 FINISH: CONTACT PLATING TIN (LEAD FREE); 60 UIN MIN. OVER 30 UIN Ni
SOLDERABILITY :95% COVERAGE MIN.;
TEST TEMPERATURE=260±5°C;
TEST TIME = 5±5 SECONDS.

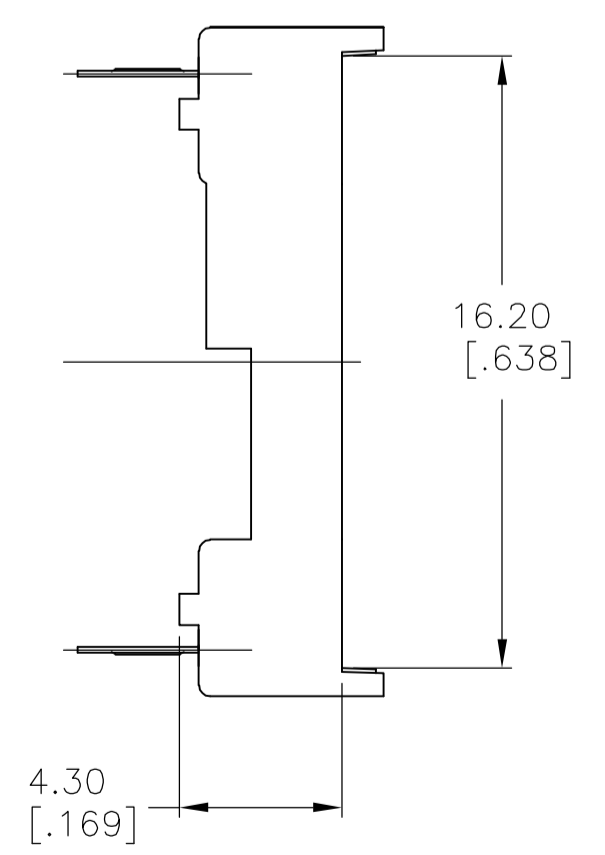
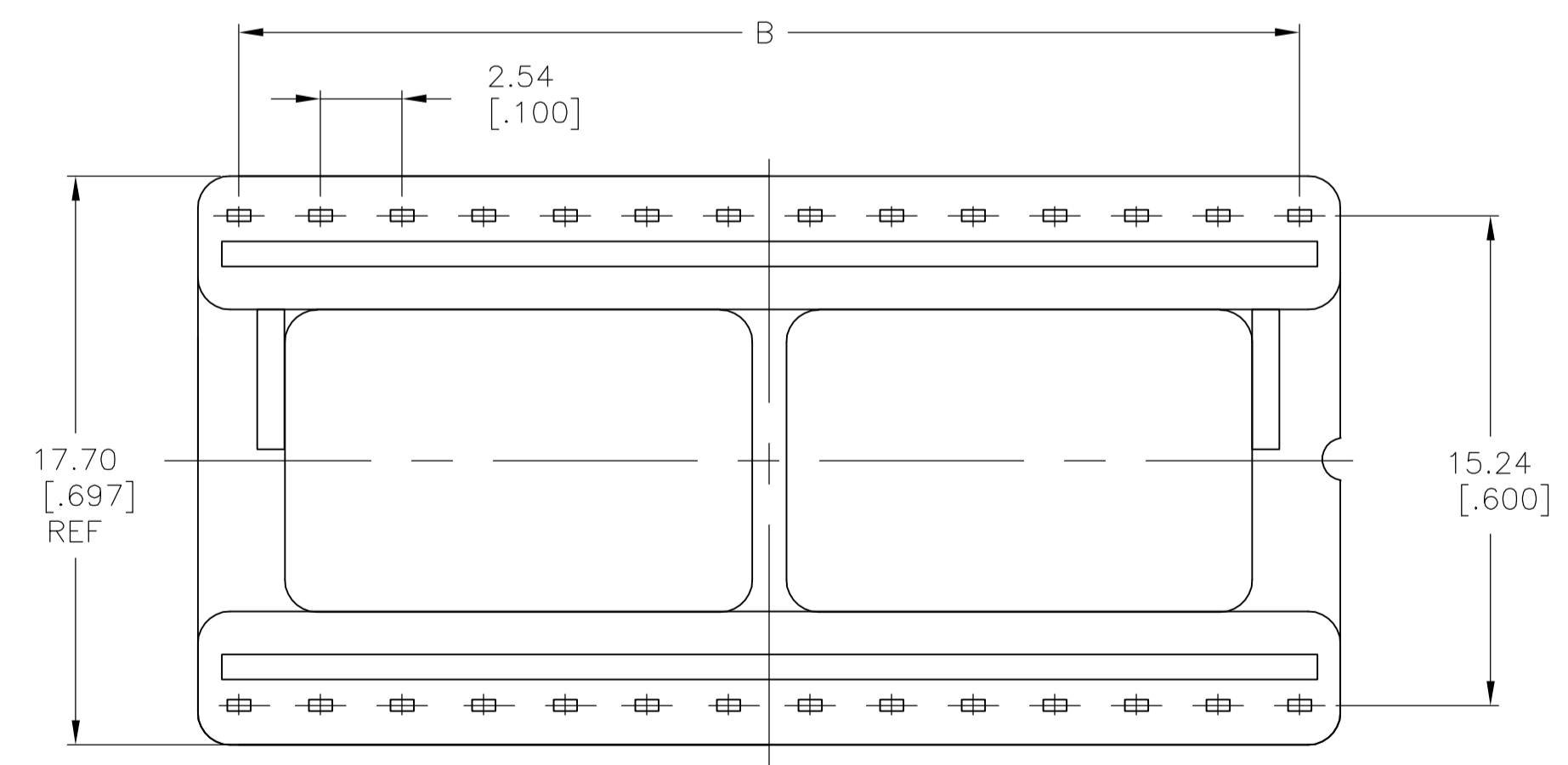
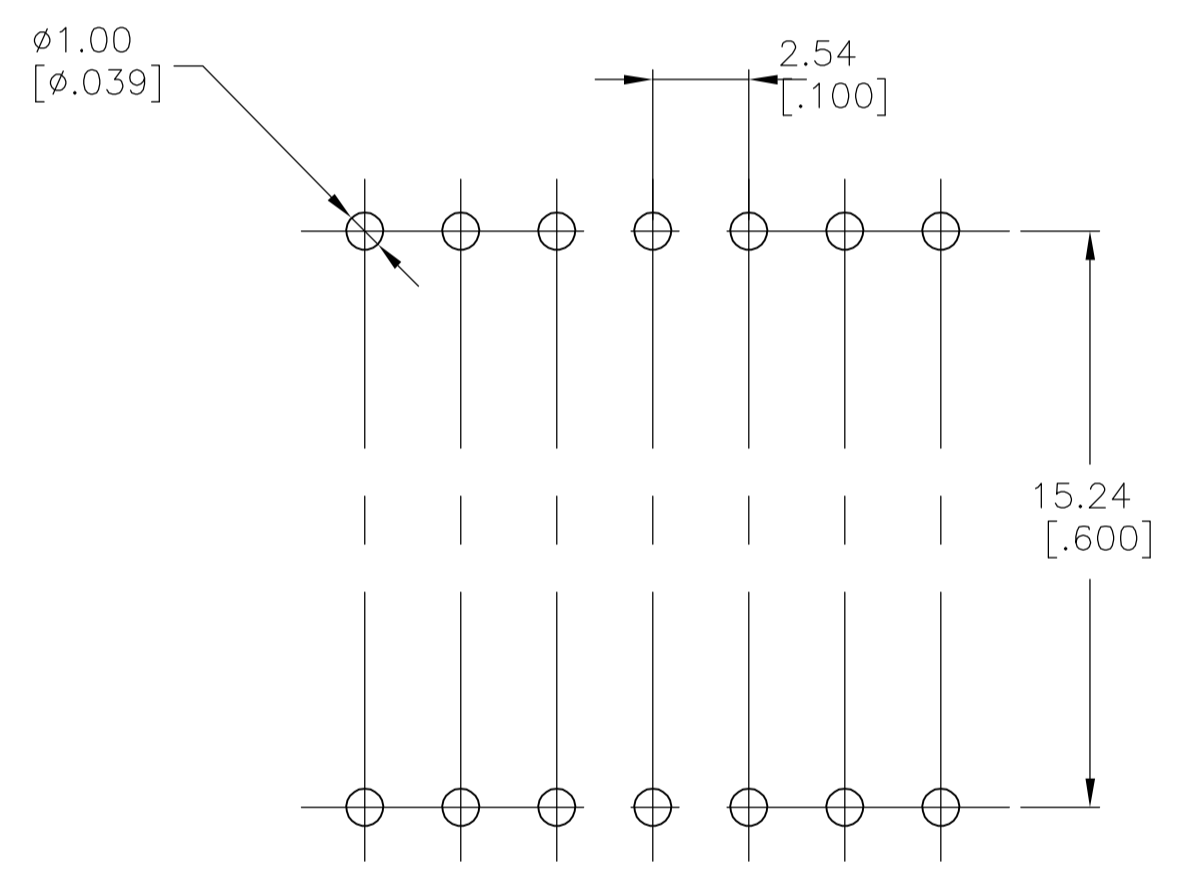
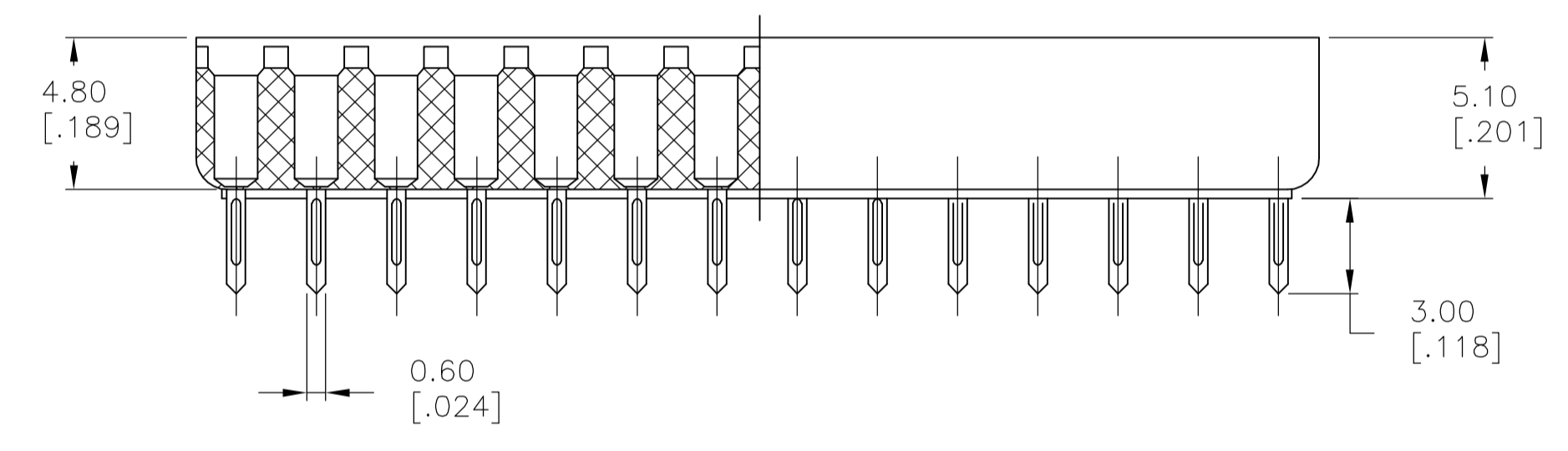

△	48	60.96 [2.400]	58.42 [2.300]	55.52 [2.19]	1-390262-7
△	42	53.34 [2.100]	50.8 [2.000]	47.90 [1.89]	1-390262-6
△	40	50.80 [2.000]	48.26 [1.900]	45.36 [1.79]	1-390262-5
△	32	40.64 [1.600]	38.10 [1.500]	35.20 [1.39]	1-390262-3
△	28	35.56 [1.400]	33.02 [1.300]	30.12 [1.19]	1-390262-2
△	24	30.48 [1.200]	27.94 [1.100]	25.10 [.988]	1-390262-1
△	48	60.96 [2.400]	58.42 [2.300]	55.52 [2.19]	390262-7
△	42	53.34 [2.100]	50.8 [2.000]	47.90 [1.89]	390262-6
△	40	50.80 [2.000]	48.26 [1.900]	45.36 [1.79]	390262-5
△	32	40.64 [1.600]	38.10 [1.500]	35.20 [1.39]	390262-3
△	28	35.56 [1.400]	33.02 [1.300]	30.12 [1.19]	390262-2
△	24	30.48 [1.200]	27.94 [1.100]	25.10 [.988]	390262-1
FINISH	POS	A±0.20 [.008]	B±0.10 [.004]	C±0.15 [.004]	PART NO.

THIS DRAWING IS A CONTROLLED DOCUMENT. 07SEP04

DIMENSIONS: mm [INCHES]	TOLERANCES UNLESS OTHERWISE SPECIFIED:	DIV BSV	CHK	APVD	NAME	DATE	BY
0 PLC ±	1 PLC ±						
2 PLC ±	3 PLC ±						
4 PLC ±	ANGLES ±						
MATERIAL	FINISH	SIZE	SCALE	WEIGHT	RESTRICTED TO		
1	2-7	A1	5:1				

tyco Electronics
 Tyco Electronics Corporation
 Harrisburg, Pa 17105-3608

PRODUCT SPEC: DIP SOCKET, .600 CENTER LINE LADDER STYLE

DRAWING NO: 390262

CUSTOMER DRAWING