

NOTES:

- 1) MATERIALS:
HOUSING: HIGH TEMPERATURE NYLON, GLASS FILLED, UL 94 V-0.
COLOR: BLACK
TERMINALS: BRASS.
 - 2) FINISH:
TERMINAL: SELECTIVE GOLD (Au) IN THE CONTACT AREA;
THICKNESS= .76 MICROMETER (30 MICROINCH) MINIMUM;
SELECTIVE TIN (Sn) ALLOY IN THE PC TAIL AREA;
THICKNESS= 1.27 MICROMETER (50 MICROINCH) MINIMUM;
NICKEL (Ni) UNDERPLATE OVERALL.
 - 3) CONFORMS TO PRODUCT SPEC: PS-71660.
 - 4) PRODUCT PACKAGED PER PK-70873-084*.
 - 5) ASSEMBLY MATES WITH MOLEX P/N SDA-71660-7***
- ⚠️ RECOMMENDED P.C. BOARD THICKNESS IS .062 (1.6).
 ⚠️ FOUR DIGIT DATE CODE (WK. YR.) EXAMPLE 26 96 LOCATED IN AREA SHOWN.

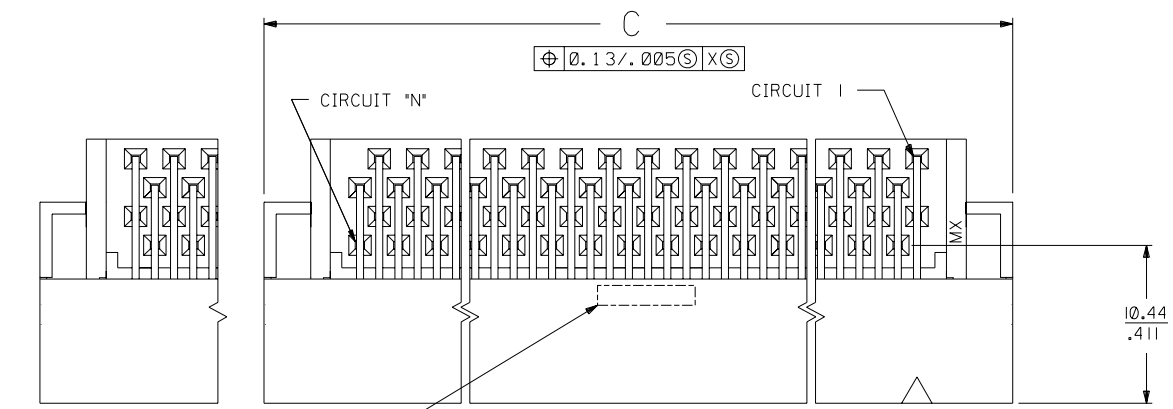

END DETAIL FOR 130 CKT

NOTE FOR LEAD FREE CONVERSION:

THE PRIMARY SHIPPING CARTON WILL BE LABELED "COMPLIANT TO ROHS DIRECTIVE 2002/95/EC AND ELV ANNEX II OF DIRECTIVE 2000/53/EC". CARTONS WITHOUT THIS LABEL MAY CONTAIN PRODUCT WITH LEAD.

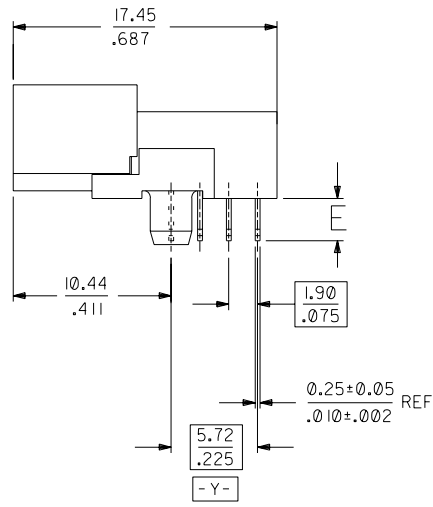
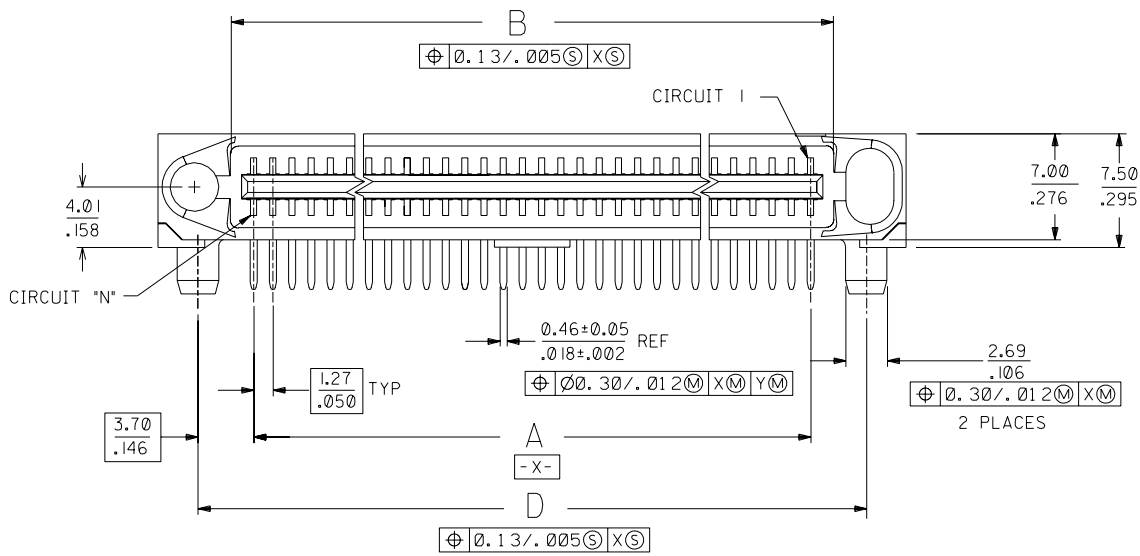

J	LEAD FREE CONV ECN UCP2004-2096 RADAMS 04/04/23
I	ADDED DIMENSION ECN UCP2004-0512 RWHITE 03/09/23
H	ADD 71661-2518 ECN UDT2002-0183 BSMART 01/08/01
G	ADD 80 CKT ECN UDT2001-1111 BSMART 01/04/16
F	ADD 40 & 100 CKT ECN UDT 2000-1086 ACHAMMER 00/05/30
E	REVISED PER ECN UDT1999-1036 KSMITH 99/05/27
DI	REVISED PER ECN UDT1999-0609 SWEENEY 99/01/27
D	REVISED PER ECN U71371 ACHAMMER 97/5/8
C	REVISED PER ECN U61477 7-3-96 DCA
B	REVISED PER ECN U60641 11-28-95 DRS
A	INITIAL RELEASE PER ECN U51055 6-1-95 RAN

MM
INCH

2	H
1	J
MFG, SH, REV, LTR, REVISIONS	

UNLESS OTHERWISE SPECIFIED TOLERANCES: ANGULAR $\pm 1/2^\circ$

INCH		METRIC	
3 PLACE	$\pm .010$	---	---
2 PLACE	$\pm .---$	± 0.25	---
1 PLACE	---	$\pm .---$	---

DRAFT WHERE APPLICABLE MUST REMAIN WITHIN DIMENSIONS

DRWG. BY: RAN CHK'D. BY: RAN
 APP'D. BY: CAB SCALE: 4: 1

FILE NAME: S7166125 301
 THIS DRAWING CONTAINS INFORMATION THAT IS PROPRIETARY TO MOLEX INC. AND SHOULD NOT BE USED WITHOUT WRITTEN PERMISSION

TITLE: SALES ASSEMBLY
 EBB1 50D RIGHT ANGLE
 BLIND MATE PLUG CONNECTOR

MOLEX INCORPORATED
 LISLE, ILL. 60532 U.S.A.

SHEET NO. 1 OF 2
 DATE 4/26/95

PART NO. SDA-71661-25**
 DRWG. NO. SEE TABLE

SIZE: C C

