

B

22

IP68

BUCCANEER "MINI"
SEALED CONNECTOR

BULGIN

Electrical + Electronic Components



WIRING AND ASSEMBLY INSTRUCTIONS

It is important that these instructions are fully complied with to ensure this product is completely Watertight and Electrically safe.

ASSEMBLY NOTES

Cable and Wiring:

Always wire socket carrier (female) to supply source and pin carriers (male) to appliance or load.

Pin or Socket carriers may be fitted to any main body to provide desired configuration.

Standard gland supplied fits cable sheaths of 5-7mm dia. Optional glands are available for 6-8mm or 7-9mm dia. cable sheaths (see overleaf).

For mains supply, 3 wire systems, always connect:

Brown	to "L" Terminal.
Blue	to "N" Terminal.
Green/Yellow	to "E" Terminal.

For correct sealing ensure all surfaces are free of contamination (dust, grease etc.)

Use only circular sheathed cable. Gland nut must be securely tightened to both seal and clamp cable.

ASSEMBLY:

1. Strip outer sheath and inner conductors to dimensions shown.
2. Thread cable as illustrated.
3. After soldering or crimping contacts, load into appropriate carrier using insertion tool SA3150.
4. Mount polarizing/blanking pins if required.
5. Push carrier firmly home ensuring it is seated on "O" ring and locking tabs snap into place.
6. Assemble gland, cage and gland nut.

Assembly Torques (Minimum)

Flex Mounting &
 In-Line: Gland Nut 0.23Nm min. 0.45Nm max.
 Chassis/Panel &
 Side Entry: Rear Nut 0.7Nm min. 1.7Nm max.
 Sealing Caps &
 Locking Ring: 0.23Nm min. 1.13Nm max.

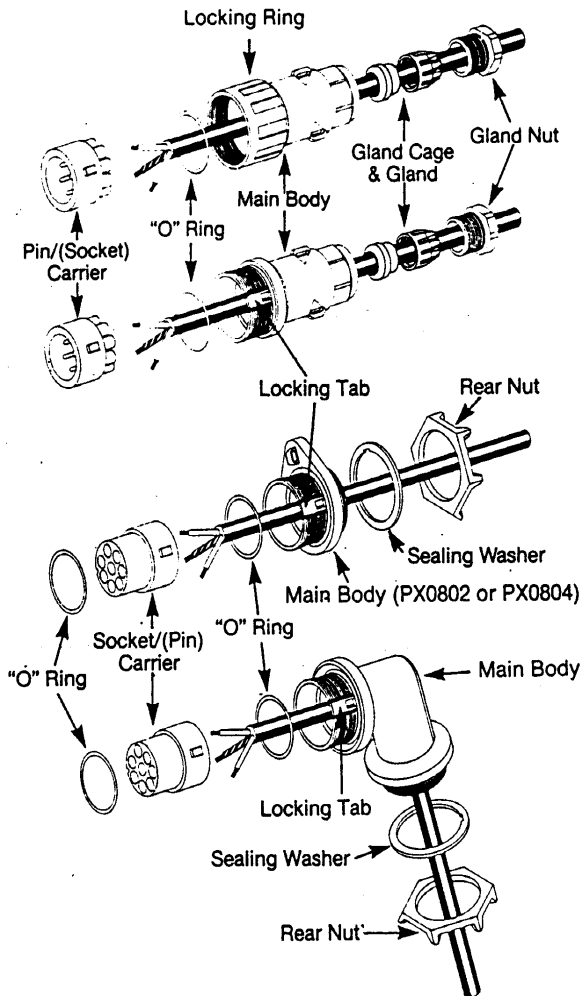

ALL 'O' RINGS ARE PRE-FITTED

Sealing Caps:

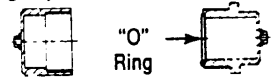

PX0810

PX0811

PX0810 Fits PX0801, PX0802, PX0803, PX0804 & PX0805. Ensure "O" Ring is in place on main body male thread.

PX0811 Fits PX0800. Ensure "O" Ring is in place in cap.

SA3150 Insertion Tool

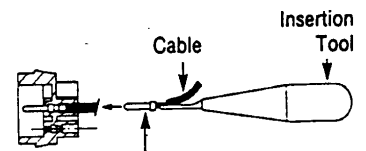

Solder/Crimp Contact

After soldering or crimping, load contact onto insertion tool SA3150 and push fully home into carrier.

Cable Stripping Dimensions

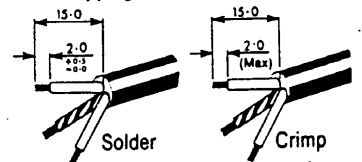

Polarizing/Blanking Pins SA3147

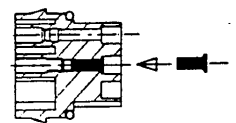

N.B. Once inserted Pins/Sockets cannot be removed and subsequently replaced without changing the carrier moulding.

Dimensions:

