

Dimensions

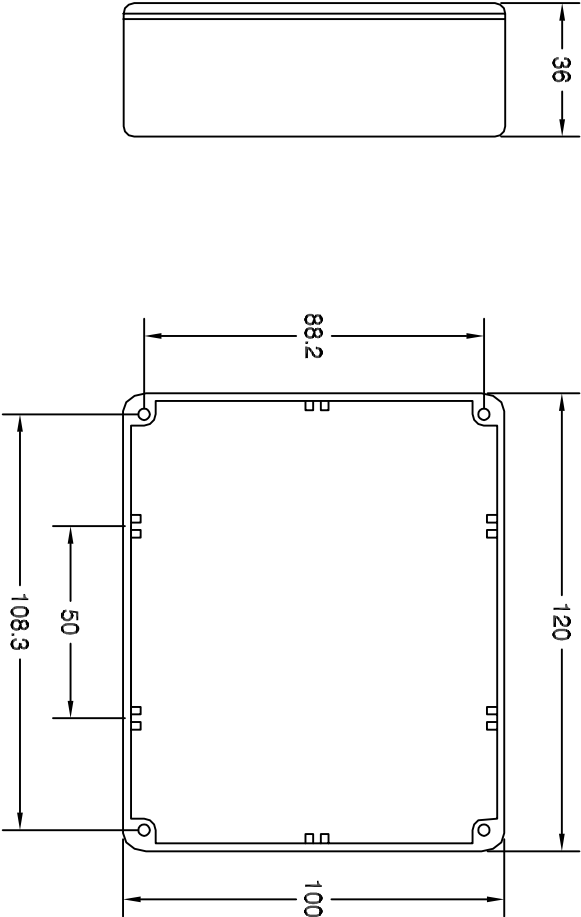

Description

A range of diecast boxes in various sizes, manufactured in a robust aluminium alloy. These lightweight enclosures provide excellent screening against EMI/RFI and are therefor ideal housing for electronic components and circuits.

The close fitting lid is secured using four countersunk screws. The box also incorporates integral PCB guides, and comes in a plain finish.

The box is fitted with a self-adhesive rubber seal, providing IP66 rating.

Features

MATERIAL BOX & LID	:Aluminium Alloy LM24
SCREWS	:Stainless Steel M3.5x12
SEAL	:Neoprene Closed cell, black
WALL THICKNESS	:2.0mm

CONVERTED FROM COREL. PS0311 ISS2

ALL DIMENSIONS IN MM / ANGLES IN DECIMAL DEGREES

DrgNo 460-0120-GS

TITLE SEALED DIECAST BOX 'M' SIZE



ISSUE 3

GENERAL SPECIFICATION  
FOR 460-0120

CUSTOMER  
FILTER REF

Sheet 1 of 1    Aprvd Date 29/04/02    Aprvd By MC    Drwn by BS    SCALE    NTS    CNN---    Location N: \LONDON\GS\GSG00078

©DELTRON EMCON LTD, ROXBURGH HOUSE, FOXHILLS INDUSTRIAL PARK, SCUNTHORPE, NORTH LINCOLNSHIRE, DN15 8QJ TEL +44 1724 281770 F +44 1724 270230