



SERVICE PARTS LIST

BULLETIN NO.
54-42-0140

| | | | |
|--|-------------------------------------|---|-----------|
| SPECIFY CATALOG NO. AND SERIAL NO. WHEN ORDERING PARTS | | REVISED BULLETIN | DATE |
| 2.4 VOLT CORDLESS SCREWDRIVER | | | July 2001 |
| CATALOG NO. 6539-1 | STARTING SERIAL NO. 729-1001 | WIRING INSTRUCTION See Reverse Side | |

EXAMPLE:
Component Parts (Small #)
Are Included When Ordering
The Assembly (Large #).

00
0

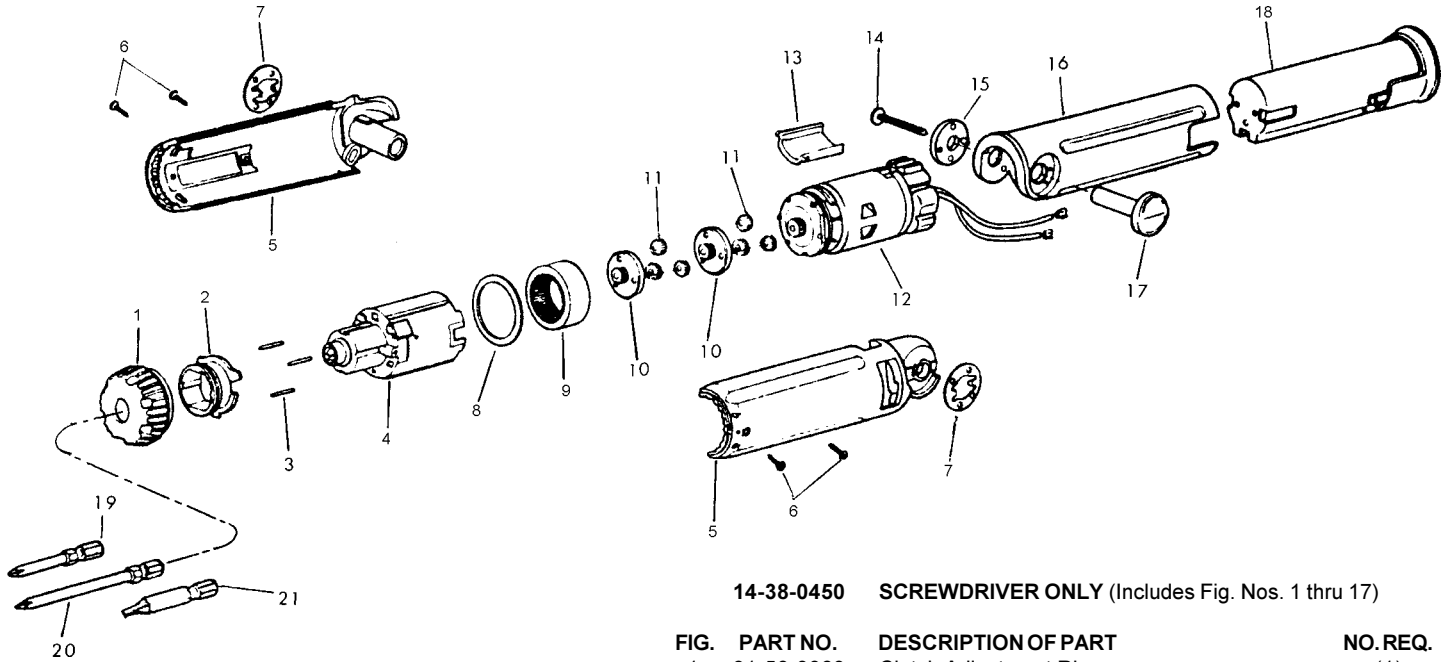

14-38-0450 SCREWDRIVER ONLY (Includes Fig. Nos. 1 thru 17)

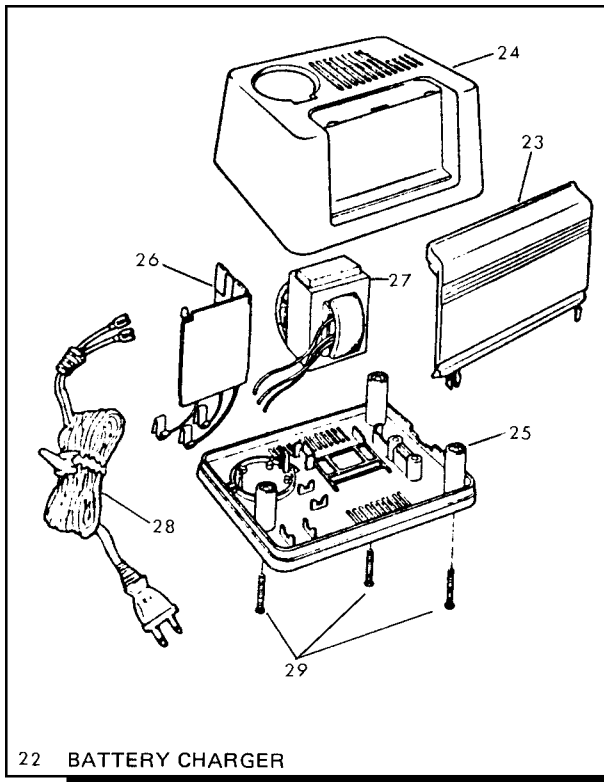

22 BATTERY CHARGER

| FIG. | PART NO. | DESCRIPTION OF PART | NO. REQ. |
|-----------------------------|------------|--|----------|
| 1 | 31-58-0060 | Clutch Adjustment Ring | (1) |
| 2 | 45-04-0710 | Adjustment Screw | (1) |
| 3 | 44-60-0800 | Shaft Pin (Contains 3) | (3) |
| 4 | 32-48-0040 | Gear Assembly | (1) |
| 5 | 31-50-0500 | Right and Left Motor Housing Set | (1) |
| 6 | 05-78-0100 | Housing Screw (Contains 4) | (4) |
| 7 | 40-50-1950 | Hinge Spring (Contains 2) | (2) |
| 8 | 44-90-0570 | Thrust Plate | (1) |
| 9 | 32-65-0030 | Internal Ring Gear | (1) |
| 10 | 42-46-0120 | Carrier (Contains 2) | (2) |
| 11 | 32-62-0090 | Planet Gear (Contains 6) | (6) |
| 12 | 14-50-0330 | Motor Assembly | (1) |
| 13 | 31-15-0360 | Hinge Cover | (1) |
| 14 | 05-78-0700 | Handle Screw | (1) |
| 15 | 45-88-7920 | Washer | (1) |
| 16 | 31-44-1400 | Handle | (1) |
| 17 | 44-60-0810 | Retaining Pin | (1) |
| ACCESSORIES FOR TOOL | | | |
| 18 | 48-11-0100 | Battery Pack | (1) |
| 19 | 48-30-1510 | Bit- No. 1 Phil. 1/4 Hex | (1) |
| 20 | 48-30-1525 | Bit- No. 1 Phil. | (1) |
| 21 | 48-30-0500 | Bit- 6F 8R 1/4 Hex | (1) |
| 22 | 48-59-0180 | Battery Charger (Incl. Fig. Nos. 23 thru 29) | (1) |
| 23 | 43-72-0130 | Bit Holder Door | (1) |
| 24 | 31-03-0040 | Upper Housing | (1) |
| 25 | 31-03-0035 | Lower Housing | (1) |
| 26 | | Printed Circuit Board | (1) |
| 27 | | Transformer | (1) |
| 28 | 22-64-0325 | Cord Set | (1) |
| 29 | 45-04-0700 | Charger Screw (Contains 3) | (3) |

WIRE CONNECTION DIAGRAM

