

REEVITE

INDUSTRIAL MOULDINGS

OPEN GROMMETS

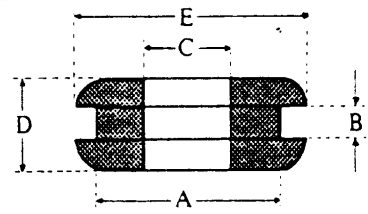

RUBBER PART NO	P.V.C. PART NO	METRIC					IMPERIAL				
		A	B	C	D	E	A	B	C	D	E
	PV 943	17.5	4.4	14.3	10.7	22.2	11/16	1/16	9/16	27/64	7/8
	PV 944	17.5	4.8	14.3	11.1	22.2	11/16	3/16	9/16	7/16	7/8
RB 3445		17.5	5.2	12.7	11.5	22.2	11/16	13/64	1/2	29/64	7/8
RB 3446		17.5	6.4	12.7	12.7	22.2	11/16	1/4	1/2	1/2	7/8
RB 3448		17.5	9.5	12.7	15.9	22.2	11/16	3/8	1/2	3/8	7/8
	PV 947	19.0	0.8	12.7	5.6	25.4	3/4	1/32	1/2	1/32	1
	PV 948	19.0	0.8	15.9	5.6	23.8	3/4	1/32	3/8	1/32	1 1/16
RB 249		19.0	1.2	6.4	7.6	25.4	3/4	3/64	1/4	19/64	1
	PV 263	19.0	1.2	7.2	9.1	25.4	3/4	3/64	9/32	23/64	1
RB 6847		19.0	1.2	14.3	7.6	25.4	3/4	3/64	9/16	19/64	1
	PV 949	19.0	1.2	17.5	7.6	23.8	3/4	3/64	1 1/16	19/64	1 1/16
	PV 950	19.0	1.2	15.9	6.0	23.8	3/4	3/64	3/8	15/64	1 1/16
RB 263		19.0	1.6	6.4	8.0	25.4	3/4	1/16	1/4	3/16	1
RB 264		19.0	1.6	9.5	6.4	25.4	3/4	1/16	3/8	1/4	1
	PV 951	19.0	1.6	11.9	8.0	25.4	3/4	1/16	1 1/32	3/16	1
IS2-345	PV 73A *	19.0	1.6	12.7	6.4	25.4	3/4	1/16	1/2	1/4	1
	PV 952	19.0	1.6	13.5	5.6	25.4	3/4	1/16	1 1/32	7/32	1
	PV 92	19.0	1.6	14.0	6.0	21.0					
RB 6848		19.0	1.6	14.3	8.0	25.4	3/4	1/16	9/16	3/16	1
	PV 73B	19.0	1.6	15.9	5.6	22.2	3/4	1/16	3/8	7/32	7/8
	PV 73	19.0	1.6	15.9	6.4	23.8	3/4	1/16	3/8	1/4	1 1/16
	PV 953	19.0	1.6	17.5	4.8	23.8	3/4	1/16	1 1/16	3/16	1 1/16
RB 6849		19.0	1.8	14.3	8.0	25.4	3/4	.070	9/16	3/16	1
RB 73		19.0	2.0	14.3	8.4	22.2	3/4	3/64	9/16	21/64	7/8
	PV 954	19.0	2.0	15.9	6.8	23.8	3/4	3/64	3/8	17/64	1 1/16
RB 250		19.0	2.4	6.4	8.7	25.4	3/4	1/32	1/4	1 1/32	1
RB 265A		19.0	2.4	12.7	8.7	25.4	3/4	1/32	1/2	1 1/32	1
	PV 955	19.0	2.4	15.9	7.2	23.8	3/4	1/32	3/8	9/32	1 1/16
	PV 956	19.0	2.8	15.9	7.6	23.8	3/4	7/64	5/8	19/64	1 1/16
RB 266		19.0	3.2	6.4	9.5	25.4	3/4	1/8	1/4	3/8	1
	PV 74A	19.0	3.2	12.7	8.0	25.4	3/4	1/8	1/2	3/16	1
RB 74		19.0	3.2	14.3	9.5	22.2	3/4	1/8	9/16	3/8	7/8
RB 6851		19.0	3.2	14.3	9.5	25.4	3/4	1/8	9/16	3/8	1
RB 74A		19.0	3.2	14.3	9.5	25.4	3/4	1/8	9/16	3/8	1
	PV 74	19.0	3.2	15.9	8.0	23.8	3/4	1/8	5/8	3/16	1 1/16
RB 254		19.0	3.6	6.4	9.9	25.4	3/4	9/64	1/4	25/64	1
RB 957		19.0	3.6	12.7	9.9	30.2	3/4	9/64	1/2	25/64	1 1/16
	PV 958	19.0	3.6	15.9	8.4	23.8	3/4	9/64	3/8	21/64	1 1/16
RB 255		19.0	4.0	6.4	10.3	25.4	3/4	1/32	1/4	1 1/32	1
	PV 262A	19.0	4.0	7.2	11.9	25.4	3/4	1/32	9/32	1 1/32	1
RB 6852		19.0	4.0	14.3	10.3	25.4	3/4	1/32	9/15	1 1/32	1
	PV 959	19.0	4.0	15.9	8.7	23.8	3/4	1/32	5/8	1 1/32	1 1/16
	PV 960	19.0	4.4	15.9	9.1	23.8	3/4	1 1/64	5/8	23/64	1 1/16
RB 259		19.0	4.8	6.4	11.1	25.4	3/4	3/16	1/4	7/16	1
	PV 267	19.0	4.8	11.1	9.5	25.4	3/4	3/16	7/16	3/8	1
	PV 961	19.0	4.8	15.9	9.5	23.8	3/4	3/16	3/8	3/8	1 1/16
RB 6853		19.0	5.2	14.3	11.5	25.4	3/4	13/64	9/16	29/64	1
RB 261		19.0	6.4	6.4	12.7	25.4	3/4	1/4	1/4	1/2	1
RB 962		19.0	6.4	7.2	15.9	23.8	3/4	1/4	9/32	3/8	1 1/16
	PV 74C	19.0	6.4	12.7	11.1	25.4	3/4	1/4	1/2	7/16	1
RB 963		19.0	6.4	12.7	11.9	28.6	3/4	1/4	1/2	1 1/32	1 1/8
RB 6854		19.0	6.4	14.3	12.7	25.4	3/4	1/4	9/16	1/2	1