

A range of diecast boxes in various sizes, manufactured in a robust aluminium alloy. These lightweight enclosures provide excellent screening against EMI/RFI and are therefore ideal housing for electronic components and circuits.

The close fitting lid is secured using countersunk screws. The box comes in a smooth, nylon, hard wearing finish in a choice of colours.

Material
Box & Lid :Aluminium Alloy
LM24
Screws :Mild Steel
Zinc Plated
M3.5x9
Nylon Coating : 75-150 microns
Rilsan Nylon 11

BLUE RAL 5010
BLACK RAL 9005
GREY RAL 7001

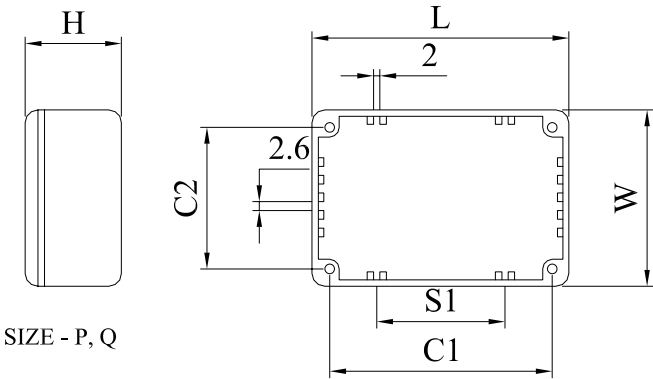
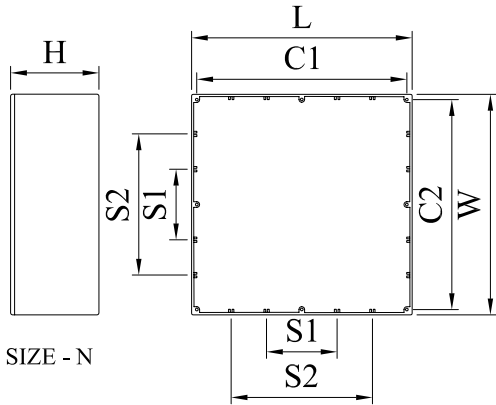
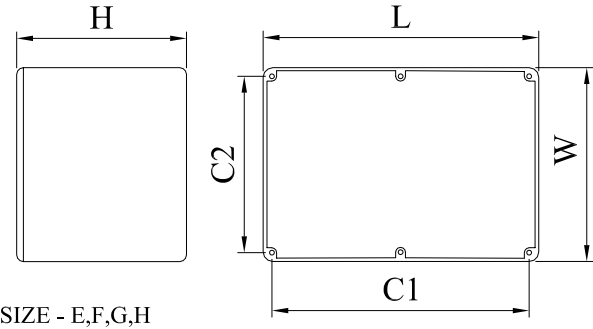
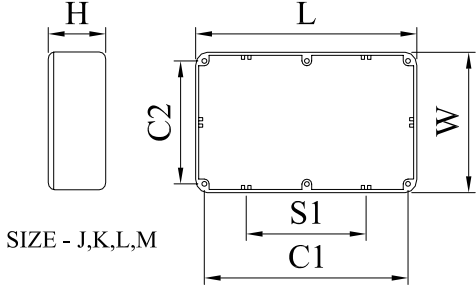
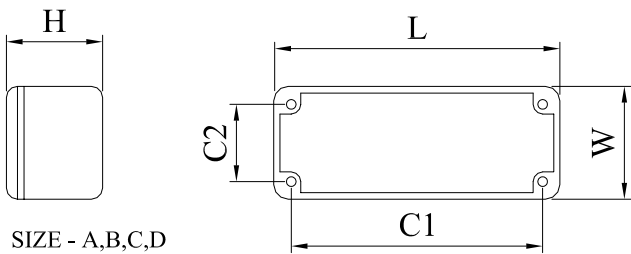

Add letter after order code for colour required.
Grey - A Blue - B Black - E

TAPER 1.5° PER SIDE

Part No	Size	L	W	H	C1	C2	S1	S2	Wall Thickness	Taper
462-0010	A	88.9	34.9	29.5	79.4	25.4			1.5mm	Base to Lid
462-0020	B	114.5	64	29.5	104.6	54.1			1.5mm	Lid to Base
462-0030	C	115.7	90.5	54.9	104.6	79.4			1.5mm	Lid to Base
462-0040	D	115.3	64.5	54.9	103.4	52.5			2.0mm	Lid to Base
462-0050	E	171.5	120.6	54.9	160.5	109.6			2.0mm	Base to Lid
462-0060	F	171.5	120.6	105.7	160.5	109.6			2.0mm	Base to Lid
462-0070	G	222.3	146	55	211.5	135.3			2.0mm	Base to Lid
462-0080	H	222.3	146	105.7	211.5	135.3			2.0mm	Base to Lid
462-0090	J	275	175	65	264	164	132		2.0mm	Base to Lid
462-0100	K	139.7	101.6	76	128.7	90.6	64.4		2.0mm	Base to Lid
462-0110	L	165	127	76	154.1	116	77		2.0mm	Base to Lid
462-0120	M	120	100	35	108.3	88.2	50		2.0mm	Base to Lid
462-0130	N	250	250	100	238	238	80	160	2.5mm	Base to Lid
462-0140	P	80	55	25	70.5	45.5	40		1.5mm	Base to Lid
462-0150	Q	60	55	30	50.5	45.5	30		1.5mm	Base to Lid