

Terminals

317 410

L1001/1 Terminal

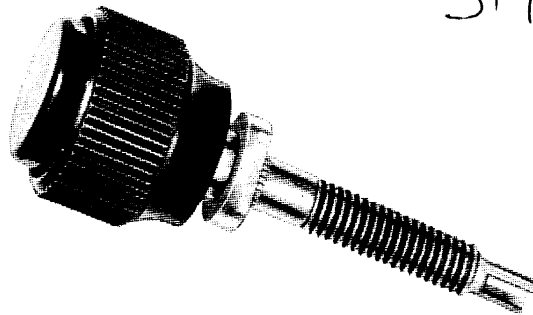

This terminal incorporates a non-rotating centre disc in the head for lettering. The rotating collar is captive and the clamping gap is free from thread.

When used with Panel fittings 01 this terminal is panel sealed.

Current rating: 15 A

Temperature range: -25°C to +70°C

Materials: Head, phenolic resin
Disc, tenite butyrate
Stem, brass, nickel-plated

Colours head: Black
disc: Black, red

Ordering reference:

L1001/1/Colour

Fixing Kit 3

Panel fittings (see below and opposite)

(Terminals and fittings are supplied unassembled and must be ordered as individual items.)

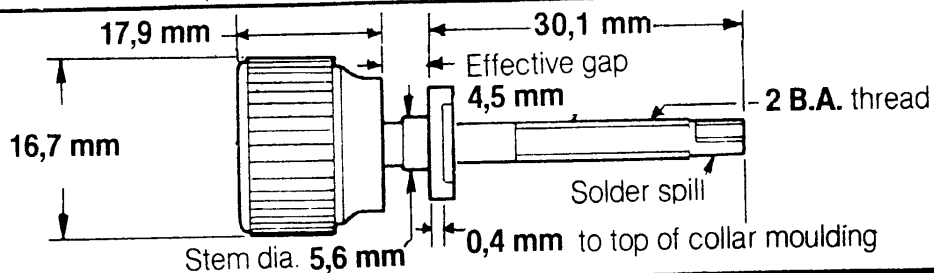

Fixing kit 3

Comprises: Metal washer
Non-rotating washer
2 locknuts (2 BA)

B panel fittings

Comprises: Phenolic resin moulding. SRBP insulating washer

Fixing torque: 1,41 Nm

Colour: Black

Breakdown voltage: 3 kVd.c.

Insulation resistance: $\geq 10^3$ megohms

Temperature range: -40°C to +85°C (ambient)

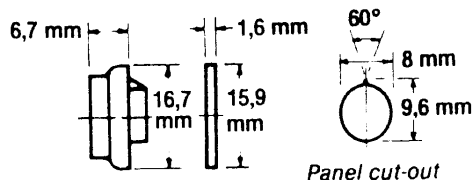



CA panel fittings

Comprises: _____ Phenolic resin moulding. 2 SRBP insulating washers

Breakdown voltage: _____ 3 kVd.c.

Insulation resistance: _____ $\geq 10^3$ megohms

Temperature

range: _____ -40°C to $+85^\circ\text{C}$ (ambient)

Fixing torque: _____ 1,41 Nm

Colour: _____ Black

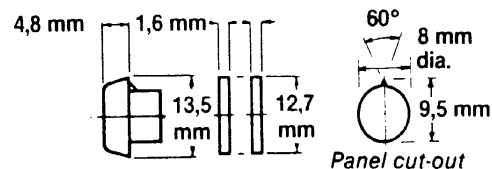

01 panel fittings

Comprises: _____ 2 phenolic resin moulding. 2 sealing rings. Metal washer 2 locknuts

Breakdown voltage: _____ >2 kVd.c.

Insulation resistance: _____

Panel thickness: 3,4 mm maximum

Fixing torque: _____ 0,565 Nm

Clamping torque: 1,13 Nm

Colour: _____ Black

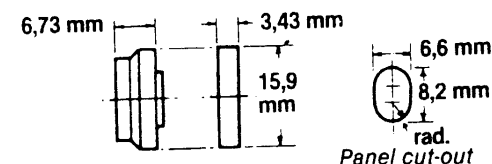

2B panel fittings

Comprises: _____ 2 phenolic resin mouldings

Breakdown voltage: _____ 7 kVd.c.

Insulation resistance: _____ $\geq 10^3$ megohms

Panel thickness: 0,9 mm to 1,6 mm

Temperature

range: _____ -40°C to $+85^\circ\text{C}$ (ambient)

Fixing torque: _____ 1,41 Nm

Colour: _____ Black

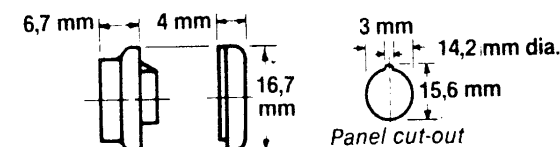

2L panel fittings

Comprises: _____ 2 polyethylene-polypropylene co-polymer mouldings

Breakdown voltage: _____ 8 kVd.c.

Insulation resistance: _____ $\geq 10^3$ megohms

Panel thickness: 0,9 mm to 4,8 mm

Temperature

range: _____ -40°C to $+85^\circ\text{C}$ (ambient)

Fixing torque: _____ 1,41 Nm

Colour: _____ Black

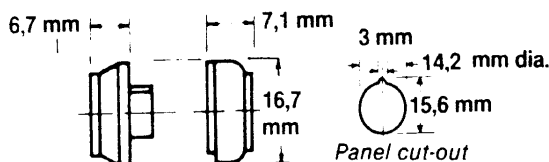

31A panel fittings

Comprises: _____ 2 polyethylene-polypropylene co-polymer mouldings

Breakdown voltage: _____ 8 kVd.c.

Insulation resistance: _____ $\geq 10^6$ megohms

Panel thickness: 0,9 mm to 3,2 mm

Temperature

range: _____ -40°C to $+100^\circ\text{C}$ (ambient)

Fixing torque: _____ 1,41 Nm

Colour: _____ Black

