

# General Accessories

## Socket Covers

### Type BB



#### Socket Covers

##### Socket cover type BB 4

For covering front screw connections of socket. The holes (Ø 5 mm) above the terminals prevent accidental touching, but allow measurements without removing socket cover.

**BB 4:** For 8-pole and S 408 and 11-pole S 411 sockets.



**Material**  
**Colour**

Noryl SE1  
Light grey

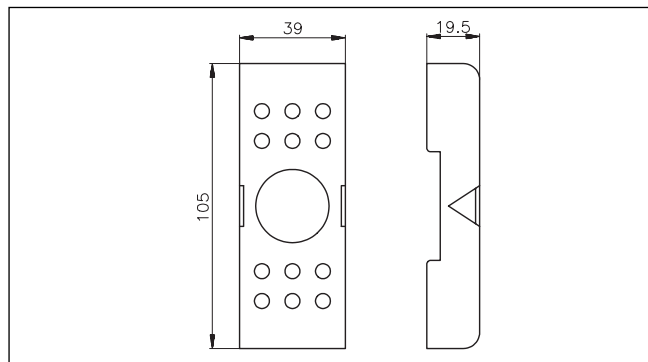

##### Socket cover type BB 5 B

For covering front screw connections of socket. The holes (Ø 5 mm) above the terminals prevent accidental touching, but allow measurements without removing socket cover.

**BB 5 B:** For 11-pole socket D 411 B.



**Material**  
**Colour**

Noryl SE1  
Black

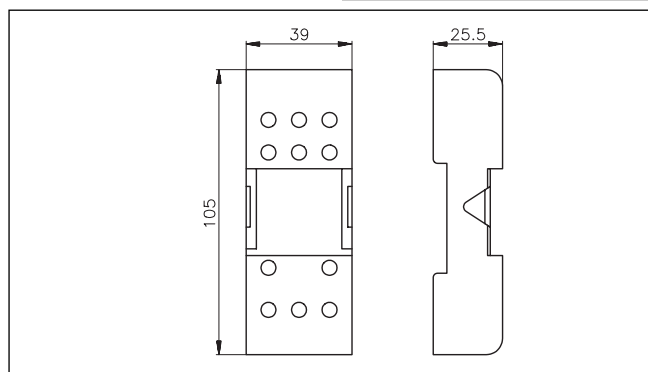

##### Socket cover type BB 1

For covering socket terminals when a plug-in timer is mounted on e.g. a front panel.

##### BB 1

For terminals of socket type S 108, S 111, S 108 A and S 111A.



**Material**  
**Colour**

Noryl SE1  
Light grey

