

1591D

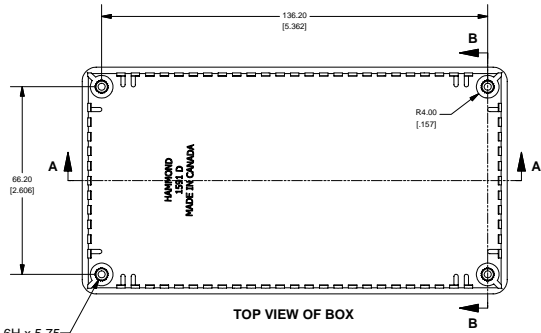

SIDE VIEW

M3 X 0.5 - 6H x 5.75-
THREADED HOLES



TOP VIEW OF BOX

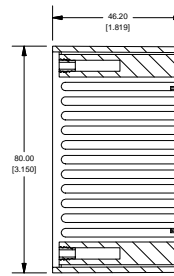

SECTION B-B
SCALE 3 / 4

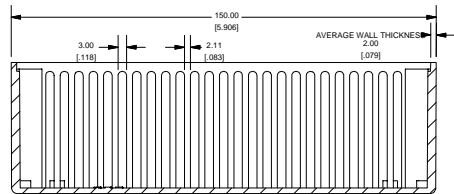

SECTION A-A
SCALE 3 / 4

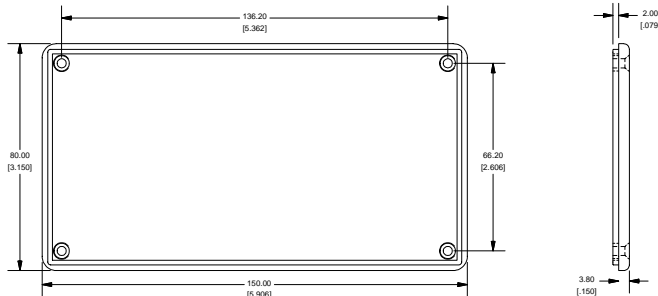
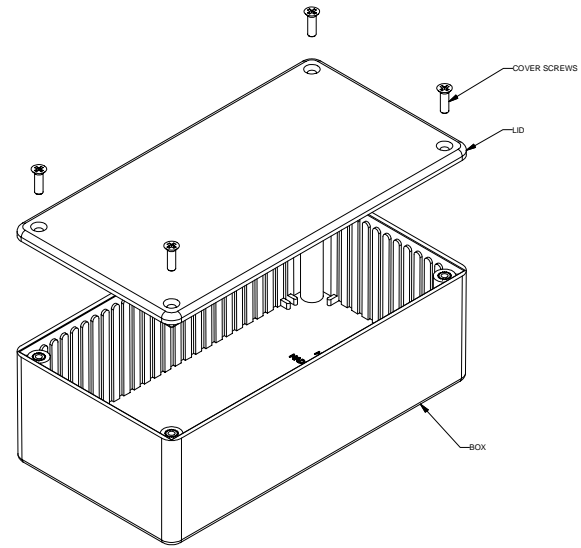

BOTTOM ON LID

SIDE OF LID

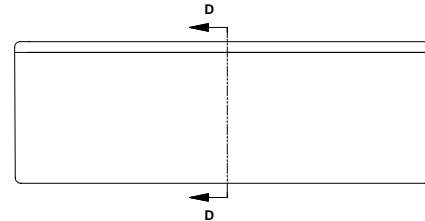

SECTION D-D
SCALE 3 / 4

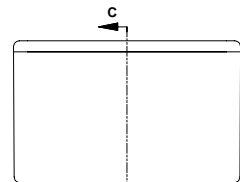
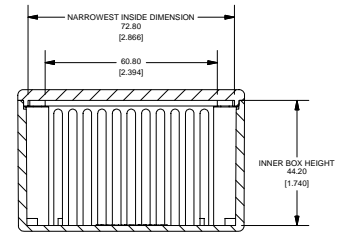

END VIEW OF ASSEMBLY

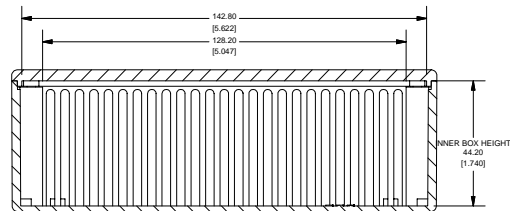

SECTION C-C
SCALE 3 / 4

PART NUMBERS		
1591D Enclosures		
Material	Colour	Part Number
ABS	Beige	1591DBG
	Black	1591DBK
	Blue	1591DBU
	Clear	1591DCY
	Black Shielded	1591RDBK
GP ABS	Black	1591DSBK
	Ice Blue	1591DTBU
Translucent Polycarbonate	IR Red	1591DTRD
	Crystal Clear	1591DTCL
Accessories		
	Description	Part Number
Used with ABS and Translucent Polycarbonate Enclosures	PC Board Card Adapters	See Accessories Section
	Flange Kits	See Accessories Section
	Replacement Screws, nickel plated M3 - 0.5 x 10mm, Pack of 100.	1591MS100BK (Black)
	Belt/Pocket Clip, w/ nylon screws (insulated to avoid interference) and mounting template	1599CLIP - Black
	Clear Lids - clear, flame retardant polycarbonate - Lid ONLY	1599CLIPGY - Grey
	Clear Lids - clear, flame retardant polycarbonate - Lid ONLY	1591DC
	PC Board Card Adapters	See Accessories Section
	Flange Kits	See Accessories Section
	Belt/Pocket Clip, w/ nylon screws (insulated to avoid interference) and mounting template	1599CLIP - Black
	Replacement Screws, self tapping, black oxide, #4 x 0.5, Pack of 100.	1591TS100BK
Used with GP ABS Enclosure	Clear Lids - clear, flame retardant polycarbonate - Lid ONLY	1591DC
	Clear Lids - clear, flame retardant polycarbonate - Lid ONLY	1591DC
Required Torques for Fasteners (no lubrication)		
	M3 - 0.5 x 10mm Screws	30-40 cN*m
	#4 x 0.5 Screws	30-40 cN*m



www.hammondmfg.com