



CMP6 Relay

No.50091133

40009196 1369391

E164730

CQC02001001295



1.COIL DATA

1-1.Nominal Voltage	5,12,24VDC
1-2.Coil Resistance	Refer to Coil Data Chart
1-3.Operate Voltage	Refer to Coil Data Chart
1-4.Release Voltage	Refer to Coil Data Chart
1-5.Nominal Power	900mW

2.CONTACT DATA

2-1.Contact Form	A-1 Form A
2-2.Contact Material	AgAlloy
2-3.Contact Rating	Resistive : 20A 250VAC/30VDC Inrush Current : 80A Break Current : 20A
2-4.Max.Switching Voltage	250VAC/30VDC
2-5.Max.Switching Current	20A
2-6.Max.Switching Power	5000VA,600W
2-7.Min.Switching Load	5VDC,100mA
2-8.Contact Resistance	Max 100m Ω(6VDC 1A)
2-9. Life	
Electrical	100,000 operations
Mechanical	20,000,000 operations

3.GENERAL DATA

3-1.Insulation Resistance	Min.1000MΩ 500VDC
3-2.Dielectric Strength	1,000VAC,1min between open contacts 4,500VAC,1min between coil and contacts
3-3.Operate Time	Max.20ms
3-4.Release Time	Max.10ms
3-5.Operate Temperature	-20 ~+55°C
3-6.Shock Resistance	
Endurance	1,000m/s ²
Misoperation	1,00m/s ²
3-7.Vibration Resistance	
Endurance	10 -55Hz, 1.5mm double amplitude
Misoperation	10 -55Hz , 1.5mmdouble amplitude
3-8.Humidity	35%~95%RH, +40°C
3-9.Weight	Approximately 21.0g
3-10.Safety	CQC NO.02001001295 VDE NO.40009196 CSA NO.1369391 (LR109368) TUV NO.50091133 UL NO.E164730

CMP6 Relay

No.50091133

40009196 1369391

E164730

CQC02001001295



4.ORDER CODE

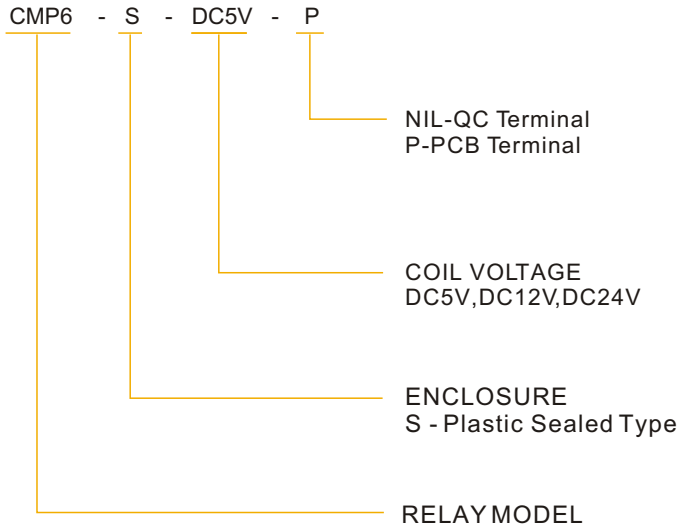

5.COIL DATA CHART

20°C

Model	Nominal Voltage VDC	Coil Resistance Ω +/-10%	Operate Voltage \leq VDC	Release Voltage \geq VDC	Coil Power mW
CMP6-(S)-DC5V	5	27.8	3.5	0.5	900
CMP6-(S)-DC12V	12	160	8.4	1.2	
CMP6-(S)-DC24V	24	640	16.8	2.4	

6.DIMENSIONS (mm)

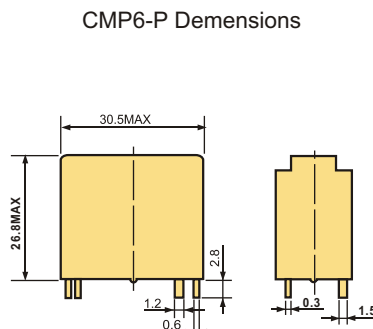
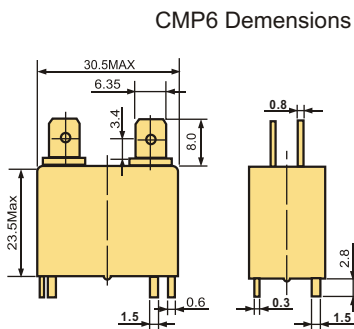

Mounting Hole Layout (Bottom View)

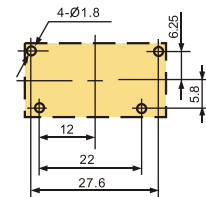

Wiring Diagrams (Bottom View)

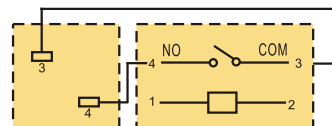
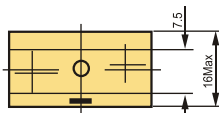
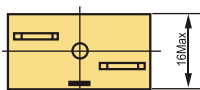

7.CMP6 CHARACTERISTIC CHART DATA

Max.Switching Power

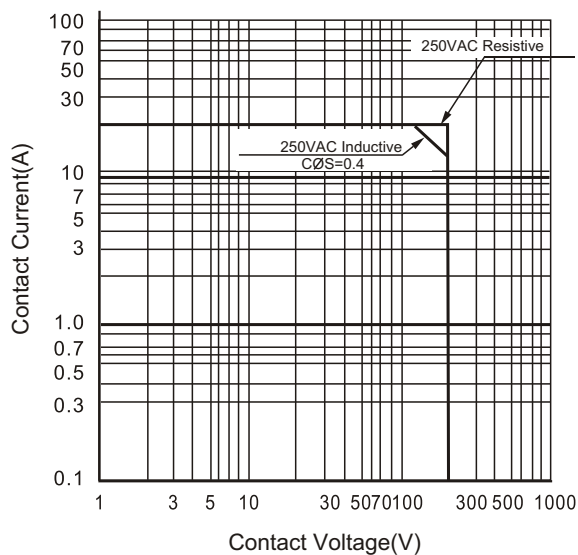

Life Curves

