

Tous droits strictement reserves. Reproduction ou communication a des tiers interdite sous quelque forme que ce soit sans autorisation écrite du propriétaire. Propriété de © FCI ELECTRONICS. Droits de reproduction © FCI ELECTRONICS INC.

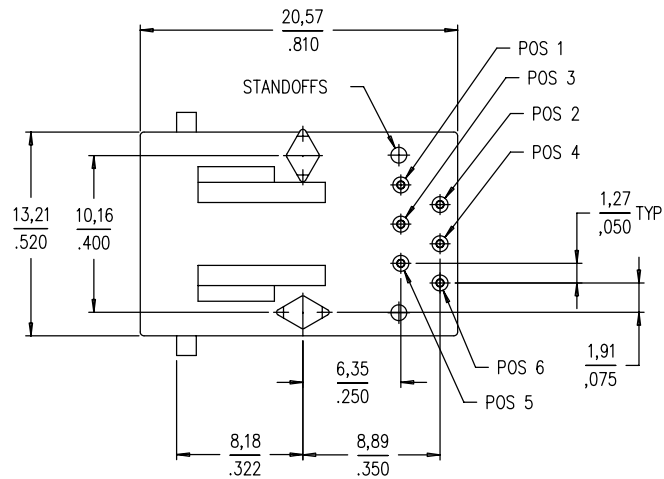

All rights strictly reserved. Reproduction or issue to third parties in any form whatever is not permitted without written authority from the proprietor. Property of © FCI ELECTRONICS Copyright FCI

PRODUCT NO.
SEE TABLE

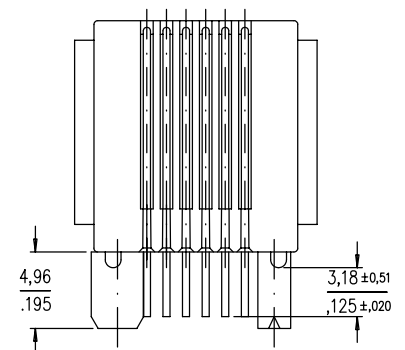
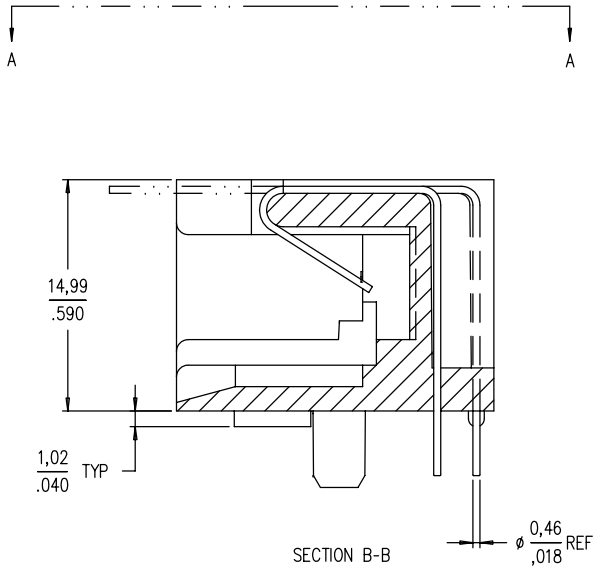
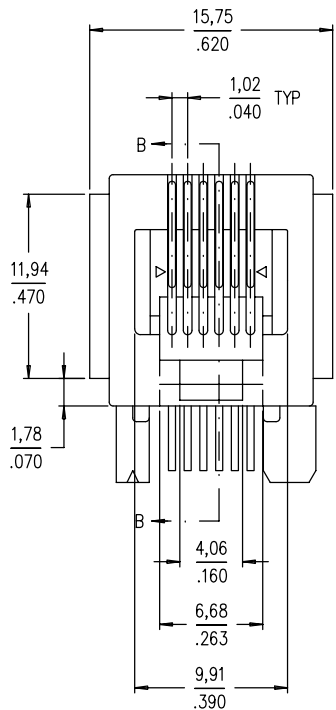

mat'l code		tolerance unless otherwise specified		CUSTOMER COPY		 www.fciconnect.com			
rev.	ecn no.	dr	date	linear	$XX \pm 0.3/XXX \pm 0.01$ $XXX \pm 0.15/XXX \pm 0.005$ $XXX \pm 0.051/XXX \pm 0.0020$	projection	title		
M	S80281	BC L	05/09/98						
N	V81245	BOB M	12/18/98						
P	S90087	BC L	05/19/99	angles	± 2°		6 POS HORIZONTAL P.C.B. MOD JACK ASSY		
R	S00022	BC L	01/26/00	dr	JANET 01/26/00			unit	product family
S	N05-0002	YS	01/07/05	enr	TONY CHIEN 01/26/00			mm/inch	code
				chr	TONY CHIEN 01/26/00	scale	size		
				appd	JENN TSAO 01/26/00	1/1	A3		
sheet	revision	S	S					product family	
index	sheet	1	2					size	
							dwg no.	TWN	
							68898	sheet	
							1 OF 2		

Tous droits strictement reserves. Reproduction ou communication a des tiers interdite sous quelque forme que ce soit sans autorisation écrite du propriétaire. Propriete de © FCI ELECTRONICS. Droits de reproduction FCI ELECTRONICS INC.

FCI

All rights strictly reserved. Reproduction or issue to third parties in any form whatever is not permitted without written authority from the proprietor. Property of c FCI ELECTRONICS Copyright FCI ELECTRONICS INC.

PRODUCT NO. (NOTE 1)	POSITIONS LOADED	CONTACT PLATING	HOUSING COLOR	MOUNTING EARS	REMARKS
68898-001/-001LF	ALL	GXT @ TM	BLACK	YES	-
-002/-002LF	2,3,4,5	GXT @ TM	BLACK	YES	-
-003/-003LF	3,4	0,76um /30u" Au	BLACK	YES	-
-004/-004LF	2,3,4,5	0,76um /30u" Au	BLACK	YES	-
-005/-005LF	ALL	0,76um /30u" Au	BLACK	YES	-
-006/-006LF	3,4	GXT @ TM	BLACK	YES	-
-007	2,3,4,5	GXT @ TM	GRAY	YES	OBSOLETE
-008/-008LF	ALL	0,76um /30u" Au	BLACK	NO	-
-009/-009LF	2,3,4,5	1,27um /50u" Au	BLACK	YES	-
-010/-010LF	ALL	1,27um /50u" Au	BLACK	YES	-
-011/-011LF	2,3,4,5	2u" Au	BLACK	YES	-
-012/-012LF	2,3,4,5	6u" Au	BLACK	YES	-
-013/-013LF	ALL	GXT @ TM	BLACK	YES	HI TEMP MATERIAL
-014/-014LF	3,4	6u" Au	BLACK	YES	-
-015/-015LF	3,4	GXT @ TM	BLACK	NO	-
-016/-016LF	2,3,4,5	GXT @ TM	BLACK	NO	-

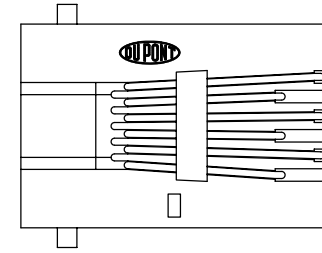

VIEW A-A

NOTES :

- WHEN PRODUCT CALLS FOR PACKAGING IN TRAY ORDER THE PRODUCT WITH PART NUMBER 68898-XXXT OR -XXXTLF FOR PACKAGING IDENTIFICATION. FOR PRODUCT NUMBER WITHOUT SUFFIX "T" OR "TLF", THE PRODUCT WILL BE PACKED IN TUBE AS PER DUPONT STANDARD PACKAGING.
- GXT IS 0,76um / 30u" MIN GXT WITH Au FLASH OVER 1,27um / 50u" MIN Ni.
- THIS PRODUCT MEETS EUROPEAN UNION DIRECTIVES AND OTHER COUNTRY REGULATIONS AS DESCRIBED IN GS-22-008.
- IF LF P/N PACKAGING MEETS GS-14-920 SPECIFICATION.
- THE HOUSING WILL WITHSTAND EXPOSURE TO 260°C PEAK TEMPERATURE FOR 10 SECONDS IN A WAVE SOLDER APPLICATION WITH A 1.60mm MINIMUM THICK CIRCUIT BOARD.
- FOR 68898-013/013LF THE HOUSING WILL WITHSTAND EXPOSURE TO 260°C PEAK TEMPERATURE FOR 10 SECONDS IN A CONVECTION, INFRA-RED OR VAPOR PHASE REFLOW OVEN.

LEAD FREE PRODUCT NO.

RECOMMENDED BOARD LAYOUT
VIEWED FROM TOP

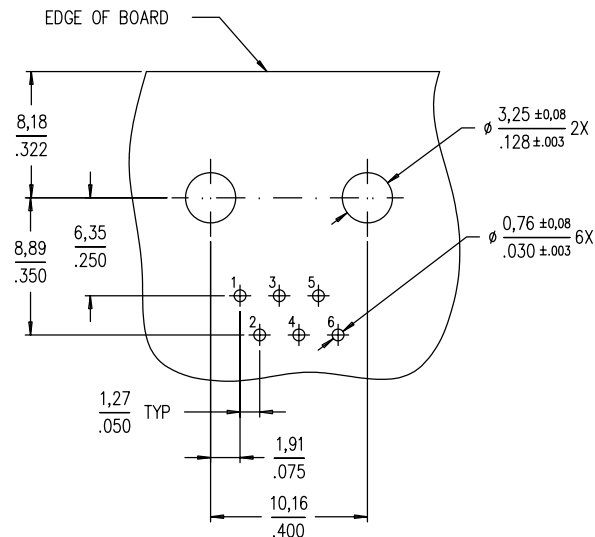

mat'l code		tolerance unless otherwise specified		CUSTOMER COPY		FCI www.fciconnect.com	
rev.	ecn no.	dr	date	linear	projection	title	
S				xx ± 0.3/xxx ± 0.01		6 POS HORIZONTAL P.C.B. MOD JACK ASSY	
				xx ± 0.15/xxx ± 0.005		product family	code
				xxx ± 0.05/xxx ± 0.0020		size	TWN
				angles ± 2°	mm/inch	dwg no.	sheet
				dr JANET 01/26/00	scale	68898	2 OF
				enr TONY CHIEN 01/26/00	1/1		
				chr TONY CHIEN 01/26/00			
				appd JENN TSAO 01/26/00			
sheet	revision						
index	sheet						