

RECOMMENDED P.C. BOARD HOLE-LAYOUT

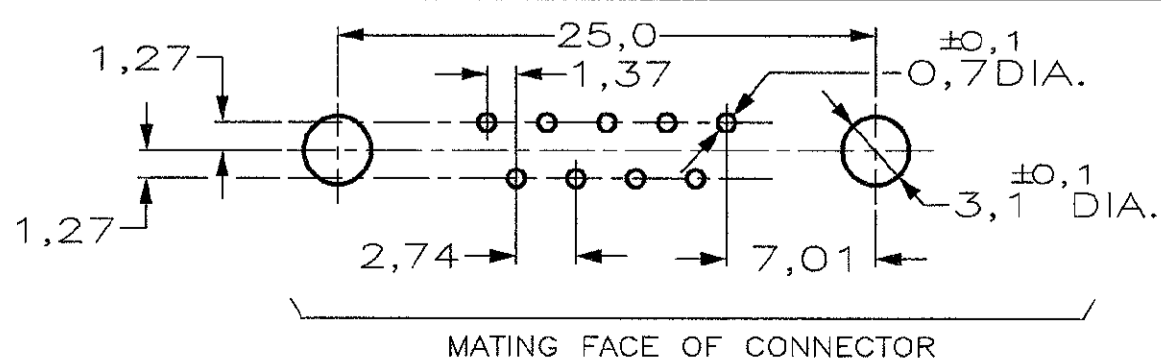

DO NOT SCALE METRIC THIRD ANGLE PROJECTION

ACCESSORIES PREFIX "Z"	DESCRIPTION OF ACCESSORY	2	2	2	2	2	2	2	2	2	2	2	2	2	2
5	BUSHING WITH THROUGH HOLE 3,1 DIA.														
5	BUSHING WITH INNER THREAD 4-40 UNC														
5	BUSHING WITH INNER THREAD M3														
4	FEMALE SCREWLOCK WITH 4-40 UNC														
4	FEMALE SCREWLOCK WITH M3														
7	BOARDLOCK														

ITEM NR.	DESCRIPTION OF ACCESSORY	0	1	2	3	4	5	6	7	8	9
9	9 POS.-----> Z-188025-Y										
	PREFIX FOR ACCESSORIES	0-XXXXXX-Y	1-XXXXXX-Y	2-XXXXXX-Y	3-XXXXXX-Y	4-XXXXXX-Y	5-XXXXXX-Y	6-XXXXXX-Y	7-XXXXXX-Y	8-XXXXXX-Y	9-XXXXXX-Y
	BASIC PARTNR.										
	SUFFIX FOR PLATING										

PLATING SUFFIX "Y"
 GOLD OVER NICKEL AS PER PERFORMANCE LEVEL 2 (DIN 41652)
 SOLDERPART: 2,5µm BRIGHT SnPb. -Y = -2

NOTES :
 1 GROOVE INDICATES VERSION WITH 4-40 UNC INNER THREAD; WITHOUT GROOVE INDICATES VERSION WITH M3 INNER THREAD.
 2 CAVITY IDENTIFICATION AT FRONT SIDE ONLY.
 3 PARTNUMBER AND DATE CODE.

- ITEM NRS./MATERIAL :
- 1 SHELL : BRIGHT TINPLATED STEEL
 - 2 HOUSING : GLASSFILLED POLYESTER, COLOR : BLACK
 - 3 CONTACTS : PHOSPHORBRONZE (PLATING : SEE TABLE ABOVE)
 - 4 FEMALE SCREWLOCK : TINPLATED STEEL (INNER THREAD 4-40 UNC OR M3)
 - 5 BUSHING : TINPLATED STEEL (INNER THREAD 4-40 UNC OR M3 OR 3,1 DIA THRU-HOLE)
 - 6 BRACKET : TINPLATED STEEL
 - 7 BOARDLOCK : TINPLATED PHOSPHORBRONZE
 - 8 POST ALIGNMENTPLATE : GLASSFILLED POLYESTER, COLOR : BLACK

-				CUSTOMER DRAWING FOR REFERENCE ONLY WILL NOT BE UPDATED			
-				© COPYRIGHT 19 - BY AMP-HOLLAND B.V. ALL INTERNATIONAL RIGHTS RESERVED. AMP PRODUCTS MAY BE COVERED BY U.S. AND FOREIGN AND/OR PATENTS PENDING. THIS DRAWING IS UNPUBLISHED RELEASED FOR PUBLICATION ,19			
-				AMP AMP-HOLLAND B.V. 's-Hertogenbosch, The Netherlands.			
E	EH-1417-99	T.K.	W.C.	19-02-00	NAME	HDP-20 SIZE 1	
D	EH-0033-99	D.K.	W.S.	25 JAN 99	RIGHT ANGLE RECEPTACLE HEADER; EUROSTYLE+ WITH BOARDLOCKS		
LTR.	REVISION RECORD	DR.	CHK.	DATE			
DR.:	D.KESSLER	CHK.:	W.SOOMERS	APP.:	W.SOOMERS	DWG.No.	REV.LTR.
DATE:	25-01-99	DATE:	18/01/99	DATE:	-	C-188025	E
	11		10		9		1 of 1
			8		7		A2
			6		5		
			4		3		
			2		1		