

1

2

3

4

5

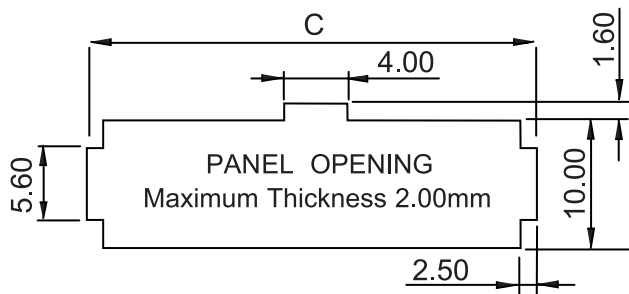
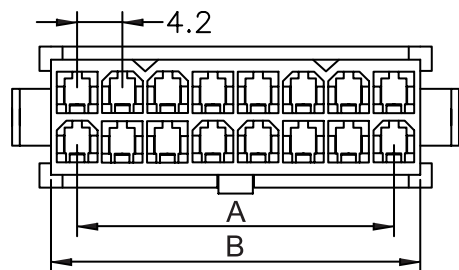
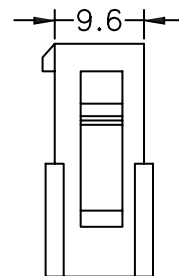
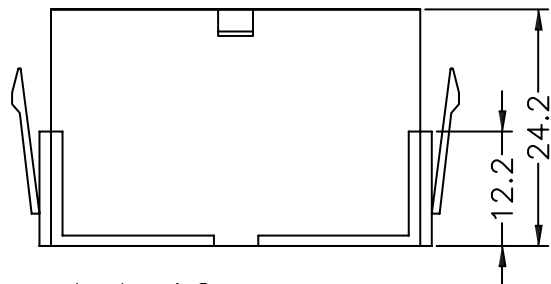
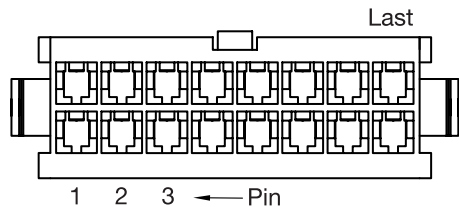

TECHNICAL CHARACTERISTICS

MATERIAL
INSULATOR: NYLON 66
FLAMABILITY RATING: UL94-V0
COLOR: WHITE
PITCH: 4.20MM

ENVIRONMENTAL
OPERATING TEMPERATURE: -40 UP TO 105°C
COMPLIANCE: LEAD FREE AND ROHS

ELECTRICAL
CURRENT RATING: 6 TO 9A

NB CIRCUITS □	2-3 □	4-6 □	7-10 □	12-24
AMPERES □	9 □	8 □	7 □	6

WORKING VOLTAGE: 600V AC
INSULATOR RESISTANCE: >1000 MOHM
DIELECTRIC WITHSTANDING VOLTAGE: 1500VAC/MN

STANDARD
 CERTIFIED: E323964 / MODEL NUMBER 649-218

SOLDERING
WAVE PROCESS ONLY

PACKAGING
BAG

DIMENSION
A = 4.20 x (NB PIN / 2 - 1)
B = 4.20 x (NB PIN / 2) + 1.30
C = 4.20 x (NB PIN / 2) + 6.60

RoHS Compliant

PROJECTION:

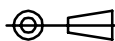

GENERAL TOLERANCE

.X = +/- 0.2

.XX = +/- 0.15



APPROVAL: RJ

UNIT: MM

DESCRIPTION: 4.20MM MALE DUAL ROW PLUG WITH PANEL MOUNT EARS

SIZE

18-NOV-09 □

STANDARD

JP

SCALE:

WERI PART NO: 649 0xx 218 22

A4

24-JUN-09 □

BAG PACKAGING

JP □

SHEET: 1/2

REV

DATE

FILE

BY

DRAW: DAVID

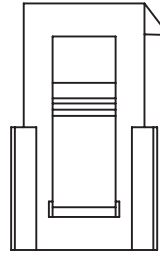
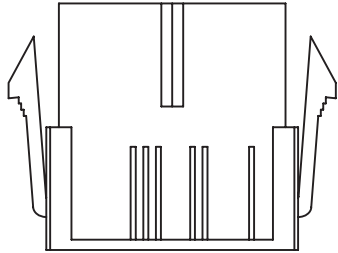
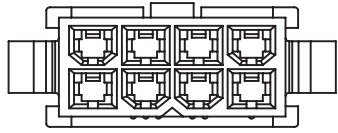

Note:

1.Dimension:

Carton Size:40*28*28(cm)

2.Quantity:

Pin.	Pcs/Bag	Pcs/Carton	Pin.	Pcs/Bag	Pcs/Carton
2	1000	7000	14	300	1500
4	1000	4000	16	250	1250
6	500	3000	18	200	1000
8	500	2500	20	200	1000
10	500	2000	22	100	800
12	400	1600	24	100	700

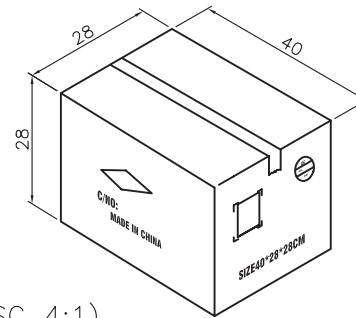
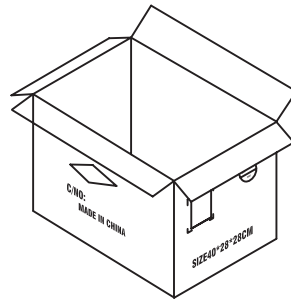
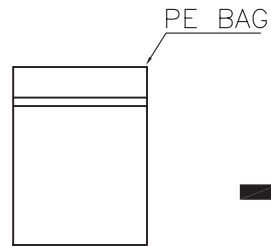

Carton (SC 4:1)

RoHS Compliant			
G			
F			
E			
D			
C			
B			
A			
REV	DATE	FILE	BY

PROJECTION:

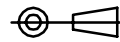

APPROVAL: RJ

GENERAL TOLERANCE

.X = +/- 0.2

.XX = +/- 0.15

UNIT: MM

SCALE:

SHEET: 2/2

DRAW: PEARL



DESCRIPTION: 4.20MM MALE DUAL ROW PLUG WITH PANEL MOUNT EARS

WERI PART NO: 6490 xx 21822_TPK

SIZE

A4