



Hosiden Besson Ltd
 St. Joseph's Close
 Brighton & Hove
 East Sussex BN3 7EZ
 England
 Tel: +44 1273 861166
 Fax: +44 1273 777501
 Email: info@hbl.co.uk
 www.hbl.co.uk

product Bleeptone™ Range sheet

- Rugged, reliable, versatile
- Wide range of applications including medical
- Panel mounted sounders

The well established Bleeptone range are small, rugged and reliable with economical solid state circuitry and easy mounting.

Hosiden Besson have been manufacturing Bleeptones for in excess of 40 years and they are ideal for a wide range of applications from medical equipment to metal detectors where quality and consistency are important. They have established themselves over this period as probably the most reliable and versatile sounder on the market today.

Standard models will tolerate reasonable environmental conditions. If extra protection is required, we can tropicalise the larger Bleeptone unit to the same high standard as our range of military-approved microphones and receivers.

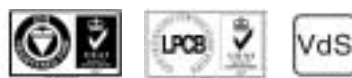

4711000/02	Bleeptone	6V 1kHz
4713000/02	Bleeptone	12V 1kHz
4713100/02	Bleeptone	12V 2k5Hz
4716000/02	Bleeptone	24V 1kHz
4716100/02	Bleeptone	24V 2k5Hz

Bleptone™ Range

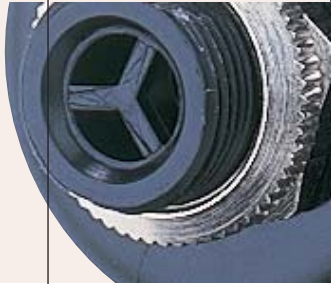

Technical Specification

Bleptone

Single sound unit with choice of two frequencies.

Voltage:	3V, 6V, 12V or 24V DC +/-30%
Current Consumption:	Typically 10mA at 6V, 7mA at 12V and 4mA at 24V.
Frequency:	2.5kHz or 1.0kHz (both +/-20%, at nominal voltage)
Output:	2.5kHz – 75dBA* +/-5dBA. 1.0kHz – 65dBA* +/-5dBA.
Insulation:	>250V mounting panel to circuit.
Temperature:	-40°C to +70°C. (Tropical protection available at extra cost).
Weight:	43 grams typical.
Mounting:	Ring, Horn.

*Measured in decibels relative to $2 \times 10^{-5} \text{N/M}^2$, all measurements taken in free field conditions 1 metre from measuring microphone.

Minibleptone 525

Multi-voltage unit featuring built-in panel mounting and low current consumption. High or low sound frequency option via third wire.

Voltage Range:	5-30v DC. May also be operated from an AC supply up to 20V RMS.
Insulation:	>500V mounting panel to circuit.
Frequency:	800Hz +/- 20% (modulated high note) or 4.0kHz +10%/-20%.
Polarity:	Fully protected against polarity reversal.
Connections:	3 flying leads 250mm long. Red - Positive (+) Black - Negative (-) White - Connect to Positive for high frequency, or to Negative for low frequency.
Temperature Range:	-40°C to +70°C.
Weight:	18 grams typical.
Mounting:	Self contained 'Single Hole' mounting with chromed lock ring.

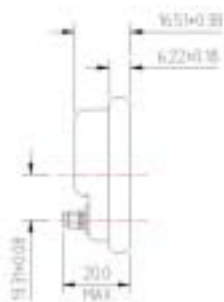

Current Consumption:

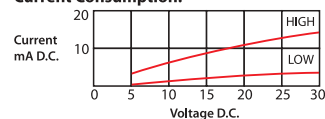

Output:

