

Introducing the NEW BuildPro™ Welding Table

Reduce set-up time, and increase productivity with the affordable, easy-to-use BuildPro™ Welding Table.



Better Tools. Better Price.™

Catalog #810
Innovative Welding/Industrial
Clamps, Work Tables, Pliers, and Magnets



Visit us online at
www.stronghandtools.com

Distributed By



7141 Paramount Blvd., Pico Rivera, CA 90660
Toll Free:: 800.989.5244, Tel: 562.949.8625, Fax: 562.949.4875

© Copyright 2008, StrongHandTools™





U.S.A. Corporate Headquarters



Factory



Machine Shop



Better Tools. Better Price.™

Innovative Welding/Industrial Clamps, Work Tables, Pliers, and Magnets

Save Time & Money

Strong Hand Tools are designed to reduce set-up time in all of your workholding applications. Developed by customer demand, and tested in the field by professional craftsmen, Strong Hand Tools™ provide an easier, safer, faster way to complete your work. Plus, Strong Hand Tools™ are always affordably priced, so you save money when you buy them, and when you use them.

Strong Hand Tools™ Features and Benefits

- Strong Hand Tools™ are multi-functional, serving more than just one application.
- All of our Clamps are “Quick Acting” for the fastest set-up.
- Strong Hand Tools™ are modular, with interchangeable accessories, so you get the most for Your Money.
- Strong Hand Tools™ Clamps are always economy-priced, so they always fit Your Budget.
- Our products can be purchased through distributors worldwide.

Mission Statement

At Strong Hand Tools™ we remain dedicated to designing the most innovative, time-saving, money-saving workholding tools to improve your efficiency, productivity, competitiveness, and profitability. Strong Hand Tools™ will always be priced affordably, to create real value, both at the time of purchase, and in the usage of the tool. We will continue to innovate, drawing new ideas from our field research, our engineering staff, and our valued customers. We'll use this idea base to continually expand our capabilities, and offer a steady stream of highly useful, relevant, and affordable new products. Building mutually beneficial relationships with our Strong Hand Tools™ employees and customers, is the basis of our strength, our success and our future, and constantly working towards a harmonious relationship, where all feel valued and appreciated, will remain our highest priority.

Table of Contents	Page
4-IN-1™ Utility™ Clamps	1
Utility™ Clamps	2, 3
Ratchet Action Clamps	4
MagSpring™ Clamps	5
Adjust-O™ Magnet Squares	6, 7
Mag-Level™	8
JointMaster™ Angle Joining Tools	9
Improved Locking C-Clamps	10
Multi-Purpose™ Pliers	11
Pipe Pliers	12
Nomad™ Welding Table	13
Grounding Clamps	14
Shark Clamps™	15
Welders Angle Clamps	16
New Products	17
Valtra Components	18
Toggle Clamps	19, 20
Accessories	21, 22

Contact Information

Toll Free: 800.989.5244
 Tel: 562.949.8625
 Fax: 562.949.4875

sales@stronghandtools.com
 www.stronghandtools.com

Corporate Headquarters:
 7141 Paramount Blvd.
 Pico Rivera, CA 90660 U.S.A.

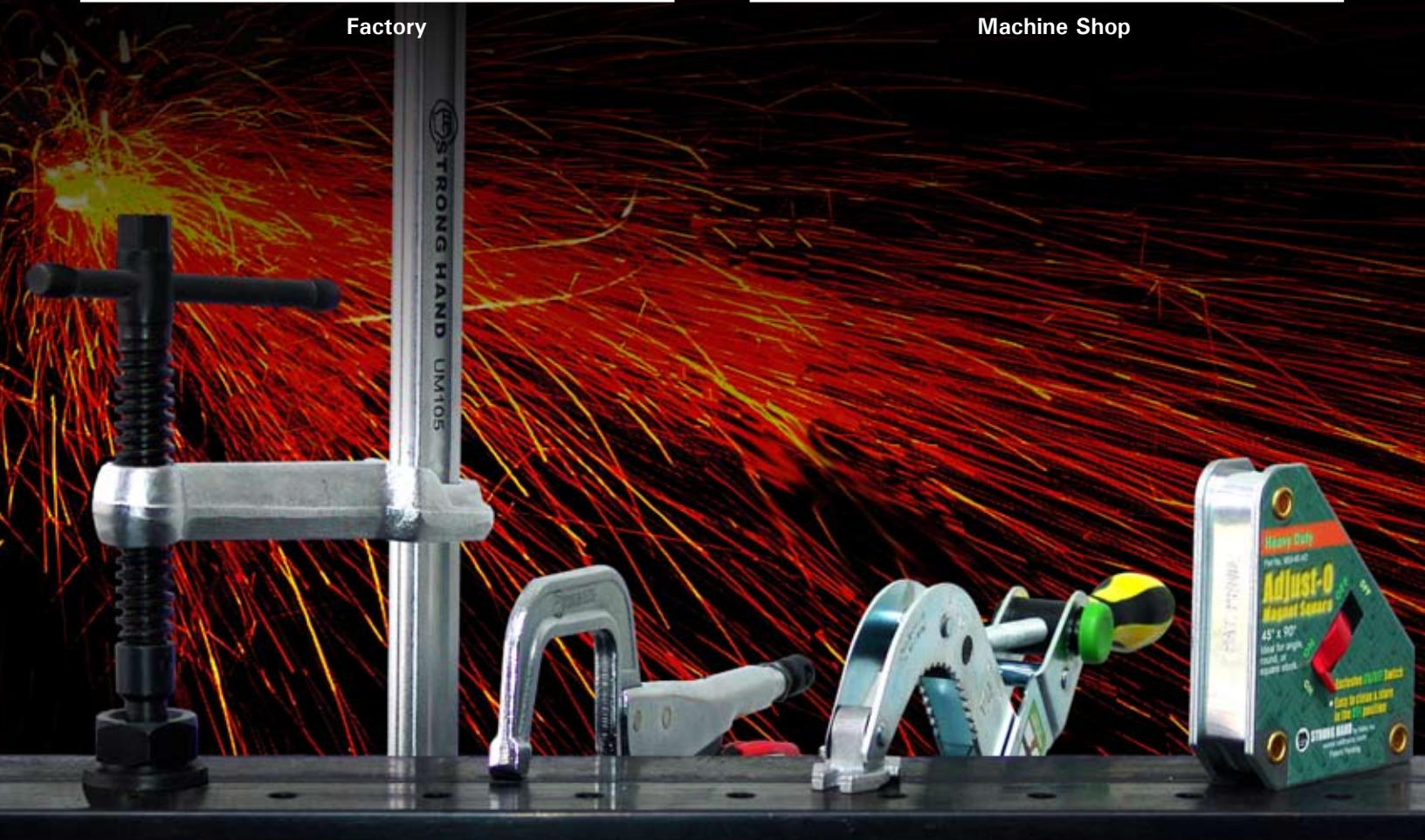



4-IN-1 Utility Clamp Kits

The most versatile Sliding Arm Clamp on the market.

Spring Loaded Stop allows Removal and Reversal of Clamp Arm for Spreading Applications



The strong, economical 4-IN-1 Clamp adapts to serve four different applications. Save set-up time and money.



Standard
The Sliding Arm Clamp is 10x faster than a C-Clamp!



Pipe
Add the exclusive V-Pad to create a Pipe Clamp!



Spreader
Slide the clamp arm OFF and reverse, to create a Spreader Clamp.

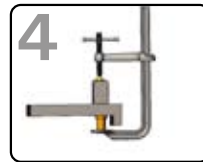

Step-Over
Add the Extender Block to create a Step-Over Clamp.

4-IN-1 Utility Clamp Kits - Clamp with V-Pad and Extender Block

Part No.	Capacity	Throat Depth	Clamping Pressure	Rail Size	Tapped Hole
UD45-C3 UD45M-C3	4-1/2" 114 mm	3-1/4" 83 mm	500 lbs 230 kg	5/8" x 5/16" 16 mm x 8	5/16-18 M8
UD65-C3 UD65M-C3	6-1/2" 165 mm	3-1/4" 83 mm	500 lbs 230 kg	5/8" x 5/16" 16 mm x 8	5/16-18 M8
UF65-C3 UF65M-C3	6-1/2" 165 mm	4-3/4" 121 mm	1,000 lbs 460 kg	7/8" x 7/16" 22 mm x 11	3/8-16 M10
UG85-C3 UG85M-C3	8-1/2" 216 mm	4-3/4" 121 mm	1,200 lbs 550 kg	1" x 15/32" 25 mm x 12	3/8-16 M10
UG125-C3 UG125M-C3	12-1/2" 318 mm	4-3/4" 121 mm	1,200 lbs 550 kg	1" x 15/32" 25 mm x 12	3/8-16 M10
UG1257-C3 UG1257M-C3	12-1/2" 318 mm	7" 178 mm	800 lbs 350 kg	1" x 15/32" 25 mm x 12	3/8-16 M10
UM85P-C3 UM85PM-C3	8-1/2" 216 mm	5-1/2" 140 mm	2,400 lbs 1,100 kg	1-3/16" x 9-16" 30 mm x 14	3/8-16 M10
UM105P-C3 UM105PM-C3	10-1/2" 267 mm	5-1/2" 140 mm	2,400 lbs 1,100 kg	1-3/16" x 9-16" 30 mm x 14	3/8-16 M10
UM125-C3 UM125M-C3	12-1/2" 318 mm	5-1/2" 140 mm	2,400 lbs 1,100 kg	1-3/16" x 9-16" 30 mm x 14	3/8-16 M10
UM165-C3 UM165M-C3	16-1/2" 419 mm	5-1/2" 140 mm	2,400 lbs 1,100 kg	1-3/16" x 9-16" 30 mm x 14	3/8-16 M10
UM205-C3 UM205M-C3	20-1/2" 521 mm	5-1/2" 140 mm	2,400 lbs 1,100 kg	1-3/16" x 9-16" 30 mm x 14	3/8-16 M10
UP205-C3 UP205M-C3	20-1/2" 521 mm	7" 178 mm	4,800 lbs 2,200 kg	1-9/16" x 3/4" 40 mm x 19	3/8-16 M10

Applications



Standard Clamping



Pipe Clamping with V-Pad



Spreader Clamp



Step-Over Clamping with Extender Block



Standard V-Pad*(A)



Extender Blocks*(E)

» Create your own 4-in-1 Clamp Kit with the V-Pad & Extender Block Accessory Pack (See accessories page)

Regular Duty - 2,400 lbs (1,100 kg) Clamping Pressure, Heavy Duty Pads

Part No.	Capacity	Throat Depth	Clamping Pressure	Rail Size	Pad	Tapped Hole	Weight
UM65 UM65M	6-1/2" 165 mm	5-1/2" 140 mm	2,400 lbs 1,100 kg	1-3/16" x 9/16" 30 mm x 14	Heavy Duty	3/8-16 M10	5.4 lbs 2.5 kg
UM85 UM85M	8-1/2" 216 mm	5-1/2" 140 mm	2,400 lbs 1,100 kg	1-3/16" x 9/16" 30 mm x 14	Heavy Duty	3/8-16 M10	5.9 lbs 2.7 kg
UM105 UM105M	10-1/2" 267 mm	5-1/2" 140 mm	2,400 lbs 1,100 kg	1-3/16" x 9/16" 30 mm x 14	Heavy Duty	3/8-16 M10	6.4 lbs 2.9 kg
UM125 UM125M	12-1/2" 318 mm	5-1/2" 140 mm	2,400 lbs 1,100 kg	1-3/16" x 9/16" 30 mm x 14	Heavy Duty	3/8-16 M10	6.5 lbs 3.0 kg
UM165 UM165M	16-1/2" 419 mm	5-1/2" 140 mm	2,400 lbs 1,100 kg	1-3/16" x 9/16" 30 mm x 14	Heavy Duty	3/8-16 M10	7.6 lbs 3.5 kg
UM205 UM205M	20-1/2" 521 mm	5-1/2" 140 mm	2,400 lbs 1,100 kg	1-3/16" x 9/16" 30 mm x 14	Heavy Duty	3/8-16 M10	8.7 lbs 4.0 kg

Regular Duty
2,400 lbs (1,100 kg)
Clamping Pressure



Heavy Duty - 4,800 lbs (2,200 kg) Clamping Pressure, Heavy Duty Pads

Part No.	Capacity	Throat Depth	Clamping Pressure	Rail Size	Pad	Tapped Hole	Weight
UP125 UP125M	12-1/2" 318 mm	7" 178 mm	4,800 lbs 2,200 kg	1-9/16" x 3/4" 40 mm x 19	Heavy Duty	3/8-16 M10	12.3 lbs 5.6 kg
UP165 UP165M	16-1/2" 419 mm	7" 178 mm	4,800 lbs 2,200 kg	1-9/16" x 3/4" 40 mm x 19	Heavy Duty	3/8-16 M10	13.6 lbs 6.2 kg
UP205 UP205M	20-1/2" 521 mm	7" 178 mm	4,800 lbs 2,200 kg	1-9/16" x 3/4" 40 mm x 19	Heavy Duty	3/8-16 M10	15.0 lbs 6.8 kg
UP245 UP245M	24-1/2" 622 mm	7" 178 mm	4,800 lbs 2,200 kg	1-9/16" x 3/4" 40 mm x 19	Heavy Duty	3/8-16 M10	16.5 lbs 7.5 kg
UP315 UP315M	31-1/2" 800 mm	7" 178 mm	4,800 lbs 2,200 kg	1-9/16" x 3/4" 40 mm x 19	Heavy Duty	3/8-16 M10	16.8 lbs 7.6 kg
UP405 UP405M	40-1/2" 1,029 mm	7" 178 mm	4,800 lbs 2,200 kg	1-9/16" x 3/4" 40 mm x 19	Heavy Duty	3/8-16 M10	22.0 lbs 10.0 kg

Heavy Duty
4,800 lbs (2,200 kg)
Clamping Pressure



Value Series - 2,400 lbs (1,100 kg) Clamping Pressure, Standard Pads

Part No.	Capacity	Throat Depth	Clamping Pressure	Rail Size	Pad	Tapped Hole	Weight
UM85P UM85PM	8-1/2" 216 mm	5-1/2" 140 mm	2,400 lbs 1,100 kg	1-3/16" x 9/16" 30 mm x 14	Standard	3/8-16 M10	5.7 lbs 2.9 kg
UM105P UM105PM	10-1/2" 267 mm	5-1/2" 140 mm	2,400 lbs 1,100 kg	1-3/16" x 9/16" 30 mm x 14	Standard	3/8-16 M10	6.3 lbs 3.0 kg
UM125P UM125PM	12-1/2" 318 mm	5-1/2" 140 mm	2,400 lbs 1,100 kg	1-3/16" x 9/16" 30 mm x 14	Standard	3/8-16 M10	6.4 lbs 3.1 kg

Value Series
2,400 lbs (1,100 kg)
Clamping Pressure



Clip on Top V-Pad*
For Standard Pad



Screw on Top V-Pad*
For Heavy Duty Pad

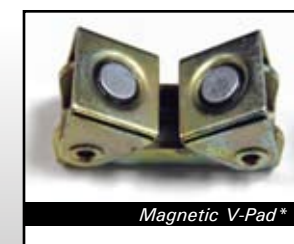

Magnetic V-Pad*



Side-Kick*

* Refer to Accessories Chart

Light Duty Series - 500 - 1,200 lbs (230 - 550 kg) Clamping Pressure, Standard Pads

Light Duty
500 - 1,200 lbs
(230 - 550 kg)
Clamping Pressure



UD Series with Key Ring Stop



UE, UF, UG Series with Spring Stop



Heavy Duty Pad



Standard Pad

Part No.	Capacity	Throat Depth	Clamping Pressure	Rail Size	Pad	Tapped Hole	Weight
UD45 UD45M	4-1/2" 114 mm	3-1/4" 83 mm	500 lbs 230 kg	5/8" x 5/16" 16 mm x 8	Standard	5/16-18 M8	1.0 lbs 0.4 kg
UD65 UD65M	6-1/2" 165 mm	3-1/4" 83 mm	500 lbs 230 kg	5/8" x 5/16" 16 mm x 8	Standard	5/16-18 M8	1.1 lbs 0.5 kg
UD85 UD85M	8-1/2" 216 mm	3-1/4" 83 mm	500 lbs 230 kg	5/8" x 5/16" 16 mm x 8	Standard	5/16-18 M8	1.2 lbs 0.6 kg
UE85 UE85M	8-1/2" 216 mm	4" 102 mm	850 lbs 390 kg	25/32" x 3/8" 20 mm x 10	Standard	3/8-16 M10	2.3 lbs 1.1 kg
UE125 UE125M	12-1/2" 318 mm	4" 102 mm	850 lbs 390 kg	25/32" x 3/8" 20 mm x 10	Standard	3/8-16 M10	2.5 lbs 1.2 kg
UE165 UE165M	16-1/2" 419 mm	4" 102 mm	850 lbs 390 kg	25/32" x 3/8" 20 mm x 10	Standard	3/8-16 M10	2.8 lbs 1.3 kg
UE205 UE205M	20-1/2" 521 mm	4" 102 mm	850 lbs 390 kg	25/32" x 3/8" 20 mm x 10	Standard	3/8-16 M10	3.0 lbs 1.4 kg
UE245 UE245M	24-1/2" 622 mm	4" 102 mm	850 lbs 390 kg	25/32" x 3/8" 20 mm x 10	Standard	3/8-16 M10	3.4 lbs 1.6 kg
UF65 UF65M	6-1/2" 165 mm	4-3/4" 121 mm	1,000 lbs 460 kg	7/8" x 7/16" 22 mm x 11	Standard	3/8-16 M10	2.4 lbs 1.1 kg
UF100 UF100M	10" 254 mm	4-3/4" 121 mm	1,000 lbs 460 kg	7/8" x 7/16" 22 mm x 11	Standard	3/8-16 M10	2.8 lbs 1.3 kg
UG85 UG85M	8-1/2" 216 mm	4-3/4" 121 mm	1,200 lbs 550 kg	1" x 15/32" 25 mm x 12	Standard	3/8-16 M10	3.6 lbs 1.6 kg
UG125 UG125M	12-1/2" 318 mm	4-3/4" 121 mm	1,200 lbs 550 kg	1" x 15/32" 25 mm x 12	Standard	3/8-16 M10	4.0 lbs 1.8 kg
UG205 UG205M	20-1/2" 521 mm	4-3/4" 121 mm	1,200 lbs 550 kg	1" x 15/32" 25 mm x 12	Standard	3/8-16 M10	4.8 lbs 2.2 kg
UG1257 UG1257M	12-1/2" 318 mm	7" 178 mm	800 lbs 350 kg	1" x 15/32" 25 mm x 12	Standard	3/8-16 M10	6.0 lbs 2.7 kg
UG1657 UG1657M	16-1/2" 419 mm	7" 178 mm	800 lbs 350 kg	1" x 15/32" 25 mm x 12	Standard	3/8-16 M10	6.5 lbs 3.0 kg
UG2057 UG2057M	20-1/2" 521 mm	7" 178 mm	800 lbs 350 kg	1" x 15/32" 25 mm x 12	Standard	3/8-16 M10	7.0 lbs 3.2 kg

Ratchet Action Utility Clamps

Ratchet mechanism ensures rapid, vibration resistant clamping.

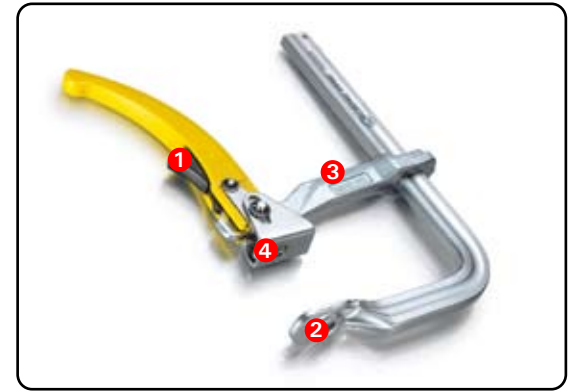
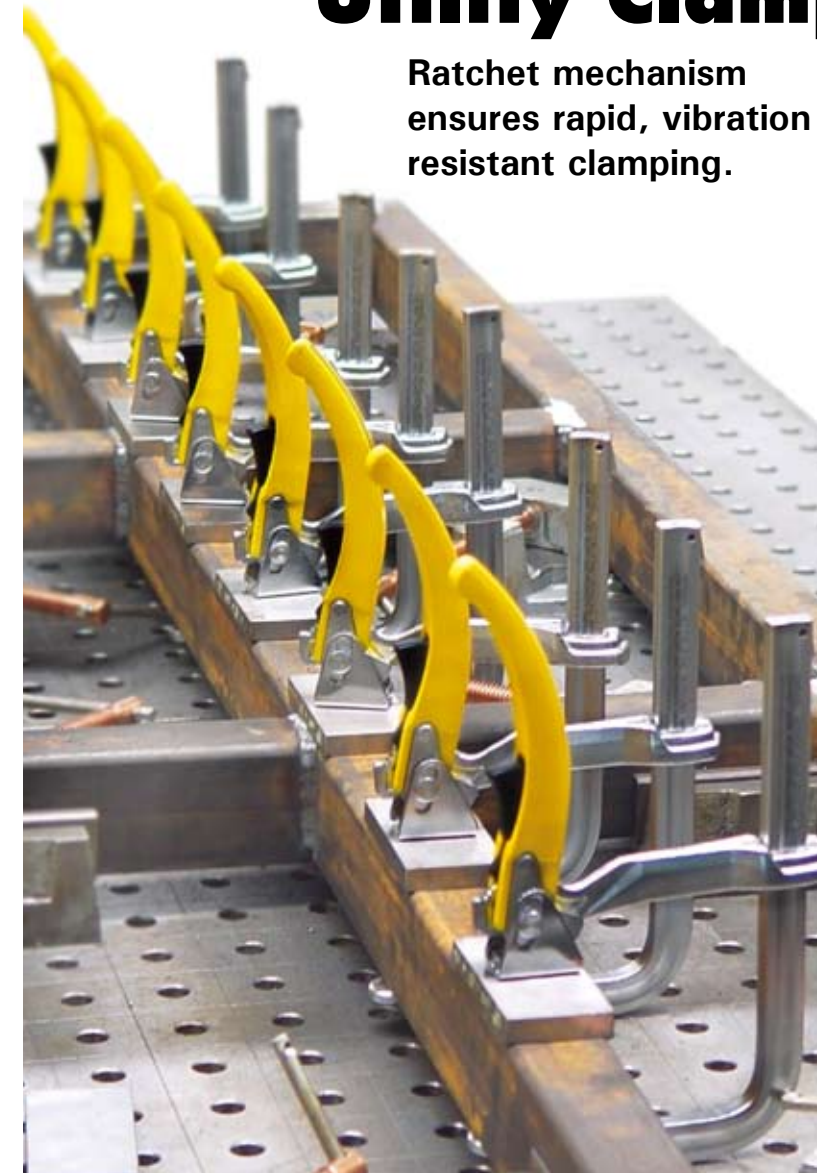

- 1 One-finger rapid release button
- 2 3/8"-16 (M10) threaded hole for Accessories
- 3 Removable / Reversible clamp arm for spreading applications
- 4 Pivoting 1-1/2" (38 mm) Contact Plate with 3/8"-16 (M10) threaded hole

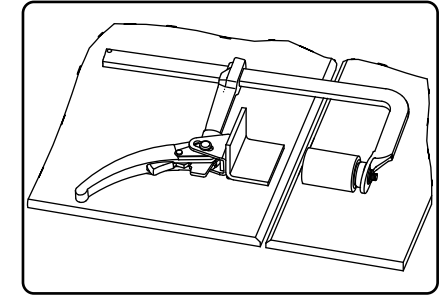

The ideal clamp to use in confined areas

J-Clamp Step-Over Series
500 - 2,400 lbs (230 - 1,100 kg) Clamping Pressure



UD Series with Key Ring Stop



UF, UG, UM Series with Spring Stop

Part No.	Capacity	Throat Depth (Return)	Clamping Pressure	Rail Size	Pad	Tapped Hole	Weight
UD45J UD45JM	4-1/2" 114 mm	3-1/4" (2") 83 mm (51)	500 lbs 230 kg	5/8" x 5/16" 16 mm x 8	Standard	5/16-18 M8	1.2 lbs 0.6 kg
UF100J UF100JM	10" 267 mm	4-3/4" (3") 121 mm (76)	1,000 lbs 460 kg	7/8" x 7/16" 22 mm x 11	Standard	3/8-16 M10	3.2 lbs 1.5 kg
UG105J UG105JM	10-1/2" 267 mm	4-3/4" (4") 121 mm (121)	1,200 lbs 550 kg	1" x 15/32" 25 mm x 12	Standard	3/8-16 M10	5.0 lbs 2.3 kg
UM125J UM125JM	12-1/2" 318 mm	5-1/2" (4") 140 mm (121)	2,400 lbs 1,100 kg	1-3/16" x 9-16" 30 mm x 14	Heavy Duty	3/8-16 M10	8.2 lbs 3.7 kg

Part No.	Capacity	Throat Depth	Clamping Pressure	Rail Size	Tapped Hole	Weight
UF65R UF65RM	7" 178 mm	4-3/4" 121 mm	1,000 lbs 460 kg	7/8" x 7/16" 22 mm x 11	3/8-16 M10	2.6 lbs 1.2 kg
UF100R UF100RM	10" 254 mm	4-3/4" 121 mm	1,000 lbs 460 kg	7/8" x 7/16" 22 mm x 11	3/8-16 M10	3.0 lbs 1.3 kg
UF100JR UF100JRM	10" 254 mm	4-3/4" (3 Return) 121 mm (76)	1,000 lbs 460 kg	7/8" x 7/16" 22 mm x 11	3/8-16 M10	3.1 lbs 1.4 kg
UG85R UG85RM	8-1/2" 216 mm	4-3/4" 121 mm	1,200 lbs 550 kg	1" x 15/32" 25 mm x 12	3/8-16 M10	3.6 lbs 1.6 kg
UG125R UG125RM	12-1/2" 318 mm	4-3/4" 121 mm	1,200 lbs 550 kg	1" x 15/32" 25 mm x 12	3/8-16 M10	4.0 lbs 1.8 kg
UG205R UG205RM	20-1/2" 521 mm	4-3/4" 121 mm	1,200 lbs 550 kg	1" x 15/32" 25 mm x 12	3/8-16 M10	4.8 lbs 2.2 kg

Ratchet Action
1,000 - 1,200 lbs
(460 - 550 kg)
Clamping Pressure



NEW **MagSpring™**
Sliding Arm Clamps

The Fast, Easy to Use, Spring-loaded, one-handed clamp with quick-set magnetic V-Pad!

Features

- Spring Loaded Arm allows users to free up one hand to position the workpiece.
- Once positioned, the Adjustable Magnetic Pad holds the clamp to the workpiece for tightening.
- Made of heat treated steel and nickel/chrome plated for strength and durability.
- Tapped Hole for Additional Accessories

Quick & Easy to Use!

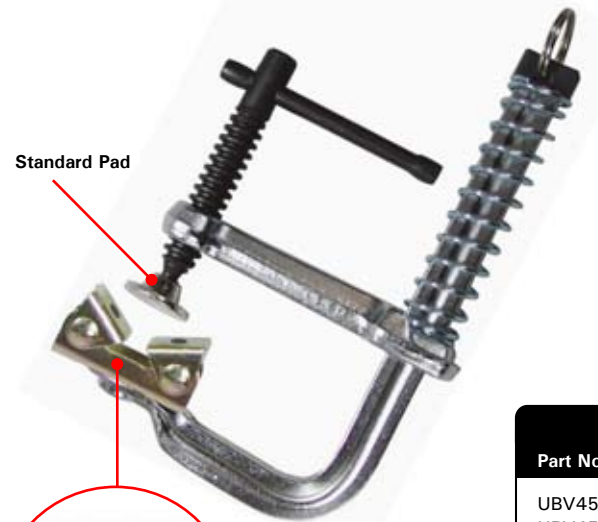
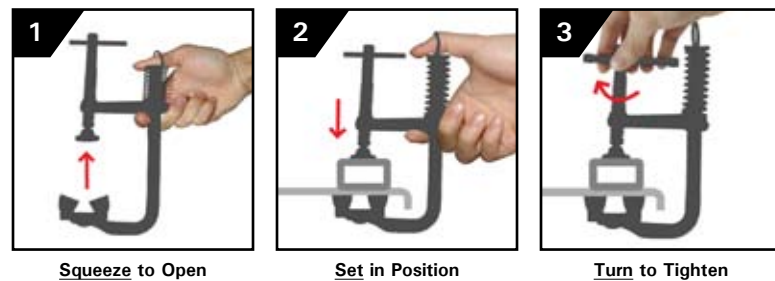

Adjustable Magnetic V-Pad
Instantly adjust for different shapes: Round, Flat, or Square metal surfaces!

Part No.	Capacity	Throat Depth	Clamping Pressure	Rail Size	Tapped Hole	Weight
UBV45	3-1/2"	2-1/2"	300 lbs	1/2" x 1/4"	1/4-20	0.8 lbs
UBV45M	90 mm	64 mm	140 kg	13 mm x 6	M6	0.4 kg
UBV65	5-1/2"	2-1/2"	300 lbs	1/2" x 1/4"	1/4-20	0.9 lbs
UBV65M	140 mm	64 mm	140 kg	13 mm x 6	M6	0.4 kg
UDV45	3-1/2"	3-1/4"	500 lbs	5/8" x 5/16"	15/16-18	1.0 lbs
UDV45M	90 mm	89 mm	230 kg	16 mm x 8	M8	0.5 kg
UDV65	5-1/2"	3-1/4"	500 lbs	5/8" x 5/16"	15/16-18	1.1 lbs
UDV65M	140 mm	89 mm	230 kg	16 mm x 8	M8	0.5 kg

Wood Straight Handle



Wood Straight Handle
- Clamping Pressure: 840 lbs (380 kg)
- Throat Depth: 4" (102 mm)
- Rail Size: 3/4" x 3/8" (20 mm x 10)
- Tapped Hole: 3/8-16 (M10)
- Standard Pads

Part No.	Capacity	Weight
UE85W	8-1/2" 216 mm	2.2 lbs 1.0 kg
UE125W	12-1/2" 318 mm	2.6 lbs 1.2 kg
UE205W	20-1/2" 521 mm	3.4 lbs 1.6 kg
UE245W	24-1/2" 622 mm	3.8 lbs 1.7 kg



Non-Marring Pads
See Accessories Page



Economy Light Duty Straight Handle
- Clamping Pressure: 300 lbs (140 kg)
- Throat Depth: 2-1/2" (64 mm)
- Rail Size: 1/2" x 1/4" (13 mm x 6)
- Tapped Hole: 1/4-20 (M6)
- Standard Pads

Part No.	Capacity	Weight
UB45A	4-1/2"	0.8 lbs
UB45AM	114 mm	0.4 kg
UB65A	6-1/2"	0.9 lbs
UB65AM	165 mm	0.4 kg
UB85A	8-1/2"	1.0 lbs
UB85AM	216 mm	0.5 kg
UB105A	10-1/2"	1.1 lbs
UB105AM	267 mm	0.5 kg
UB125A	12-1/2"	1.2 lbs
UB125AM	318 mm	0.6 kg
UB165A	16-1/2"	1.3 lbs
UB165AM	419 mm	0.6 kg
UB205A	20-1/2"	1.4 lbs
UB205AM	521 mm	0.6 kg

Adjust-O Magnet Squares

Featuring the Original On/Off Switch

Patent No. US 7,009,480 B2

Adjust-O Magnet Squares

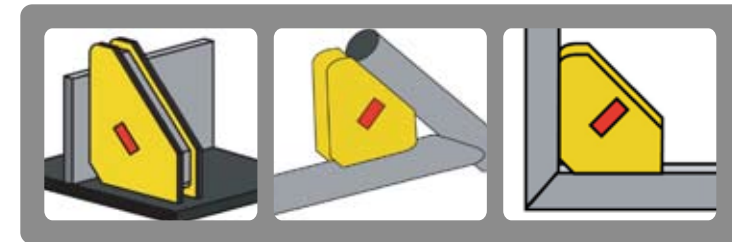
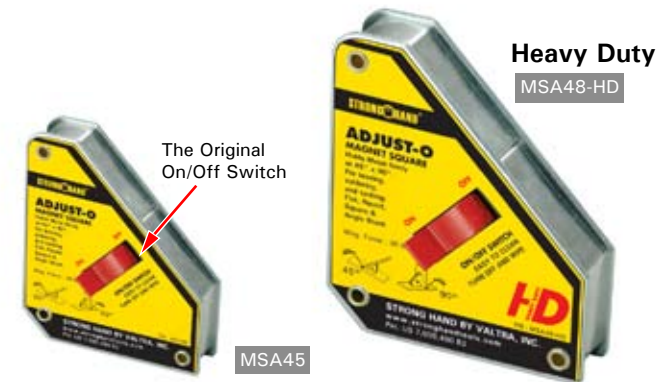

Metal Plates Round Tubing/Pipe Square Tubing

Features

- The fast and easy way to hold metal workpieces at 45° & 90°.
- Turn the magnet Off when setting up, turn On when you're ready to work. Easy and safe set-up!
- Easy to clean! Turn the magnet Off and wipe.
- Ideal for round and square tubing, angle, and flat stock.
- Pull forces from 50 lbs to 140 lbs.
- Strong and Durable Rare Earth Magnets

Part No.	Angles	Dimension	Pull Force	Weight
MSA45	45° x 90°	4-3/8" x 3-3/4" x 1" 111 mm x 95 x 25	50 lbs 25 kg	1.0 lbs 0.5 kg
MSA46-HD*	45° x 90°	4-3/8" x 3-3/4" x 1-1/8" 111 mm x 95 x 29	80 lbs 35 kg	1.5 lbs 0.7 kg
MSA47	45° x 90°	6" x 5-1/8" x 1-1/4" 152 mm x 130 x 32	75 lbs 35 kg	2.2 lbs 1.0 kg
MSA48-HD*	45° x 90°	6" x 5-1/8" x 1-3/8" 152 mm x 130 x 35	140 lbs 65 kg	3.0 lbs 1.4 kg
MSA53-HD	30°/60° x 45° x 90°	6" x 5-1/8" x 1-3/8" 152 mm x 130 x 35	127 lbs - 140 58 kg - 65	3.0 lbs 1.4 kg

*HD- Heavy Duty Version

Multiple Angles at
30°, 45°, 60°, 90°.



Adjust-O Dual Switch Magnet Squares

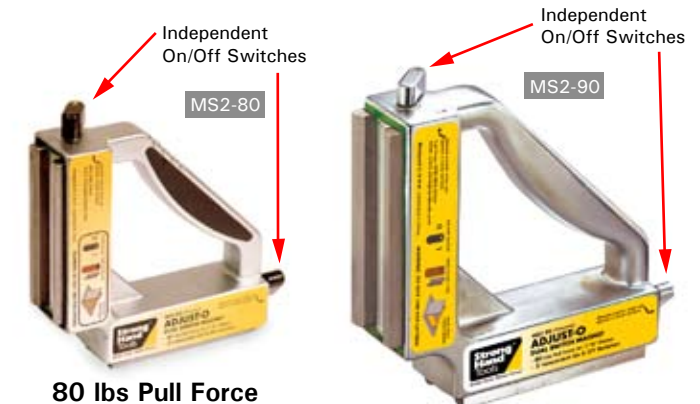

80 lbs Pull Force

150 lbs Pull Force

Features

For professional jobs that demand strong hold down forces. Hold flat and round metal work pieces.

- Rare Earth magnets
- Precision Machined Flat and V-Surfaces
- 2 On / Off Switches
- Easy to clean! Turn the magnet Off and wipe.
- Ideal for round and square tubing, angle, and flat stock.

Part No.	Angles	Dimension	Pull Force	Weight
MS2-80	90°	6" x 6" x 1-1/2" 152 mm x 152 x 38	80 lbs 35 kg	2.7 lbs 1.2 kg
MS2-90	90°	7-3/4" x 7-3/4" x 1-7/8" 197 mm x 197 x 48	150 lbs 70 kg	6.0 lbs 2.7 kg

* Pull Force varies by material thickness

Adjust-O Angle Magnets & Standard Magnets

Patent No. US 7,009,480 B2

Adjust-O Angle Magnets

Introducing the New Adjust-O Dual Switch Multi Angle Magnet

- Press and hold the Angle Setting Button while moving the arms to the desired angle: 45°, 90°, 60° (120°), or 180°.
- The Magnet smoothly "clicks" into each of the pre-set angle positions.
- Turn the wing nut to "lock-in" the position.

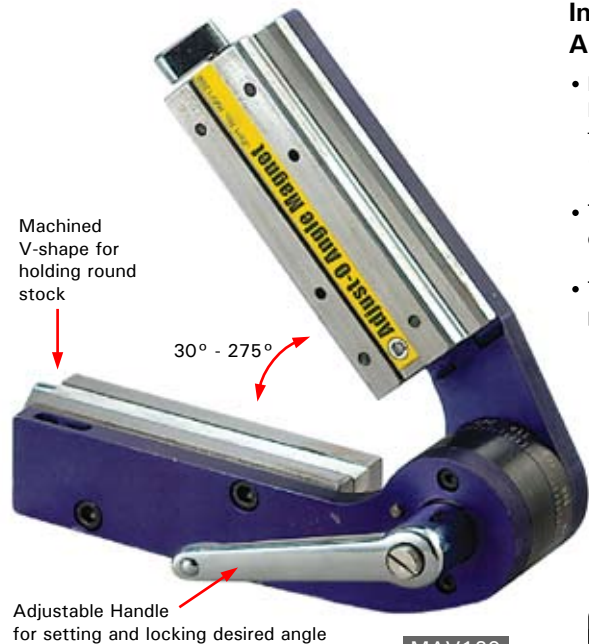

Adjustable Handle for setting and locking desired angle

MAV120

These heavy duty, variable angle magnets combine the convenience of ON / OFF switches with heavy duty magnetic force for professional jobs. Securely hold flat and round workpieces.



Angle Set Button
Positive Locking Wing Nut

NEW

Part No.	Angles	Dimension	Pull Force	Weight
MV100	45°, 90°, 60°(120°), 180°	6-1/4" x 6-1/4" x 2" 159 mm x 159 x 51	80 lbs 35 kg	2.7 lbs 1.2 kg
MAV120	30° - 275°	7-3/4" x 7-3/4" x 3-3/4" 197 mm x 197 x 95	90 lbs 41 kg	5.3 lbs 2.4 kg

Mini Multi Angle Magnets

Patent # D535,577S

Multi Angles
30/60° x 45° x 90°



Part No.	Description	Dimension	Pull Force	Weight
MS346AK	6-Pack	2-5/16" x 2" x 5/8" 59 mm x 51 x 16	25 lbs 10 kg	1.7 lbs 0.8 kg
MS346AT	Twin Pack	2-5/16" x 2" x 5/8" 59 mm x 51 x 16	25 lbs 10 kg	0.6 lbs 0.3 kg

Standard Magnet Squares



Part No.	Angles	Dimension	Pull Force	Weight
MS45	45° x 90°	4-3/8" x 3-3/4" x 3/4" 111 mm x 95 x 19	45 lbs 20 kg	1.0 lbs 0.5 kg
MS60	30°/60° x 90°	4-3/8" x 3-3/4" x 3/4" 111 mm x 95 x 19	45 lbs 20 kg	1.0 lbs 0.5 kg
MS346C	45° x 30°/60° x 90°	5-1/2" x 4-3/8" x 3/4" 140 mm x 29 x 19	45 lbs 20 kg	1.7 lbs 0.8 kg

Mag-Level

Torpedo Mag-Level™

The Use-Anywhere, View-Anywhere magnetic level!

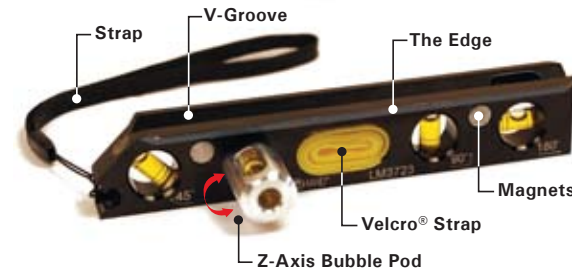

Easily mount onto metal surfaces.



Align cabinets and shelves with ease using the edge.



The 1/4" Edge allows the level to be easily aligned with the side of the workpiece.



Z-Axis Bubble Pod provides accurate leveling of 2-axes. The pod can be rotated for easy viewing from different angles and heights.



Elastic Velcro® Strap Allows the level to be easily attached to non-magnetic surfaces. The strap fits snugly into the hole for safe keeping.



Velcro® strap attaches the level to non-magnetic materials.



Align round workpieces with the V-Groove.

Part No.	Dimension	Weight
LM3723	7" L x 1-1/4" H x 1" W 178 mm x 32 x 25	0.4 lbs 0.2 kg

Mag Level

Patent No. US 7,009,480 B2

Holds securely to both flat & round metal surfaces

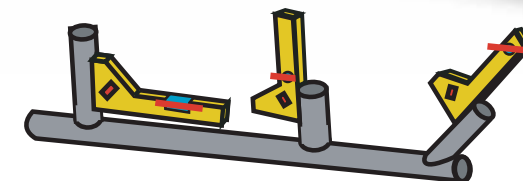
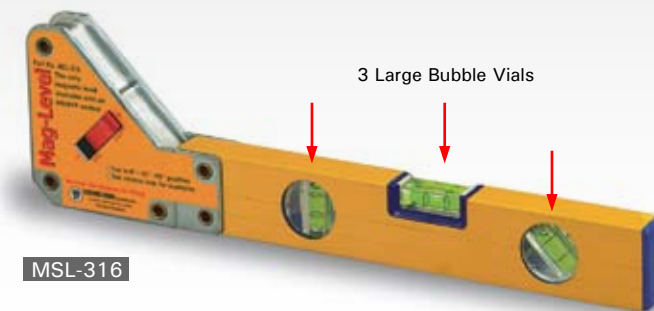

Part No.	Angles	Dimension	Pull Force	Weight
MSL-316	45° x 90° x 180°	4" x 16" x 1" 102 mm x 406 x 25	50 lbs 25 kg	2.0 lbs 0.9 kg

Snake Magnet

Patented

Snake Magnet

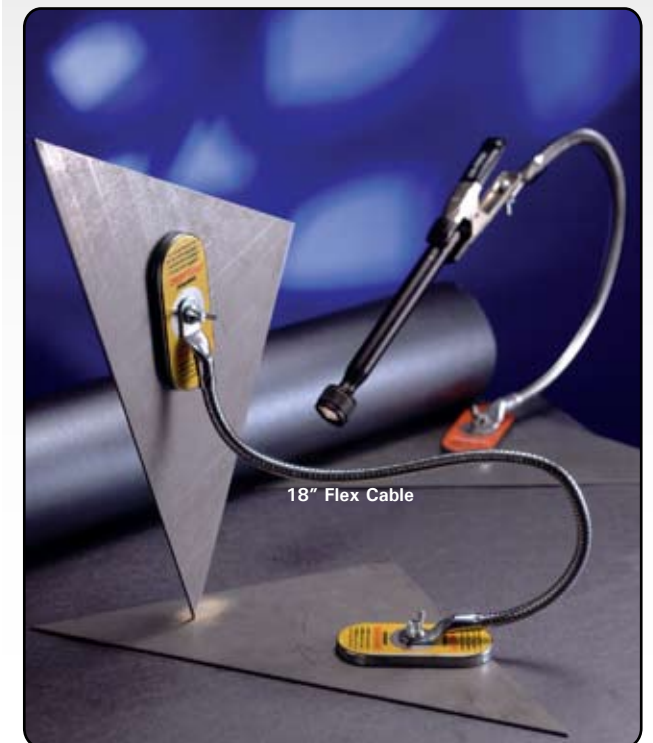

18" Flex Cable



The Third Hand HOLDS, BENDS, TWISTS

The Snake Magnet comes with 2 Magnetic Pads and 1 Spring Clamp that are interchangeable. The 18" Flex Cable is very easy to manipulate and can be bent and twisted to the desired angle.

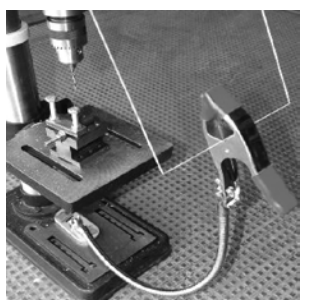

Part No.	Description	Dimension	Pull Force	Weight
MFC318	Any Angle Cable, 2 Mag. Pads, 1 Spring Clamp	18" Cable 460 mm	13 lbs 6 kg	1.4 lbs 0.6 kg

JointMaster™ Angle Joining Tools

PL Series

Right Angle JointMaster™ is a fast, precise and affordable single-hand corner joining tool.

Features:

- Ideal for quick hold and release on wood, metal and synthetic materials.
- A "helping hand" to hold stock firmly at right angles while creating or repairing permanent joints.

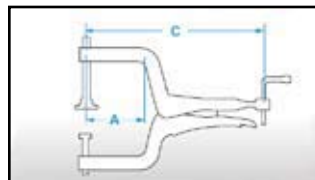

Max. Clamping Pressure: 160 lbs (75 kg)

NOTE

- PL Series comes with 1 pair of Pliers
- PT and PA Series come with 2 pairs of Pliers



PT Series

The 90° Fixed JointMaster™ features a retractable plate for edge alignment, V-Grooves for securely holding round pieces. Ideal for holding two pieces of different thicknesses that require individual adjustments.

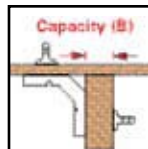

Maximum Capacity (B):
PT622: 1-1/4"
PT634: 3"



PA Series

Position the Adjustable JointMaster™ fixture from 30°-275°. Simply adjust to the desired angle, and "lock" into position using the handle. Join round, or flat workpieces, or materials with different thicknesses.

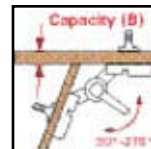

Maximum Capacity (B):
PA622: 1-1/4"
PA634: 3"

Part No.	Throat Depth (A)	Max. Capacity	OAL (C)	Weight
PL622	2"	3/4"	7-1/2"	1.0 lbs
PL622M	51 mm	19 mm	190 mm	0.5 kg
PL634	3"	1-1/4"	8-1/2"	1.1 lbs
PL634M	76 mm	32 mm	216 mm	0.6 kg
PT622	2"	1-1/2"	7-1/2"	1.6 lbs
PT622M	51 mm	38 mm	190 mm	0.7 kg
PT634	3"	3"	8-1/2"	2.5 lbs
PT634M	76 mm	76 mm	216 mm	1.1 kg
PA622	2"	1-1/2"	7-1/2"	2.0 lbs
PA622M	51 mm	38 mm	190 mm	0.9 kg
PA634	3"	3"	8-1/2"	2.4 lbs
PA634M	76 mm	76 mm	216 mm	1.1 kg

Applications



T-Joint at oblique angle



Corner joints

Table Mount C-Clamp



Model PTT934 Shown

Table Mount C-Clamp

The Table Mount C-Clamp mounts directly to your work bench, drill press, etc. The mounting base hole accepts standard 5/16"-18 bolt and uses push-down action to hold your workpiece securely. Use the speedy L-Handle for rapid tightening. Ideal for repetitious clamping.

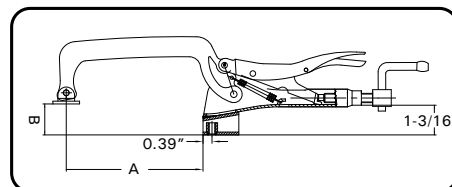

Part No.	Throat Depth (A)	Max. Capacity (B)	Mount Thread	Adjustment Handle	Weight
PTT934	3-3/8" 85 mm	4" 100 mm	5/16-18 M8	M12	1.6 lbs 0.7 kg
PTT956	6-1/8" 155 mm	4-3/4" 120 mm	5/16-18 M8	M12	2.0 lbs 0.9 kg

Improved Locking C-Clamps

Improved features for Professionals and Do-It-Yourselfers

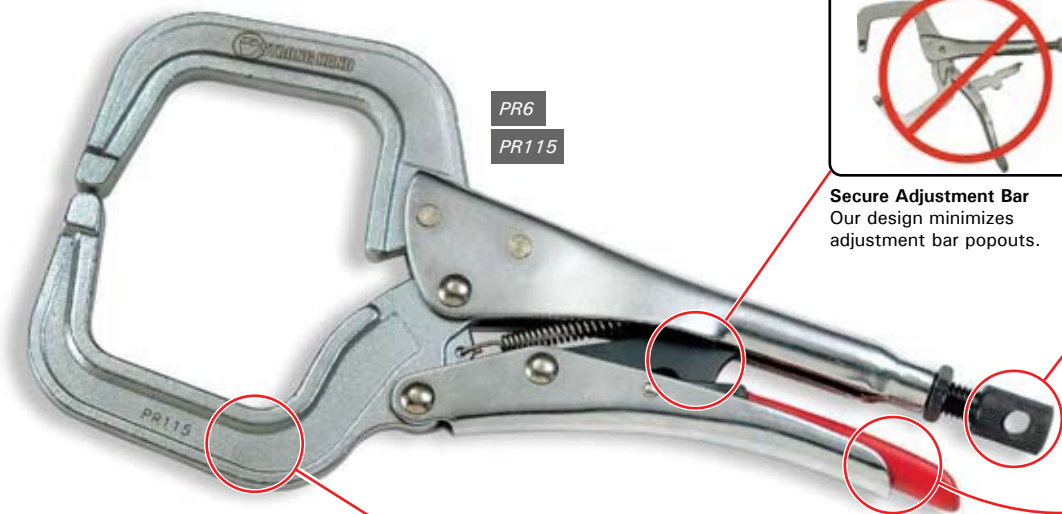

Secure Adjustment Bar
Our design minimizes adjustment bar popouts.

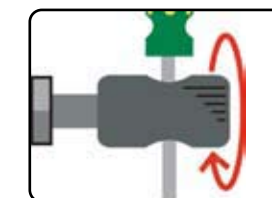

Adjustment Screw
Large adjustment screw with a hole for easy torque.



Single Hand Release Handle
Vinyl coated release handles are made for comfort / ease.

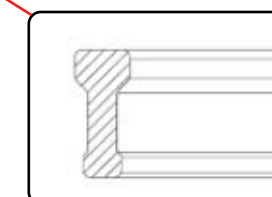

Cross Section
Made of heat treated steel and nickel/chrome plated for strength and durability



Optional Crank Handle
Crank Handle bar can be purchased separately.
*See Accessories Page



	Part No.	OAL	Throat Depth	Opening	Weight
ROUND TIP	PR6	6-1/2" 165 mm	1-13/16" 46 mm	2-3/16" 56 mm	0.5 lbs 0.2 kg
	PR115	11" 280 mm	3-1/4" 83 mm	4" 102 mm	2.0 lbs 0.9 kg
	PR18	18" 450 mm	10" 254 mm	4-1/2" 114 mm	3.0 lbs 1.4 kg
SWIVEL PAD	PR6S	6-1/2" 165 mm	1-13/16" 46 mm	2-3/16" 56 mm	0.6 lbs 0.3 kg
	PR115S	11" 280 mm	3-1/4" 89 mm	4" 102 mm	2.2 lbs 1.0 kg
	PR18S	18" 450 mm	10" 254 mm	4-1/2" 114 mm	3.1 lbs 1.4 kg

Made of rugged, forged heat treated steel. Updated features help you work quickly, safely and efficiently.



Multi-Purpose Pliers

One swivel pad spindle and a fixed head spindle for flexible clamping. Threaded jaw holes allow addition of accessories.

Pliers Models

Part No.	OAL	Throat Depth	Opening	Thread	Weight
PG622 PG622M	6" 150 mm	2" 46 mm	2-1/2" 64 mm	5/16-18 M8	0.7 lbs 0.3 kg
PG634 PG634M	8-1/2" 215 mm	3" 83 mm	4" 102 mm	5/16-18 M8	2.0 lbs 0.9 kg
PG114 PG114M	11" 280 mm	3-1/2" 89 mm	4" 102 mm	3/8-16 M10	2.0 lbs 0.9 kg
PG134 PG134M	13" 330 mm	5-1/2" 89 mm	4" 102 mm	3/8-16 M10	2.2 lbs 1.0 kg
PG204 PG204M	21" 535 mm	12-1/2" 254 mm	4" 102 mm	3/8-16 M10	3.1 lbs 1.4 kg
PGA20 PGA20M	23" - 29" 585 mm - 740	14", 16", 18", 20" 350 mm, 405, 460, 510	4" 102 mm	3/8-16 M10	4.8 lbs 2.2 kg
PGA20S PGA20SM	23" - 29" 585 mm - 740	14", 16", 18", 20" 350 mm, 405, 460, 510	4" 102 mm	3/8-16 M10	4.8 lbs 2.2 kg
PP20	Rubber Pads (4 per set) Fits PG204, PGA20				
PP20S	Rubber Pads (4 per set) Fits PGA20S				

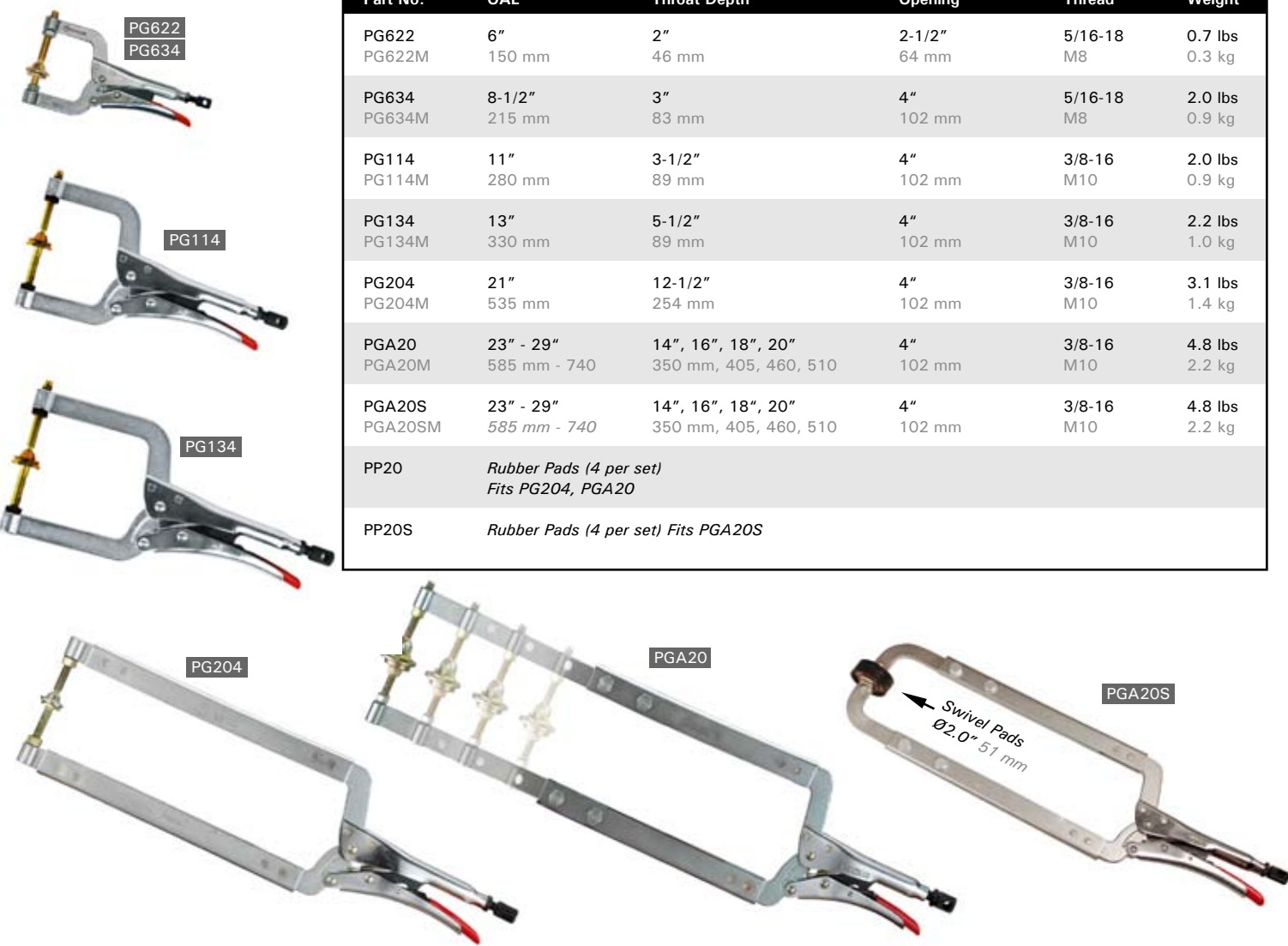

Multi Positions Pliers Holder

Part No. PB11

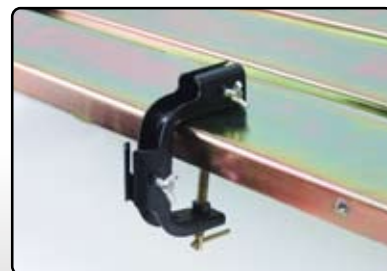

- Holds Pliers in Vertical and Horizontal positions.
- Secure and easy to setup with the swivel pad for uneven surfaces.
- Wing nuts on both vertical and horizontal position secures and locks pliers in place.



Pipe Pliers, Expand-O Pliers

Pipe Pliers

Hold Round Parts securely!

The new convenient way to hold pipe / tube for butt-welding.



Hold pipes securely with high clamping pressure.



Hold pipes at different angles using our *Link *(G)* accessory with two high clamping pressure pliers.

Part No.	OAL	Description	Min/ Max Diameter	Thread	Weight
PG622V PG622VM	6" 150 mm	6" Pliers with V-Pads	1" - 2" 25 mm - 51	5/16-18 M8	0.8 lbs 0.4 kg
PG634V PG634VM	8-1/2" 215 mm	Wide Opening, 8-1/2" Pliers with V-Pads	1-1/2" - 3" 40 mm - 80	5/16-18 M8	1.1 lbs 0.5 kg
PG114V PG114VM	11" 280 mm	11" Pliers with V-Pads	1-1/2" - 2-1/2" 40 mm - 64	3/8-16 M10	2.8 lbs 1.3 kg

* Model XFV2
Optional Magnetic V-pad

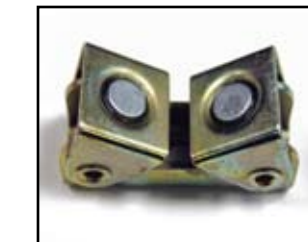

* See Accessories Page

Expand-O Pliers

Unique, Reverse-Action Clamping Pliers!

The only expanding / spreading pliers in the market. Jaws move in opposite directions to push against two surfaces.

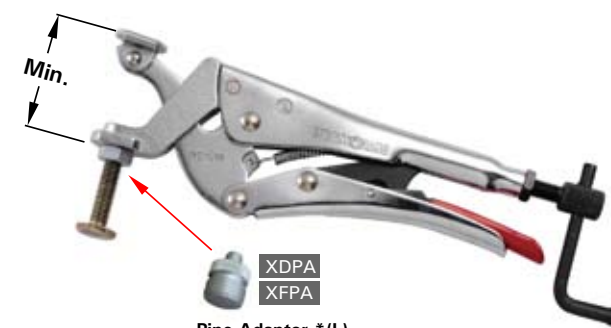

Pipe Adaptor *(L)
Attach 1/2" NPT pipes for wide spreading jobs.
* See Accessories Page

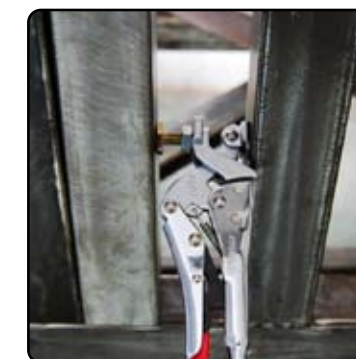

Great for Metal or Wood working

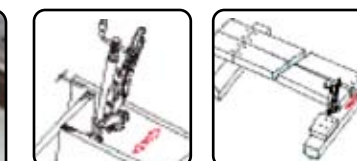

Separate Cabinets

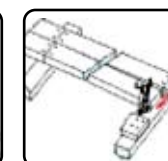

Straighten Warped Deck

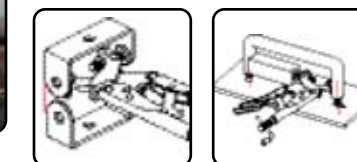

Fit Over Bent Brackets

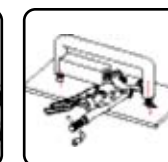

Align Holes

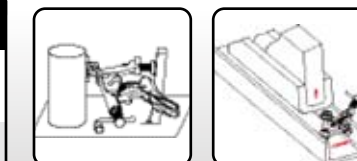

Break Off Weld

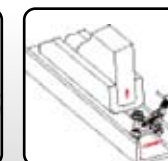

Insert Panel into U-Channel

Part No.	OAL	Clamping Pressure	Thread	Min.	Stroke	Weight
PE6 PE6M	6-1/2" 165 mm	500 lbs 230 kg	5/16-18 M8	1" 25 mm	3/4" 19 mm	0.5 lbs 0.2 kg
PE10 PE10M	10" 255 mm	900 lbs 410 kg	3/8-16 M10	1-3/8" 35 mm	1-3/8" 35 mm	1.8 lbs 0.8 kg

NEW NOMAD™ Economy Welding Table



Three 1.1" (28 mm) Slots in the tabletop allow for insertion of clamps to reach ANY POINT on the table.

Tabletop adjusts to three positions: Horizontal, 30°, and Folded for Compact Storage and Mobility.



Part No.	Tabletop Size	Table Height Range	Slots in Tabletop	Table Positions	Load Capacity	Weight
TS3020	30" W x 20" L (760 mm x 510)	26" - 32" (660 mm x 810)	1.1" (28 mm)	Horizontal, 30°, Folded	350 lbs (160 kg)	44 lbs (20 kg)

NOMAD™ Economy Tool Kit



A. MagSpring™ Clamp (UBV45 - 3-1/2" Cap.)



B. Multi-Angle Magnet (MS346C)



C. Mini Magnet (MS346A)



D. Adjustable Magnetic V-Pad (XDV4)

TSK104 - The Basic Kit (6 Tools)

- 2 pcs. A. MagSpring™
- 1 pc. B. Multi-Angle Magnet
- 1 pc. C. Mini Magnet
- 2 pcs. D. Adjustable Magnetic V-Pad

Ground Hog™ & Strong Grip™ Grounding Clamps

High Clamping Pressure Improves Arc Stability, Reduces Power Consumption, and Improves Cable Life

STRONG GRIP™ ECONOMY GROUND CLAMP
Solid, insulated copper U-channel is a superior conductor of electrical current and rotates for easy access.



GP628 Model



Round pipe to Angle Iron

DUAL PURPOSE
Clamping + Grounding

GROUND HOG™



GP950 Model

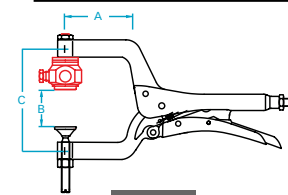

GP950

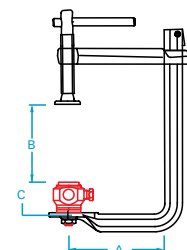

GF650

Part No.	Amperage / Cable Size	Throat Depth	Max. Opening	Tapped Hole	Clamping Pressure	OAL / Rail Size	Weight	Optional Top V-Pad
GP630	300A / 2/0 - 0.427"	3"	1-1/4"	5/16-18	240 lbs	6"	0.9 lbs	XDV
GP1530	2/0 - 0.427"	76 mm	32 mm	M8	110 kg	150 mm	0.4 kg	
GP950	450A / 2/0 - 0.427"	3-1/2"	2-1/2"	3/8-16	400 lbs	11"	2.4 lbs	XFV
GP2850	2/0 - 0.427"	89 mm	64 mm	M10	180 kg	280 mm	1.1 kg	
GP951	530A / 3/0 - 0.475"	3-1/2"	2-1/2"	3/8-16	400 lbs	11"	2.4 lbs	XFV
GP2851	2/0 - 0.475"	89 mm	64 mm	M10	180 kg	280 mm	1.1 kg	
GP628	300A / 2/0 - 0.427"	3"	3"	5/16-18	165 lbs	8.5"	1.0 lbs	XDV
		76 mm	76 mm	M8	75 kg	215 mm	0.5 kg	
GD430	300A / 2/0 - 0.427"	3"	4"	5/16-18	1,000 lbs	5/8" x 5/16"	1.3 lbs	XDA2
GD1130	2/0 - 0.427"	76 mm	102 mm	M8	450 kg	16 mm x 8	0.6 kg	
GF650	450A / 2/0 - 0.427"	4-3/4"	5-3/4"	3/8-16	1,000 lbs	7/8" x 7/16"	3.0 lbs	XFA2
GF1750	2/0 - 0.427"	121 mm	146 mm	M10	450 kg	22 mm x 11	1.4 kg	
GF651	530A / 3/0 - 0.475"	4-3/4"	5-3/4"	3/8-16	1,000 lbs	7/8" x 7/16"	3.0 lbs	XFA2
GF1751	2/0 - 0.475"	121 mm	146 mm	M10	450 kg	22 mm x 11	1.4 kg	

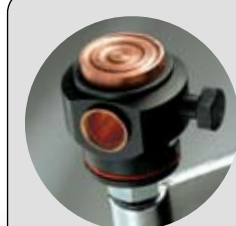

Ground Hog Unit

The Ground Hog™ is rated at **530 AMPS @ 60% duty cycle** (with 3/0 cable)

The groove design on the Copperhead seals out weld spatter and reduces particle buildup. The side screw provides a secure cable connection. Ground Hog body rotates for cable positioning.

Get the high quality electrical transfer that is necessary for good welding.

The Ground Hog's large copper-head contact point prevents current restriction, allowing a complete transfer of the electrical current in a full circuit. The Ground Hog controls the electrical current by isolating the contact surface and the cable connection. Get a smooth, continuous arc with no fade, and no heat transfer while improving cable life, and reducing power consumption.

Ground Hog Unit

Part No.	Amperage / Cable Size	Thread & Length	Weight
GC304	300A / 2/0 - 0.427"	5/16-18 x 1" L	0.3 lbs
GC3008	2/0 - 0.427"	M8 x 25 mm	0.1 kg
GC504	450A / 2/0 - 0.427"	3/8-16 x 1-1/4" L	0.5 lbs
GC5010	2/0 - 0.427"	M10 x 32 mm	0.2 kg
GC514	530A / 3/0 - 0.475"	3/8-16 x 1-1/4" L	0.5 lbs
GC5310	2/0 - 0.475"	M10 x 32 mm	0.2 kg

Shark Clamps

The Precise Scissor Action Clamp with the Exclusive Quick Acting Button for fast setup.



Straight Handle, Soft Grip



T-Handle, Heavy Duty

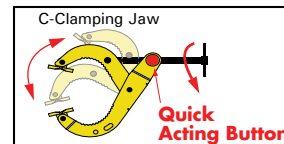

Fast Set-ups, just hold the button down and pull-push the handle to desired clamping position, release the button and turn the handle.

Pivoting, hinged arms provide a wide opening. Choose from 5", or 6-1/2" capacities. Inside serrations hold workpieces securely.

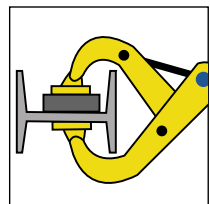

Curved Clamp Arms for step over clamping

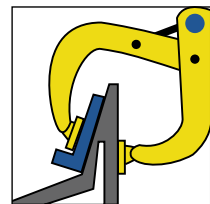

Angled Surfaces clamping

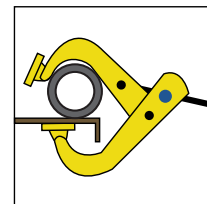

Clamp round part on table

Part No.	Description	Pull Force	Opening	Weight
SC50	T-Handle	1000 lbs 455 kg	5" 127 mm	2.2 lbs 1.0 kg
SC50A	Straight Handle	300 lbs 135 kg	5" 127 mm	2.0 lbs 0.9 kg
SC65	T-Handle	1000 lbs 455 kg	6-1/2" 165 mm	2.5 lbs 1.1 kg
SC65A	Straight Handle	300 lbs 135 kg	6-1/2" 165 mm	2.2 lbs 1.0 kg
SCP	4 Piece Set Rubber Pads			

Half Clamp

The Efficient, Safe Way to Align Materials

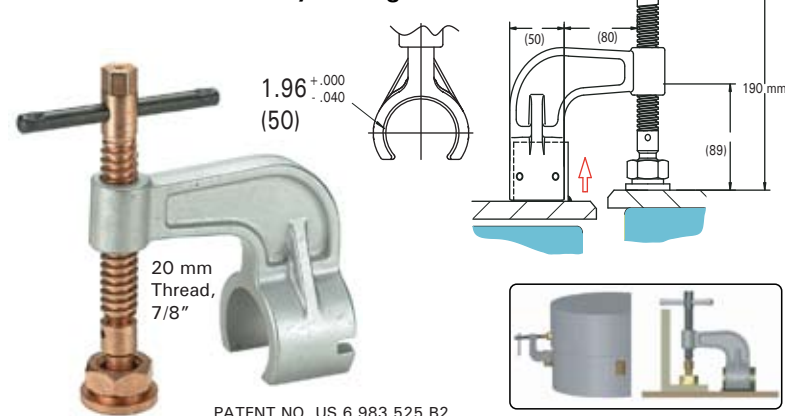

The DOG & WEDGE and CUT-OFF C-CLAMP methods of material alignment are messy, time consuming, and unsafe! The Strong Hand 1/2-Clamp is the NEW and BETTER way to align materials. Align materials in the fabrication of water tanks, bulkheads, deck sections, flat plates, etc. The Half Clamp is ideal for fabricators, repairmen, ship and barge builders.



Part No.	Weight
VHC15	3.8 lbs (1.7 kg)

Copper Plated Acme Screw
Ductile Iron Body

How to Use



Tack weld the front side of 1-1/2" pipe coupon to the lower of the two surfaces.

Slide Half Clamp onto the cut pipe, turn the handle until the misaligned materials align.

Use the rear slot on the Half Clamp to easily break off the coupon. Rotate, and reuse the cut pipes at least 25 times.

Side Clamp



Model VSC15
Weight: 5.6 lbs (2.6 kg)

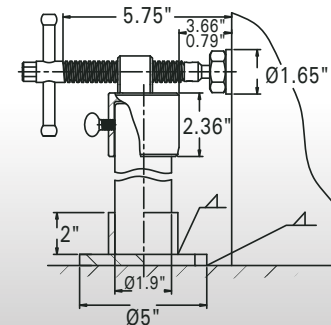

Welders Angle Clamps

3-Axis Welders Angle Clamps

PATENT NO. US 6,860,475 B2



Holds a 3-axis workpiece in position before welding. These unique 3-Axis Vises feature **Quick Acting Screws**, "**Swing Away**" Arm. With the push of the **buttons**, the threaded screws easily slide in and out. When the job is finished, simply "swing away" the 3rd Axis arm for quick and easy part removal. Hold parts in position during cool down to minimize distortion due to contraction.

Two Models Available in 3.75" and (NEW) 4.75" capacities

2-Axis Welders Angle Clamps

Made with machined cast iron. Featuring the following improvements:

- Machined outside faces - usable for upright joint
- Stand-off increases access
- Quick acting screw on deluxe models (35D and 45)

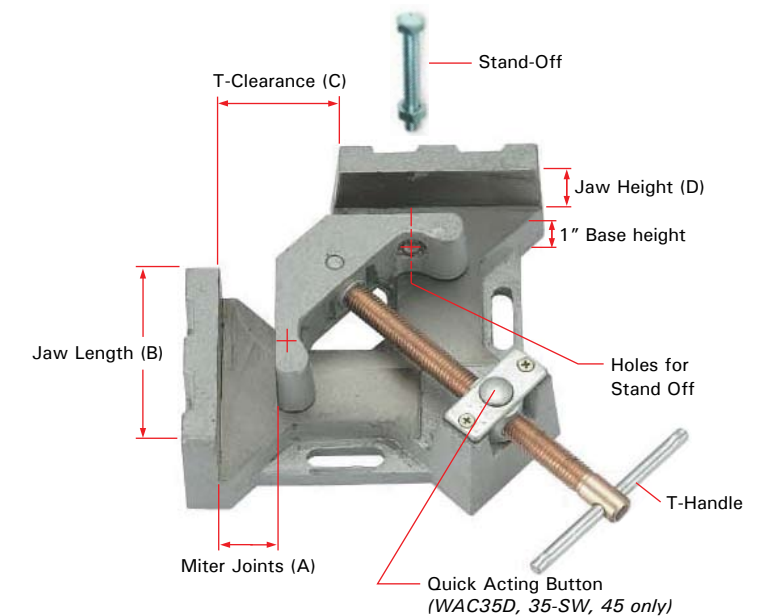

	Part No.	Features	Miter Joints (A)	Jaw Length (B)	T-Clearance (C)	Jaw Height (D)	Weight
2-AXIS	WAC22	Std. screw, Machined on 2 Sides, T-Handle	2.21" 56 mm	3.54" 90 mm	1.85" 47 mm	1.28" 33 mm	8.8 lbs 4.0 kg
	WAC34	Econo Model, Std. Screw, T-Handle	3.75" 95 mm	4.80" 122 mm	2.45" 62 mm	1.38" 35 mm	11 lbs 5.0 kg
	WAC35D	Quick acting Screw, Machined on 2 Sides, Stand-Offs, T-Handle	3.75" 95 mm	4.80" 122 mm	2.45" 62 mm	1.38" 35 mm	11 lbs 5.0 kg
	WAC45	Quick Acting Screw, Machined on 2 Sides, Stand-Offs, T-Handle	4.75" 121 mm	5.32" 135 mm	3.92" 100 mm	2.50" 64 mm	23.2 lbs 10.6 kg
3-AXIS	WAC35-SW	3-Axis Fixture, Quick Acting Screw, Swing Away Arm, T-Handle, Stand-Offs	3.75" 95 mm	4.80" 122 mm	2.45" 62 mm	1.38" 35 mm	24.4 lbs 11.1 kg
	WAC45-SW	3-Axis Fixture, Quick Acting Screw, Swing Away Arm, Stand-Offs, T-Handle	4.75" 121 mm	5.32" 135 mm	3.92" 100 mm	2.50" 64 mm	43.0 lbs 19.6 kg

Inserta-Clamp

Modular Inserta-Clamp

- Choose from Acorn Bushing or Table Mount Models.
- Clamp comes with standard or heavy duty Swivel Pads.
- Unique Side-Kick Attachment provides push-action horizontal clamping force. (optional)
- Optional V-Pads can be mounted on the Sliding Arm or Side-Kick Attachment.

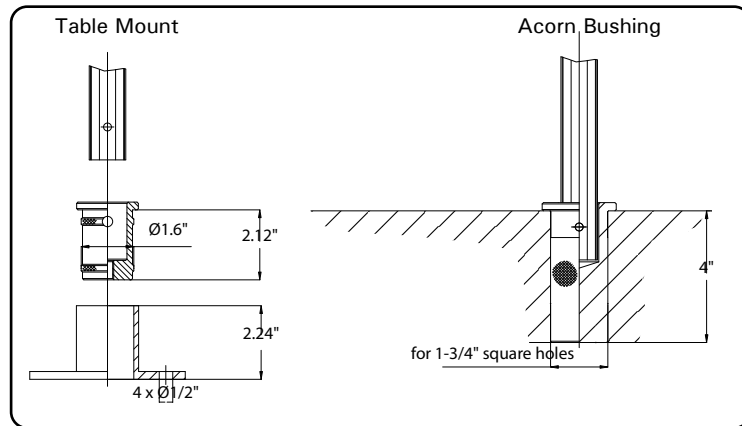
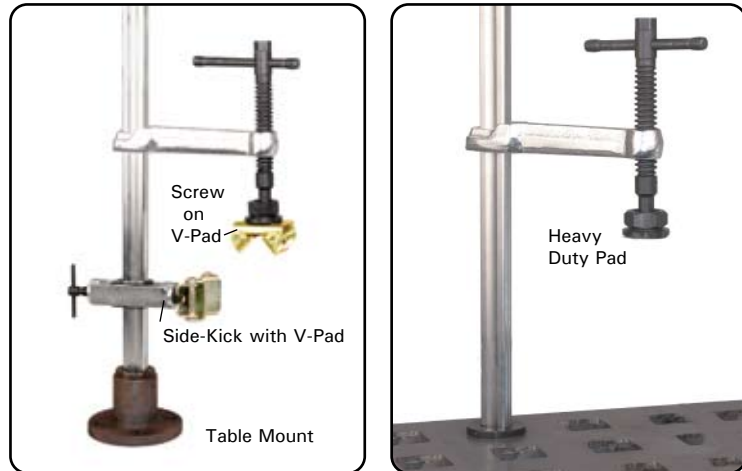

Part Number	Description	Pad	Opening	Throat	Clamping Pressure (lbs)
UF8NA	"F" Rail Insert Clamp, Acorn Bushing	Standard	8"	4-3/4"	1000
UF8NC	"F" Rail Insert Clamp, Table Mounting	Standard	8"	4-3/4"	1000
UF10NA	"F" Rail Insert Clamp, Acorn Bushing	Standard	10"	4-3/4"	1000
UF10NC	"F" Rail Insert Clamp, Table Mounting	Standard	10"	4-3/4"	1000
UF12NA	"F" Rail Insert Clamp, Acorn Bushing	Standard	12"	4-3/4"	1000
UF12NC	"F" Rail Insert Clamp, Table Mounting	Standard	12"	4-3/4"	1000
UM12NA	"M" Rail Insert Clamp, Acorn Bushing	Heavy Duty	12"	5-1/2"	2400
UM12NC	"M" Rail Insert Clamp, Table Mounting	Heavy Duty	12"	5-1/2"	2400
UM16NA	"M" Rail Insert Clamp, Acorn Bushing	Heavy Duty	16"	5-1/2"	2400
UM16NC	"M" Rail Insert Clamp, Table Mounting	Heavy Duty	16"	5-1/2"	2400
UM20NA	"M" Rail Insert Clamp, Acorn Bushing	Heavy Duty	20"	5-1/2"	2400
UM20NC	"M" Rail Insert Clamp, Table Mounting	Heavy Duty	20"	5-1/2"	2400

Clamp Assembly
Part No. : UDW265
Throat Depth 3"
Max. Capacity 4-3/8" DIA
Rail Size 1/2" x 1/4"
Weight 2.6 lbs

Assembly includes:
2 Utility Clamps
1 Fixed V-Block

Pliers Assembly
Part No. : PW2634
Throat Depth 3"
Max. Capacity 4" DIA
Weight 2.0 lbs

Assembly includes:
2 Pliers
1 Fixed V-Block

Fixed V-Block
Part No. : XWV12
Max. Capacity 4-3/8" DIA
Aluminum, Weight 0.2 lbs

Fixed V-Block
Versatile, lightweight aluminum V-Block can be mounted onto a Utility Clamp, Locking C-Clamp, or table top to securely hold round parts. (Screws not included)
Overall size: 4-5/8"L x 2-1/2"D x 1-1/4"H.

Valtra® Components

Our Valtra® catalog features a wide range of Clamps, Machine Parts, Tooling Components, and Fasteners. Call to request a copy of the full line catalog. Modifications to standard parts and custom requests welcome.

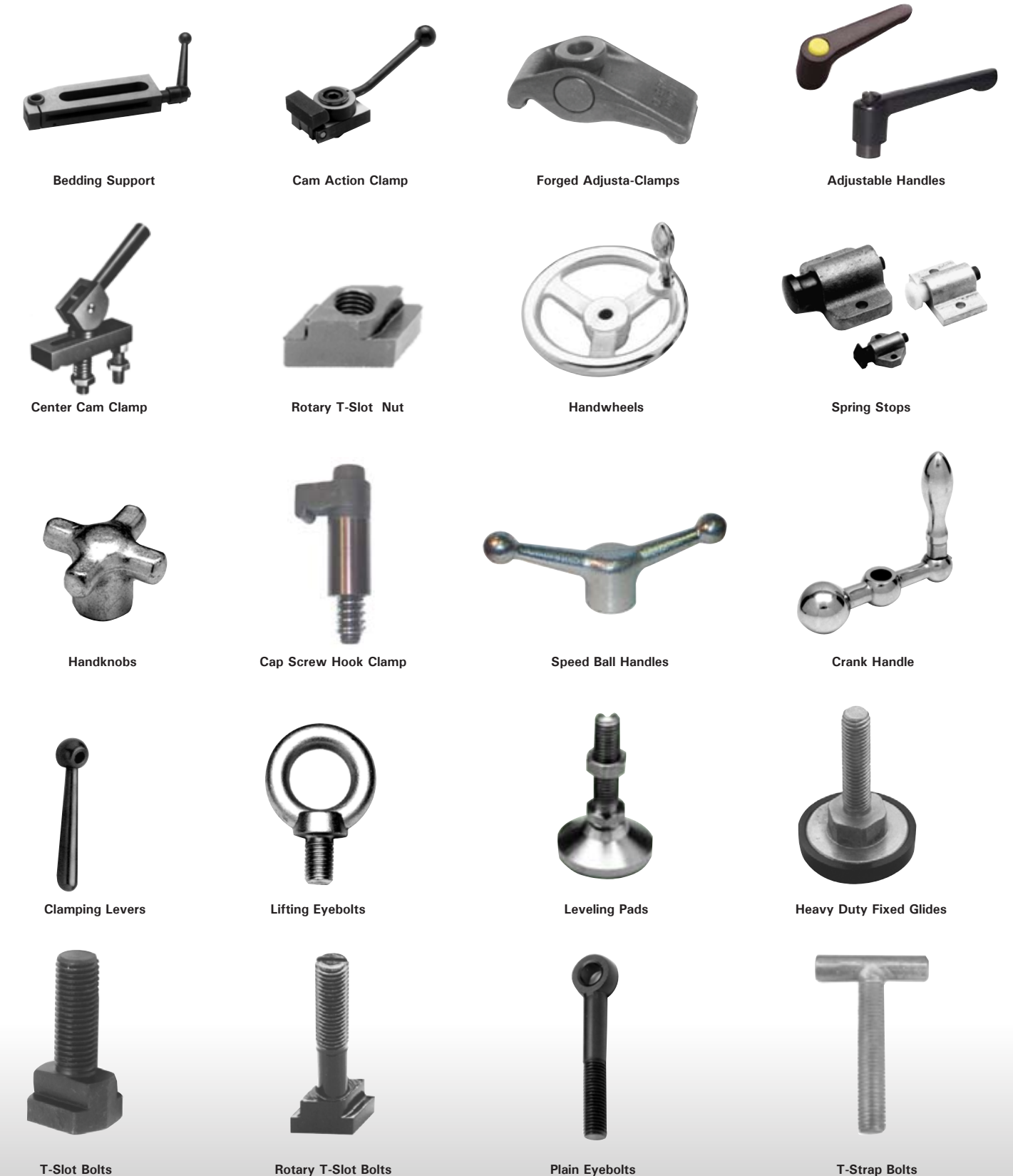

Good Hand™ Toggle Clamps

Ideal time-saving jig and fixture clamps. The toggle design allows instant lock & release of the work piece

Vertical Handle (Hold Down Action)



Model GH-12050 Shown

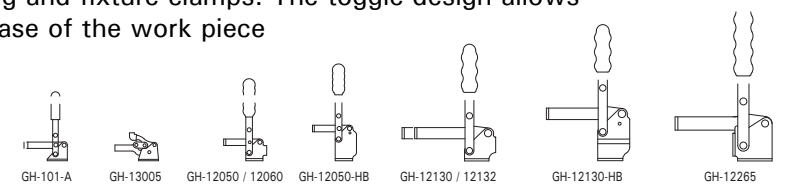
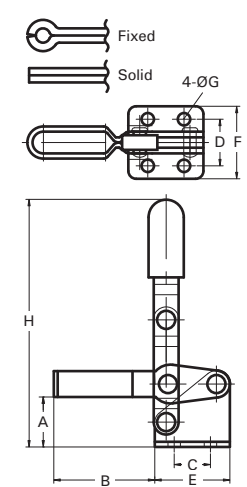

Vertical Handle											
PART NO.	BAR	HOLDING CAPACITY	A	B	C	D	E	F	ØG	H	WEIGHT
GH-101-A	U	110 lbs.	0.75	1.02	0.63	0.94	1"	1.31	0.17	3.03	0.13 lb.
GH-13005	U	150 lbs.	0.5	1.21	0.53	0.63	1.03	1"	0.17	1.4	0.13 lb.
GH-12050	Fixed	200 lbs.	0.89	1.3	0.5	1.06	1"	1.56	0.2	3.74	0.38 lb.
GH-12050-HB	Fixed	200 lbs.	1.66	1.3	0.5	1.06	1"	1.56	0.2	4.8	0.38 lb.
GH-12060	Solid	200 lbs.	0.89	1.3	0.5	1.06	1"	1.56	0.2	3.74	0.38 lb.
GH-12130	U	500 lbs.	1.25	2.81	0.75	1.25	1.37	1.81	0.28	5.5	0.78 lb.
GH-12130-HB	U	500 lbs.	2.25	2.81	0.75	1.25	1.75	1.81	0.28	6.5	0.78 lb.
GH-12132	U	500 lbs.	1.25	3.75	0.75	1.25	1.37	1.81	0.28	5.5	0.81 lb.
GH-12265	U	750 lbs.	1.75	3.58	1.25	1.78	1.94	2.53	0.34	7.5	1.40 lbs.

UNIT: inches

Horizontal Handle (Hold Down Action)



Model GH-201-B Shown

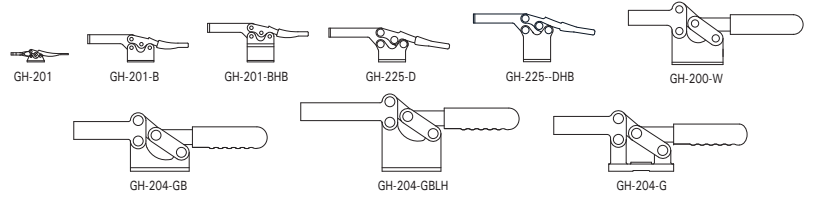
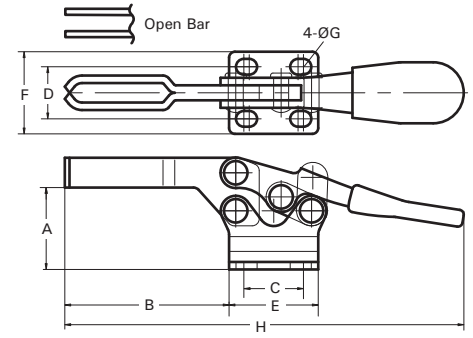

Horizontal Handle											
PART NO.	BAR	HOLDING CAPACITY	A	B	C	D	E	F	ØG	H	WEIGHT
GH-201	U	60 lbs.	0.37	0.87	0.63	0.63	0.94	0.94	0.17	3.11	0.09 lb.
GH-201-B	U	200 lbs.	1"	2.17	1.06	0.87	1.45	1.42	0.2	5.43	0.29 lb.
GH-201-BHB	U	200 lbs.	1.66	2.17	1.06	0.87	1.45	1.42	0.2	5.43	0.32 lb.
GH-225-D	U	500 lbs.	1.37	2.75	1"	0.87	1.5	1.42	0.26	6.61	0.59 lb.
GH-225-DHB	U	500 lbs.	2.13	2.75	1"	0.87	1.5	1.42	0.26	6.61	0.63 lb.
GH-200-W	U	880 lbs.	2.13	2.36	1.65	1.18	2.76	1.96	0.39	9.45	1.32 lbs.
GH-204-GB	Open	1,400 lbs.	1.77	3.15	2.24	2"	3.27	2.8	0.37	10.59	2.6 lbs.
GH-204-GBLH	U	1,400 lbs.	2.79	5"	2.24	2"	3.27	2.8	0.37	12.44	2.78 lbs.
GH-204-G	Open	1,400 lbs.	2"	3"	2.76	1.18	3.54	1.89	0.33	10.55	2.69 lbs.

UNIT: inches

Push/Pull (Straight Line Action)

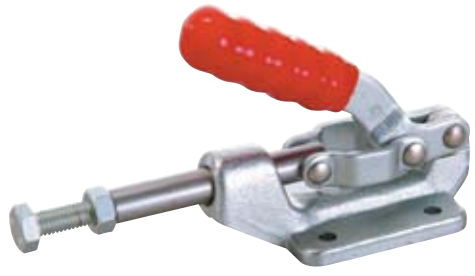

Model GH-36003 Shown

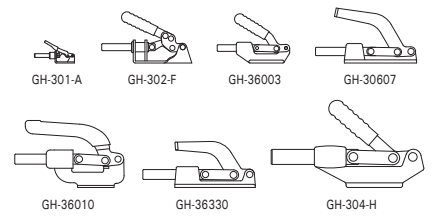
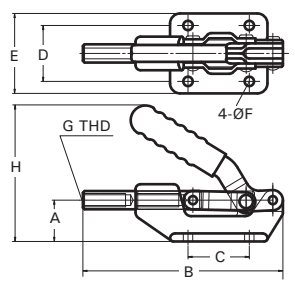

Push/Pull											
PART NO.	HOLDING CAPACITY	PLUNGER STROKE	A	B	C	D	E	ØF	G	H	WEIGHT
GH-301-A	100 lbs.	0.63	0.50	2.68	0.63	0.63	1.06	0.17	8-32	1.73	0.11 lb.
GH-302-F	300 lbs.	1.25	0.96	5.51	1.38	1.61	2.2	0.20	5/16-18	3.07	0.66 lb.
GH-36003	600 lbs.	1.25	0.97	4.69	1.44	1.34	1.97	0.26	5/16-18	3.23	0.78 lb.
GH-30607	700 lbs.	1.63	0.69	6.03	1.37	1.63	2.19	0.28	5/16-18	3.28	1.54 lbs.
GH-36010	800 lbs.	1.63	1.75	6.75	1.63	1.63	2.25	0.34	3/8-16	4.06	1.76 lbs.
GH-36330	2,500 lbs.	2"	0.81	7"	1.37	1.63	2.25	0.34	3/8-16	2.83	2.06 lbs.
GH-304-H	1,500 lbs.	2.36	1.75	9.38	2"	2"	2.81	0.34	1/2-13	6.76	3.26 lbs.

UNIT: inches

Latch Type (Pull Action)



Model GH-431 Shown

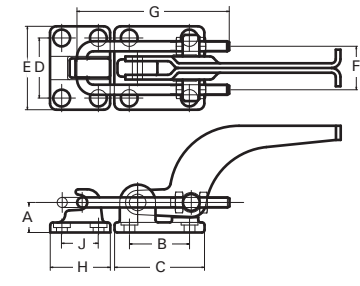

Latch Type											
PART NO.	HOLDING CAPACITY	A	B	C	D	E	F	G	H	J	WEIGHT
GH-40840	550 lbs.	0.50	0.75	1.38	1.26	1.89	1.12	4.3	1.30	0.55	0.67 lb.
GH-431	700 lbs.	0.50	0.63	1.03	0.75	1.11	0.75	2.24	0.78	0.39	0.50 lb.
GH-40370	4,000 lbs.	1.13	2.25	3.37	2.25	3.13	1.37	5.71	2.25	1.37	2.78 lbs.
GH-40380	7,500 lbs.	1.13	2.25	3.37	2.25	3.13	2.13	5.79	2.25	1.37	3.25 lbs.

UNIT: inches

Yoke Assemblies

Hold two workpieces, or long pieces of metal. The yokes have spring loaded, extra-wide spindles that provide strong, holding power that adjusts to varying material thickness and sizes.

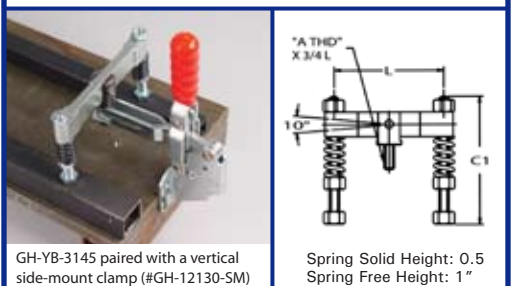

PART NO.	A	L	C1
GH-YB-3145	5/16-18	4.5"	2.5"
GH-YB-3160	5/16-18	6"	2.5"
GH-YB-3745	3/8-16	4.5"	3"
GH-YB-3760	3/8-16	6"	3"

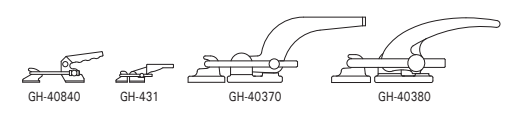

Toggle Clamps for Welding Applications.

Please call us at 800.989.5244 to request a comprehensive Good Hand™ Toggle Clamps catalog.



Standard V-Pad

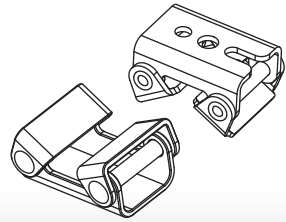

Attaches to pliers or clamps to hold round and angled work pieces.

P/N	Threaded Hole	For Pliers	For Clamps
XDV	5/16-18 M8	PG622 PG634	UD
XFV	3/8-16 M10	PG114 PG134	UE, UF, UG
XMV	3/8-16 M10	PG204 PGA20	UM, UP
XDVS	5/16-18 M8	PG622 PG634	UD
XFVS	3/8-16 M10	PG114 PG134	UE, UF, UG
XMVS	3/8-16 M10	PG204 PGA20	UM, UP

Clip-On Top V-Pad

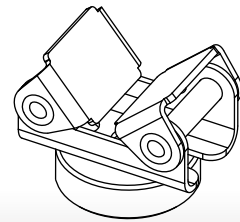

For Light Duty and Value Series
Attaches to Standard Pad Clamps

P/N	Threaded Hole	For Clamps
XDA2	5/16-18 M8	UD
XFA2	3/8-16 M10	UE, UF, UG
XMA2	3/8-16 M10	UM
XDAS	5/16-18 M8	UD
XFA2S	3/8-16 M10	UE, UF, UG
XMA2S	3/8-16 M10	UM

Screw-On Top V-Pad

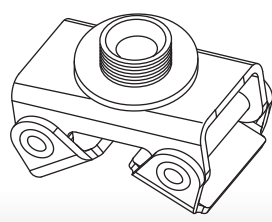

For Regular Duty and Heavy Duty Series
Attaches to Heavy Duty Pad.

P/N	Threaded Hole	For Clamps
XMA	3/8-16 M10	UM, UP
XMAS	3/8-16 M10	UM, UP

Yoke

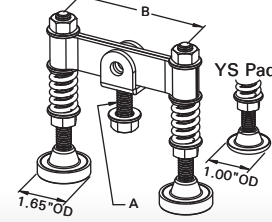

Additional support, varying height.

P/N	A	B
YS-3145	5/16-18 M8	4-1/2" 114 mm
YS-3160	5/16-18 M8	6" 152 mm
YP-3145	5/16-18 M8	4-1/2" 114 mm
YP-3160	5/16-18 M8	6" 152 mm

YS - Steel Swivel Pad
YP - Plastic / Rubber Pad

Pliers Replacement Parts

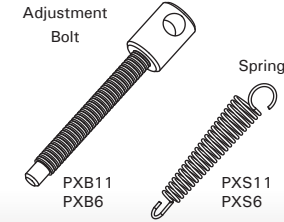

Adjustment Bolt and Spring for Pliers.

P/N	For Pliers
PXS11	11" Pliers
PXS6	6" Pliers
PXB11	11" Pliers
PXB6	6" Pliers

Crank Handles

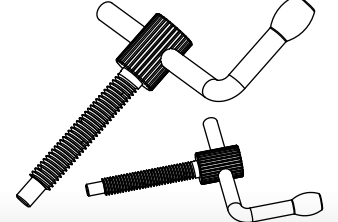

Optional or replacement Handles for all Strong Hand Tools™ pliers.

P/N	Thread
PXH6	5/16-18 M8
PXH11	3/8-16 M10

Magnetic V-Pad

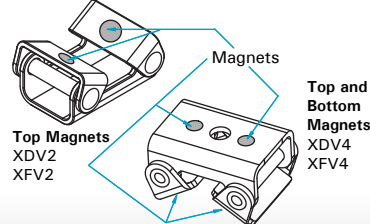

Rare Earth Magnetic V-Pads for holding round and angled pipes.

P/N	Threaded Hole	For Pliers	For Clamps	Table Mount
XDV2	5/16-18 M8	PG622 PG634	UD	No
XDV4	5/16-18 M8	---	---	Yes
XFV2	3/8-16 M10	PG114 PG134 PG204 PGA20	UE, UF, UG	No
XFV4	3/8-16 M10	---	---	Yes

Extender Block

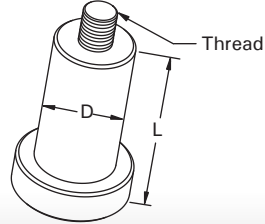

Attaches to clamps for Step-Over applications.

P/N	Threads	D	L	For Clamps
XDB1	5/16-18 M8	3/4" 19 mm	1" 25 mm	UD
XFB	3/8-16 M10	1-3/16" 30 mm	2" 51 mm	UE, UF, UG
XMB2	3/8-16 M10	1-3/16" 30 mm	2" 51 mm	UM, UP

Side-kick

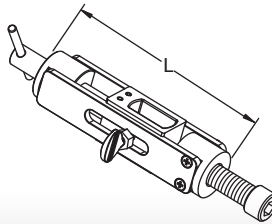

Mount on Utility Clamps for 2-axis horizontal clamping.

P/N	L	Stroke	For Clamps
XDS	3-1/8" 79 mm	1" 25 mm	UD
XFS	4-3/8" 111 mm	1-3/8" 35 mm	UF
XGS	4-3/8" 111 mm	1-3/8" 35 mm	UG
XMS	4-3/8" 111 mm	1-3/8" 35 mm	UM

C3 Package

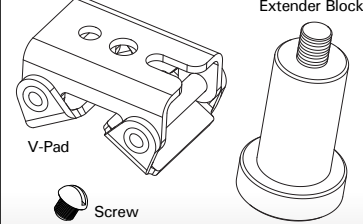

C3 Package for 4-IN-1 Utility Clamps. 1 V-Pad, 1 Extender Block, 1 Screw

P/N	V-Pad / Extender Block
XDVB	XDV / XDB For UD Models
XFVB	XFV / XFB For UE, UF, UG Models
XMVB	XMV / XMB2 For UM, UP Models

Pipe Adapter

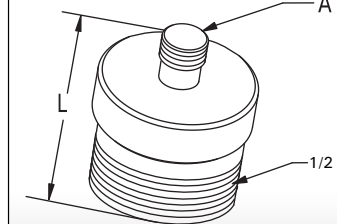

Attaches to clamps for Step-Over applications.

P/N	A	L	For Pliers	For Clamps
XDJ	5/16-18 M8	1-1/16" 27 mm	PE6	UD
XFJ	3/8-16 M10	1-5/32" 29 mm	PE10	UE, UF, UG, UM, UP

Swivel / Pivot Pads

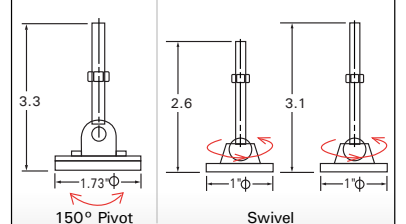

Flat pad pivots at 150° and round pad swivels at 360°

P/N	Thread
854944 (Pivot)	3/8-16 M10
854940 (Swivel)	3/8-16 M10
854930 (Swivel)	5/16-18 M8
854935 (Swivel)	5/16-18 M8

Yoke Support

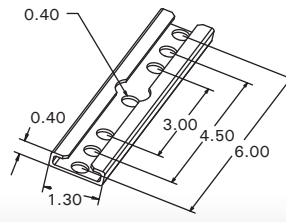

Yoke Support used in conjunction with the yoke for PG11

P/N	OAL
XDK	6-1/2" 165 mm

Bench Rest

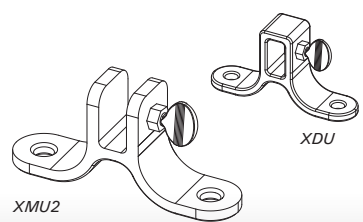

Supports U-Clamp in Standing Position.

P/N	For Clamps
XDU	UD
XMU2	UM

Multi-Position Pliers Holder

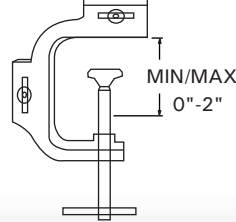

Holds Pliers in multiple positions

P/N	For Pliers
PB11	For All Pliers Models

Big Hex Spindles

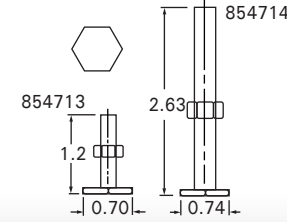

Fixed Head Spindles

P/N	Thread
854713	5/16-18 M8
854714	3/8-16 M10

T-Snap Bolt

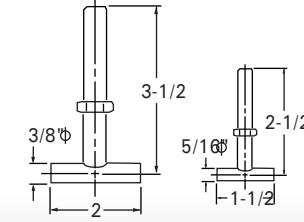

For Step-Over applications

P/N	Thread
840435	3/8-16 M10
840335	5/16-18 M8

Fixed Glide

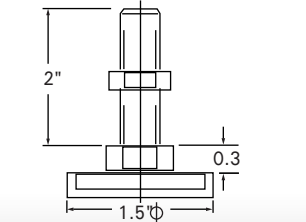

Fixed Glide with non-marring rubber pads.

P/N	Thread
854740P	3/8-16 M10