

707 405

ML26AA

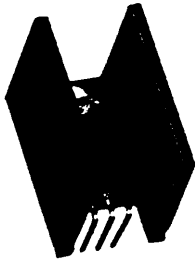

Model ML26AA R_{θ} (°C/W) -----17.9



AIR VELOCITY
m/sec 0 1.0 2.0 3.0 4.0 5.0
ft/min 0 200 400 600 800 1000

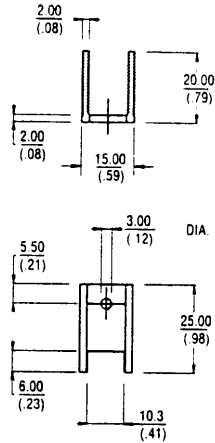
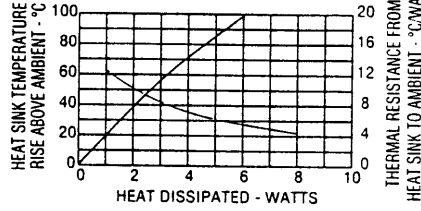

6098 Series, ML73 Series



Model	Dim. A mm (inches)	Dim. B mm (inches)	R_{θ} (°C/W)
6098B	25.40 (1.000)	25.40 (1.000)	14.0
6099B	38.10 (1.500)	25.40 (1.000)	11.0
6100B	50.80 (2.000)	25.40 (1.000)	9.0
6101B	63.50 (2.500)	25.40 (1.000)	7.1

Model	Dim. A mm (inches)	R_{θ} (°C/W)
ML73/1	25 (.984)	14.0
ML73/1.5	38 (1.50)	11.0
ML73/2	50 (1.97)	9.0



6098B

Accepts CLP-204

Notes: (6098 Series) To order optional solderable roll pin with shoulder, add "P2" after model number, e.g. 6098B-P2. Shoulder washer is 1.27 + .38/.13 (.050 + .015/- .005) thick. These parts are also available without roll pins: 6090B is 25.40mm (1.0") tall without roll pins, 6091B is 38.10mm (1.5") tall without roll pins, and 6092B is 50.80mm (2.0") tall without roll pins. See information on roll pins on page A28.

The Productivity Enhancements shown in the circles above are for use with the 6098 Series only

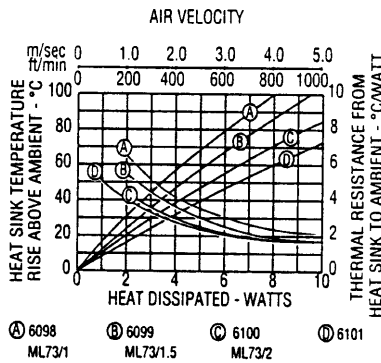

6098 Series

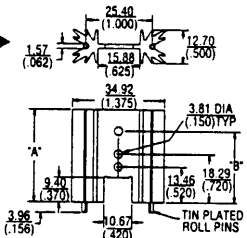

ML73 Series

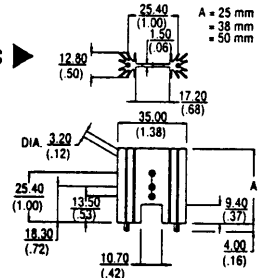

ML24



Model ML24 R_{θ} (°C/W) -----16.7

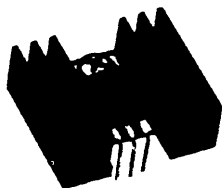

AIR VELOCITY
m/sec 0 1.0 2.0 3.0 4.0 5.0
ft/min 0 200 400 600 800 1000

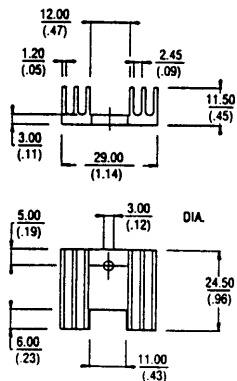
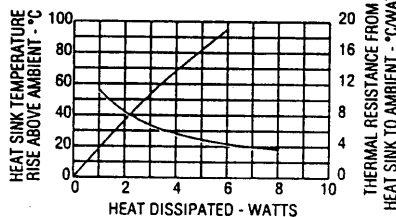

TO-220 HEAT SINKS