

### TERMINALS

#### 01 Solder Lug

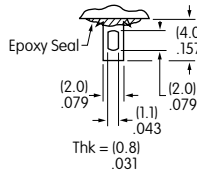

#### 02 .062" (1.57mm) Wide Quick Connect

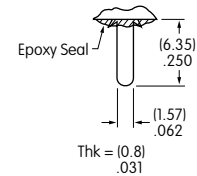

#### 03 .250" (6.35mm) Straight PC

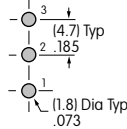
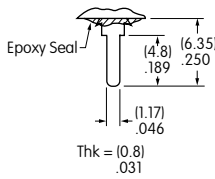

Single Pole

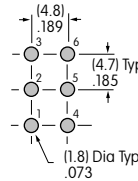

Double Pole

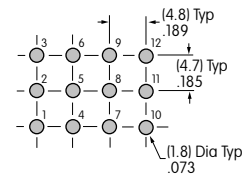

Four Pole

#### 05 .425" (10.8mm) Wirewrap or Extended PC

#### 06 .750" (19.05mm) Wirewrap or Extended PC

#### 07 .964" (24.5mm) Wirewrap or Extended PC

#### 08 1.062" (27.0mm) Wirewrap or Extended PC

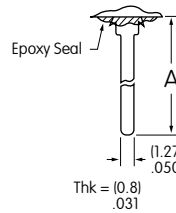

If using as extended PC terminal, refer to the above footprints.

Dimension A = terminal lengths as shown beside the terminal codes at the left.

### CAPS & CAP COLORS

#### B AT078 .315" (8.0mm) Dia. Screw-on Cap

Material: Polystyrene  
Finish: Glossy



Colors Available: A B C E F G H

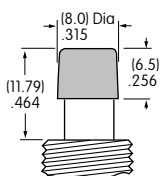

#### C AT079 .394" (10.0mm) Dia. Screw-on Cap

Material: Polystyrene  
Finish: Glossy



Colors Available: A B C E F G H

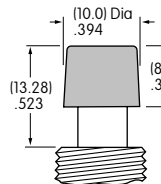

#### D AT414 .520" (13.2mm) Dia. Screw-on Cap

Material: PBT  
Finish: Glossy



Colors Available: A B C D E F G H

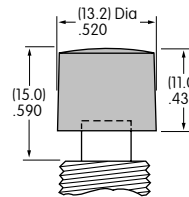

#### E AT412 .748" (19.0mm) Dia. Screw-on Cap

Material: Polystyrene  
Finish: Glossy



Colors Available: A B C F

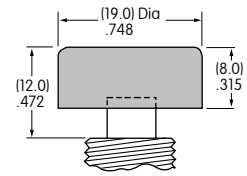

Cap Color Codes:

**A** Black **B** White **C** Red **D** Amber **E** Yellow **F** Green **G** Blue **H** Gray