

463-322

SPECIFICATION.

CRAASLF

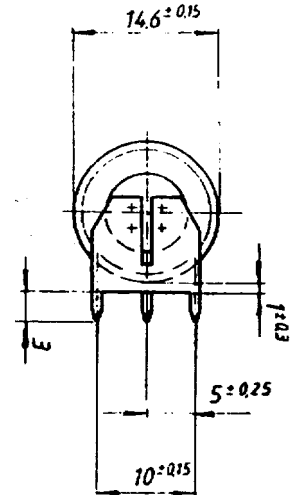
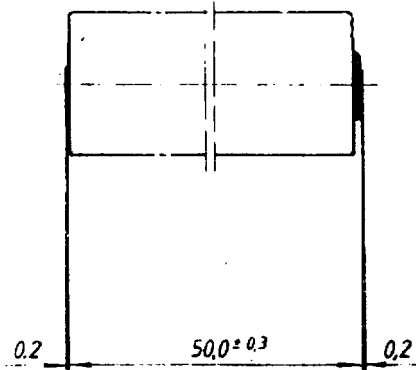
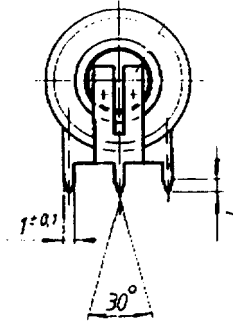

Cell Type ----- CRAASLF

System ----- Lithium Manganese
Dioxide

Order No. ----- 099205

Farnell Part No. ----- 463-322

Nominal Voltage ----- 3v

Typical Capacity at RT ----- 2000mAh
down to 2.0v
load 1.0kohm

Max. Continuous Discharge ----- 20mA

Weight Approx. ----- 21.5g

Temperature Range	Recommended	Permissible
Discharge -----	-30 to +75 degC	-40 to +85 degC
Storage -----	-55 to +75 degC	(max 2 weeks)

Life ----- Up to 10 years (dependant on application)