

ISS.	AMEND	DATE
1	ISSUED	23/01/03
2	BORDER UPDATE	03/09/10

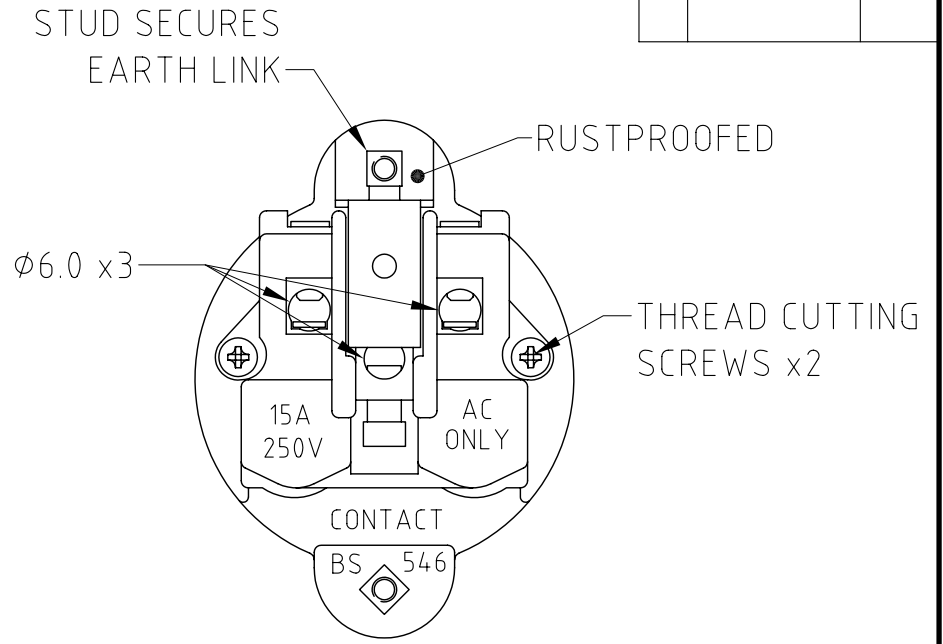
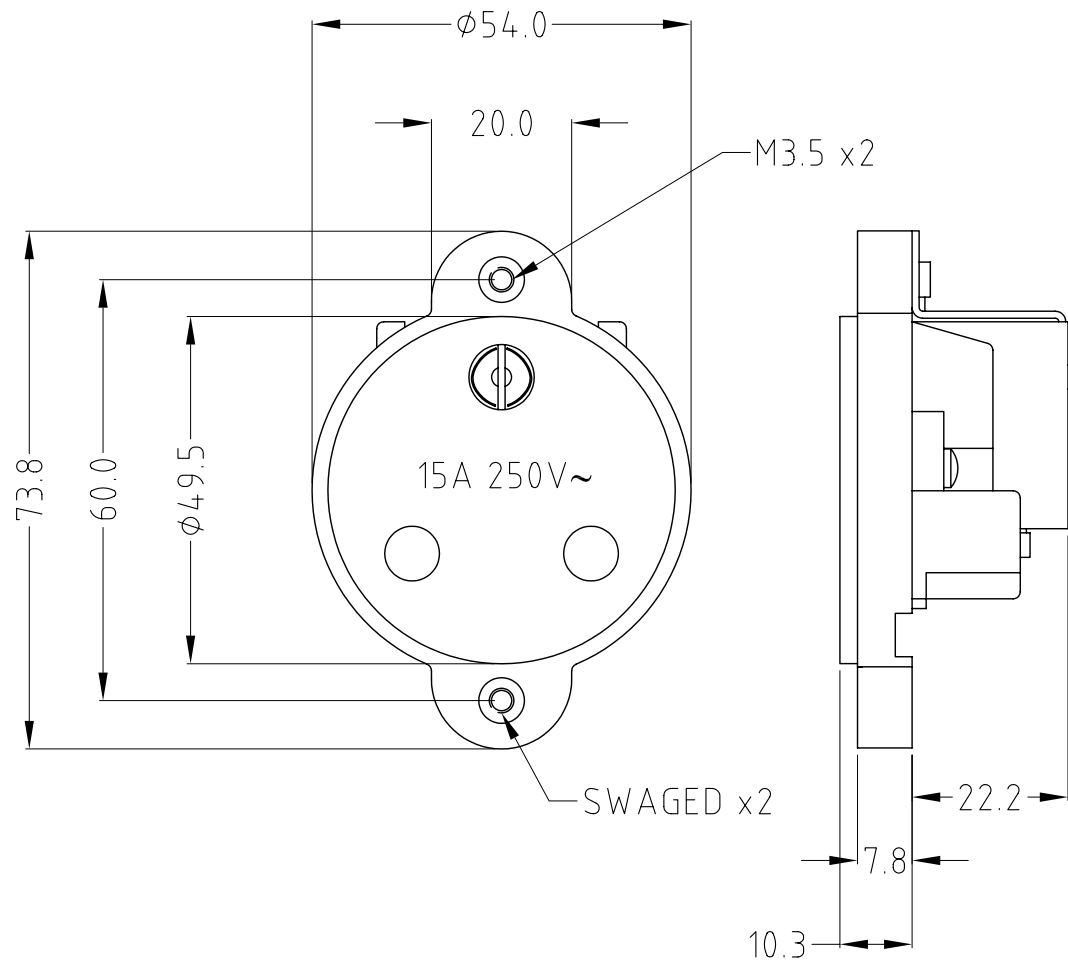

VARIANTS	
PART No	COLOUR
FM7080	WHITE
FM7081	BLACK

RoHS
COMPLIANT

TOLERANCE
 NO DEC. PLACE ±0.50
 1 DEC. PLACE ±0.20
 2 DEC. PLACE ±0.10
 HOLE Ø ±0.10
 ANGLES ± 1/2°
 UNLESS OTHERWISE STATED

FIRST DRAWN 5/3/02

Cliff Electronic Components Ltd. 76 Holmethorpe Avenue, Holmethorpe Industrial Estate, Redhill, Surrey, RH1 2PF, England, UK Tel: 01737-771375 Fax: 01737-766012 Website: www.cliffuk.co.uk	DIMENSIONS IN MILLIMETERS UNLESS OTHERWISE STATED. WORK TO DIMENSIONS. REMOVE ALL BURRS. IF IN DOUBT ASK.		3rd ANGLE PROJECTION:		DO NOT SCALE
	MATERIAL: MELAMINE / POLYCARBONATE / BRASS / STEEL	TITLE: 15A SHUTTERED SOCKET		FORM: A4DRWGH	
FINISH: CLEAN / 10 PCS PER CARTON	DRAWN: C.A.M.J.		APPROVED: R.W.T.		DRWG. No. FM7080