

DESIGNED & DIMENSIONED
IN MILLIMETERS [INCHES]

USB3-B-S-X-XX-XX

VERSION
-3.0

TYPE
-B

CONFIGURATION
-S: SINGLE

OPTION
TR: TAPE AND REEL

TERMINATION
-TH: THROUGH HOLE
* -SM: SURFACE MOUNT

PLATING SPECIFICATION
-S: SELECTIVE, .000030" MIN GOLD ON MATING AREA, .000080" MIN MATTE TIN ON TAILS WITH .000050" MIN NICKEL UNDERPLATE
-F: .000003" MIN GOLD FLASH ON MATING AREA, .000080" MIN MATTE TIN ON TAILS WITH .000050" MIN NICKEL UNDERPLATE
SHIELD PLATED:
0.000050" MIN NICKEL WITH 0.000050" MIN COPPER UNDERPLATE
* = NOT TOOLED

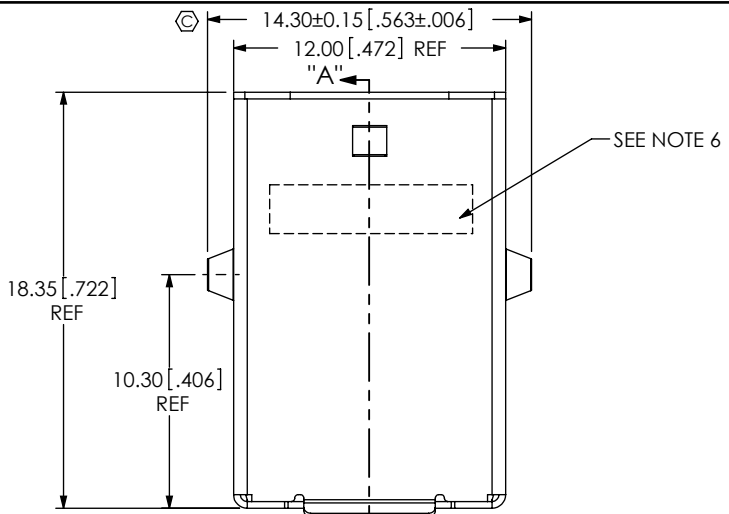
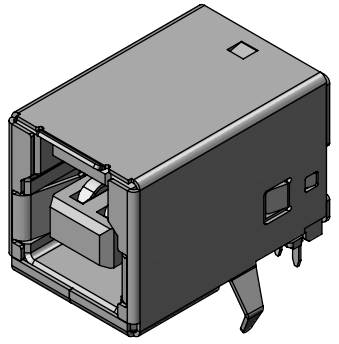

SEE NOTE 6

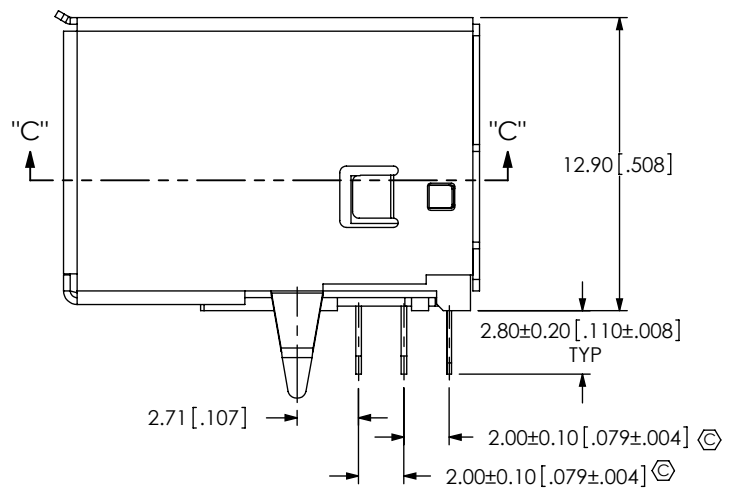
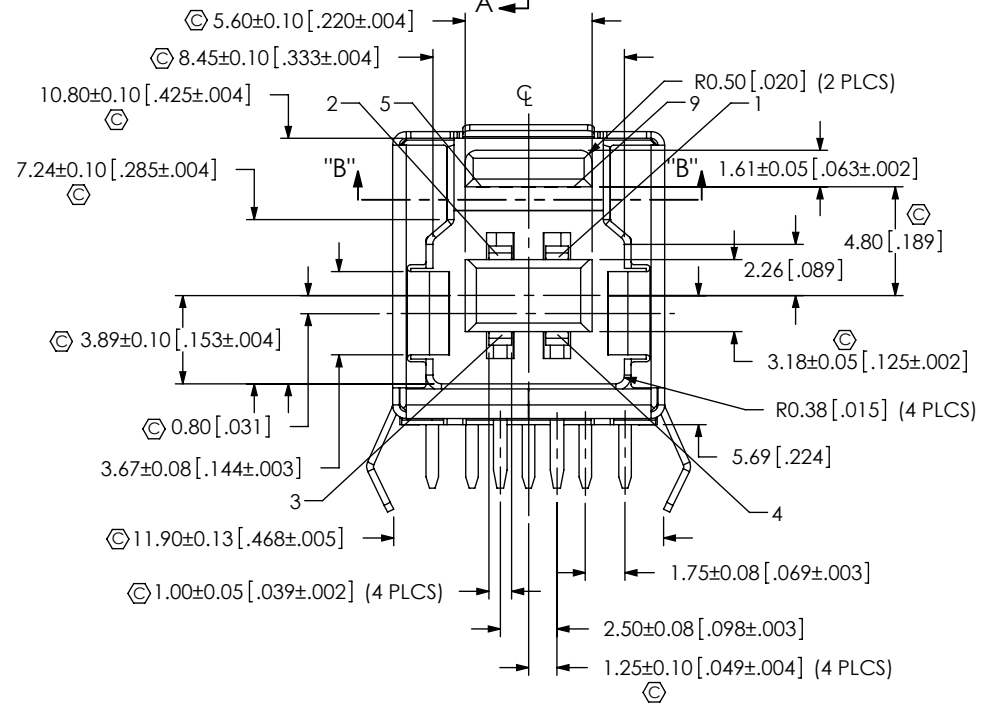

- NOTES:
- ⊗ REPRESENTS A CRITICAL DIMENSION.
 - VENDOR: YANGMING PRECISION OF PLASTIC METAL ELECTRONIC CO; PART NUMBER: 11161-20900X-00.
 - PART TO BE COMPLIANT WITH USB 3.0 SPECIFICATION.
 - THE COMPONENTS BE ROHS COMPLIANT, RECEPTACLE MATERIALS SHOULD CONFORM TO DIRECTIVE 2002/95/EC OF JANUARY 27, 2003 ON ROHS OR OTHER REGULATORY DIRECTIVES.
 - TRAY PACKAGE IS STANDARD PACKAGE AND OFFERED BY SUPPLIER.
 - INK PRINTED SAMTEC LOGO AND DATE CODE:

FIG. 1
(USB3-B-S-X-TH SHOWN)

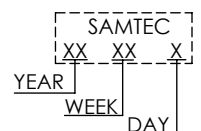

UNLESS OTHERWISE SPECIFIED, DIMENSIONS ARE IN MILLIMETERS. TOLERANCES ARE:
DECIMALS ANGLES
X.X: ±0.3 [.01] 2°
X.XX: ±0.13 [.005]
X.XXX: ±0.051 [.0020]

PROPRIETARY NOTE
THIS DOCUMENT CONTAINS INFORMATION CONFIDENTIAL AND PROPRIETARY TO SAMTEC, INC. AND SHALL NOT BE REPRODUCED OR TRANSFERRED TO OTHER DOCUMENTS OR DISCLOSED TO OTHERS OR USED FOR ANY PURPOSE OTHER THAN THAT WHICH IT WAS OBTAINED WITHOUT THE EXPRESSED WRITTEN CONSENT OF SAMTEC, INC.

samtec
520 PARK EAST BLVD., NEW ALBANY, IN 47150
PHONE: 812-944-6733 FAX: 812-948-5047
e-Mail: info@SAMTEC.com code 53322

MATERIAL: DO NOT SCALE DRAWING SHEET SCALE: 3:1
HOUSING: NYLONT 9T BLUE UL94 V-0
CONTACT: PHOSPHOR BRONZE C5191R-H
FRONT SHIELD: PHOSPHOR BRONZE C5191-H
BACK SHIELD: BRASS C2680-H

DESCRIPTION:
USB 3.0 B TYPE RECEPTACLE
DWG. NO. **USB3-B-S-X-XX-XX**
BY: DUKES Z 5/25/2010 SHEET 1 OF 2

REVISION D

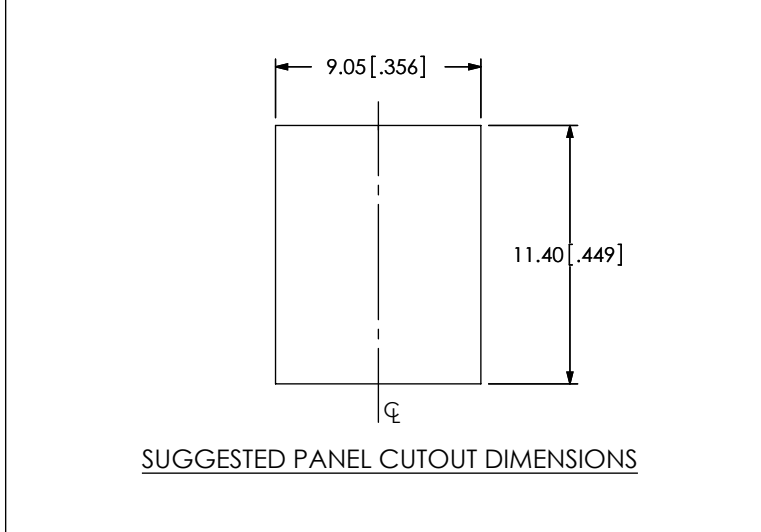
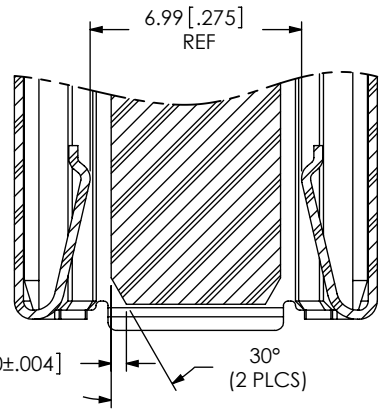
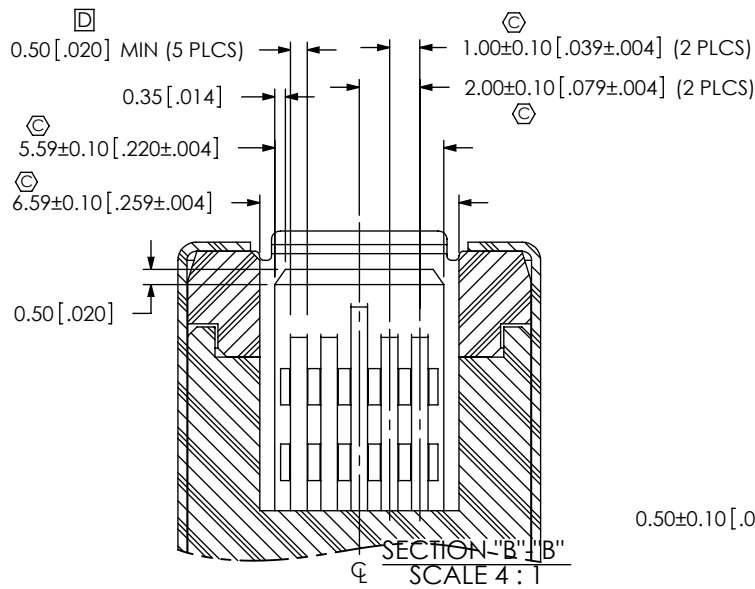
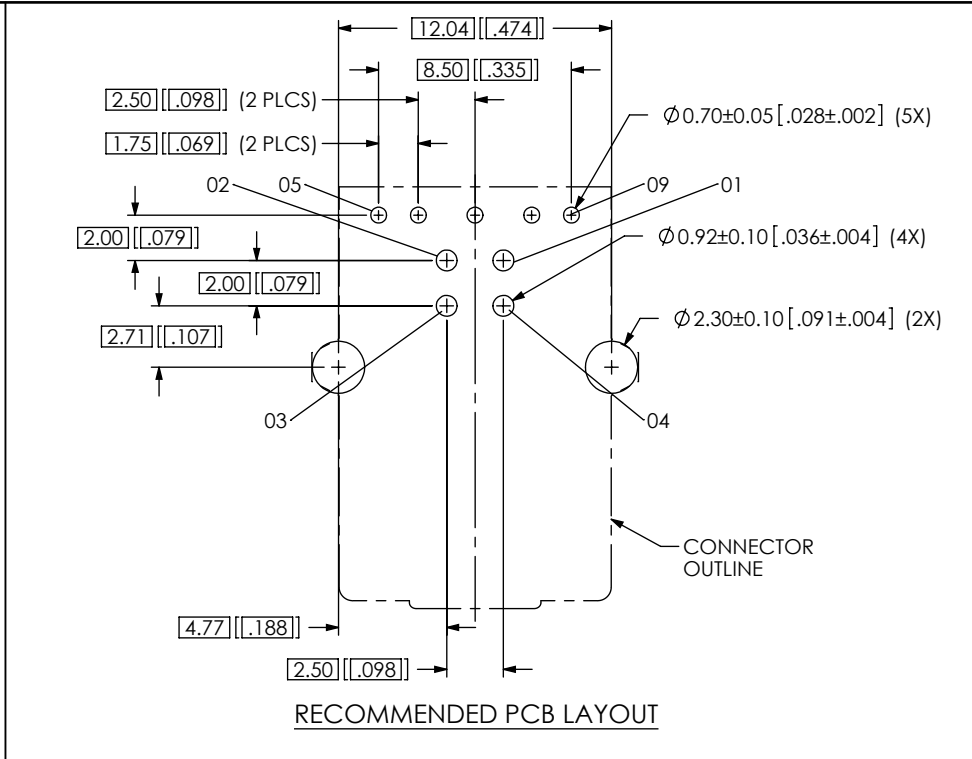
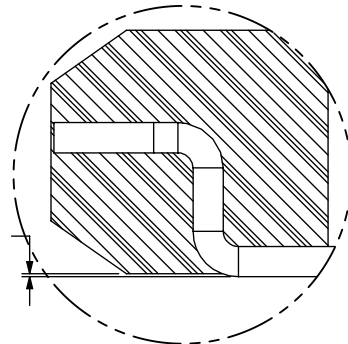
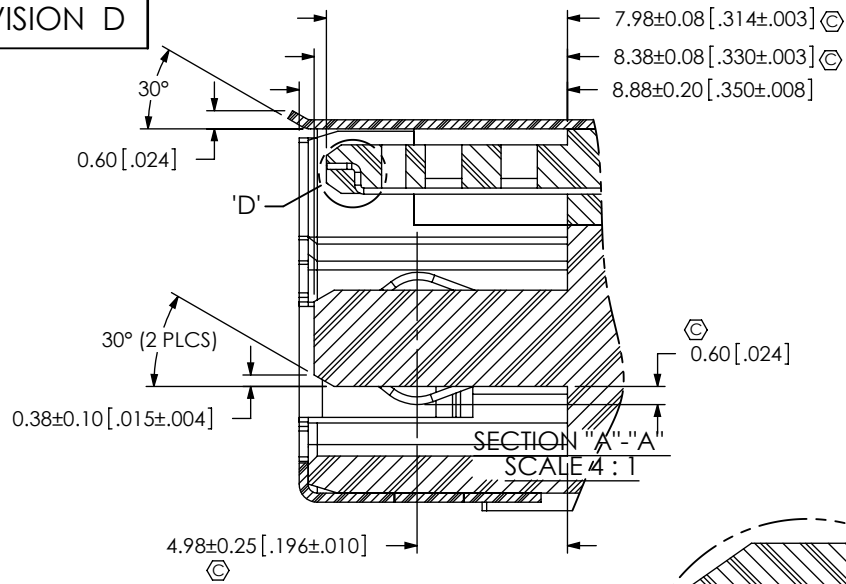

PROPRIETARY NOTE
 THIS DOCUMENT CONTAINS INFORMATION CONFIDENTIAL AND PROPRIETARY TO SAMTEC, INC. AND SHALL NOT BE REPRODUCED OR TRANSFERRED TO OTHER DOCUMENTS OR DISCLOSED TO OTHERS OR USED FOR ANY PURPOSE OTHER THAN THAT WHICH IT WAS OBTAINED WITHOUT THE EXPRESSED WRITTEN CONSENT OF SAMTEC, INC.

samtec
 520 PARK EAST BLVD, NEW ALBANY, IN 47150
 PHONE: 812-944-6733 FAX: 812-948-5047
 e-Mail: info@SAMTEC.com code 55322

DO NOT SCALE DRAWING
 SHEET SCALE: 3:1

DESCRIPTION: USB 3.0 B TYPE RECEPTACLE
 DWG. NO. USB3-B-S-X-XX-XX

BY: DUKES Z 5/25/2010 SHEET 2 OF 2