

1. MATERIAL: SEE LEGEND
2. FINISH: SEE LEGEND
3. PRODUCT SPECIFICATION: PS-08-50
4. CRIMP ACCEPTS 22 TO 26 GA. WIRE WITH (1.65)/0.65 MAX INSULATION DIA.
5. DIMENSIONS GIVEN ACROSS CENTERLINES ARE SYMMETRICAL ABOUT THOSE CENTERLINES WITHIN HALF THE TOTAL TOLERANCE.
6. OPTIONAL DESIGN (.86±.05)/.034±.002
7. THIS PART CONFORMS TO CLASS B REQUIREMENTS OF COSMETIC SPECIFICATION PS-45499-002

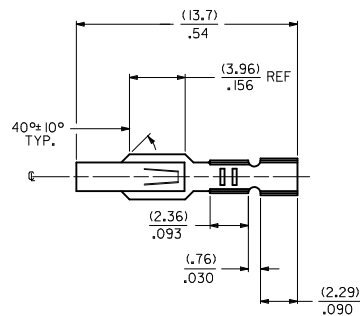
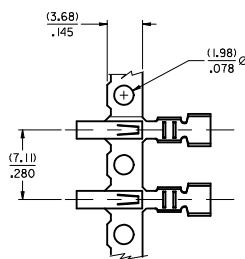

MATERIAL CODE
 (.28)/.0106 THK
 BLANK=BRASS
 B=PHOS BRONZE

2578 - * - * * *
 WINDING SPEC.
 A=PER ES-339-A
 BLANK=PER ES-339-B
 L=LOOSE

PLATING CODE
 (PER SDES-88)

OPTIONS
 BLANK=AS SHOWN
 1 = WITH CAT EARS

- (122) - OVERALL TIN: (0.00381)/.000150 MIN. OVER (0.00076)/.000030 MIN. NICKEL
- (154) - OVERALL TIN (0.00254)/.000100 MIN. OVER (0.00127)/.000050 MIN. NICKEL
- (224) - OVERALL MATTE TIN: (0.00508)/.000200 MIN. OVER (0.00127)/.000050 MIN. NICKEL
- (550) - SELECT GOLD: (0.000381)/.000015 MIN. OVERALL GOLD FLASH: (0.00005)/.000002 MIN. OVERALL NICKEL UNDERPLATE: (0.00076)/.000030 MIN.
- (555) - SELECT GOLD: (0.000381)/.000015 MIN. OVERALL NICKEL UNDERPLATE: (0.00076)/.000030 MIN.
- (558) - SELECT GOLD: (0.00076)/.000030 MIN. OVERALL GOLD FLASH: (0.00005)/.000002 MIN. OVERALL NICKEL UNDERPLATE: (0.00127)/.000050 MIN.
- (P909) - OVERALL HOT TIN DIP: (0.00254)/.000100 MIN

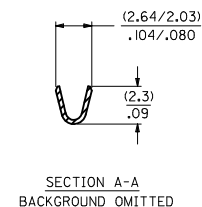
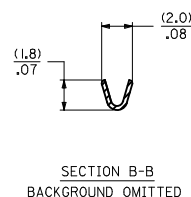
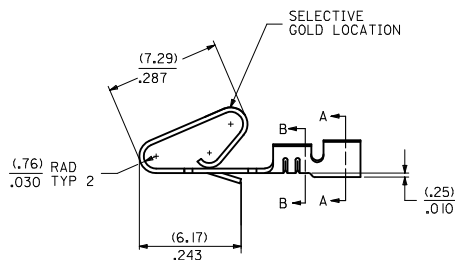
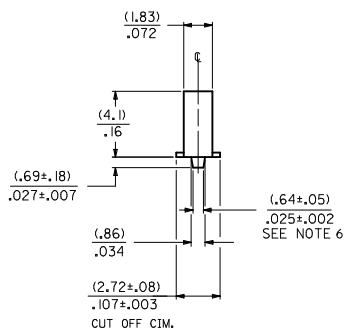

CHANGE PLATING IEC NO. UCF2012-1821 DRAWN BY: DRWINMSTROH 2012/01/11 CHECKED BY: CHYDHIKIPPER 2012/01/16 APPROVED BY: APPR:FSMITH 2012/02/02	QUALITY SYMBOLS	GENERAL TOLERANCES (UNLESS SPECIFIED)	DIMENSION STYLE	SCALE	DESIGN UNITS	THIRD ANGLE PROJECTION
	▽=0	mm INCH	MM/IN	--	INCH	☉
	▽=0	4 PLACES ± --- ± ---	DRAWN BY: PEREZ/AR	DATE: 01/29/187	TITLE: CRIMP TERMINAL (3.96)/.156 CENTERS 22 TO 26 GA WIRE	MOLEX INCORPORATED MATERIAL NO. SD-2578 DOCUMENT NO. 1 OF 2
	▽=0	3 PLACES ± --- ± .010	CHECKED BY: PATEL	DATE: 01/29/187	SIZE: D	
▽=0	2 PLACES ± 0.25 ± .014	APPROVED BY: LENZ	DATE: 01/29/187	THIS DRAWING CONTAINS INFORMATION THAT IS PROPRIETARY TO MOLEX INCORPORATED AND SHOULD NOT BE USED WITHOUT WRITTEN PERMISSION		
	1 PLACE ± 0.36 ± ---	ANGULAR ±1/2°				

2578-(***)*		2578-B-(***)*	
PART NO.	ENG. NO.	PART NO.	ENG. NO.
08-50-0107	2578-(P909)	08-50-0133	2578-B-(P909)
08-50-0108	2578-(P909)L	08-50-0134	2578-B-(P909)L
08-50-0111	2578-(154)	08-65-0116	2578-B-(555)
08-50-0112	2578-(154)L	08-65-0117	2578-B-(555)L
08-56-0107	2578-(550)	08-60-0003	2578-B-(122)
08-56-0108	2578-(550)L	08-60-0004	2578-B-(122)L
08-55-0105	2578-(555)	08-65-0110	2578-B-(558)
08-55-0106	2578-(555)L	08-65-0111	2578-B-(558)L
08-50-0061	2578-(224)	08-58-0125	2578-B-(550)
08-50-0062	2578-(224)L	08-58-0126	2578-B-(550)L
08-55-0137	2578-(558)A		
	2578-(558)L		
08-50-0018	2578-(154)		
08-50-0019	2578-(154)L		
08-55-0123	2578-(558)		
	2578-(558)L		

SEE SHEET 1 EC NO: UCP2012-1821 DRAWN: MSTR0H 2012/01/11 CHKD: HKLIPPER 2012/01/16 APPR: FSM LTH 2012/02/02	QUALITY SYMBOLS 	GENERAL TOLERANCES (UNLESS SPECIFIED) <table border="1"> <tr><th></th><th>mm</th><th>INCH</th></tr> <tr><td>4 PLACES</td><td>± .005</td><td>± .0002</td></tr> <tr><td>3 PLACES</td><td>± .005</td><td>± .0002</td></tr> <tr><td>2 PLACES</td><td>± .005</td><td>± .0002</td></tr> <tr><td>1 PLACE</td><td>± .005</td><td>± .0002</td></tr> </table>		mm	INCH	4 PLACES	± .005	± .0002	3 PLACES	± .005	± .0002	2 PLACES	± .005	± .0002	1 PLACE	± .005	± .0002	DIMENSION STYLE MM/IN	SCALE --	DESIGN UNITS INCH	THIRD ANGLE PROJECTION
		mm	INCH																		
	4 PLACES	± .005	± .0002																		
	3 PLACES	± .005	± .0002																		
2 PLACES	± .005	± .0002																			
1 PLACE	± .005	± .0002																			
DRAWN BY PEREZ/AR	DATE 01/29/87	TITLE CRIMP TERMINAL (3.96)/.156 CENTERS 22 TO 26 GA WIRE																			
CHECKED BY PATEL	DATE 01/29/87	APPROVED BY LENZ																			
MATERIAL NO. SEE CHART		DATE 01/29/87		DOCUMENT NO. SD-2578																	

DRAFT WHERE APPLICABLE MUST REMAIN WITHIN DIMENSIONS
 THIS DRAWING CONTAINS INFORMATION THAT IS PROPRIETARY TO MOLEX INCORPORATED AND SHOULD NOT BE USED WITHOUT WRITTEN PERMISSION