

LOC		DIST		REVISIONS			
P	LTR	DESCRIPTION		DATE	DWN	APVD	
	A2	REVISED (ECR-12-006771)		27AUG12	JL	WK	

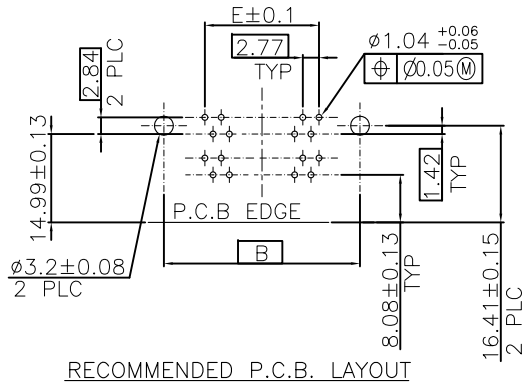

- NOTES:
- MATERIAL:
 - HOUSING/BACK COVER: THERMOPLASTIC, UL94V-0; COLOR: SEE TABLE.
 - CONTACTS: COPPER ALLOY
 - BOARDLOCK: COPPER ALLOY
 - BRACKET: ZINC ALLOY
 - SHELL: STEEL
 - FINISH:
 - CONTACT: GOLD PLATING (SEE TABLE) ON CONTACT AREA. 2.54µm[100µ"] MIN. MATTE TIN PLATING ON SOLDER TAIL AREA. 1.27µm[50µ"] MIN. NICKEL UNDERPLATING OVERALL.
 - BOARDLOCK: 1.52µm[60µ"] MIN. MATTE TIN PLATING OVERALL. 1.27µm[50µ"] MIN. NICKEL UNDERPLATING OVERALL.
 - SHELL: 1.52µm[60µ"] MIN. BRIGHT TIN PLATING OVERALL.
 - WAVE SOLDER CAPABLE TO 265°C PER TE SPEC. 109-202, CONDITION B.
- ⚠ OBSOLETE PARTS: OBSOLETE CIS STREAMLINING PER D.RENAUD/D.SINISI

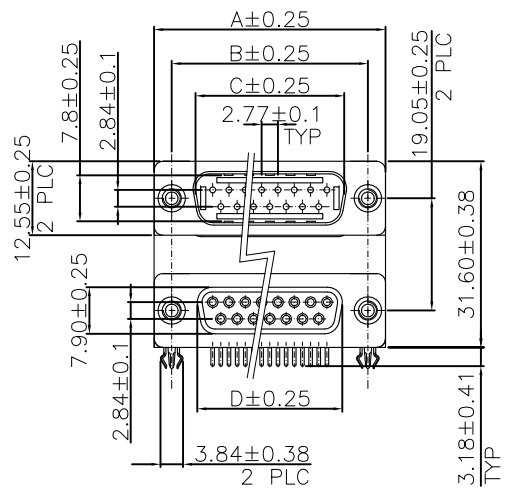
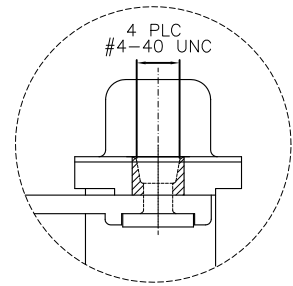
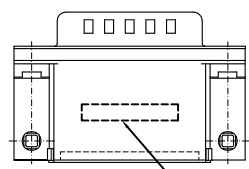
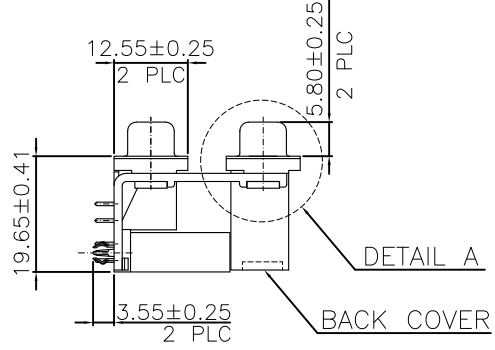
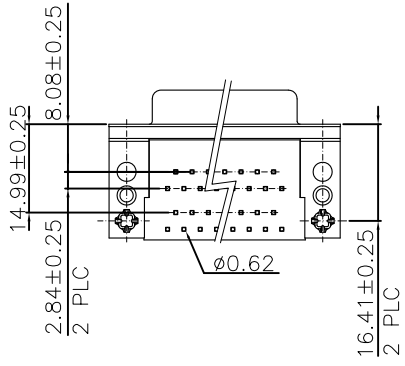

X-1734282-6	30 u"	PC99/ACTUAL COLOR	37-37 NOT AVAILABLE
X-1734282-5	10 u"	PC99/ACTUAL COLOR	
X-1734282-4	GOLD FLASH	PC99/ACTUAL COLOR	
X-1734282-3	30 u"	BLACK	
X-1734282-2	10 u"	BLACK	
X-1734282-1	GOLD FLASH	BLACK	
PART NO.	GOLD PLATING	HSG COLOR	

PART NO.	PINS	A	B	C	D	E
3-1734282-X	37-37	69.34	63.50	55.42	54.80	49.86
2-1734282-X	25-25	53.10	47.04	38.96	38.30	33.24
1-1734282-X	15-15	39.30	33.30	25.25	24.60	19.39
1734282-X	9-9	30.95	24.99	16.92	16.20	11.08

OBSOLETE	1-1734282-6
	1-1734282-5
	1-1734282-4
OBSOLETE	1-1734282-3
	1-1734282-2
OBSOLETE	1-1734282-1
	1734282-6
OBSOLETE	1734282-5
	1734282-4
OBSOLETE	1734282-3
	1734282-2
OBSOLETE	1734282-1
	PART NO.

THIS DRAWING IS A CONTROLLED DOCUMENT.

DIMENSIONS: MM	TOLERANCES UNLESS OTHERWISE SPECIFIED:	DWN S. CHIEN 18MAY2009	TE Connectivity
	0 PLC ± 0.5 1 PLC ± 0.3 2 PLC ± 0.2 3 PLC ± 4 PLC ± ANGLES ± 3'	CHK S. CHIEN 18MAY2009	
MATERIAL SEE NOTE	FINISH SEE NOTE	APVD W. KODAMA 18MAY2009	NAME
		PRODUCT SPEC 108-57517	D-SUB STACKED PLUG OVER RCPT, R/A TYPE, THREAD INSERTS
		APPLICATION SPEC 501-57590	SIZE CAGE CODE DRAWING NO RESTRICTED TO
		WEIGHT - GRAMS	A3 00779 C=1734282
		CUSTOMER DRAWING	SCALE SHEET 1 OF 2 REV A2

4

3

2

1

THIS DRAWING IS UNPUBLISHED. RELEASED FOR PUBLICATION AUG., 2006.
 © COPYRIGHT 2009 BY TYCO ELECTRONICS CORPORATION. ALL RIGHTS RESERVED.

LOC		DIST		REVISIONS			
P	LTR	DESCRIPTION		DATE	DWN	APVD	
SEE SHEET 1.							

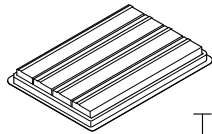
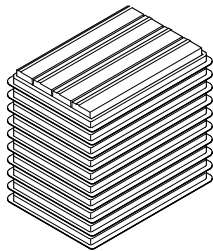

TOP COVER

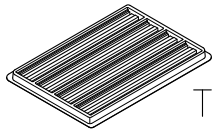

TRAY

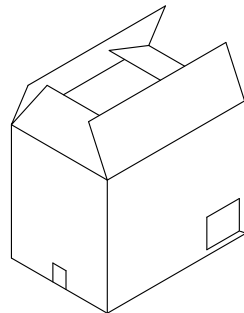

CARTON

LABEL

- NOTE :
- DIMENSION :
 TRAY : L=310, W=215, H=30
 CARTON : L=335, W=230, H=280
 - TRAY : PS or PET
 - QUANTITY:

PIN NO.	9-9	15-15	25-25	37-37
PCS/TRAY	36	28	20	16
TRAY/CARTON	10	10	10	10
PCS/CARTON	360	280	200	160
NET WT.(KG/CARTON)	9.72	9.62	9.38	10.3
GROSS WT.(KG/CARTON)	11.22	11.05	10.81	11.46

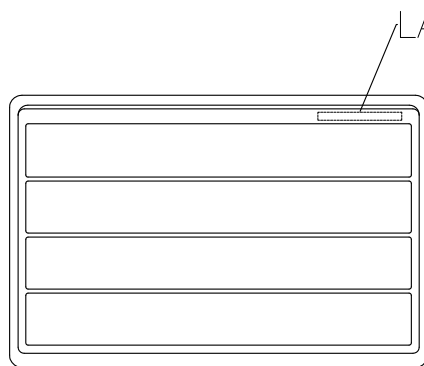

LABEL

TRAY LAYOUT

THIS DRAWING IS A CONTROLLED DOCUMENT.		DWN		TE Connectivity	
DIMENSIONS: MM		CHK			
		APVD		NAME	
TOLERANCES UNLESS OTHERWISE SPECIFIED:		PRODUCT SPEC		D-SUB STACKED PLUG OVER RCPT, R/A TYPE, THREAD INSERTS	
0 PLC ± -		APPLICATION SPEC		SIZE CAGE CODE DRAWING NO RESTRICTED TO	
1 PLC ± -		WEIGHT		A3 00779 C=1734282	
2 PLC ± -		CUSTOMER DRAWING		SCALE SHEET 2 OF 2 REV A2	
3 PLC ± -					
4 PLC ± -					
ANGLES ± -					
FINISH					