

THIS DRAWING IS UNPUBLISHED. RELEASED FOR PUBLICATION 2012
 © COPYRIGHT 2012 BY TE CONNECTIVITY ALL RIGHTS RESERVED.

| LOC | DIST | REVISIONS | | | | | |
|-----|------|-----------|-----|---------------------------|-----------|-----|------|
| CM | 00 | P | LTR | DESCRIPTION | DATE | DWN | APVD |
| | | D5 | | REVISED PER ECO-12-011527 | 19JUN2012 | RGV | DCS |
| | | D6 | | REVISED PER ECO-13-006897 | 22APR2013 | DLG | DCS |
| | | D7 | | REVISED PER ECO-13-013385 | 24OCT2013 | DLG | DCS |

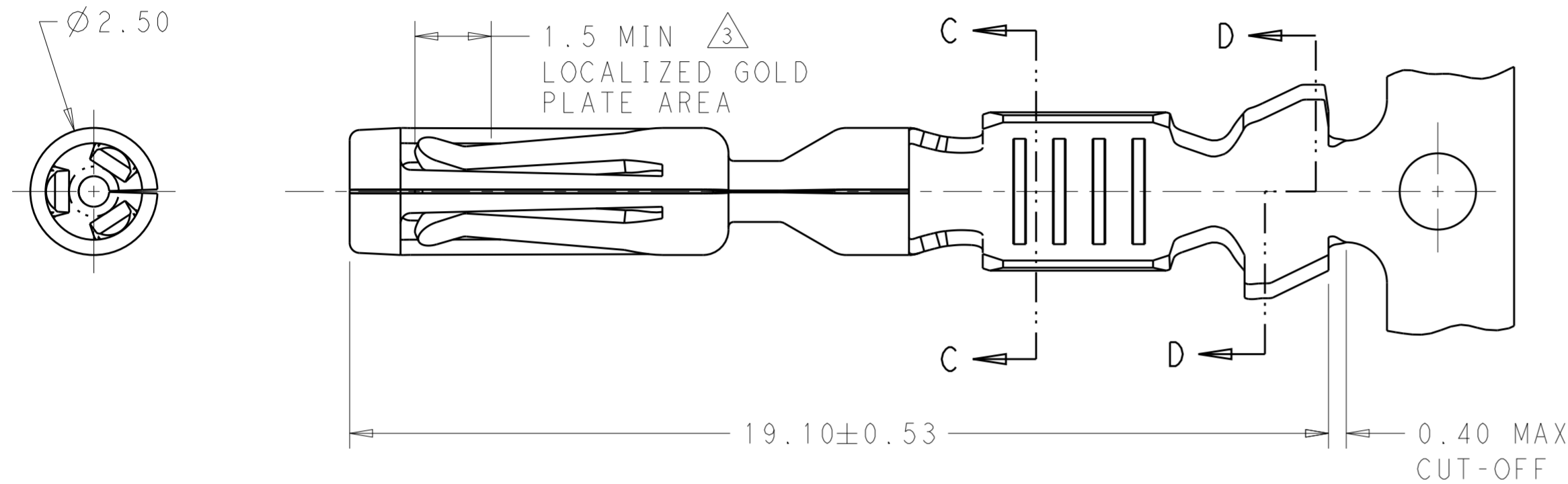

1. WIRE RANGE: 20-16 AWG, 1.0mm², 1.5mm².
2. INSULATION RANGE: 1.70-2.70.
3. .00075 MIN GOLD IN THE LOCALIZED GOLD PLATE AREA, .0025 MIN MATTE TIN IN THE LOCALIZED TIN PLATE AREA OVER .00125 MIN NICKEL OVER ENTIRE CONTACT.
4. USED WITH AMPSEAL PLUG ASSEMBLY: 776286, 776273, 770680, 776164.

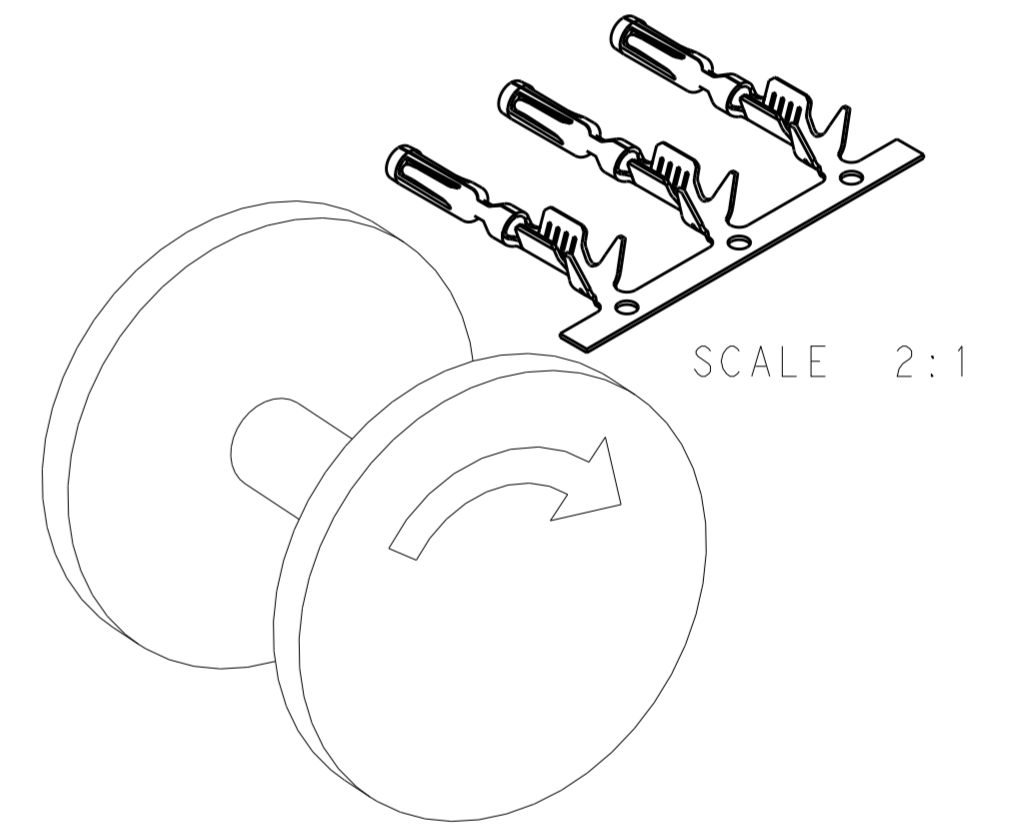
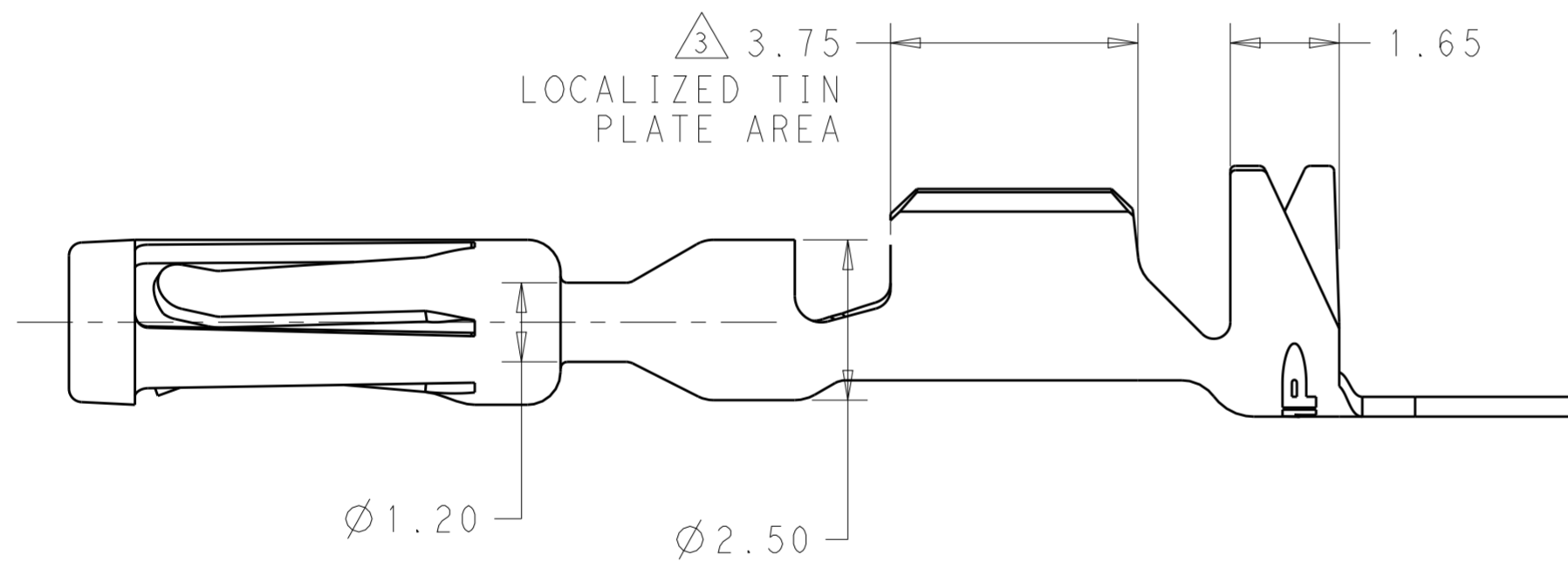
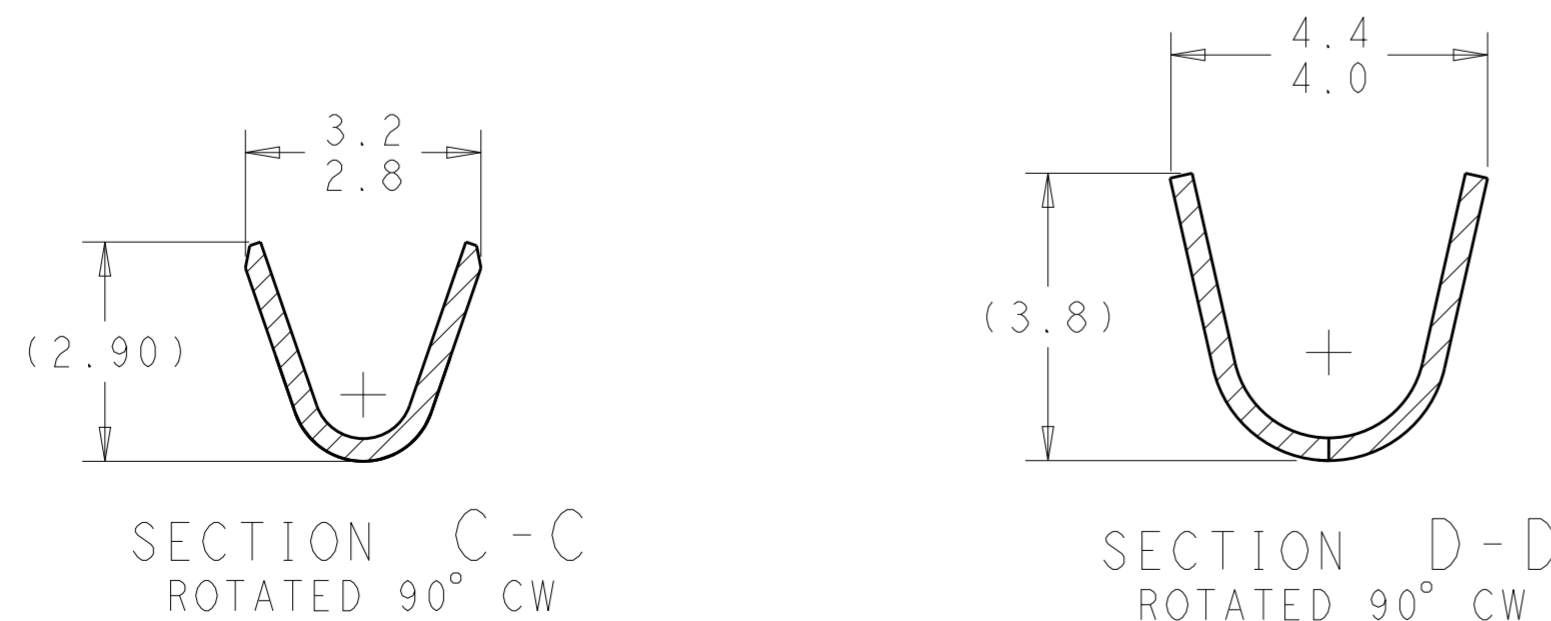

FIGURE 1
FINAL PAYOUT DIRECTION



| | | | |
|-------------|---------|-------------------|-------------|
| 770854-3 | GOLD | 0.38 COPPER ALLOY | 770520-3 |
| 770854-1 | PRE-TIN | 0.38 COPPER ALLOY | 770520-1 |
| LOOSE PIECE | FINISH | MATERIAL | PART NUMBER |

| DIMENSIONS: | | TOLERANCES UNLESS OTHERWISE SPECIFIED: | | APPROVALS | | TE Connectivity | |
|-------------|--|--|-------|------------------|------------------|-----------------|--------------|
| mm | | 0 PLC | ± | DWN | R. VESTAL | 19 JUN 2012 | |
| | | 1 PLC | ± | CHK | D. STRAUSSER | 19 JUN 2012 | |
| | | 2 PLC | ±0.15 | APVD | D. STRAUSSER | 19 JUN 2012 | |
| | | 3 PLC | ± | NAME | CONTACT, AMPSEAL | | |
| | | 4 PLC | ± | PRODUCT SPEC | 108-1329 | | |
| | | ANGLES | ± | APPLICATION SPEC | 114-16016 | | |
| | | FINISH | ± | WEIGHT | - | | |
| SEE TABLE | | SEE TABLE | | CUSTOMER DRAWING | | SCALE 10:1 | SHEET 1 OF 1 |