

NOTES:
 1. MATERIAL:
 SHIELD: DEEP DRAW STEEL,
 HOUSING: LCP, UL94V-0, NATURAL (WHITE),
 TAIL ALIGNER: LCP, UL94V-0, NATURAL (WHITE),
 CONTACT: COPPER ALLOY.
 2. PLATING: SEE SHEET 2.
 3. PRODUCT CONFORMS TO MOLEX PRODUCT SPECIFICATION NUMBER PS-74320-001. REFER TO THIS SPECIFICATION FOR SPACING ON A P.C.B. OF TWO OR MORE CONNECTORS WHEN USING A CABLE OR AN ADAPTER ASSEMBLY.
 4. SEE SHEET 2 FOR RECOMMENDED PANEL CUT-OUT AND P.C.B. LAYOUT.
 5. PARTS WILL BE PACKAGED IN TRAYS PER PK-74320-010.
 6. PRODUCT CONFORMS TO DDWG DVI SPECIFICATION. REFER TO THIS SPECIFICATION FOR CONNECTOR MATING DIMENSIONS.
 7. RECOMMENDED MOUNTING HARDWARE IS MOLEX P/N 71781-0001 OR 82007-0300 OR 88780-6066. REFER TO PRODUCT SPECIFICATION NUMBER PS-74320-001 FOR THIS APPLICATION TORQUE REQUIREMENT FOR ASSMBLING MOUNTING HARDWARE.
 ⚠️ CAVITY ID AND MANUFACTURING PLANT CODE.

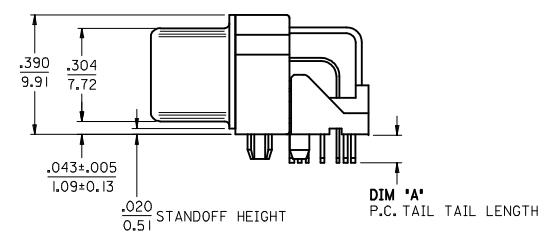

| PART NUMBER | PLATING OPTION | DIM A | DIM B |
|-------------|----------------|------------|-------------|
| 74320-1000 | 1 | 0.092/2.34 | 0.080±0.020 |
| 74320-1001 | 1 | 0.050/1.27 | 2.03±0.51 |
| 74320-1003 | 1 | 0.123/3.12 | 0.110/2.79 |
| 74320-1004 | 2 | 0.092/2.34 | 0.080±0.020 |
| 74320-1005 | 2 | 0.050/1.27 | 2.03±0.51 |
| 74320-1006 | 2 | 0.110/2.79 | 0.110/2.79 |
| 74320-1007 | 2 | 0.123/3.12 | 0.110/2.79 |

| | | |
|---------------|--------------------|------------|
| REVISED | EC NO: SH2015-0200 | 2014/12/10 |
| DRWN: XQZHANG | 2014/12/10 | |
| CHKD: XQZHANG | 2014/12/10 | |
| APPR: AYIN | 2015/02/09 | |
| REV | DESCRIPTION | |

| QUALITY SYMBOLS | GENERAL TOLERANCES (UNLESS SPECIFIED) | |
|-------------------|--|---------|
| | mm | INCH |
| $F_{\Delta} = 0$ | 4 PLACES ± --- ± --- | ± --- |
| $F_{\square} = 0$ | 3 PLACES ± --- ± 0.010 | ± 0.010 |
| $F_{\nabla} = 0$ | 2 PLACES ± 0.25 ± 0.010 | ± 0.010 |
| | 1 PLACE ± 0.25 ± 0.010 | ± --- |
| | 0 PLACE ± --- ± --- | ± --- |
| | ANGULAR ± 0.5° | |
| | DRAFT WHERE APPLICABLE MUST REMAIN WITHIN DIMENSIONS | |

| DIMENSION STYLE | | SCALE | DESIGN UNITS | THIRD ANGLE PROJECTION |
|-----------------|---|--|--------------|------------------------|
| IN/MM | | 1:1 | INCH | |
| DRAWN BY | DATE | TITLE | | |
| XQZHANG | 2014/12/10 | DVI - INTERGRATED RIGHT ANGLE RECEPTACLE CONNECTOR | | |
| CHECKED BY | DATE | | | |
| XQZHANG | 2014/12/10 | | | |
| APPROVED BY | DATE | | | |
| AYIN | 2015/02/09 | molex | | |
| MATERIAL NO. | | DOCUMENT NO. | | SHEET NO. |
| SEE TABLE | | SD-74320-001 | | 1 OF 2 |
| SIZE | THIS DRAWING CONTAINS INFORMATION THAT IS PROPRIETARY TO MOLEX INCORPORATED AND SHOULD NOT BE USED WITHOUT WRITTEN PERMISSION | | | |
| A3 | | | | |

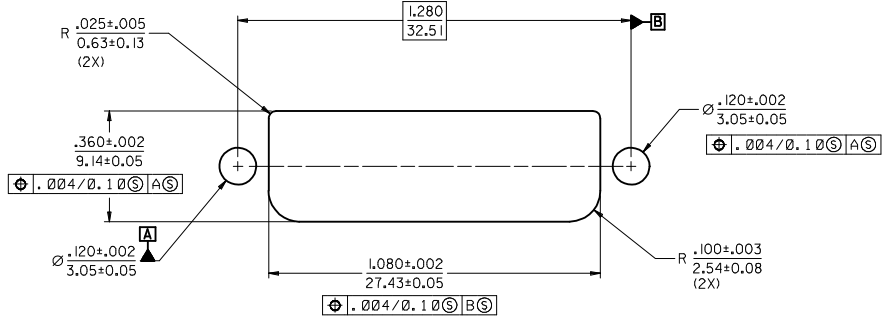
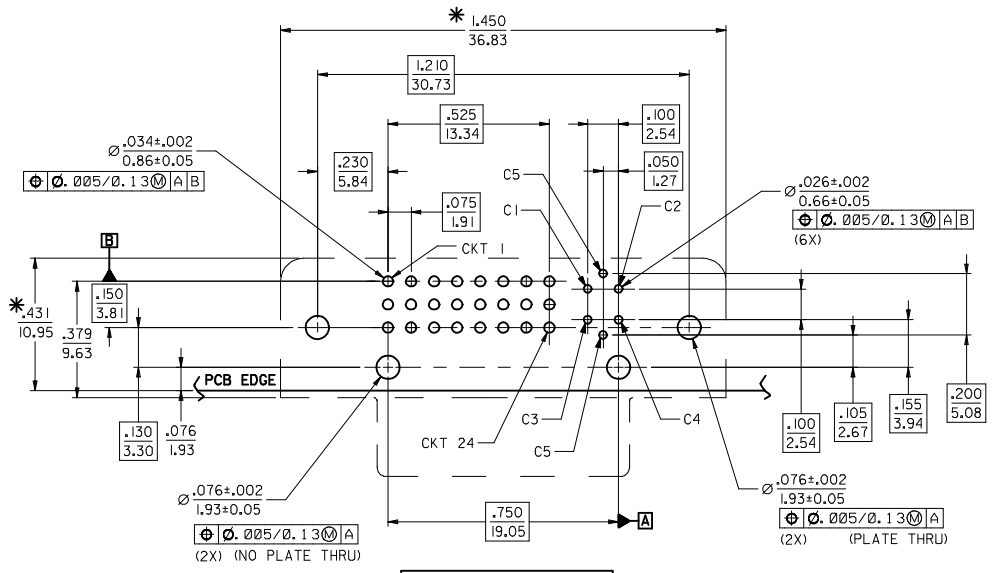

| | | | | | | | | | |
|---|--|---|--|--------------|----------------------|------------------------|---|------------------------------|---------------------|
| SEE SHEET 1 EC NO: SH2015-0200 DRWN: XQZHANG 2014/12/10 CHKD: XQZHANG 2014/12/10 APPR: AYIN 2015/02/09 | QUALITY SYMBOLS $F_A=0$ $F_C=0$ $F_P=0$ | GENERAL TOLERANCES (UNLESS SPECIFIED) mm INCH 4 PLACES ± --- ± --- 3 PLACES ± --- ± 0.10 2 PLACES ± 0.25 ± 0.10 1 PLACE ± 0.25 ± 0.10 0 PLACE ± --- ± --- ANGULAR ± 0.5° DRAFT WHERE APPLICABLE MUST REMAIN WITHIN DIMENSIONS | DIMENSION STYLE IN/MM DRAWN BY: XQZHANG CHECKED BY: XQZHANG APPROVED BY: AYIN MATERIAL NO.: SEE SHEET 1 | SCALE 1:1 | DESIGN UNITS INCH | THIRD ANGLE PROJECTION | TITLE DVI - INTERGRATED RIGHT ANGLE RECEPTACLE CONNECTOR molex | DOCUMENT NO. SD-74320-001 | SHEET NO. 2 OF 2 |
| | DRAWN BY: XQZHANG DATE: 2014/12/10 | | DATE: 2014/12/10 | | DATE: 2015/02/09 | | THIS DRAWING CONTAINS INFORMATION THAT IS PROPRIETARY TO MOLEX INCORPORATED AND SHOULD NOT BE USED WITHOUT WRITTEN PERMISSION | | |
| | DATE: 2015/02/09 | | DATE: 2015/02/09 | | DATE: 2015/02/09 | | THIS DRAWING CONTAINS INFORMATION THAT IS PROPRIETARY TO MOLEX INCORPORATED AND SHOULD NOT BE USED WITHOUT WRITTEN PERMISSION | | |
| | DATE: 2015/02/09 | | DATE: 2015/02/09 | | DATE: 2015/02/09 | | THIS DRAWING CONTAINS INFORMATION THAT IS PROPRIETARY TO MOLEX INCORPORATED AND SHOULD NOT BE USED WITHOUT WRITTEN PERMISSION | | |