

DIALIGHT PART NUMBER	COLOR
551-3508-801	RED/GREEN
551-3508-801F	RED/GREEN

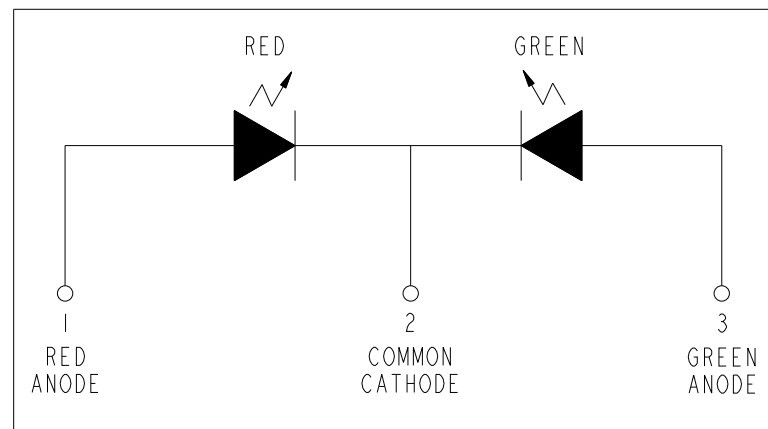

REV	ECN NO	REVISIONS	DRN	CKD	APP	DATE
A	---	NEW RELEASE	MC	---	N.O.	8-22-95
B	---	ADDED P/N 551-3508-801F; UPDATED OPERATING CHARACTERISTICS, SCHEMATIC, FORMAT & NOTES; ADDED Ø.122, ABSOLUTE MAXIMUM RATINGS & FAMILY PART TABLE.	TWC	TC	AV	6-15-05
C	---	".385 MAX" WAS ".380 MAX"; ".110 ±.015" WAS ".106±.005"; UPDATED TOLERANCES, ADDED NOTES 2 AND 3.	KLJ	NO	AV	2-4-09
D	---	UPDATED LED SPECS	VP	JTD	NO	9-10-15

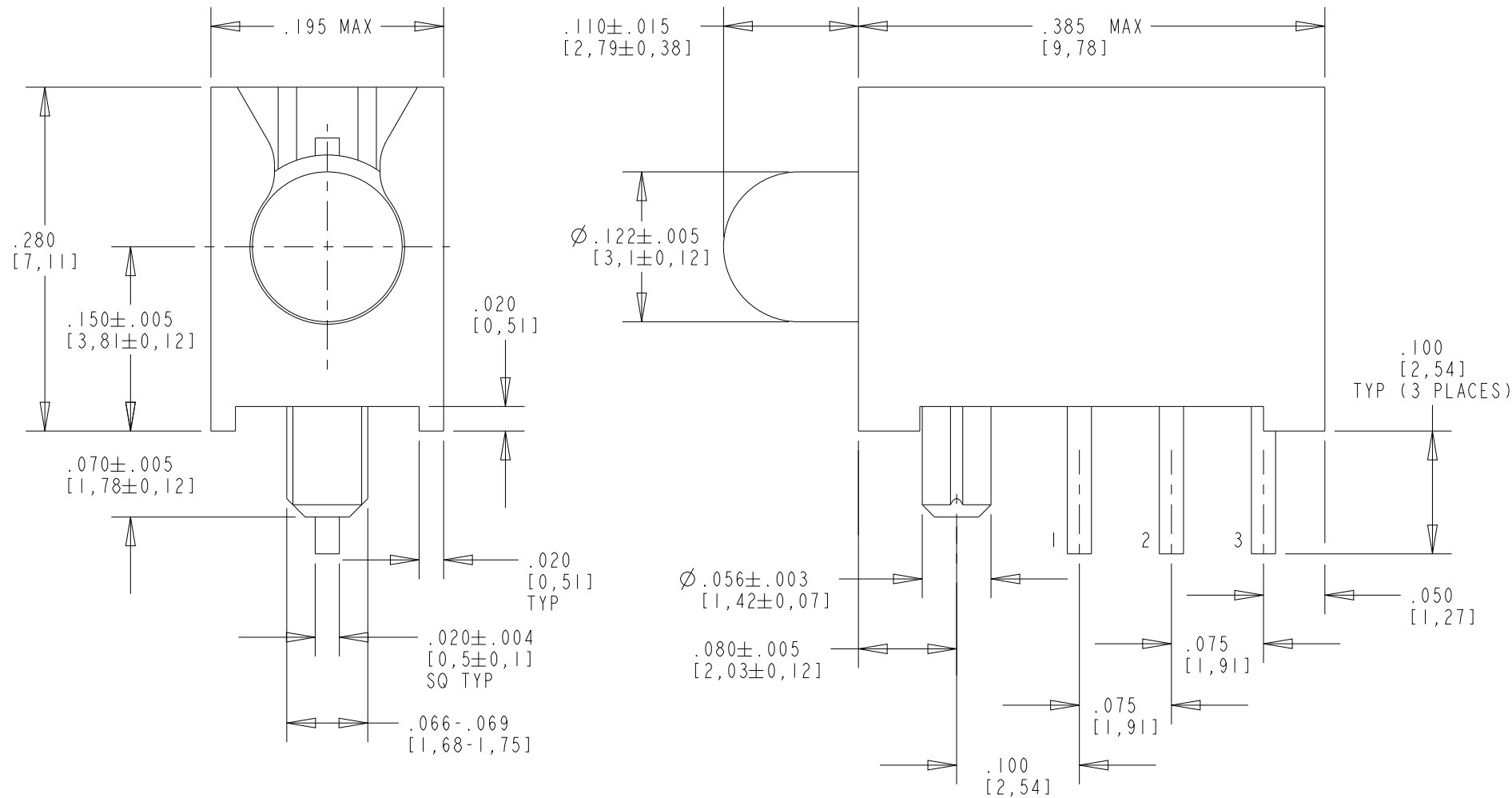

OPERATING CHARACTERISTICS AT 25°C AMBIENT						
LED CHARACTERISTICS	COLOR	MIN.	TYP.	MAX.	UNITS	TEST CONDITIONS
LUMINOUS INTENSITY	RED	4	8		mcd	I _F = 20 mA
	GREEN	6	12			
FORWARD VOLTAGE	RED		2.0	2.5	V	I _F = 20 mA
	GREEN		2.1			
REVERSE CURRENT	RED			100	μA	V _R = 4 V
	GREEN					
PEAK WAVELENGTH (λ _p)	RED		630		nm	
	GREEN		560			
VIEWING ANGLE 2θ _{1/2}	RED		59		DEG	I _F = 20 mA
	GREEN		68			
DOMINANT WAVELENGTH	RED		624		nm	
	GREEN		567			

ABSOLUTE MAXIMUM RATINGS AT 25°C AMBIENT	RED	GREEN	UNITS
POWER DISSIPATION	75		mW
AVERAGE FORWARD CURRENT	30		mA
PULSE FORWARD CURRENT (D<1/20, t < 1 ms)	90		mA
DERATING LINEAR FROM 25°C	0.33		mA
REVERSE VOLTAGE	4		V
LEAD SOLDERING TEMPERATURE FOR 5 SEC.	260		°C
OPERATING TEMPERATURE	-30 TO +85		°C
STORAGE TEMPERATURE	-30 TO +100		°C

NOTES:

- PRODUCT P/N WITH "F" SUFFIX ENDING IS RoHS COMPLIANT. DIALIGHT P/N 550-3508-801, -801F LED LEADS ARE PLATED TIN (Sn), SILVER (Ag), COPPER (Cu).
- LED LEAD DIMENSIONS SHOWN ARE MEASURED AT HOUSING EXIT.
- LEADS TO FIT INTO HOLES SPACED AS PER PATTERN.

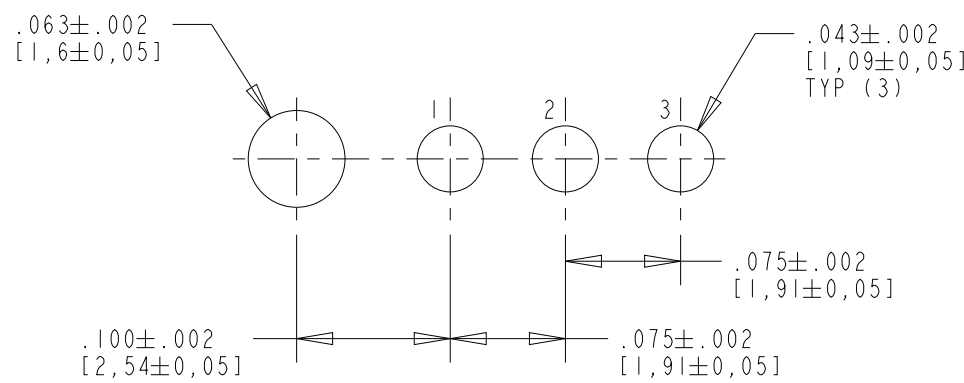

RECOMMENDED PC BOARD HOLE PATTERN

THIS DRAWING AND THE CONTENTS HEREIN ARE CONFIDENTIAL AND THE SOLE PROPERTY OF DIALIGHT. REPRODUCTION OF THIS DRAWING OR CONSTRUCTION OF ANY PARTS WITHIN THIS DRAWING ARE FORBIDDEN WITHOUT THE WRITTEN CONSENT OF DIALIGHT.

SCALE: DRAWING SCALE ALL DIM'S IN: INCHES (MM)	DRAWING NUMBER C-16015	REV D
TOLERANCES: UNLESS OTHERWISE SPECIFIED FRACTIONS: ±1/64 DECIMALS (.XX): ±.02 DECIMALS (.XXX): ±.010	TITLE 3mm BI-COLOR CBI 3 LEADED R/G	
ANGLES: ±3° FINISH:	MATERIAL	
FSCM 83330	1501 ROUTE 34 SOUTH FARMINGDALE, NJ 07727	
SHEET 1 OF 1		FAMILY TABLE: