

| Part No. | Cable color |
|----------|-------------|
| ~088*1~ | GRAY |
| ~088*2~ | BLACK |
| ~088*3~ | WHITE |

NOTE ① We indicate the length of the harness on the last of product name. 'L' part.

② Tolerance for [L]

| Length L [mm] | Tolerance [mm] |
|----------------------|----------------|
| $35 \leq L \leq 200$ | ±4 |
| $200 < L \leq 500$ | ±8 |
| $500 < L \leq 1000$ | ±12 |
| $1000 < L$ | ±1.5% |

③ Connector rotation angle is within ±45 degree from the above image. For long length in the case of L>500, the angle is optional.

4. Specifications are subject to change without notice.

【 DIMENSIONS OF CONNECTOR 】

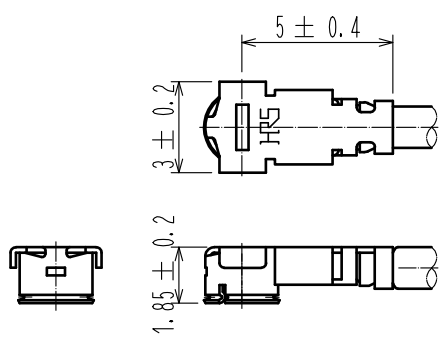

| | | | | |
|-----|-------------|--------------|-----|-------------------------|
| 1 | U.FL-LP-088 | CL331-0454-0 | 2 | 1.37 Dia. coaxial cable |
| NO. | PART NO. | CODE NO. | NO. | PART NO. |

| UNITS mm | SCALE FREE | COUNT | DESCRIPTION OF REVISIONS | DESIGNED | CHECKED | DATE |
|--------------------------------------|---------------|-------|--|---|---------|----------|
| | | | | | | |
| HRS HIROSE ELECTRIC CO., LTD. | | | APPROVED :NK. NINOMIYA 16.07.22 CHECKED :MT. KANEKO 16.07.21 DESIGNED :MS. MATSUMOTO 16.07.21 DRAWN :MS. MATSUMOTO 16.07.21 | DRAWING NO. PART NO. U.FL-2LP-088**T-A-L CODE NO. | | |
| | | | | | | ① 1/1 |