

1

2

3

4

5

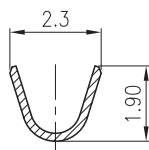
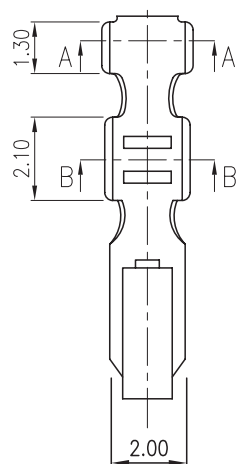

A-A

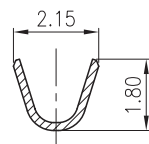

B-B

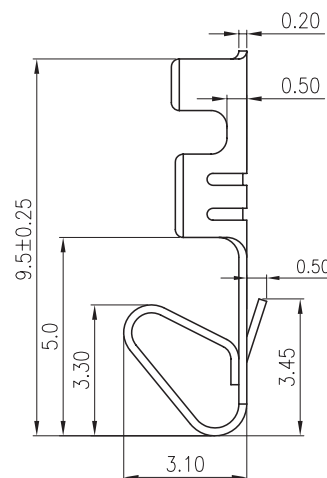
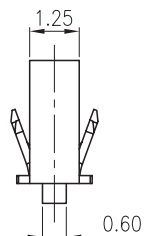

TECHNICAL CHARACTERISTICS

MATERIAL
 CONTACT MATERIAL: COPPER ALLOY
 CONTACT TYPE: STAMPED
 CONTACT PLATING: TIN
 QUALITY CLASS: 25 MATING CYCLES
 PITCH: 2.54MM

ENVIRONMENTAL
 OPERATING TEMPERATURE: -40 UP TO 125°C
 COMPLIANCE: LEAD FREE AND ROHS

ELECTRICAL
 CURRENT RATING: 3A
 WORKING VOLTAGE: 250V AC
 CONTACT RESISTANCE: 20 mOHM MAX

WIRE DIMENSION
 AWG: AWG 22 - 28

PACKAGING
 BULK/LOOSE DELIVERY IN A BAG
 EACH TERMINAL SEPARATED FROM EACH OTHER
 NOT ON A REEL
 100PCS/PER BAG. MULTIPLE OF 100PCS ONLY
 1PC OF 61900113722DEC=1 CRIMP TERMINAL
 SO 1 BAG MEANS 100 PCS OF 61900113722DEC

RoHS Compliant

PROJECTION:

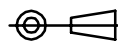

GENERAL TOLERANCE

.X = \pm 0.2.XX = \pm 0.15

APPROVAL: RJ

UNIT: MM

DESCRIPTION: 2.54 MM FEMALE CRIMP TERMINAL

SIZE

SCALE:

WERI PART NO: 61900113722DEC

A4

SHEET: 1/1

DRAW: PEARL

G			
F			
E			
D			
C			
B	06-AUG-13	CHARACTERISTIC	QL
A	11-MAY-10	PDF	JP
REV	DATE	FILE	BY