

REVISIONS			
REV	DESCRIPTION, ECN, EAR NO.	DATE	APP'D
A	PROPOSAL DRAWING	FEB 14/05	K.L
B	PROPOSAL DRAWING	MAR 04/16	L.CHAN

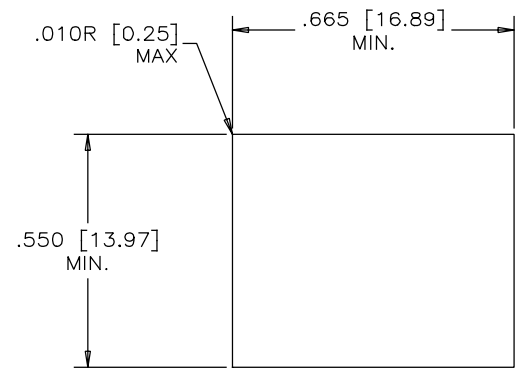

RECOMMENDED PANEL CUTOUT

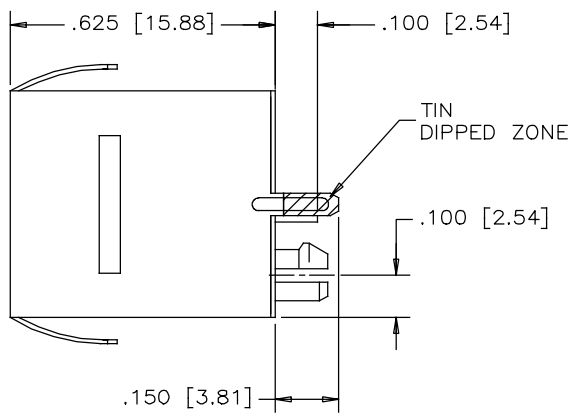
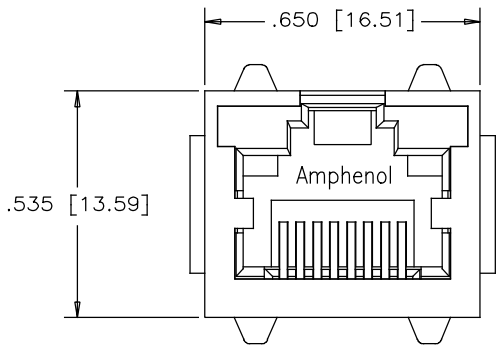
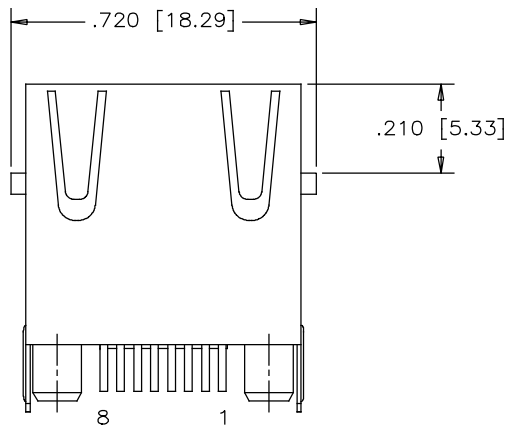

MATERIALS:

PLASTIC HOUSING: HIGH TEMPERATURE THERMOPLASTIC
FLAMMABILITY RATING UL 94V-0

CONTACTS:

PHOSPHOR BRONZE
PLATING: 30 μ" [0.76 MICRONS]
MIN. GOLD ON MATING SURFACES.
50 μ" [1.27 MICRONS]
MIN. NICKEL UNDERPLATE
100 μ" [2.54 MICRONS]
MIN. MATTE TIN ON CONTACT TAILS.

SHIELD:

STAINLESS STEEL WITH TIN DIPPED ON SOLDER TAILS.

RECOMMENDED SOLDERING TEMPERATURE:

WAVE SOLDERING TEMPERATURE AT 260°C MAXIMUM
FOR 5 SEC MAXIMUM.

ENVIRONMENTAL: OPERATING TEMPERATURE: -55°C to 85°C

AMPHENOL PART NUMBER: RJHSE-3P80

- 0 = NO LEDS
- 8 = 8 POSITIONS, 8 CONTACTS
- P = VERTICAL STYLE SHIELD FOR FLANGE & 4 SIDE GROUND TABS
- 3 = TOP ENTRY CONNECTOR

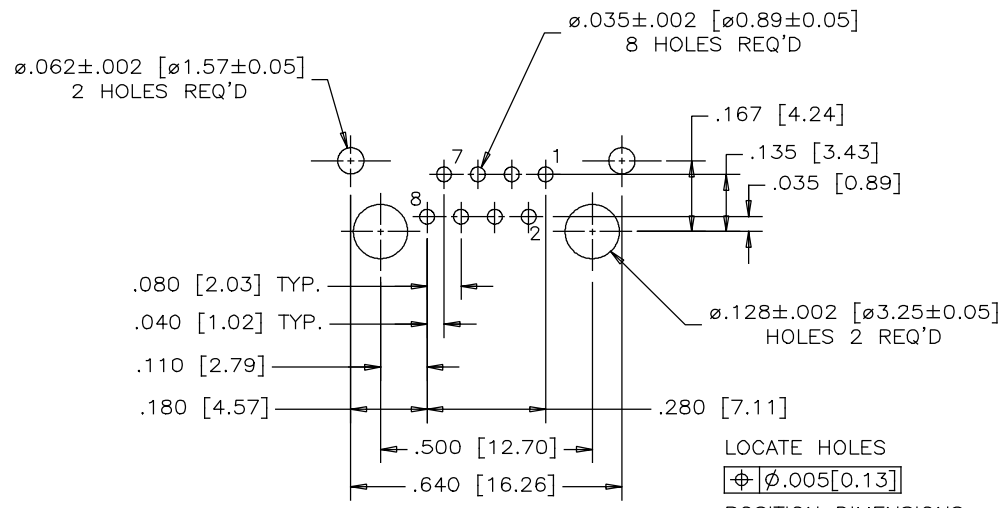

RECOMMENDED P.C.B. LAYOUT
(COMPONENT SIDE OF BOARD)

LOCATE HOLES
 $\phi \pm .005 [0.13]$
 POSITION DIMENSIONS ARE BASIC

UNLESS SPECIFIED OTHERWISE	DRAWN	K.LAMBIE	FEB.14/05
PRIMARY UNITS INCH	CHECKED	L.CHAN	FEB.14/05
SECONDARY UNITS MILLIMETER	M.E. APP'D		
REFERENCE IN PARENTHESES	Q.A. APP'D		
1 DECIMAL PLACE ±0.025	DWG APP'D		
2 DECIMAL PLACE ±0.020	ENG. REL. NO.		
3 DECIMAL PLACE ±0.015	REF.		
ANGULAR DEGREES ±1°	THIRD ANGLE PROJECTION		

Amphenol Canada Corp. www.amphenolcanada.com			
SINGLE-PORT HIGH SPEED MODULAR JACK, 8 POSITIONS, 8 CONTACTS, WITH FLANGE & SHIELD WITH 4 SIDE GROUND TABS -RoHS COMPLIANT			
DWG NO.	P-RJHSE-3P80		REV B
CODE ID NO. 03554	DWG SIZE: C	SCALE: N/A	SHEET 1 OF 1