

This document is the property of Amphenol Corporation and is delivered on the express condition that it is not to be disclosed, reproduced or used, in whole or in part, for manufacture or sale by anyone other than Amphenol Corporation without its prior consent, & that no right is granted to disclose or to use any information in this document.

# Customer drawing

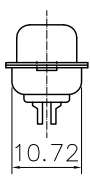

09,15,25,37 Positions

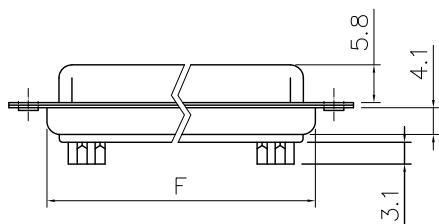
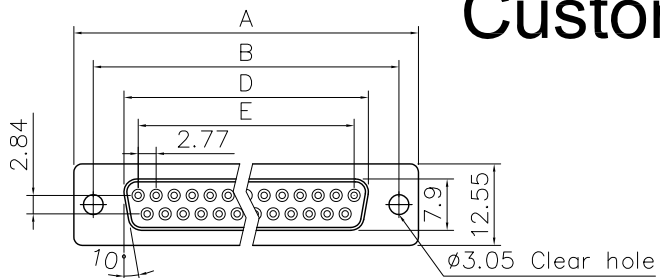
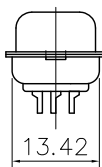
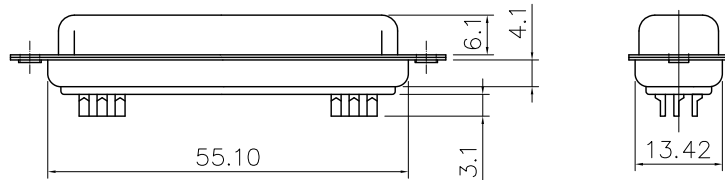
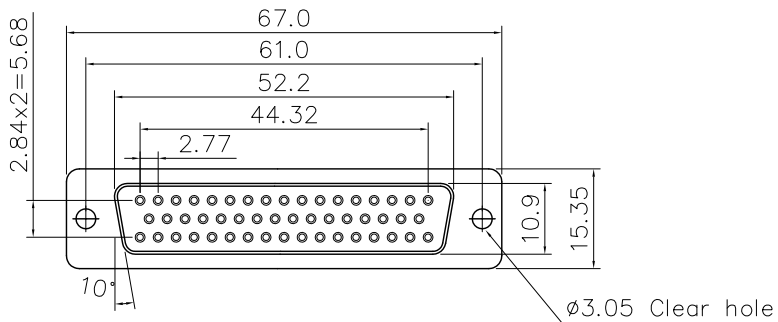

50 Positions

## Dimensions

Positions	A	B	D	E	F
9	30.81	24.99	16.33	11.08	19.20
15	39.20	33.30	24.70	19.39	27.70
25	53.05	47.04	38.40	33.24	41.10
37	69.40	63.50	54.80	49.86	57.30

## REVISIONS

SYM	ECN	DESCRIPTION	DATE	APPROVED
1	HK--	First Release Drawing	10/23/08	IP
2	HK--	Change contact material	08/24/10	IP
3	HK--	Update tail length	04/17/12	IP
4	HK--	Update the Drawing	08/13/13	IP

## D-SUB TECHNICAL DATA

SHELL : Steel, 100u" Tin Over 50u" min nickel over 50u" min Copper  
 BODY : Glass-Filled Thermoplastic PBT,UL94V-0  
 CONTACTS : Brass  
 Gold flash over 50u" nickel on mating area  
 100u" tin over 50u" nickel on solder area  
 ELECTRICAL : Contact Resistance : 20 milliohms Max  
 Insulation Resistance : 1000megohms at 500 VDC  
 Dielectric Withstanding Voltage :1000 VAC/RMS  
 Current Rating : 3 AMP  
 Voltage Rating : 250 VAC/RMS  
 MARKING : Amphenol...(Series No.)  
 Commercial reference  
 Manufacturing date

## PRODUCT CODE

**L 77 SD X XX S**

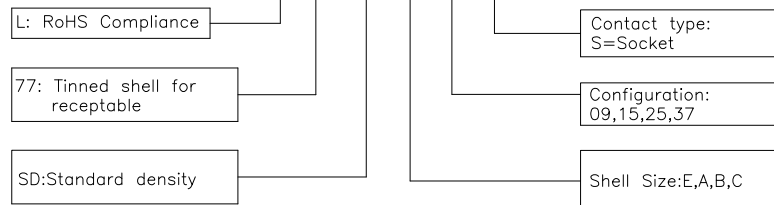

UNLESS OTHERWISE SPECIFIED TOLERANCES		APPROVAL		DATE
U.S.	METRIC	DRAWN	Checked	
.X +/-	0.50	Felix Liu		8/13/13
.XX +/-	0.30	Tony Tang		8/13/13
.XXX +/-	0.20	CHECKED		
FRACTIONS +/-				
ANGLES +/-	5°			
FOR MATERIALS AND FINISHES SEE NOTES		DRAWING FILE :		
REMOVE SHARP EDGES		ANGLE OF PROJECTION		
DIMENSIONS				
U.S.	INCHES			
METRIC	MM			

Amphenol		Amphenol East Asia Limited	
TITLE			
Stamped and formed contact,SD series			
SIZE	DRAWING NO.	REV.	
A4	C L77SDXXXS	4	
SCALE	NONE	SHEET 1 OF 1	