

Recommended PCB Layout

☒ Solder Area

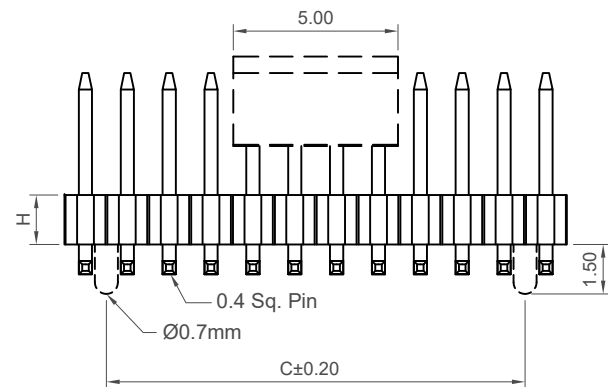
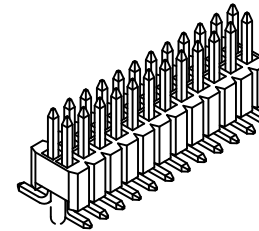
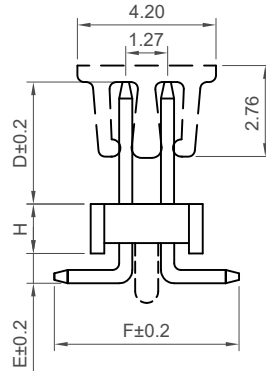

Specifications 规格

Material 物料

Insulator Material 绝缘体物料:
Polymer 聚合物, LCP, UL 94V-0
Contact Terminal 接触端子: Copper Alloy

Plating 电镀

See Ordering Grid

Electrical 电气

Current Rating 电流额定值: 1A per pin
Contact Resistance 接触电阻值: 20 mΩ max.
Insulating Resistance 绝缘电阻值: 1000 MΩ min.
Dielectric Withstand Voltage 耐压: 300V AC

Soldering Process 可焊性:

IR Reflow 回流焊: 260°C for 10 sec.
Wave 波峰焊: 250°C for 5-10 sec
Manual Solder 人工焊接: 350°C for 3-5 sec

Mechanical & Environmental 机械 & 环境

Operating Temperature 工作温度: -40°C to +105°C

Mates with 配套之母座

(Subject to pin length 在端子长度适合的条件下)
BD050 BD055 BD060 BD064
BD065 BD091 BD092

Ordering Grid

BD095 XX X XX - XXXX - XXXX - XXXX - XX Request Samples and Quotation

No. of Contacts
06 to 66

Contact Plating

A = Gold Flash All Over (Standard)
B = Selective Gold Flash Contact Area/Tin On Tail
C = Tin All Over
G = 10µ" Gold Contact Area/Tin On Tail
H = 15µ" Gold Contact Area/Tin On Tail
I = 30µ" Gold Contact Area/Tin On Tail

Insulator Height "H"

A = 1.50mm (Standard)
K = 1.00mm
B = 2.00mm
L = 2.50mm
F = 3.00mm

Locating Peg

0 = Without
1 = With

Dimension D (1/100mm) (Post Height)

0200 = 2.00mm (Standard)
0350 = 3.50mm (Standard)
or specify Custom Post Height
eg 2.50mm = 0250

Packing Options

B = Tape and Reel with Cap (Standard)
D = Tube (not available in 6, 8 & 10 Contacts)
E = Tube with Cap (not available in 6, 8 & 10 Contacts)
G = Plastic Box (only available in 6, 8 & 10 Contacts)

Insulator Material

L = LCP (Insulator H = A, B, L, F)
N = Nylon 6T (Insulator H = K)

Dimension F (1/100mm) (Width of Footprint)

0570 = 5.70mm (Standard)
or specify Custom Footprint Width
eg. 2.50mm = 0250

Dimension E (1/100mm) (PCB to Insulator)

0070 = 0.70mm (Standard)
or specify Custom PCB to Insulator dimension
eg. 2.50mm = 0250 (Minimum = 0.70mm)

Number of Contacts	Dimension		
	A	B	C
6	2.54	3.81	1.27
8	3.81	5.08	2.54
10	5.08	6.35	3.81
12	6.35	7.62	5.08
14	7.62	8.89	6.35
16	8.89	10.16	7.62
18	10.16	11.43	8.89
20	11.43	12.70	10.16
22	12.70	13.97	11.43
24	13.97	15.24	12.70
26	15.24	16.51	13.97
28	16.51	17.78	15.24
30	17.78	19.05	16.51
32	19.05	20.32	17.78
34	20.32	21.59	19.05
36	21.59	22.86	20.32
38	22.86	24.13	21.59
40	24.13	25.40	22.86
42	25.40	26.67	24.13
44	26.67	27.94	25.40
46	27.94	29.21	26.67
48	29.21	30.48	27.94
50	30.48	31.75	29.21
52	31.75	33.02	30.48
54	33.02	34.29	31.75
56	34.29	35.56	33.02
58	35.56	36.83	34.29
60	36.83	38.10	35.56
62	38.10	39.37	36.83
64	39.37	40.64	38.10
66	40.64	41.91	39.37

Part Number		Product Description	
BD095		1.27mm Pitch Pin Header, Dual Row, Surface Mount, Vertical	
Drawing Date		28th December 2007	
By	AJO	Tolerances (Except as Noted)	
Detail	BD095 I PCN	Length	Angle
Revision	I2	X. ± 0.30	X.° ± 5°
Date	06/03/17	X.X ± 0.20	X.X° ± 2°
		X.XX ± 0.15	X.XX° ± 1°
		X.XXX ± 0.10	X.XXX° ± 0.5°
Units:		Metric (mm)	
RoHS COMPLIANT 2011/65/IEU		3rd Angle Projection	
This drawing is confidential and copyright of Global Connector Technology, Ltd (GCT). This drawing must not be copied or disclosed without written consent. E & OE			

GCT
Global Connector Technology
www.gct.co

Not to Scale | Drawn By LYH | Sheet No. 1/1