

ISS.	AMEND	DATE
1	ISSUED	30/5/97

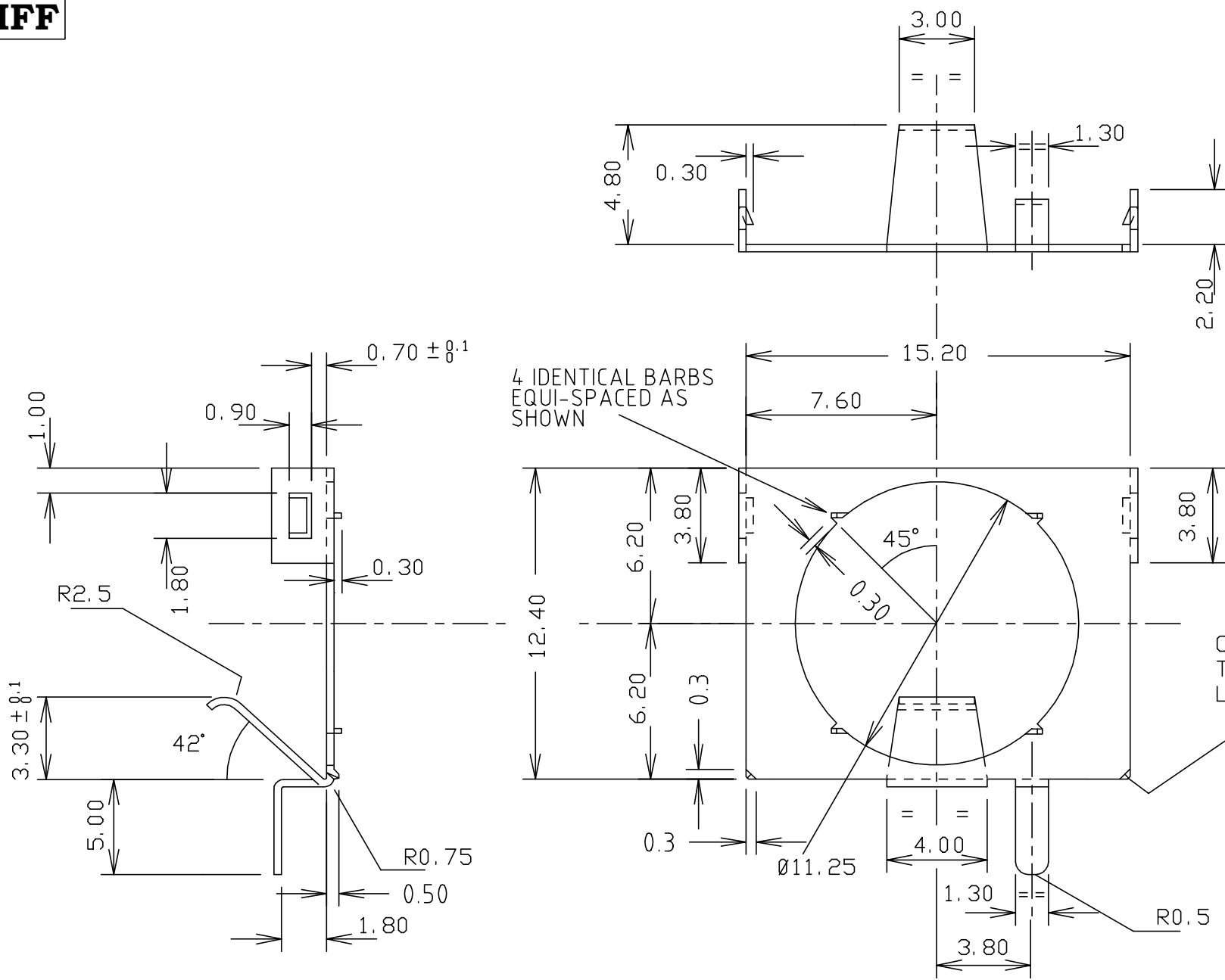

RoHS COMPLIANT
Tolerance
NO DEC. PLACE \pm
1 DEC. PLACE \pm
2 DEC. PLACE ± 0.1
DIA. HOLES ± 0.1
ANGLES $\pm 1/2^\circ$
UNLESS OTHERWISE STATED

1ST DRAWN : 25/7/95 WHERE USED F.R.
SCALE N.T.S.

DIMENSIONS IN MILLIMETERS UNLESS OTHERWISE STATED. WORK TO DIMENSIONS. DO NOT SCALE DRAWING. 3rd ANGLE PROJECTION. REMOVE BURRS. IF IN DOUBT ASK.		TITLE EARTHING WASHER FOR S1 JACK (TYPE C)	
Cliff Electronic Components Limited 76 Holmethorpe Ave., Holmethorpe Ind. Estate, Redhill, Surrey. RH1 2PF. England. Tel: 01737-771375 Fax: 01737-766012		DRWG. No. CL 14423	
MATERIAL HARD BRASS TO BS2870 CZ108.H 0.3mm +0.05-0 THK	FINISH TIN PLATED	APPD. RWT	FORM: A4DRWGH
DRAWN C.A.M.J.			