

4

3

2

1

THIS DRAWING IS UNPUBLISHED. RELEASED FOR PUBLICATION  
 © COPYRIGHT - By - ALL RIGHTS RESERVED.

| REVISIONS |     |                           |           |     |      |
|-----------|-----|---------------------------|-----------|-----|------|
| P         | LTR | DESCRIPTION               | DATE      | DWN | APVD |
|           | R1  | REVISED PER ECO-11-004917 | 11MAR11   | RK  | HMR  |
|           | R2  | REVISED PER ECO-17-006294 | 09OCT2017 | RS  | DR   |

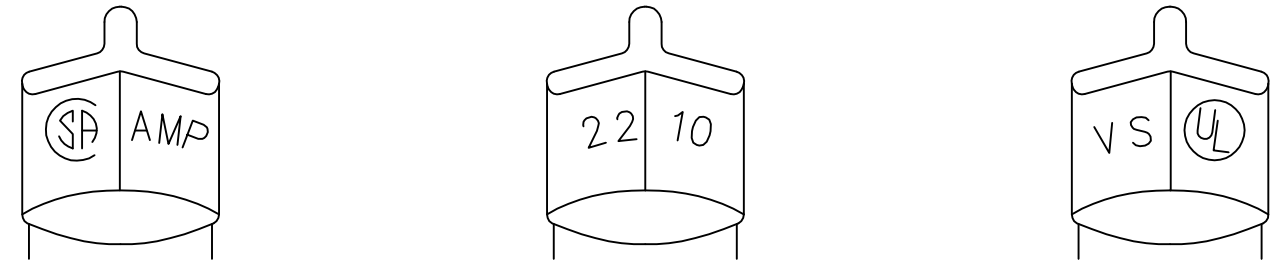

STAMPING DETAIL

- 1 FOR  $\phi 7.92$  [ $\phi .312$ ] MAX WIRE INSULATION.
- 2 NOTE DELETED.
- 3 MATERIAL: BODY; COPPER PER ASTM B152 INSULATION; PVC COLOR; PURPLE
- 4 FINISH: BODY; TIN PLATE PER ASTM B-545

|                             |                             |                             |
|-----------------------------|-----------------------------|-----------------------------|
| AMP WIRE RANGE              | Listed                      | LR7189 Certified            |
| 22-10 AWG SOLID OR STRANDED | 22-10 AWG SOLID OR STRANDED | 22-10 AWG SOLID OR STRANDED |

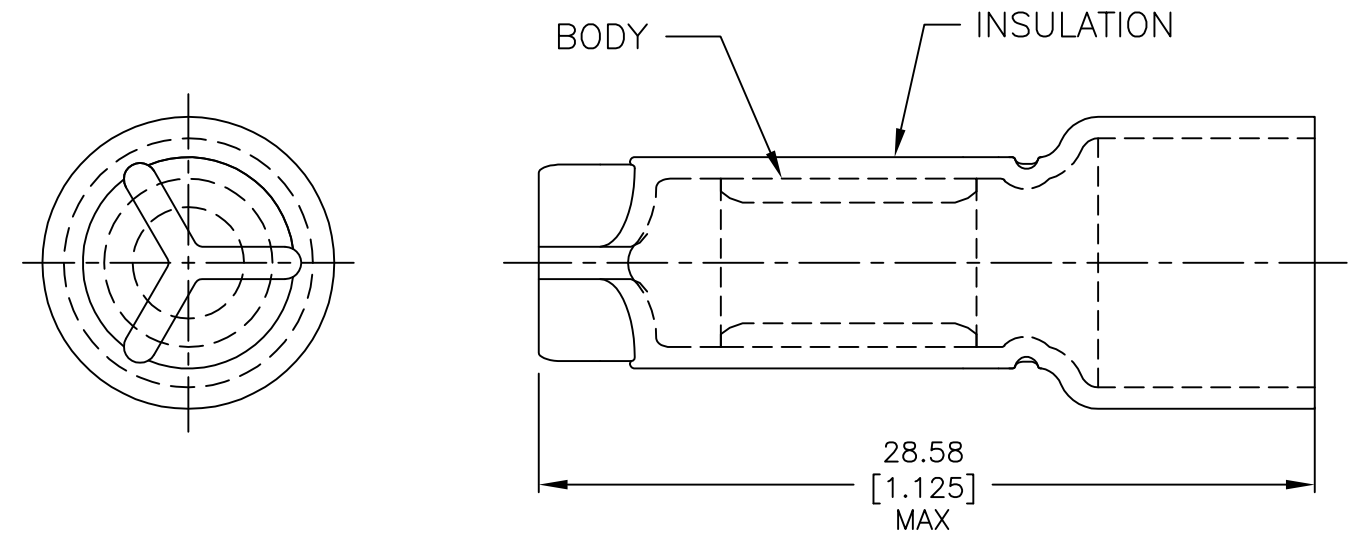

|       |              |           |
|-------|--------------|-----------|
| 1,500 | TAPE MOUNTED | 1-36965-1 |
| 500   | LOOSE PIECE  | 36965     |
| QTY   | DESCRIPTION  | PART NO   |

|  |  |   |  |  |                      |                  |       |           |            |   |           |
|--|--|---|--|--|----------------------|------------------|-------|-----------|------------|---|-----------|
| AMP INCORPORATED<br>CUSTOMER SERVICE SYSTEMS                                     |  | MAX RECOMMENDED OPERATING TEMPERATURE:<br>90°C [194°F] MAX  | THIS DRAWING IS A CONTROLLED DOCUMENT. |  | DWN<br>G KRUPER 1/93 | TE Connectivity  |       |           |            |   |           |
| FOR ADDITIONAL PRODUCT INFORMATION OR COPIES OF DRAWINGS AND TECHNICAL DOCUMENTS | PRODUCT INFORMATION CENTER<br>1-800-522-6752 | VOLTAGE RATING:<br>300V MAX   | DIMENSIONS:<br>mm [INCHES]             | TOLERANCES UNLESS OTHERWISE SPECIFIED:   | CHK<br>R HERSEY 1/93 |                  |       |           |            | NAME<br>SPLICE, WIRE, CLOSED END<br>22-10 AWG |           |
| FOR APPLICATION TOOLING INFORMATION  | TOOLING ASSISTANCE CENTER<br>1-800-722-1111  | CIRCULAR MIL AREA:<br>1.65-6.64mm <sup>2</sup> [3248-13100]<br>SOLID OR STRANDED  |  | 0 PLC ± -<br>1 PLC ± -<br>2 PLC ± 0.20[.008]<br>3 PLC ± -<br>4 PLC ± -<br>ANGLES ± - | APVD<br>M ELLIS 1/93 | PRODUCT SPEC     | SIZE  | CAGE CODE | DRAWING NO | RESTRICTED TO                                 |           |
| FOR ORDER ENTRY  | 1-800-526-5142                               | THIS DRAWING IS A CONTROLLED DOCUMENT FOR AMP INCORPORATED. IT IS SUBJECT TO CHANGE AND THE CONTROLLING ENGINEERING ORGANIZATION SHOULD BE CONTACTED FOR THE LATEST REVISION. | MATERIAL<br>                           | FINISH<br>   | PRODUCT SPEC         | APPLICATION SPEC | —     | —         | —          | —   |           |
|  |  |   |  |  | WEIGHT               | A3 00779         |       | C-36965   |            | —   |           |
|  |  |   |  |  | CUSTOMER DRAWING     |                  | SCALE | 4:1       | SHEET      | 1 OF 1  | REV<br>R2 |