

DO NOT SCALE FROM THIS PRINT

DESIGNED & DIMENSIONED IN MILLIMETERS [INCHES]

PCIE-LP-XX-01-X-DV-A-XX-XX

No OF LANES
-01, -04, -08, -16

CARD THICKNESS
-01: 1.57mm (.062) CARD

PLATING SPECIFICATION
-F: 3µ" SELECTIVE GOLD IN CONTACT AREA, MATTE TIN ON TAIL
-S: 30µ" SELECTIVE GOLD IN CONTACT AREA, MATTE TIN ON TAIL
-L: 10µ" LIGHT SELECTIVE GOLD IN CONTACT AREA, MATTE TIN ON TAIL

PACKAGING
-TR: TAPE & REEL (REQUIRED FOR LANES -01, -04 & -08) (LEAVE BANK FOR TRAY PACKAGING, ONLY AVAILABLE FOR LANES -16) (SEE NOTE 5 & 6)

OPTION
-WT: WELD TAB (SEE FIG 2, SHT 2)
-K: POLYIMIDE FILM PAD (SEE FIG 3, SHT 2)

ALIGNMENT PIN

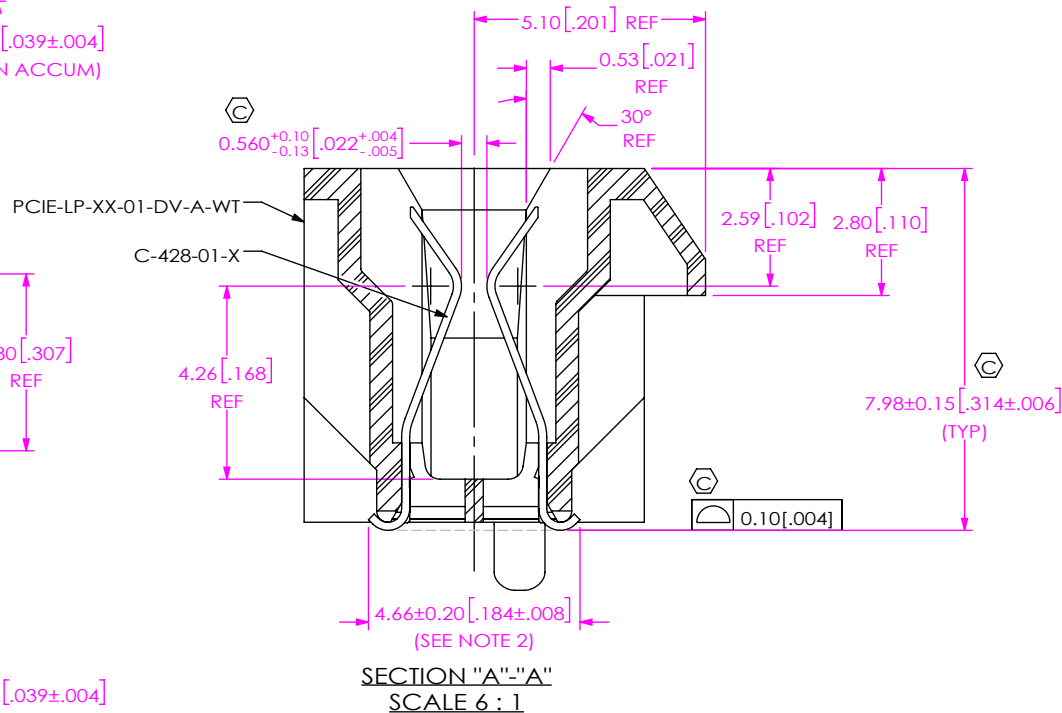
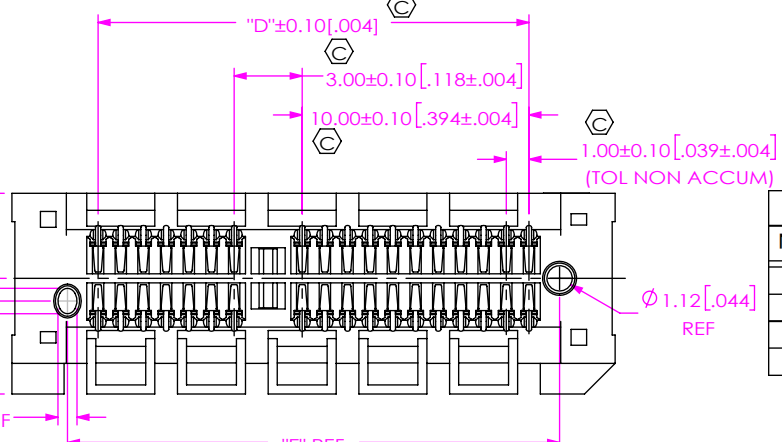
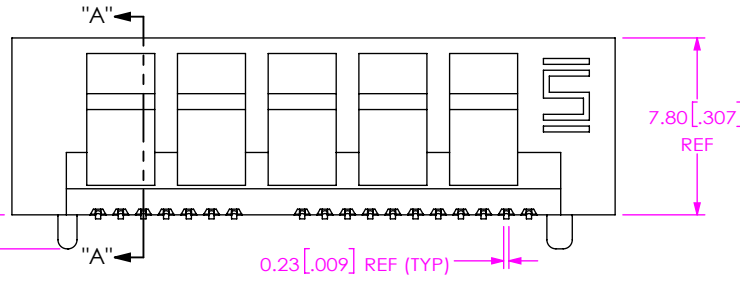
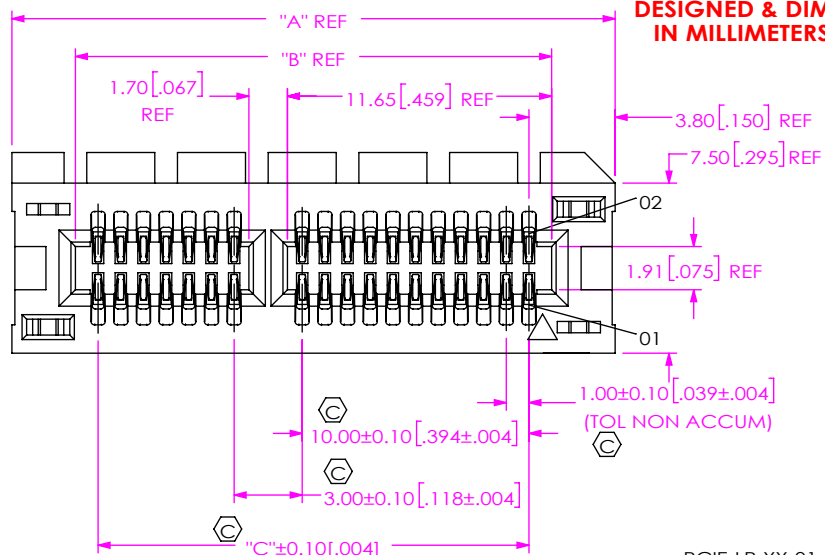

TABLE 1

No OF LANES	"A"	"B"	"C"	"D"	"E"
-01	26.60 [1.047]	21.00 [0.827]	19.00 [0.748]	19.00 [0.748]	21.70 [0.854]
-04	40.60 [1.598]	35.00 [1.378]	33.00 [1.299]	33.00 [1.299]	35.70 [1.406]
-08	57.60 [2.268]	52.00 [2.047]	50.00 [1.969]	50.00 [1.969]	52.70 [2.075]
-16	90.60 [3.567]	85.00 [3.346]	83.00 [3.268]	83.00 [3.268]	85.70 [3.374]

NOTES:

- ⊕ REPRESENTS A CRITICAL DIMENSION.
- DIMENSIONS MEASURED TIP TO TIP.
- MINIMUM PUSHOUT FORCE: SIGNAL: 2.2N, WELD TAB: 4.45N.
- MATING CARD MUST HAVE LEAD-IN. SEE SAMTEC FOOTPRINT FOR SPECIFICATIONS.
- FOR QUANTITIES UP TO 49 PCS., NO LEADER, TRAILER OR REEL WILL BE SUPPLIED. FOR QUANTITIES OF 50-124 PCS., NO LEADER OR TRAILER WILL BE SUPPLIED, SPLICES MAY BE PRESENT.
- 01, -04, -08 LANES PARTS TO BE PACKAGED IN TAPE & REEL, -16 LANES PARTS TO BE PACKAGED IN TRAY.

FIG 1

PCIE-LP-01-01-X-DV-A-XX SHOWN

UNLESS OTHERWISE SPECIFIED, DIMENSIONS ARE IN MILLIMETERS.

TOLERANCES ARE:
DECIMALS ANGLES
X.X: ±0.3 [0.1]
X.XX: ±0.13 [0.05]
X.XXX: ±0.051 [0.020]

PROPRIETARY NOTE

" THIS DOCUMENT CONTAINS CONFIDENTIAL AND PROPRIETARY INFORMATION AND ALL DESIGN, MANUFACTURING, REPRODUCTION, USE, PATENT RIGHTS AND SALES RIGHTS ARE EXPRESSLY RESERVED BY SAMTEC, INC. THIS DOCUMENT SHALL NOT BE DISCLOSED, IN WHOLE OR PART, TO ANY UNAUTHORIZED PERSON OR ENTITY NOR REPRODUCED, TRANSFERRED OR INCORPORATED IN ANY OTHER PROJECT IN ANY MANNER WITHOUT THE EXPRESS WRITTEN CONSENT OF SAMTEC, INC.



520 PARK EAST BLVD. NEW ALBANY, IN 47150
PHONE: 812-944-6733 FAX: 812-948-5047
e-Mail: info@SAMTEC.com code 55322

MATERIAL: DO NOT SCALE DRAWING SHEET SCALE: 3:1
INSULATOR: LCP, UL 94 V0, COLOR: BLACK
CONTACT: PHOS BRONZE
WELD TAB: BRASS ALLOY

DESCRIPTION:
PCI EXPRESS LOW PROFILE ASSEMBLY
DWG. NO.
PCIE-LP-XX-01-X-DV-A-XX-XX
BY: JESSIE W 6/30/2016 SHEET 1 OF 2

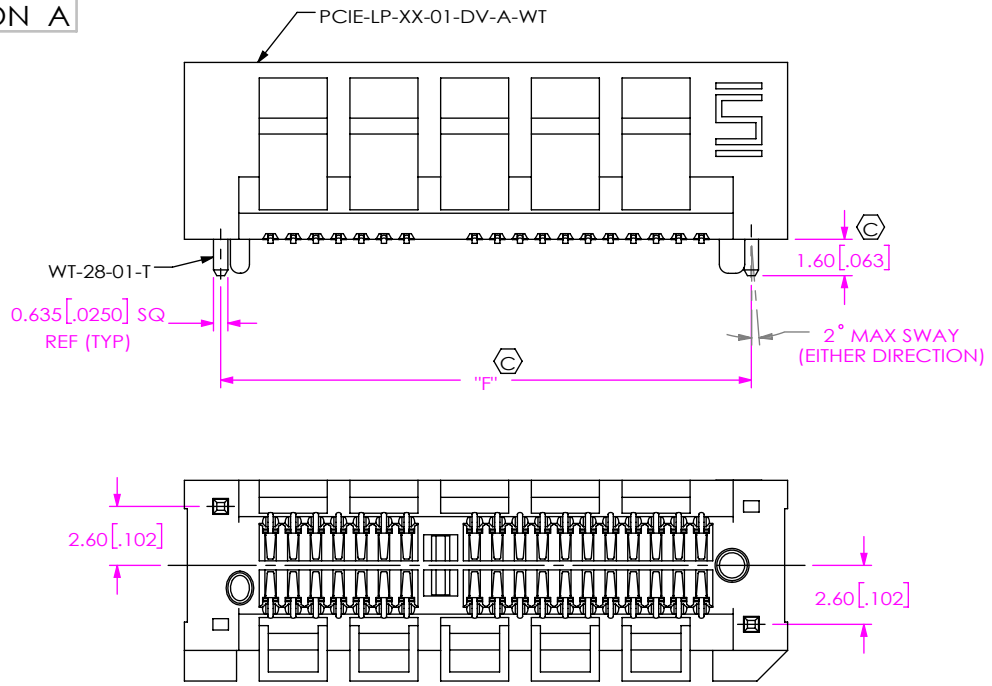
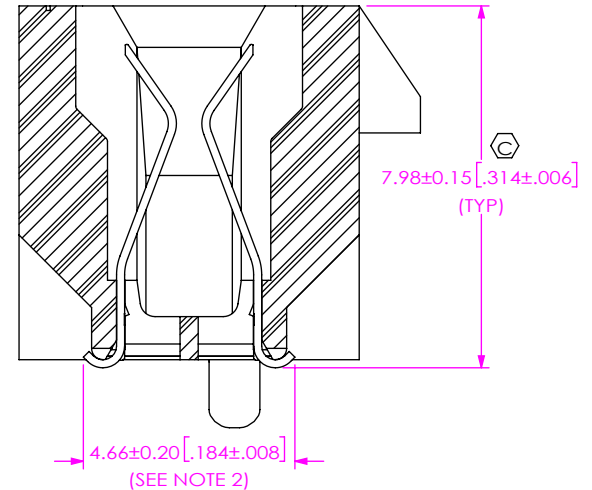

FIG 2
 PCIE-LP-01-01-X-DV-A-WT-XX SHOWN
 (DIFFERENT AS SHOWN, OTHERWISE SAME AS FIG 1)

TABLE 2		
No OF LANES	"F"	"G"
-01	23.40 [.921]	8.80 [.346]
-04	37.40 [1.472]	15.80 [.622]
-08	54.40 [2.142]	24.30 [.957]
-16	87.40 [3.441]	40.80 [1.606]



IN-PROCESS 1
 (FILL C-428-01-X)

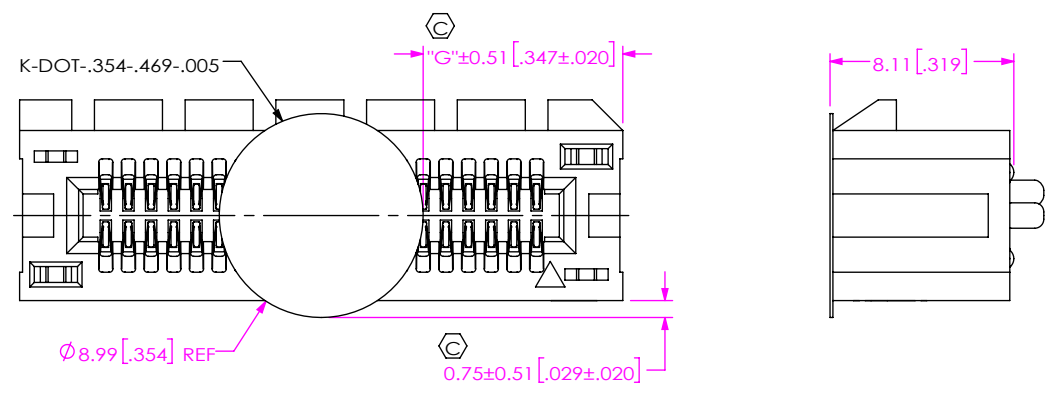

FIG 3
 PCIE-LP-01-01-X-DV-A-K-XX SHOWN
 (DIFFERENT AS SHOWN, OTHERWISE SAME AS FIG 1)

PROPRIETARY NOTE
 THIS DOCUMENT CONTAINS CONFIDENTIAL AND PROPRIETARY INFORMATION AND ALL DESIGN, MANUFACTURING, REPRODUCTION, USE, PATENT RIGHTS AND SALES RIGHTS ARE EXPRESSLY RESERVED BY SAMTEC, INC. THIS DOCUMENT SHALL NOT BE DISCLOSED, IN WHOLE OR PART, TO ANY UNAUTHORIZED PERSON OR ENTITY NOR REPRODUCED, TRANSFERRED OR INCORPORATED IN ANY OTHER PROJECT IN ANY MANNER WITHOUT THE EXPRESS WRITTEN CONSENT OF SAMTEC, INC.

samtec
 520 PARK EAST BLVD, NEW ALBANY, IN 47150
 PHONE: 812-944-6733 FAX: 812-948-5047
 e-Mail: info@SAMTEC.com code 55322

DO NOT SCALE DRAWING
 SHEET SCALE: 3:1

DESCRIPTION:
 PCI EXPRESS LOW PROFILE ASSEMBLY
 DWG. NO.
PCIE-LP-XX-01-X-DV-A-XX-XX
 BY: JESSIE W 6/30/2016 SHEET 2 OF 2