

This is issued in strict confidence on condition that it is not used as a basis for manufacture or sale, and that it is not copied, reprinted or disclosed to a third party either wholly or in part without prior written consent of ITT Cannon.

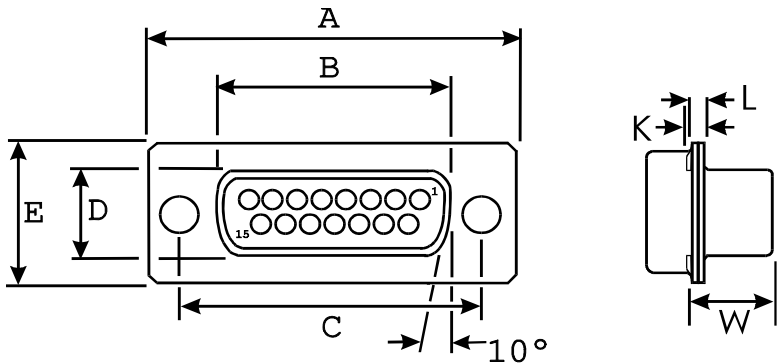

A ± 0,38 (.015)	B ± 0,13 (.005)	C ± 0,13 (.005)	D ± 0,13 (.005)	E ± 0,38 (.015)	L ± 0,25 (.010)	W ± 0,41 (.016)	K ± 0,51 (.020)
39,14 (1.541)	24,66 (.971)	33,32 (1.312)	7,90 (.311)	12,55 (.494)	0,76 (.030)	6,94 (.273)	1,27 (.050)

Selected hardware option
with 2,26 (.089) mounting hole

Signal contacts
not shown for clarity

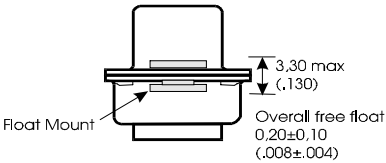

Solder cup signal contacts

9,91 (.390) max.

Mounting hardware
not shown for clarity

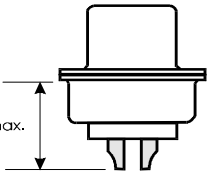

DESCRIPTION	MATERIAL	FINISH
Insulator	Thermo-Plastic	None, (Color Black)
Shells	Steel	Yellow Chromate over Zinc
Signal Contacts	Copper alloy	50 microinches Gold over Nickel in mating area
Rivets	Steel	Trivalent Chromate over Zinc
Washers	Stainless Steel	Passivated
Unless otherwise specified, dimensions are in mm & (in.) Tolerances are (.XXX = mm) Decimals Angles .X ± 0,20 (.008) X° ± 1.0° .XX ± 0,10 (.004) .XXX ± 0,05 (.002)	Issue Date: 17-May-18	Cannon ITT
	CONNECTOR, RECEPTACLE, ELECTRICAL D-SUBMINIATURE 15 POSITION SOLDER CUP	
	PART NO.	DAMMY15S