

DWG STATUS				REVISION HISTORY				AUTH		DR		APVD	
DATE	STG	REV	NIP	CHG	DATE	BY	REASON	DATE	BY	DATE	BY	DATE	BY
12AP02	R	01	-	-			ALL PARTS - CREATED PD, UPDATED MATL SPEC, ADDED LOGO & MATL RECYCLING NOTES	222939	JGR	EDV	JH	ET	
10JUL02	R	02	-	-			ALL PARTS - REVISED MATL SPEC	227746	HH	EDV	JH	ET	
24JAN03	R	03	-	-			ALL ACTIVE PARTS - 17.90 +/-0.15/0.25 WAS 17.90 & 16.80 +/-0.15/0.25 WAS 16.80	236013	CKZ	RK	ET		

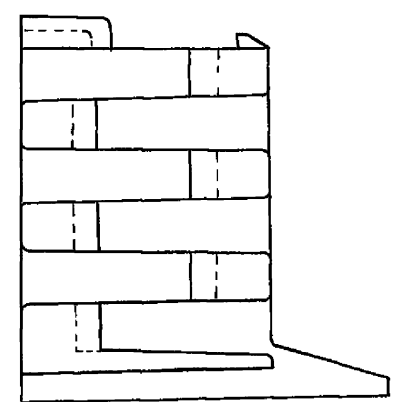
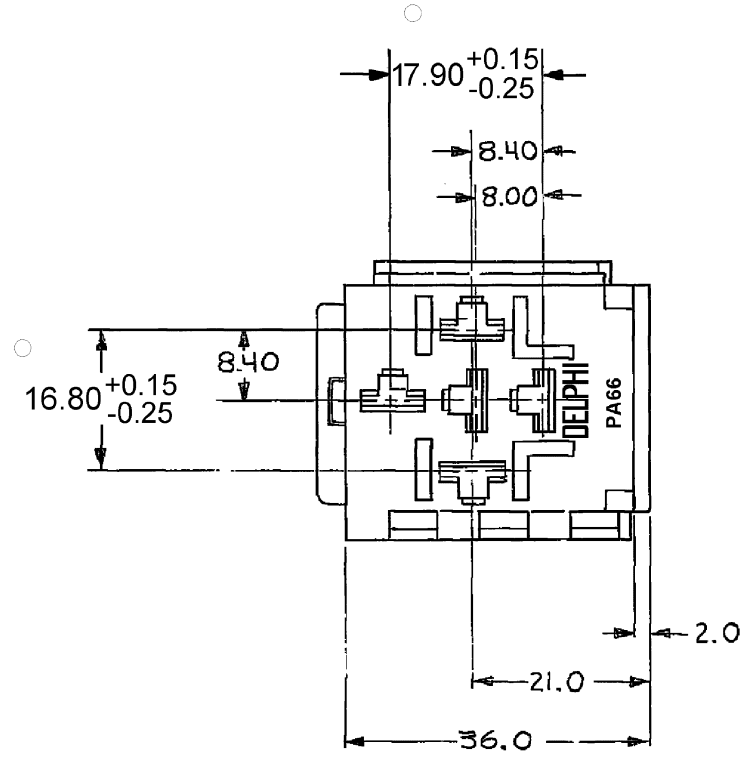
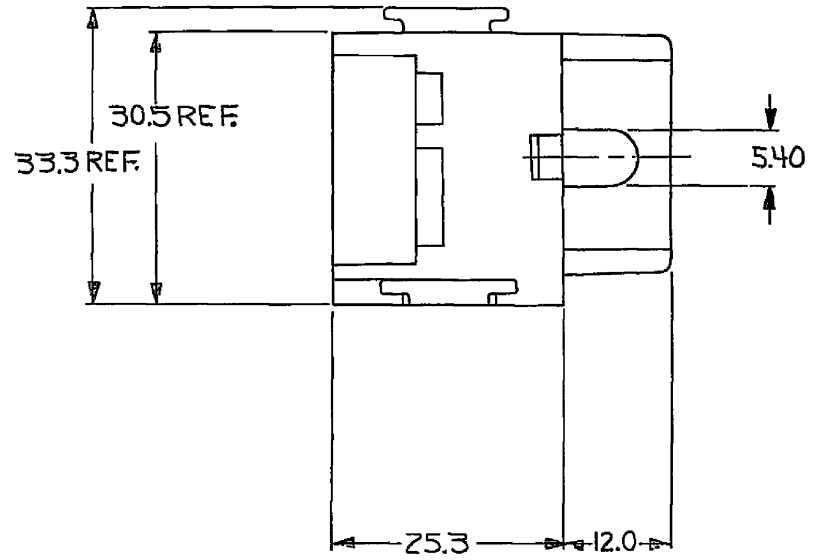

NOTES

- UNLESS OTHERWISE SPECIFIED AND/OR INDICATED:
DIMENSIONS ARE TO FACE OF VIEW SHOWN
CAVITIES ARE IDENTICAL
CABLE SLOTS ARE IDENTICAL
- MATING COMPONENTS OR EQUIVALENT:
CONNECTOR RELAY
TERMINAL 12015838
SECONDARY LOCK 12033872
LOCK 12033873
- THIS PART ACCEPTS THE FOLLOWING COMPONENTS OR EQUIVALENT:
CAVITIES MARKED WITH * TERMINAL 12015889
LENGTH BLADES 11.5 +/- 0.5
- MAXIMUM CABLE SIZE USABLE IN CAVITIES 2 & 5 IS DOUBLE 3mm² (1.95mm MAX CRIMP HEIGHT)
- 1.85 MIN X 0.1 MIN RAISED DELPHI CORPORATE BRAND TO BE LOCATED ON ANY EXTERIOR SURFACE, PREFERABLY VISIBLE AT FINAL ASSEMBLY. OPTIONAL CONSTRUCTION TO BE "PED" OR NO LOGO
- MATERIAL RECYCLING CODE >PA66< PER SAE J1344. 1.85 MIN X 0.1 MIN RAISED CHARACTERS AS SHOWN TO BE LOCATED ON ANY EXTERIOR SURFACE. OPTIONAL CONSTRUCTION TO BE NO MATERIAL RECYCLING CODE.

PART NO	REV	NIP	STATUS	MATERIAL SPECIFICATION AND COLOR
12176691	02	AA	-	M3592015 PA66 IM HS GRN LT
12103621	02	AA	-	M3592004 PA66 IM HS RED
12089766	09	AA	-	M3592010 PA66 IM HS BRN
12089746	H	-	OBSOLETE	M2019004 NYLON 6 NAT
12033871	09	AA	-	M3592001 PA66 IM HS BLK

DWG TYPE PART DRAWING	
STYLE	DISTR CODE
VOLUME (CM)	D
ROUTING 6900	
UNLESS OTHERWISE SPECIFIED THIS DOCUMENT IS IN ACCORDANCE WITH AEC TOLERANCE MANUAL, AS APPLIED TO THE DIMENSIONS, DIMENSIONS AND TOLERANCE REQUIREMENTS. ALL DIMENSIONS UNLESS OTHERWISE SPECIFIED ARE TO FACE UNLESS INDICATED OTHERWISE. DIMENSIONS IN QUOTES ARE FOR INFORMATION ONLY. DIMENSIONS IN PARENTHESES ARE FOR INFORMATION ONLY. DIMENSIONS IN PARENTHESES ARE FOR INFORMATION ONLY.	
THIRD ANGLE PROJECTION	

DELPHI
DELPHI PACKARD ELECTRIC SYSTEMS
WARREN, OHIO

DR	J. GAVALDON	DATE	12AP02
APVD1	E. VAZQUEZ	DATE	12AP02
APVD2	E. TRACEY	DATE	15AP02
APVD3			
APVD4			
SUBSTANCES OF CONCERN AND RECYCLED CONTENT PER DELPHI A 1088001			
MATERIAL			
SEE CHART			
DRAWING NAME TAXI CONN 5F M/P 630			
DRAWING NUMBER 12089762			
SHEET	SCALE	FORMED BY	SHEET NO
A0	NONE	1 OF 1	1 OF 1
REV	NIP	DATE	BY