

In case that the application demands a high level of reliability, such as automotive, please contact a company representative for further information.

NO.	DATE	BY	CHKD	DESCRIPTION OF REVISIONS	COUNT	BY	CHKD	DATE
1								
2								
3								
4								
5								
6								
7								
8								

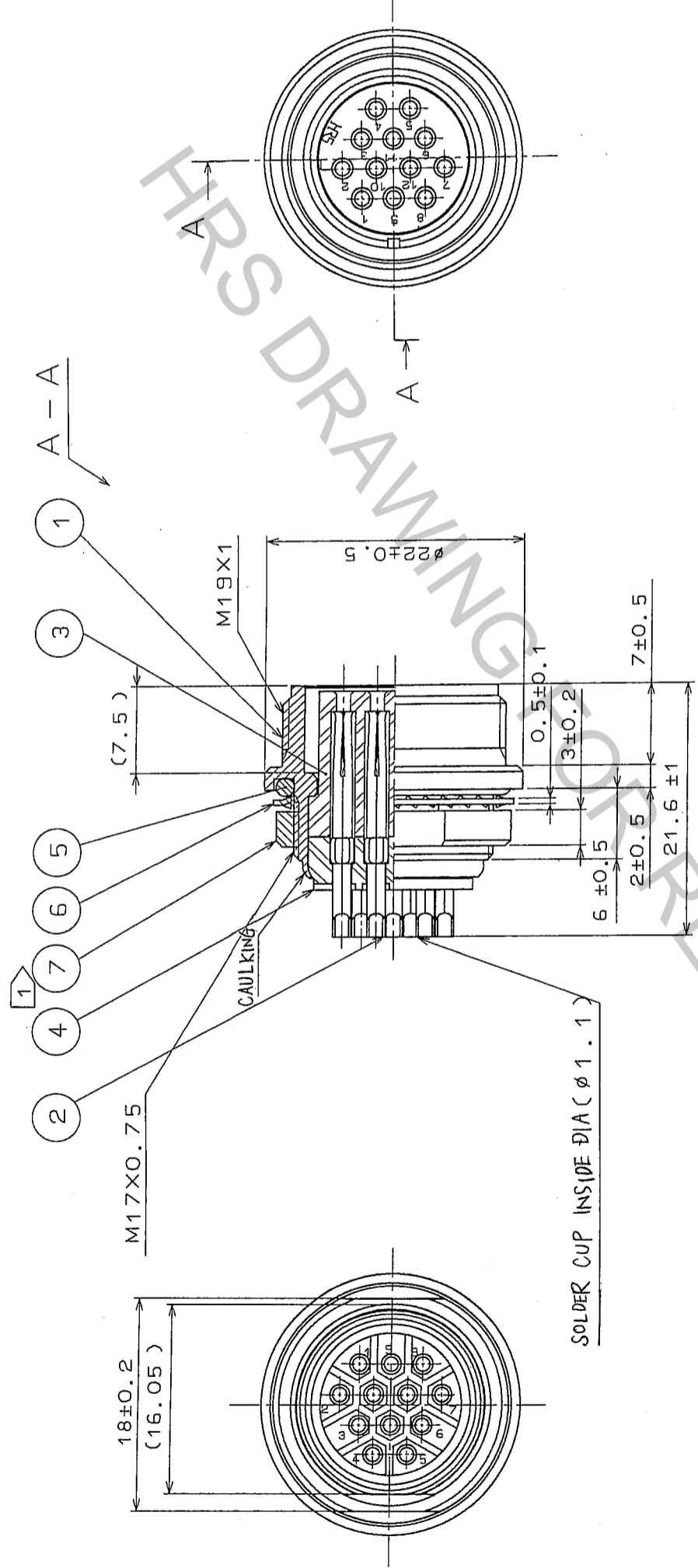

NOTE 1 THE RECOMMENDED CLAMP TORQUE OF REF. NO. Ø TO BE 3 N·m.
 LOCTITE 242, HENKEL JAPAN OR EQUIVALENT IS RECOMMENDED TO PREVENT REF. NO. Ø FROM LOOSING.

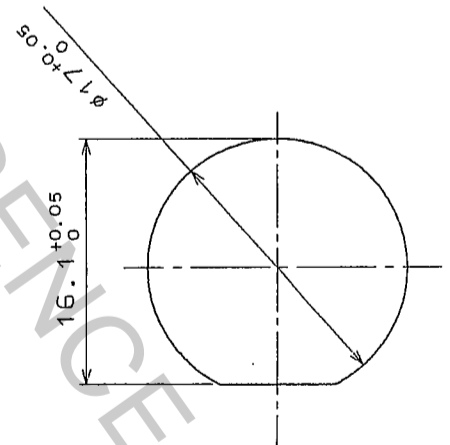

DIMENSIONS OF MOUNTING HOLE (2:1)
 t=0.5 TO 2

NO.	MATERIAL	FINISH, REMARKS	NO.	MATERIAL	FINISH, REMARKS
4	DIALYL PHTHALATE (BLACK)UL94V-0		7	BRASS	NICKEL PLATING
3	DIALYL PHTHALATE (BLACK)UL94V-0		6	PHOSPHOR BRONZE	NICKEL PLATING
2	COPPER ALLOY	SILVER PLATING 5µm min.	5	SILICON RUBBER (BLACK)	
1	ZINC ALLOY	CHROME PLATING			

CODE NO. (OLD)	CL	DRAWN	DESIGNED	CHECKED	APPROVED	RELEASED
		Y. Yamamoto	G. Yamada	H. Zamba	M. Saito	
		05.11.18	05.11.18	05.11.18	05.11.18	

DRAWING NO.	PART NO.
EDC3-111082-71	RM15WTRZ-12S(71)

SCALE	UNITS	CODE NO.
2 : 1	ITM	CL109-1642-9-71

HIROSE ELECTRIC CO., LTD.
 FORM NO. 229