

REVISIONS

Rev	DESCRIPTION	DATE
A	INITIAL RELEASE	

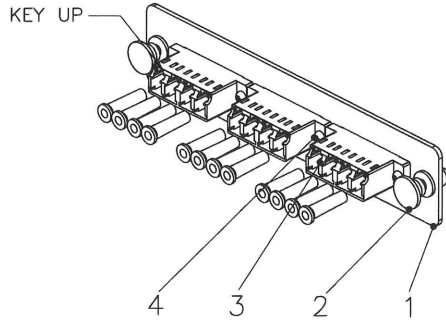

SCALE 1/40

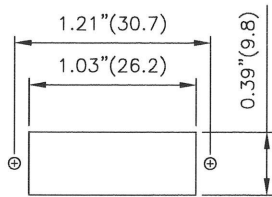
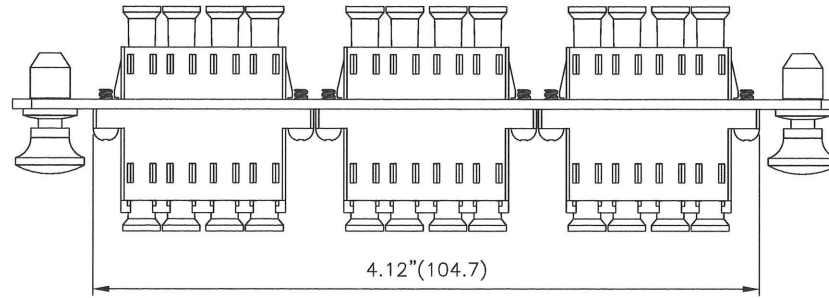

SUGGESTED PANEL CUTOUT

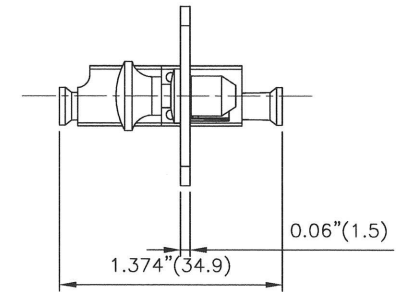
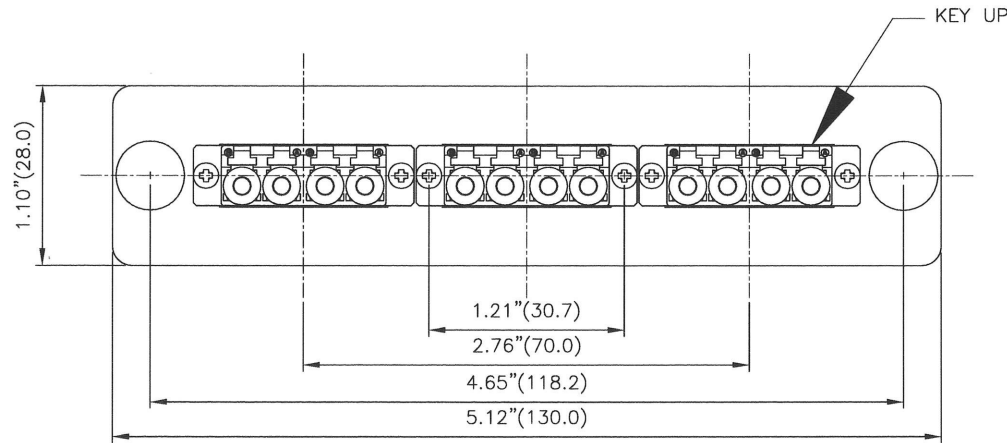

Specification :

Material :

1. Panel material : SPCC, 1.5mm thickness.
2. Accessory : 2 pcs, Snap Rivet, Male Nylon/Female PC material, Black color.
3. Adaptor : 3 pack Quad LC (L) Adaptor.
4. Screw : 6 pcs, M2*6/3.3mm, Nickel Plated, White color.
5. Coupler : Blue, Ceramic sleeve.
6. Panel Color : Black.

Performance :

- a. Durability : 500 cycles.
- b. Tensile Strength : 10 kgf.
- c. Insertion Loss : <0.3 dB.
- d. Operating Temperature : -20°C to +70°C.
- e. Storage Temperature : -40°C to +80°C.
- f. Dimension : 5.12" x 1.10" x 1.374" (130.0 x 28.0 x 34.9mm)
- g. Weight : 0.05kg.

UNLESS OTHERWISE SPECIFIED:
DIMENSIONS ARE IN INCHES
TOLERANCES:
FRACTIONAL ±
ANGULAR MATCH ± BEND ±
TWO PLACE DECIMAL ±
THREE PLACE DECIMAL ±

The information contained in this document is the sole property of Black Box Corporation of Pennsylvania. Any reproduction in part or whole without the written permission of Black Box Corp. is prohibited.
©Copyright 2012 Black Box Corporation of Pennsylvania d/b/a Black Box Network Services. All Rights Reserved.

INTERPRET GEOMETRIC TOLERANCING PER:
MATERIAL: CRS
FINISH: POWDER COAT
DO NOT SCALE DRAWING



NAME	DATE	TITLE:
Drawn By	3/11/2013	Fiber Adapter Panel-3 LC Quad
ENG APPR.	Approved By	3/11/2013
CHECKED	Checked By	3/11/2013
COMMENTS:		
SIZE	DWG. NO.	REV
B	JPM455C-R2	A
SCALE: 1:20		SHEET 1 OF 1