

This document is the property of Amphenol Corporation and is delivered on the express condition that is not to be disclosed, reproduced or used, in whole or in part, for manufacture or sale by anyone other than Amphenol Corporation without its prior consent, and that no right is granted to disclose or to use any information in this document.

The marking on this product doesn't contain environmental hazardous materials per Material Specification SS-00259 for Sony GP compliant or per directive 2011/65/EU for RoHS compliant or per IEC 61249-2-21 for Halogen-Free compliant.



ORIGINAL

REVISIONS				
SYM	ECN No.	DESCRIPTION	DATE	By
A	NE-18093	RELEASE TO PRODUCTION	2017.05.29	Sandra Sang
B	NE-18187	ADDED BACK VIEW AND CHANGED GENERAL TOLERANCES	2018.08.28	Sandra Sang

NOTES:

- MATERIAL:
 - HOUSING: HIGH TEMPERATURE THERMAL PLASTIC, LCP, UL94V-0, COLOR: OPTION.
 - SLEEVE: HIGH TEMPERATURE THERMAL PLASTIC, LCP, UL94V-0, COLOR: OPTION.
 - TERMINAL: HIGH PERFORMANCE COPPER ALLOY.
 - SHELL: STAINLESS STEEL.
- FINISH:
 - TERMINAL:
 - CONTACT AREA: SELECTIVE GOLD PLATING THICKNESS MIN.;
 - SOLDERING AREA: GOLD FLASH PLATING. ;
 - UNDER PLATING: NICKEL PLATING 50 μm THICKNESS MIN. OVERALL.
 - SHELL:
 - MATTE TIN PLATING 100 μm THICKNESS MIN.;
 - NICKEL PLATING 50 μm THICKNESS MIN. OVERALL.
- PRODUCT SPECIFICATION REFER TO : PS-7655.
- THIS PRODUCT DOESN'T CONTAIN ENVIRONMENTAL HAZARDOUS PER DIRECTIVE 2011/65/EU FOR RoHS COMPLIANT.

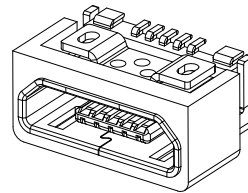

DATE CODE
 Y WW D
 1~7: DATE NO.
 12: WEEK NO.
 6: 2016

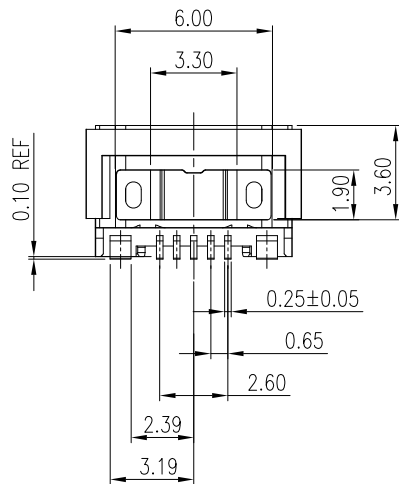
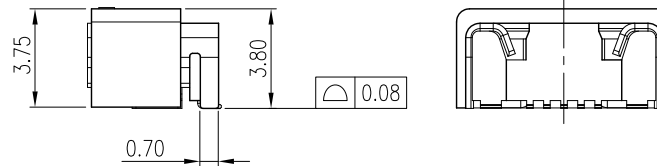
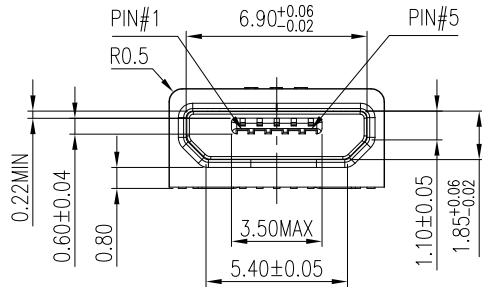
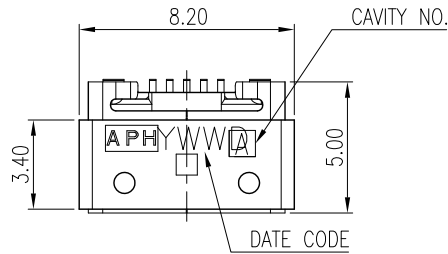

P/N: GMCBA058 X X 1230HHR

CONTACT FINISH
 2: 30u" GOLD

COLOR
 1: BLACK

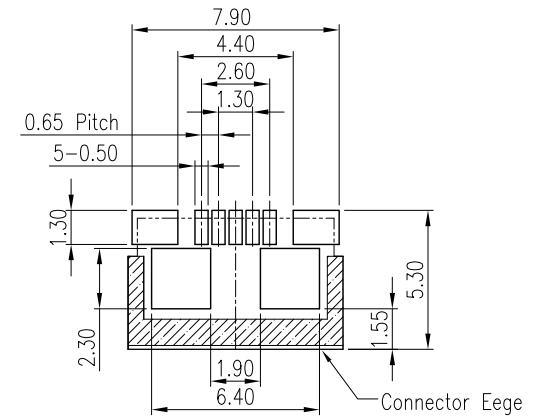

RECOMMENDED PCB LAYOUT
 TOP VIEW (TOLERANCE±0.05)

KEEPOUT AREA

TOLERANCE	DRAWN	APPROVALS	DATE	TITLE	Amphenol®			
X: ±0.20	DESIGNED	Sandra Sang	08/28/2018	SPLASH PROOF MICRO USB B TYPE, RECEPTACLE 5 POS. R/A SMT HI-RISE	Amphenol Corporation Amphenol Taiwan Corporation			
X.X: ±0.10	CHECKED	Chenny Yeh	08/28/2018					
X.XX: ±0.10	APPROVED	Hank Hsu	08/28/2018					
ANGULAR ±2°	DWG TYPE	CUST DWG	PROJECT CODE T618		UNIT mm	SIZE A3	PART No. GMCBA058XX1230HHR	
UNLESS OTHERWISE SPECIFIED					SCALE NA	SHEET 1 OF 2	DWG No. GMCBA058XX1230HHR	REV. B

This document is the property of Amphenol Corporation and is delivered on the express condition that is not to be disclosed, reproduced or used, in whole or in part, for manufacture or sale by anyone other than Amphenol Corporation without its prior consent, and that no right is granted to disclose or to use any information in this document.
 The marking on this product doesn't contain environmental hazardous materials per Material Specification 55-00259 for Sony GP compliant or per directive 2011/65/EU for RoHS compliant or per IEC 61249-2-21 for Halogen-Free compliant.



ORIGINAL



REVISIONS				
SYM	ECN No.	DESCRIPTION	DATE	By
A	NE-18093	RELEASE TO PRODUCTION	2017.05.29	Sandra Sang
B	NE-18187	ADDED BACK VIEW AND CHANGED GENERAL TOLERANCES	2018.08.28	Sandra Sang

PULL OUT DIRECTION →

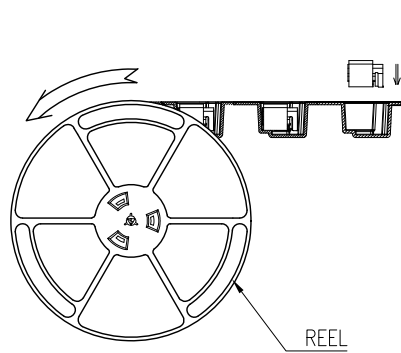

REEL

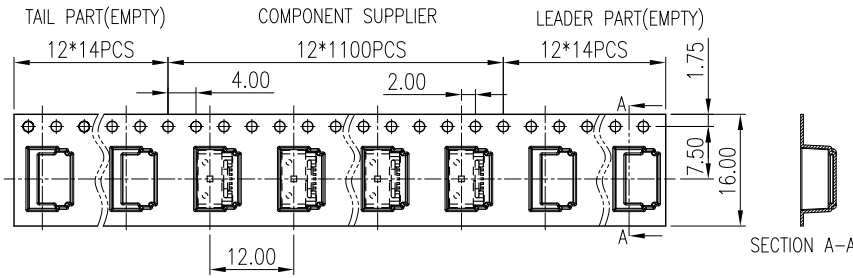

SECTION A-A

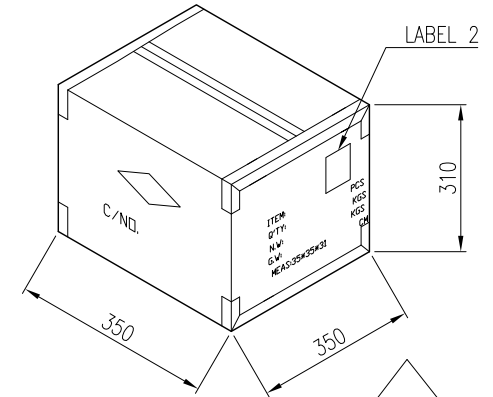

LABEL 2

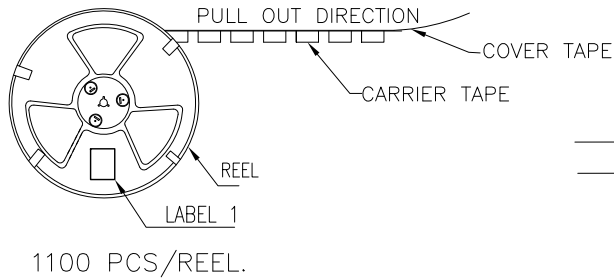

1100 PCS/REEL.

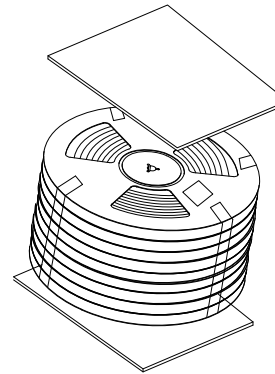

14 REEL

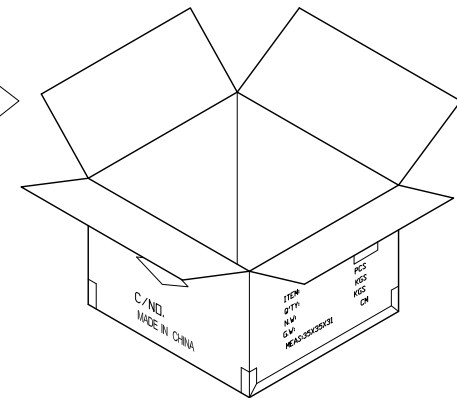

CPN (IP) : XXXXXXXXXX	
MPN (M) : GMCBA058XX1230HHR	
CPO (K) : 123456789	
AMTA PO : 411-012345-001	
VENDOR (V) : AMPHENOL	
QTY (Q) :	1100
DATE :	07/01/2014
Amphenol Taiwan Corporation	

LABEL 1

CPN (IP) : XXXXXXXXXX	
MPN (M) : GMCBA058XX1230HHR	
CPO (K) : 123456789	
AMTA PO : 411-012345-001	
VENDOR (V) : AMPHENOL	
QTY (Q) :	15400
DATE :	07/01/2014
L*W*H (CM)	HF
G.W. :	KG
Amphenol Taiwan Corporation	

LABEL 2

PACKAGING BY T&R	10.4	4.9	1100	14	15400	GMCBA058XX1230HHR
	G/W KG	N/W KG	PCS/ REEL	REELS/ BOX	QUANTITY (PCS)	PART NUMBER
TOLERANCE	DRAWN APPROVALS		DATE		TITLE	
X. ±0.20	DESIGNED Sandra Sang		08/28/2018		SPLASH PROOF MICRO USB	
X.X ±0.10	CHECKED Chenny Yeh		08/28/2018		B TYPE, RECEPTACLE 5 POS.	
X.XX ±0.10	APPROVED Hank Hsu		08/28/2018		R/A SMT HI-RISE	
ANGULAR ±2°	DWG TYPE	PROJECT CODE	UNIT		SIZE	PART No.
UNLESS OTHERWISE SPECIFIED	CUST DWG	T618	mm		A3	GMCBA058XX1230HHR
			SCALE	SHEET	DWG No.	REV.
			NA	2 OF 2	GMCBA058XX1230HHR	B