

Customer Information Sheet

DRAWING No.: M300-FCXXX05F2-XXXXL

PAGE 2 OF 2

IF IN DOUBT - ASK

©

NOT TO SCALE

THIRD ANGLE PROJECTION

ALL DIMENSIONS IN mm

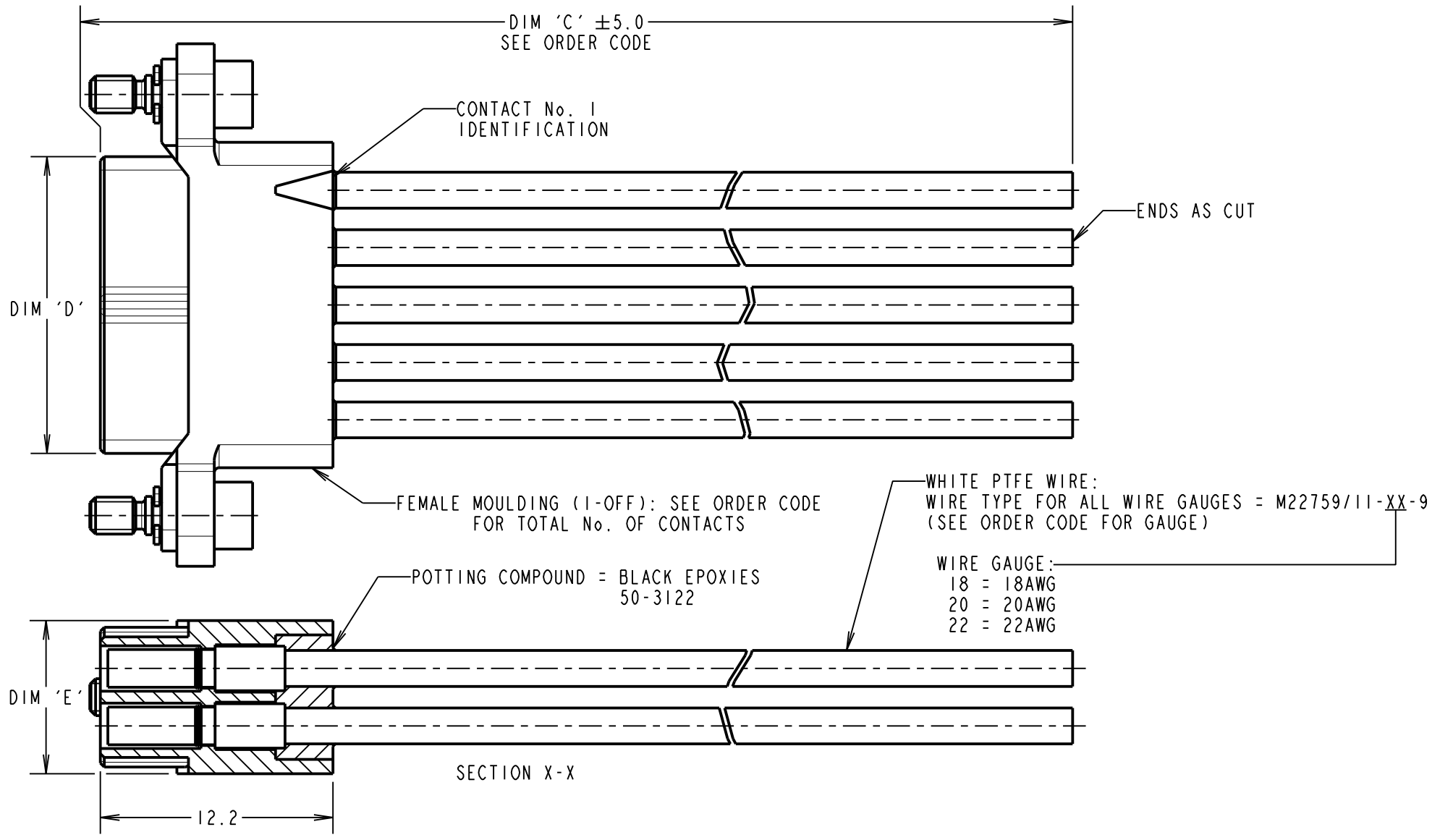
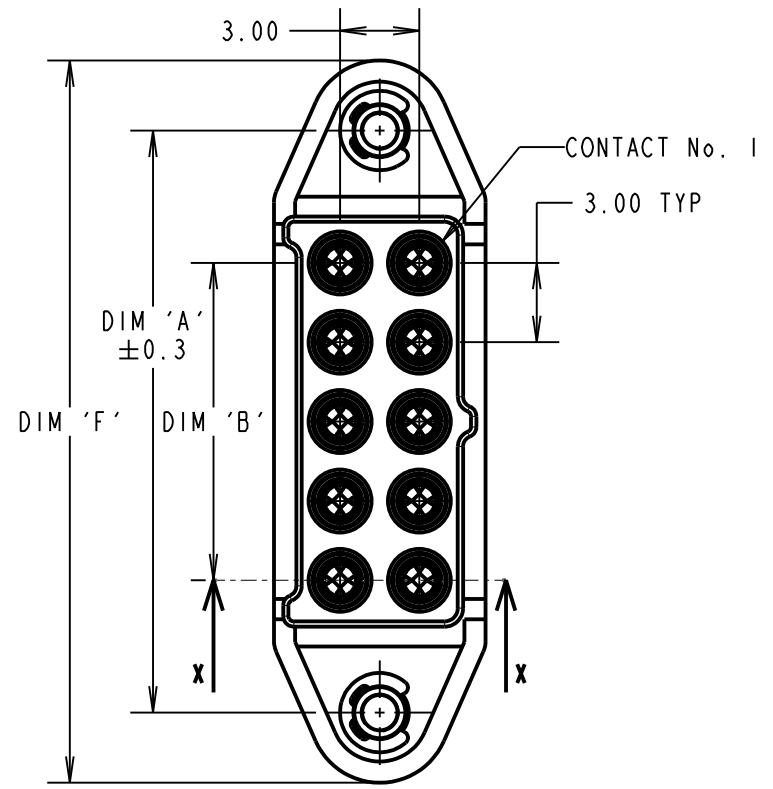

VIEWS SHOW
DOUBLE ROW (DIL),
3 WAY CONNECTOR IS
SINGLE ROW (SIL)

- NOTES:
1. CABLE ASSEMBLIES WILL BE PACKED IN BAGS OF 10.
2. FOR COMPLETE SPECIFICATION, SEE COMPONENT SPECIFICATION C048XX (LATEST ISSUE) AND C049XX (LATEST ISSUE).

DIMENSION	MEASUREMENT
DIM 'A'	((No. OF CONTACTS PER ROW - 1) x 3) + 10.00
DIM 'B'	(No. OF CONTACTS PER ROW - 1) x 3
DIM 'D'	((No. OF CONTACTS PER ROW - 1) x 3) + 3.50
DIM 'E'	3 CONTACTS = 5.30, 6 & 10 CONTACTS = 8.00
DIM 'F'	((No. OF CONTACTS PER ROW - 1) x 3) + 15.30

EXAMPLE PART No.:
10 DIL CONTACTS CONNECTOR WITH 150mm OF 18AWG WIRE = M300-FC11005F2-0150L
3 SIL CONTACTS CONNECTOR WITH 450mm OF 22AWG WIRE = M300-FC70305F2-0450L

ORDER CODE:
M300-FCXXX05F2-XXXXL

WIRE AWG:	DIM 'C' LENGTH:
1 = 18AWG DIL	0060 = 60mm MIN
2 = 20AWG DIL	9999 = 9999mm MAX
3 = 22AWG DIL	(SEE TABLE FOR EXAMPLES)
5 = 18AWG SIL	STOCKED CABLE LENGTHS:
6 = 20AWG SIL	0150 = 150mm
7 = 22AWG SIL	0300 = 300mm
	0450 = 450mm

TOTAL No. OF CONTACTS:
03 = 03 CONTACTS (SIL ONLY)
06 = 06 CONTACTS (DIL ONLY)
10 = 10 CONTACTS (DIL ONLY)

FM	4	16.04.18	21155
NAME	ISS.	DATE	C/NOTE
APPROVED: F.MCGOWAN			
CHECKED: M.PLESTED			
DRAWN: M.PERREN			
CUSTOMER REF.:			
ASSEMBLY DRG:			

 www.harwin.com technical@harwin.com	THIS DRAWING AND ANY INFORMATION OR DESCRIPTIVE MATTER SET OUT HEREON ARE CONFIDENTIAL AND COPYRIGHT PROPERTY OF THE HARWIN GROUP AND MUST NOT BE DISCLOSED, LOANED, COPIED OR USED FOR MANUFACTURING, TENDERING OR FOR ANY OTHER PURPOSE WITHOUT THEIR WRITTEN PERMISSION.	TOLERANCES	MATERIAL:	TITLE:
		X. = ±1mm X.X = ±0.50mm X.XX = ±0.10mm X.XXX = ±0.01mm ANGLES = ±5° UNLESS STATED	SEE ABOVE	M300 FEMALE SINGLE-ENDED CABLE ASSEMBLY
		FINISH: SEE ABOVE	S/AREA: mm ²	DRAWING NUMBER: M300-FCXXX05F2-XXXXL
				SHT 2 OF 2