

This document is the property of Amphenol Corporation and is delivered on the express condition that it is not to be disclosed, reproduced or used, in whole or in part, for manufacture or sale by anyone other than Amphenol Corporation without the prior consent. It is not to be granted to disclose or to use any information in this document.

Customer drawing

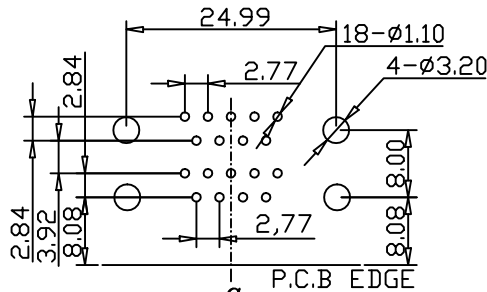

RECOMMENDED P.C.B LAYOUT

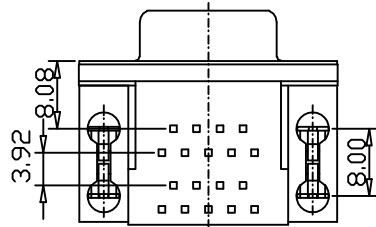
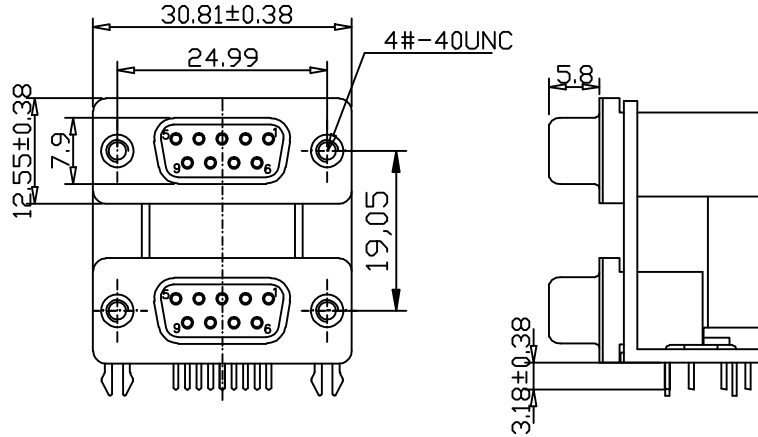

REVISIONS

SYM	ECN	DESCRIPTION	DATE	APPROVED
1		Release drawing	3/1/13	Tony

D-SUB TECHNICAL DATA

SHELL : Cold Roller Steel. Tin Plated.

BODY : PBT UL 94V-0 Rated.

CONTACTS : Brass. Gold Flash .

ELECTRICAL : Contact Resistance :

25 Milliohms Maximum.

Insulation Resistance :

5000 Medohms Minimum

Dielectric Withstanding Voltage :

AC 1000/60sec.r.m.s.

Current Rating : 3AMP

Operating Temperature:-55°C to+105°C.

MARKING : Amphenol...(Series No.)

Commercial reference

Manufacturing date

PRODUCT CODE

L 17H 2 2 2 0 1 3 0

RoHS Compliance

Spacing Between Ports:
2: F=19.05mm
G=31.60mm

Top Connector Type:
2=9-pos. Female

Bottom Connector Type:
2=9-pos. Female

Flange Mounting Option:
0=4-40 rear insert

Board Mounting Option:
3=Quad Arrowhead Boardlock

Front Shell Finish:
1=Tin over Nickel

Contact Finish:
0=flash gold

UNLESS OTHERWISE SPECIFIED TOLERANCES	APPROVAL		DATE
	U.S.	METRIC	
.X +/-	0.50	DRAWN	XS.Cuo 3/1/13
.XX +/-	0.30	CHECKED	Tony 3/1/13
.XXX +/-	0.20	CHECKED	
FRACTIONS +/-			
ANGLES +/-	2'		
FOR MATERIALS AND FINISHES SEE NOTES	DRAWING FILE :		
REMOVE SHARP EDGES	ANGLE OF PROJECTION		
DIMENSIONS			
U.S. INCHES			
METRIC MM			

Amphenol

TITLE		REV.
D-sub, Dual Port, 9pos Female-9pos Female		1
SIZE	DRAWING NO.	
A4	CL17H2220130	
SCALE	NONE	SHEET 1 OF 1