

THIS DRAWING CONTAINS INFORMATION PROPRIETARY TO POSITRONIC AND ITS SUBSIDIARIES. POSITRONIC BELIEVES THE DATA ON THIS DRAWING TO BE RELIABLE, SINCE THE TECHNICAL INFORMATION IS GIVEN FREE OF CHARGE, THE USER EMPLOYS SUCH INFORMATION AT HIS OWN DISCRETION AND RISK. POSITRONIC ASSUMES NO RESPONSIBILITY FOR RESULTS OBTAINED OR DAMAGES INCURRED FROM USE OF SUCH INFORMATION IN WHOLE OR IN PART.

DATE	REV	REVISION RECORD	APP	DR	CK
7-6-06	NC	ECO 26319		ME	

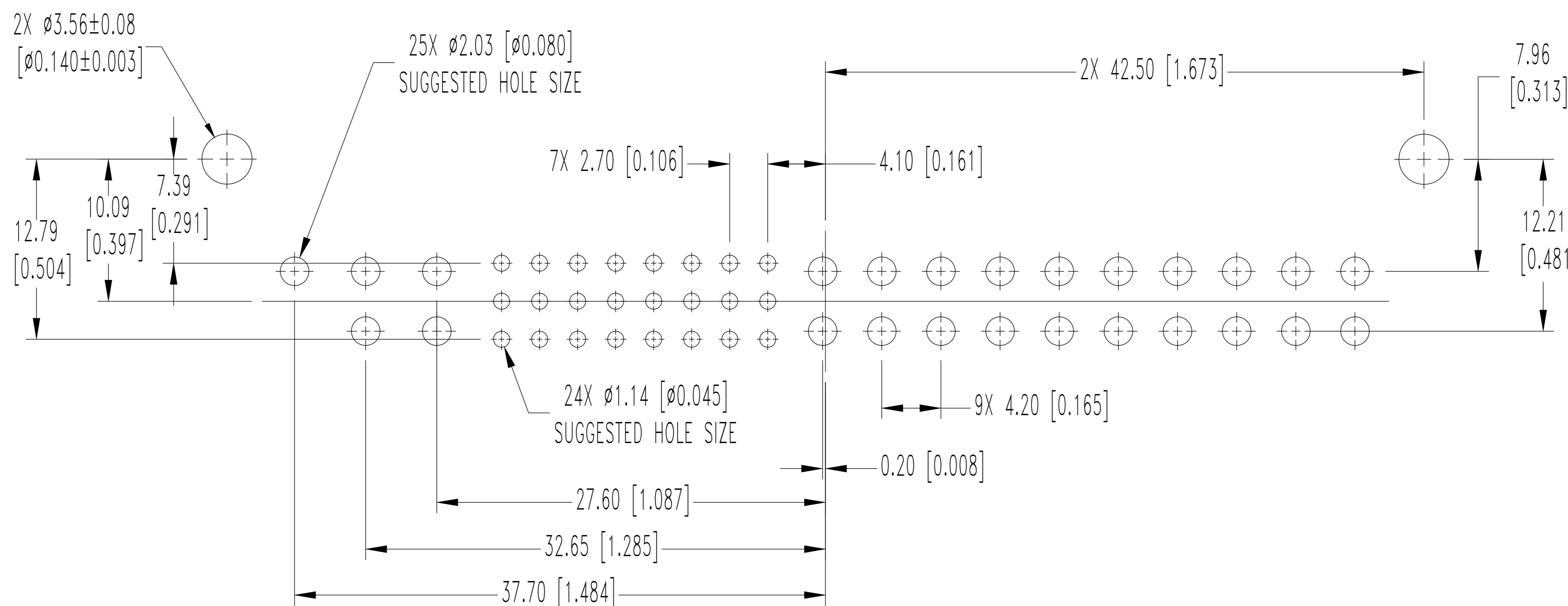
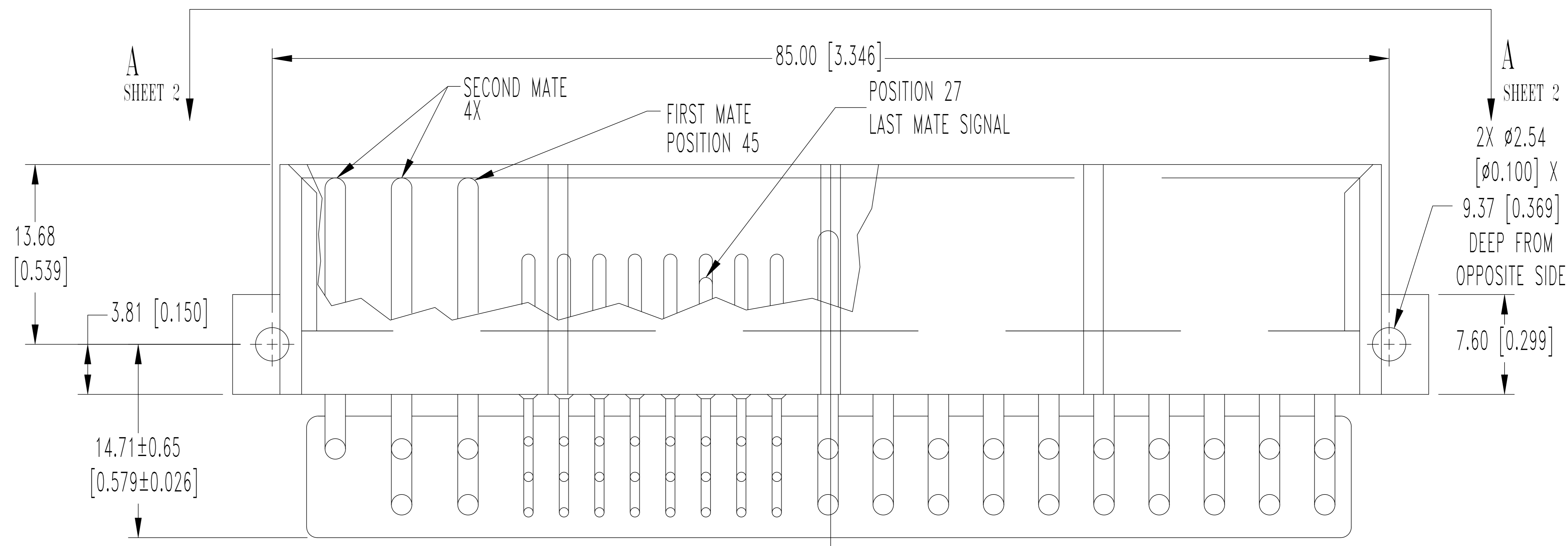

NOTES:

1. MATERIALS AND FINISHES:

INSULATOR: GLASS FILLED POLYESTER, UL 94V-0. COLOR: BLUE.
CONTACTS: HIGH CONDUCTIVITY PRECISION MACHINED COPPER ALLOY WITH GOLD FLASH OVER NICKEL.

2. ELECTRICAL CHARACTERISTICS:

CONTACT CURRENT RATING PER UL 1977:
SIZE 16 CONTACTS: 28 AMPERES CONTINUOUS, ALL CONTACTS UNDER LOAD.
SIZE 22 CONTACTS: 3 AMPERES NOMINAL RATING.
INITIAL CONTACT RESISTANCE MAXIMUM:
SIZE 16 CONTACTS: 0.0007 OHMS. MAXIMUM.
SIZE 22 CONTACTS: 0.004 OHMS MAX. PER IEC 512-2, TEST 2b.
INSULATION RESISTANCE: 5 G OHMS PER IEC 512-2, TEST 3a.

VOLTAGE PROOF:

CONTACTS 1 THROUGH 20: 1,500 V r.m.s.
CONTACTS 45 THROUGH 49: 1,500 V r.m.s.
CONTACTS 21 THROUGH 44: 1,000 V r.m.s.

WORKING VOLTAGE:

CONTACTS 1 THROUGH 20: 500 V r.m.s.
CONTACTS 45 THROUGH 49: 500 V r.m.s.
CONTACTS 21 THROUGH 44: 333 V r.m.s.

3. WORKING TEMPERATURE: -55°C TO +125°C.

4. MOS 378.0 ALLOWS FOR CONTACT POSITIONS 45, 46, 47, 48, 49 TO HAVE A MATING LENGTH OF 12.67 [0.499] MEASURED FROM MOUNTING HOLE TO THE MATING END OF CONTACTS.

5. CONNECTORS ARE ROHS COMPLIANT PER ROHS DIRECTIVE 2002/95/EC OF 27 JAN. 2003.

6. DIMENSIONS ARE IN MILLIMETERS [INCHES].

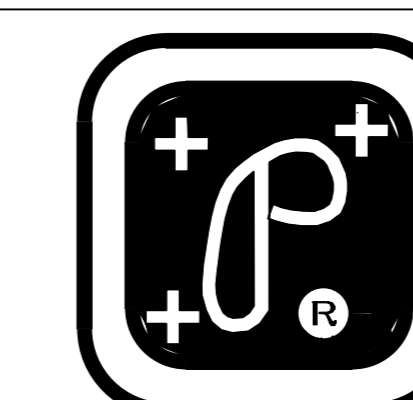

POSITRONIC INDUSTRIES INC.

SPRINGFIELD, MISSOURI 65801

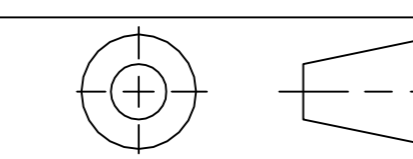

DECIMAL TOL.
± 0.38 [0.015]



ANGULAR TOL.
± 3°

PCI SERIES

SCALE
N.T.S.

DRAWN BY
M. ENEA

TITLE
PCIH49W25M400A1/AA-378.0

DATE
7-6-06

DRAWING NUMBER
SK7738

SHEET 1 OF 2

REV.
NC

THIS DRAWING CONTAINS INFORMATION PROPRIETARY TO POSITRONIC AND ITS SUBSIDIARIES. POSITRONIC BELIEVES THE DATA ON THIS DRAWING TO BE RELIABLE, SINCE THE TECHNICAL INFORMATION IS GIVEN FREE OF CHARGE, THE USER EMPLOYS SUCH INFORMATION AT HIS OWN DISCRETION AND RISK. POSITRONIC ASSUMES NO RESPONSIBILITY FOR RESULTS OBTAINED OR DAMAGES INCURRED FROM USE OF SUCH INFORMATION IN WHOLE OR IN PART.

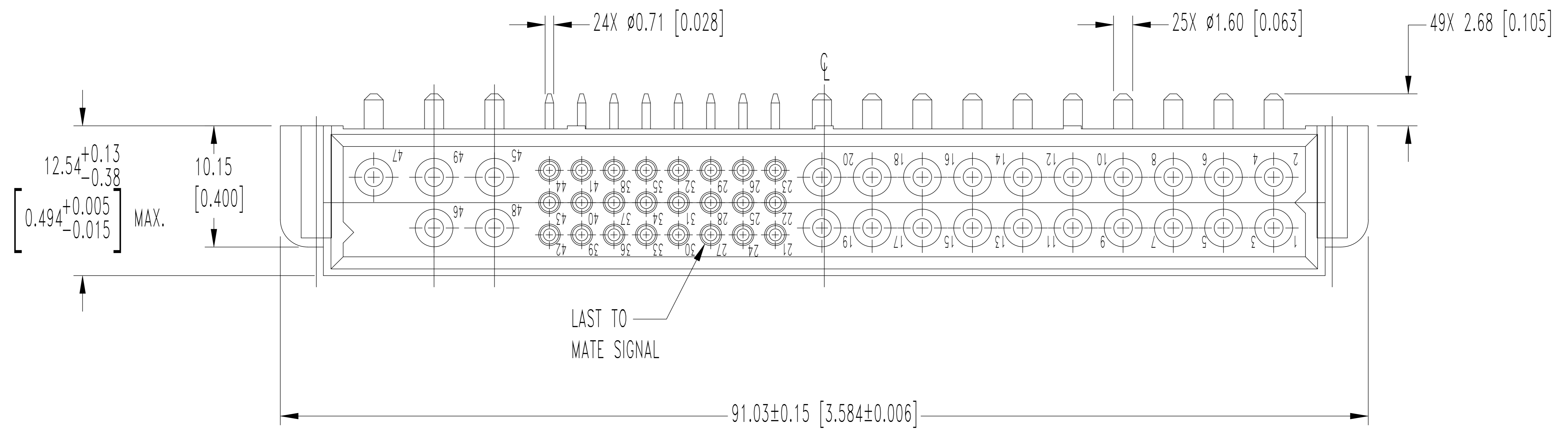

VIEW A-A