

THIS IS A C.A.D. GENERATED DRAWING  
DO NOT MAKE MANUAL REVISIONS TO MASTER.  
ALL TOLERANCES UNLESS OTHERWISE SPECIFIED ±.015

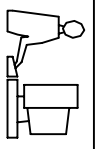

ISSUE NUMBER  
**ORIGINAL**  
1

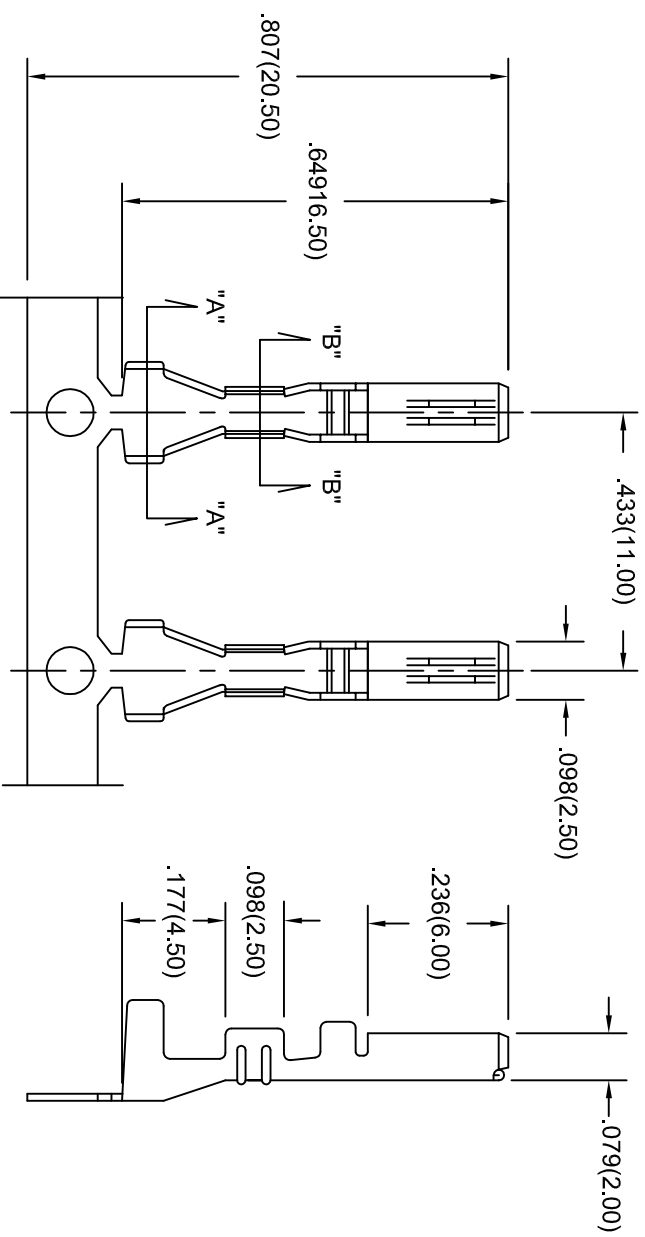

**MATERIAL: BRASS, TIN PLATED**

**PART NUMBER 570-290-761 WILL BE IN REEL 4,000 PCS**  
**PART NUMBER 570-290-761P40 WILL BE IN STRIP 40 PCS**

**570 SERIES FEMALE CRIMP CONTACT**  
**WIRE RANGE AWG 20 TO 16**

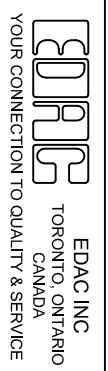

THESE DRAWINGS AND SPECIFICATIONS ARE THE PROPERTY OF EDAC INC. AND SHALL NOT BE REPRODUCED OR COPIED OR USED AS THE BASIS FOR THE MANUFACTURE OR SALE OF APPARATUS WITHOUT WRITTEN PERMISSION.

ACAD REF DWG NUMBER	570-290-761
DRAWN: F. BRIONES	DATE: JUL.30/14
CHECKED:	DATE:
PART NUMBER	570-290-761
DRAWING NUMBER	570-290-761
ISSUE	1