

THE INFORMATION CONTAINED IN THIS DRAWING IS THE SOLE PROPERTY OF ANDERSON POWER PRODUCTS. ANY REPRODUCTION IN PART OR WHOLE WITHOUT THE WRITTEN PERMISSION OF ANDERSON POWER PRODUCTS IS PROHIBITED.

**Copyright 2009**

ANDERSON POWER PRODUCTS RESERVES THE RIGHT TO ALTER PRODUCT TYPES, THEIR TECHNICAL DATA, DIMENSION, STYLE AND ACCESSORIES WITHOUT PRIOR NOTIFICATION.

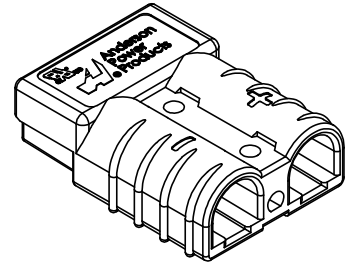
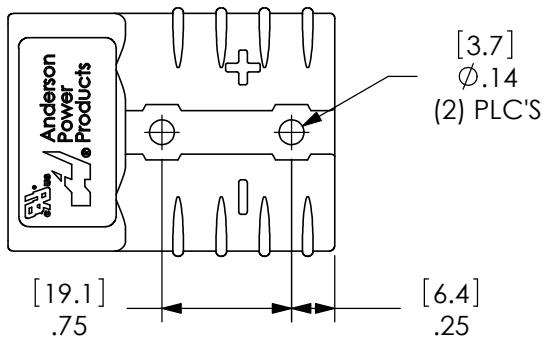

COLOR	P/N	MAT'L
GRAY	992	PC
	P992	PC/PBT
RED	992G1	PC
	P992G1	PC/PBT
BLACK	992G2	PC
	P992G2	PC/PBT
BLUE	992G4	PC
	P992G4	PC/PBT
YELLOW	992G5	PC
	P992G5	PC/PBT
GREEN	992G6	PC
	P992G6	PC/PBT
ORANGE	992G7	PC
	P992G7	PC/PBT

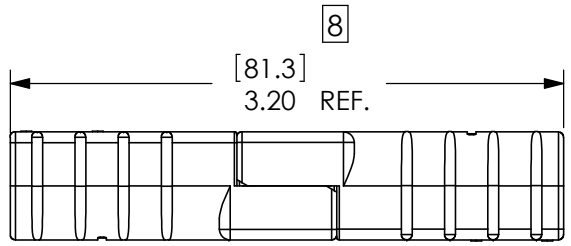
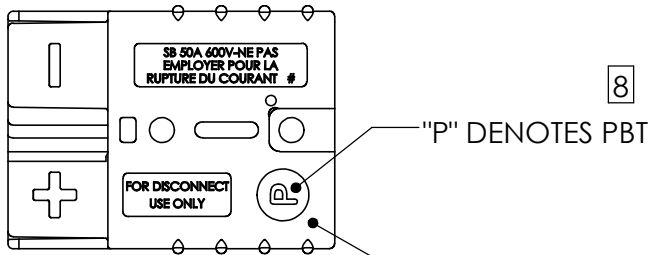
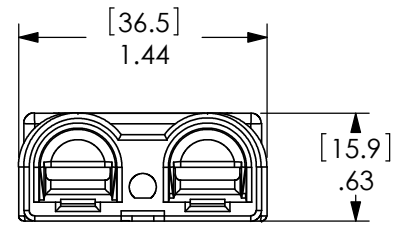
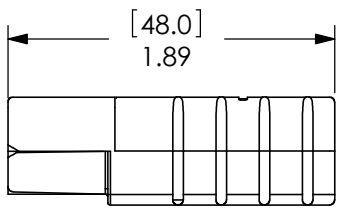

**MATED PAIR**

- NOTES:
1. SPRING/HOUSING ASSEMBLIES ARE UL RECOGNIZED PER FILE E26226, CSA CERTIFIED PER LR25154
  2. HOUSINGS ARE KEYED TO ONLY ALLOW MATING WITH THE SAME COLOR HOUSING, EXCEPT FOR THE BLACK HOUSING, WHICH MATES WITH THE GRAY HOUSING AND OTHER CUSTOMER SPECIFIC CONNECTORS.
  3. FOR ASSEMBLY INSTRUCTIONS, SEE DOCUMENT 1S1030A
  4. HOUSING ASSEMBLIES ACCOMODATE ANDERSON CONTACTS FOR WIRE RANGES #16 AWG TO #6 AWG.
  5. MANUFACTURING AND AGENCY MARKINGS SHOWN IN THIS AREA.

7 8

REV.	DESCRIPTION	APPRV	DATE
8	ECN 2016-0112 - CHANGED NOTE 5 AND ADDED LEADER FOR PBT	CPD	12/9/2016
7	ECN 2016-0085	CPD	10/20/2016
6	ECRN-15855	TWE	9/4/2015
5	ECRN-14934 COLOR & KEYING ADDED	TWE	7/5/11
4	ECRN 14661: "PC/PBT" WAS "PBT"	CMS	7/7/10
3	ECRN 14391: REDRAW, UPDATE BORDER, ADD TABLE	AMS	2/27/09

REVISIONS

DIMENSIONS ARE IN:	INCH [MM]	<b>APPROVALS</b>		<p><b>ANDERSON POWER PRODUCTS</b></p> <p>TITLE</p> <p><b>50A DUAL POLE SPRING AND HOUSING</b></p>		
UNLESS OTHERWISE STATED		DRAWN	CMS 3/18/1999			
TOLERANCES:		CHECKED	DJD 3/19/1999			
DECIMALS (INCH) .XX ± .02		MFG APPRV	CHB 4/20/1999			
DECIMALS (MM) .X ± .5		QC APPRV	DJM 4/20/1999			
ANGLES ±2°		ENG APPRV	UFN 4/19/1999	SIZE	DWG NO.	REV.
SURFACE FINISH:				A	111923S1	8
MACHINED 128µin [3.2µ]				SCALE	CADFILE	SHEET
MOLDED 64µin [1.6µ]				NONE	01000	1 OF 2
MATERIAL: SPRINGS-STAINLESS STEEL						
HOUSINGS-SEE TABLE						
FINISH:						
		-CAD GENERATED DRAWING- DO NOT MANUALLY UPDATE DO NOT SCALE				

THE INFORMATION CONTAINED IN THIS DRAWING IS THE SOLE PROPERTY OF ANDERSON POWER PRODUCTS. ANY REPRODUCTION IN PART OR WHOLE WITHOUT THE WRITTEN PERMISSION OF ANDERSON POWER PRODUCTS IS PROHIBITED.

**Copyright 2009**

ANDERSON POWER PRODUCTS RESERVES THE RIGHT TO ALTER PRODUCT TYPES, THEIR TECHNICAL DATA, DIMENSION, STYLE AND ACCESSORIES WITHOUT PRIOR NOTIFICATION.

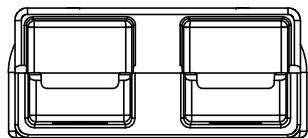

**GRAY, BLACK AND NATURAL VOLTAGE KEYING**

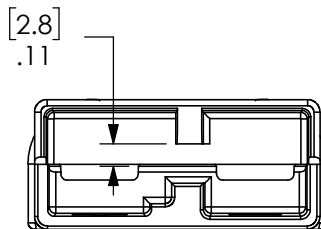

**BLUE & WHITE VOLTAGE KEYING**

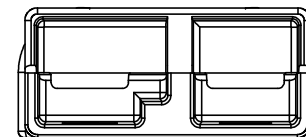

**ORANGE VOLTAGE KEYING**

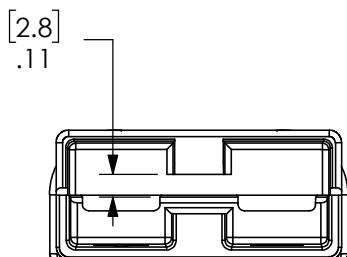

**RED VOLTAGE KEYING**

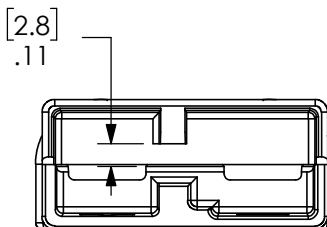

**YELLOW VOLTAGE KEYING**

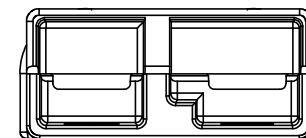

**GREEN VOLTAGE KEYING**

DIMENSIONS ARE IN:		INCH [MM]		<b>APPROVALS</b>		<b>ANDERSON POWER PRODUCTS</b> TITLE 50A DUAL POLE SPRING AND HOUSING
UNLESS OTHERWISE STATED				<b>DRAWN</b>		
TOLERANCES:				<b>CMS</b>	3/18/1999	
DECIMALS (INCH) DECIMALS (MM) ANGLES .XX ±.02 .X ±.5 ±2°				<b>CHECKED</b>	<b>DJD</b> 3/19/1999	
SURFACE FINISH:				<b>MFG APPRV</b>		
MACHINED 128µin [3.2µ]				<b>CHB</b>	4/20/1999	
MOLDED 64µin [1.6µ]				<b>QC APPRV</b>		
<b>MATERIAL:</b> SPRINGS-STAINLESS STEEL HOUSINGS-SEE TABLE				<b>DJM</b>	4/20/1999	
<b>FINISH:</b>				<b>ENG APPRV</b>		
				<b>UFN</b>	4/19/1999	
				<b>SIZE</b>	<b>DWG NO.</b>	<b>REV.</b>
				A	111923S1	7
				<b>SCALE</b>	<b>CADFILE</b>	<b>SHEET</b>
				NONE	01000	2 OF 2

-	See Sheet 1	-	-
REV.	DESCRIPTION	APPRV	DATE
REVISIONS			