

PART NUMBER (FROM 20Pos. TO 40Pos.)
10159549-120XXLF ~ 10159549-140XXLF

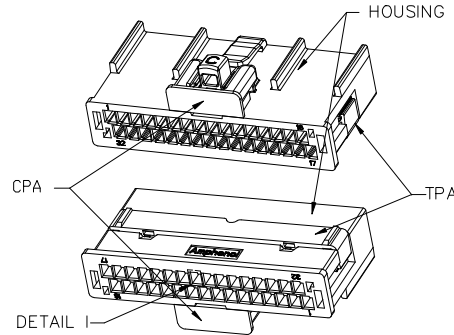
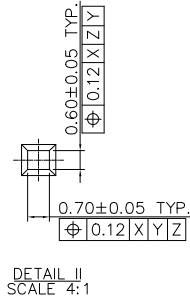
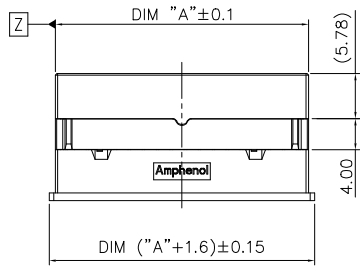
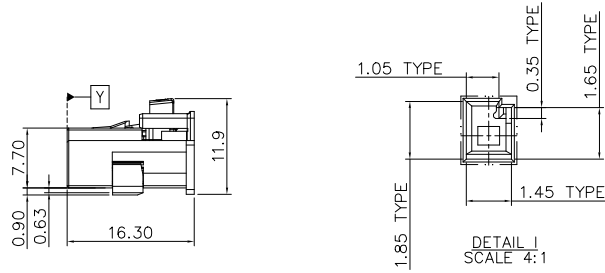
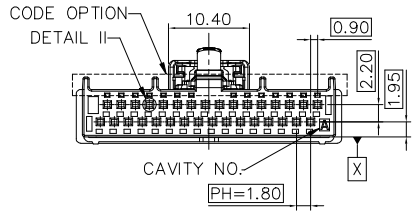

10159549-132XALF

POS.	PART NO.	DIM "A"	POS.	PART NO.	DIM "A"	POS.	PART NO.	DIM "A"
20	10159549-120XALF	21.70	28	10159549-128XALF	28.90	36	10159549-136XALF	36.10
	10159549-120XBLF			10159549-128XBLF			10159549-136XBLF	
	10159549-120XCFL			10159549-128KCLF			10159549-136XCFL	
	10159549-120XDLF			10159549-128KDLF			10159549-136XDLF	
22	10159549-122XALF	23.50	30	10159549-130XALF	30.70	38	10159549-138XALF	37.90
	10159549-122XBLF			10159549-130XBLF			10159549-138XBLF	
	10159549-122XCFL			10159549-130XCFL			10159549-138XCFL	
	10159549-122XDLF			10159549-130XDLF			10159549-138XDLF	
24	10159549-124XALF	25.30	32	10159549-132XALF	32.50	40	10159549-140XALF	39.70
	10159549-124XBLF			10159549-132XBLF			10159549-140XBLF	
	10159549-124XCFL			10159549-132XCFL			10159549-140XCFL	
	10159549-124XDLF			10159549-132XDLF			10159549-140XDLF	
26	10159549-126XALF	27.10	34	10159549-134XALF	34.30	REMARK, THIS SHEET SHOWS 20Pos. TO 40Pos.		
	10159549-126XBLF			10159549-134XBLF				
	10159549-126XCFL			10159549-134XCFL				
	10159549-126XDLF			10159549-134XDLF				

NOTES:

- 1 - MATERIAL: THERMOPLASTIC UL94V-0
COLOR: FOUR COLORS, DETAIL SEE TABLE
- 2 - PACKAGING SPEC: GS-14-2668
- 3 - PART NUMBER CODE: 10159549-1 XX X X LF

NUMBER OF POSITIONS
 20 - 20 PINS
 22 - 22 PINS

 40 - 40 PINS

RoHS COMPATIBLE
 CODE OPTION + COLOR
 A - A CODE
 B - B CODE
 C - C CODE
 D - D CODE
 PACKAGING
 K - TRAY PACKAGE
 T - PE BAG PACKAGE

<p>A CODE / COLOR: BLACK</p>	<p>B CODE / COLOR: GREEN; COLOR CODE: RAL6002</p>
<p>C CODE / COLOR: WHITE; COLOR CODE: RAL9001</p>	<p>D CODE / COLOR: BORDEAUX; COLOR CODE: RAL4004</p>
<p>REMARK, THIS SHEET SHOWS 20Pos. TO 40Pos.</p>	

mat'l. code	surface ISO 1302	tolerance ISO 406/ISO 1101	projection mm	product family HPL649
ltr	ecn no	dr	date	title
A	NEW DRAWING RELEASE	DW	10/23/20	RECEPTACLE KITS, DUAL ROW, WITH CPA
B	ELX-N-40676	DW	4/13/2021	WireLock® Series Cable Kits
<p>tolerances unless otherwise specified</p> <p>angles 0±2'</p> <p>linear .0±.3 .00±.15 .000±.010</p> <p>scale 1:1</p>				<p>sheet 1 of 3</p> <p>size A4</p>
<p>Amphenol FCI</p>				<p>10159549</p>
<p>type Product Customer Drawing</p>				
sheet index	revision sheet	B	1~3	

PART NUMBER (FROM 14Pos. TO 18Pos.)

10159549-114XXLF ~ 10159549-118XXLF

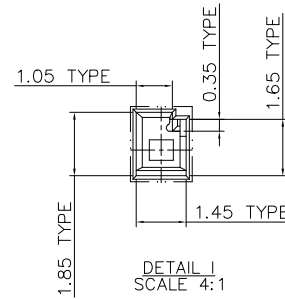
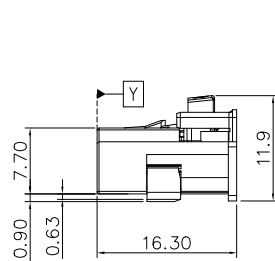
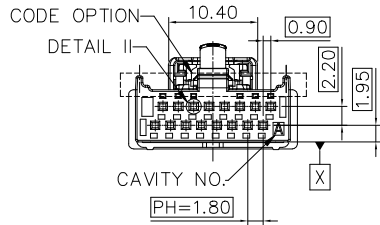

POS.	PART NO.	DIM "A"	POS.	PART NO.	DIM "A"
14	10159549-114XALF	16.30	18	10159549-118XALF	19.90
	10159549-114XBLF			10159549-118XBLF	
	10159549-114XCFL			10159549-118XCFL	
	10159549-114XDLF			10159549-118XDLF	
16	10159549-116XALF	18.10	REMARK, THIS SHEET SHOWS 14Pos. TO 18Pos.		
	10159549-116XBLF				
	10159549-116XCFL				
	10159549-116XDLF				

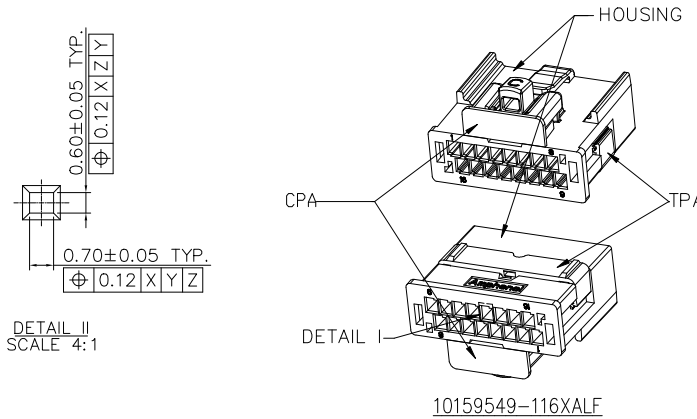
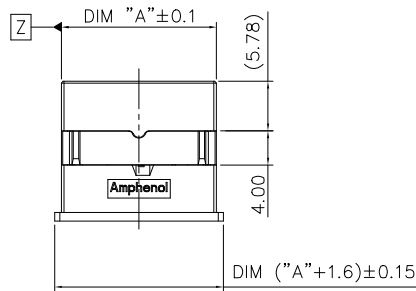

NOTES:

- 1 - MATERIAL: THERMOPLASTIC UL94V-0
COLOR: FOUR COLORS, DETAIL SEE TABLE
- 2 - PACKAGING SPEC: GS-14-2668
- 3 - PART NUMBER CODE: 10159549-1 XX X X LF

NUMBER OF POSITIONS
14 - 14 PINS
18 - 18 PINS

RoHS COMPATABLE
CODE OPTION + COLOR
A - A CODE
B - B CODE
C - C CODE
D - D CODE
PACKAGING
K - TRAY PACKAGE
T - PE BAG PACKAGE

<p>A CODE / COLOR: BLACK</p>	<p>B CODE / COLOR: GREEN; COLOR CODE: RAL6002</p>
<p>C CODE / COLOR: WHITE; COLOR CODE: RAL9001</p>	<p>D CODE / COLOR: BORDEAUX; COLOR CODE: RAL4004</p>
<p>REMARK, THIS SHEET SHOWS 14Pos. TO 18Pos.</p>	

mat'l. code				surface	tolerance	projection	product family
				ISO 1302	ISO 406/ISO 1101		HPL649
ltr	ecn	no	dr	tolerances unless otherwise specified		mm	title
B				angles	.0±.3	← mm →	RECEPTACLE KITS, DUAL ROW, WITH CPA
				linear	.00±.15	scale 1:1	WireLock® Series Cable Kits
				0±2'	.000±.010		dwg no
				dr	NICK ZHANG	10/23/20	sheet 2 of 3
				eng	NICK ZHANG	10/23/20	size
				chr	ZK HU	10/23/20	A4
				app	TIM YAO	10/23/20	10159549
							type Product Customer Drawing
sheet index	revision	B					
	sheet	1~3					

PART NUMBER (FROM 10Pos. TO 12Pos.)

10159549-110XXLF ~ 10159549-112XXLF

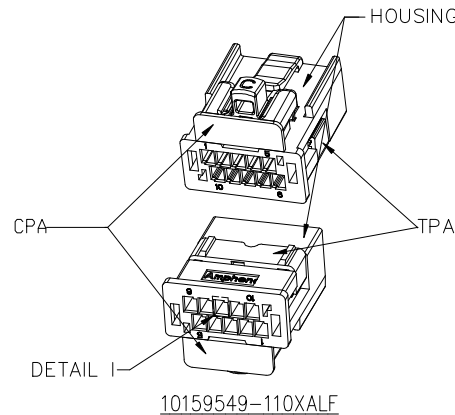
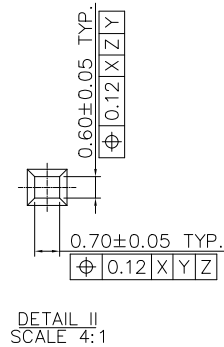
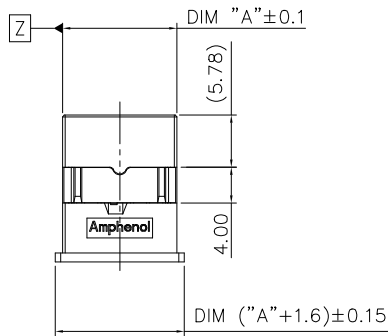
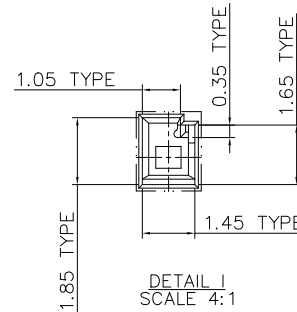
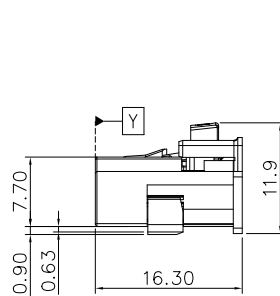
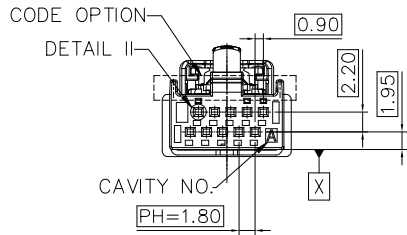

POS.	A CODE / COLOR: BLACK
10	
12	
REMARK, THIS SHEET SHOWS 10Pos. TO 12Pos. NO B/C/D CODE TO PROVIDE.	

POS.	PART NO.	DIM "A"	POS.	PART NO.	DIM "A"
10	10159549-110XALF	12.70	12	10159549-112XALF	14.50
REMARK, THIS SHEET SHOWS 10Pos. TO 12Pos.					

NOTES:

- 1 - MATERIAL: THERMOPLASTIC UL94V-0
COLOR: FOUR COLORS, DETAIL SEE TABLE
- 2 - PACKAGING SPEC: GS-14-2668
- 3 - PART NUMBER CODE: 10159549-1 XX X X LF

NUMBER OF POSITIONS
10 - 10 PINS
12 - 12 PINS

RoHS COMPATIBLE
CODE OPTION + COLOR
A - A CODE
(NO B/C/D CODE TO PROVIDE.)

PACKAGING
K - TRAY PACKAGE
T - PE BAG PACKAGE

mat'l. code				surface	tolerance	projection	product family	
ltr				ISO 1302	ISO 406/ISO 1101		HPL649	
ecn no				tolerances unless otherwise specified	mm	title		
dr				angles	linear	RECEPTACLE KITS, DUAL ROW, WITH CPA		
date				0°±2'	mm	WireLock® Series Cable Kits		
dr				NICK ZHANG	10/23/20	scale 1:1	dwg no	
engr				NICK ZHANG	10/23/20	Amphenol FCI	sheet 3 of 3	
chr				ZK HU	10/23/20		size	
appd				TIM YAO	10/23/20	10159549		A4
sheet index				revision B	type		Product Customer Drawing	
sheet				1~3				