

ISS.	AMEND	DATE
1	ISSUED	21/01/21

DUAL MOUNT  
CAN BE FRONT OR REAR MOUNTED

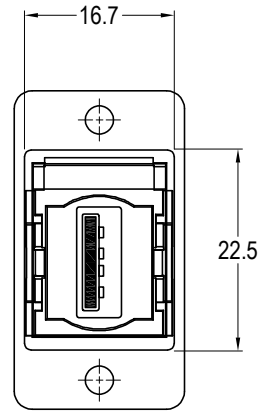
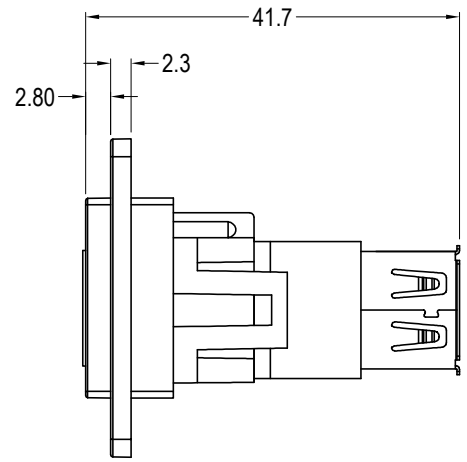
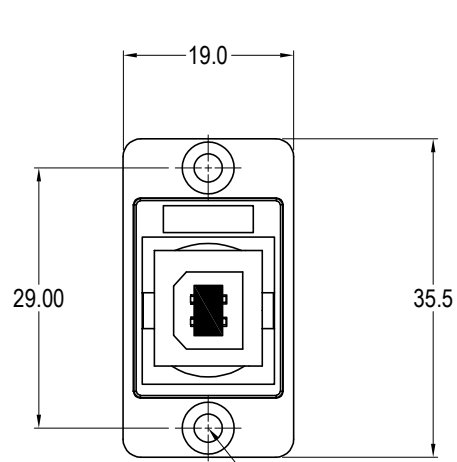
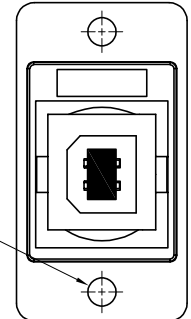
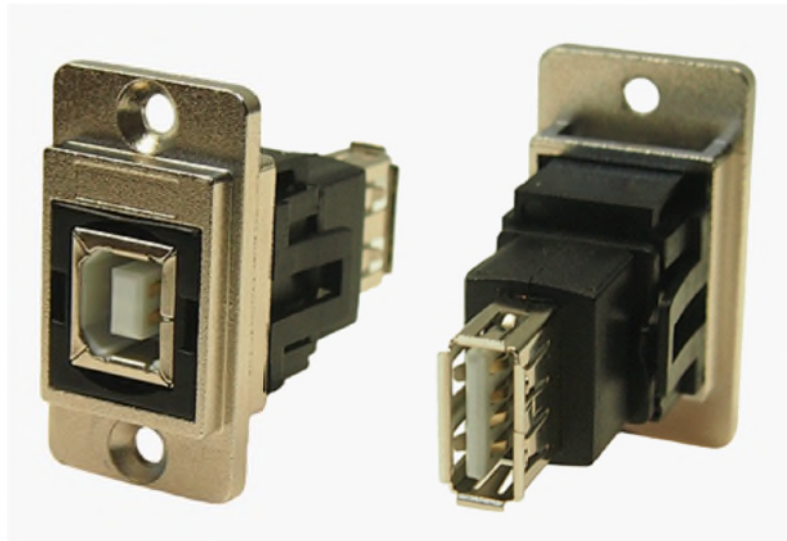
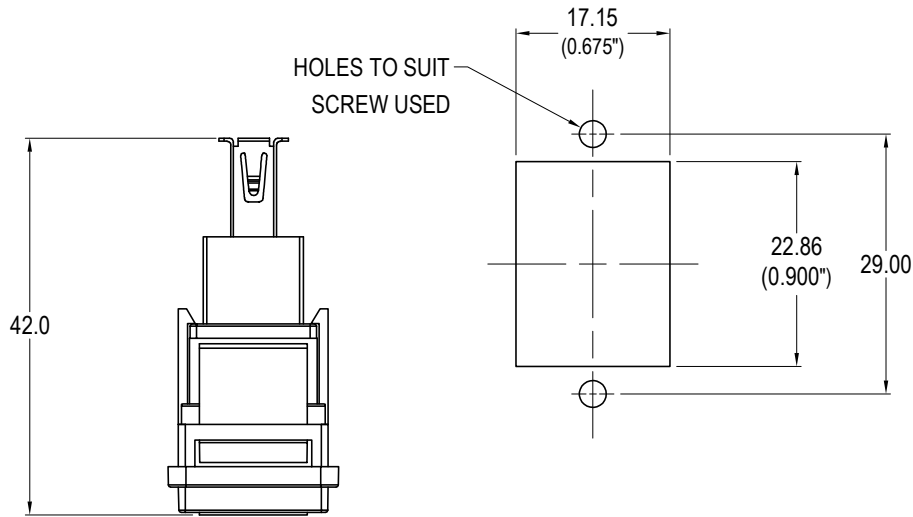

VARIANTS	
PART NO.	HOLE DETAILS
CP30707NM	HOLE Ø3.2 x CSK 90° x Ø5.85
CP30707NM3	M3 HOLES
CP30707NM440	#4-40 UNC HOLES
CP30707NMX1	PLAIN HOLE Ø3.2

4x HOLE VARIANTS  
Ø3.2mm CSK 90° x Ø5.85  
M3 x 0.5 THREAD  
#4-40 UNC THREAD  
PLAIN Ø3.2 HOLES

Specification:

1. Voltage rating: 30V AC
2. Current rating: 1.5A max
3. Contact resistance: 50mΩ max
4. Insulation resistance: 20MΩ min
5. Dielectric withstanding voltage: 500V AC
6. Operating Temperature: -20°C to 50°C

Material:

1. Insert: ABS UL94 HB
2. FT Frame: Diecast, Nickel plated
3. Inner Overmouldings: PE + PVC
4. Shell: Nickel plated steel
5. Contacts: Gold Plated

**RoHS**  
✓ COMPLIANT

TOLERANCE  
NO DEC. PLACE ±  
1 DEC. PLACE ±  
2 DEC. PLACE ±  
HOLE Ø ±  
ANGLES ±  
UNLESS OTHERWISE STATED