

PANEL THICKNESS
.062-.125
[1,58-3,17]

For mating dimensions
see MIL-DTL-38999 Series III

Reference MIL-STD-1560
for insert arrangement details.

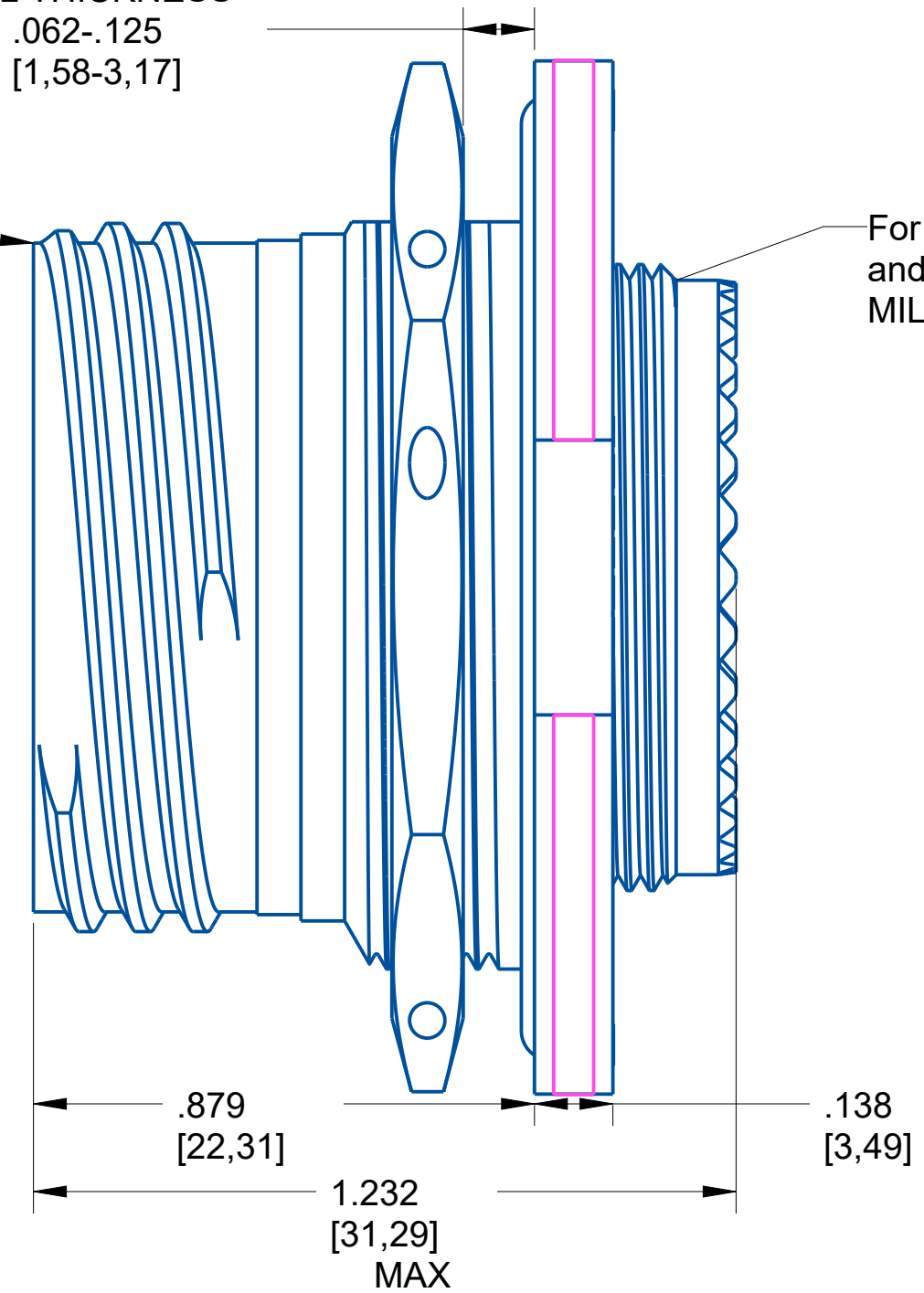

For rear shell features
and accessories see
MIL-DTL-38999 Series III

NOTE:

- DRAWING NOT TO SCALE
- DIMENSIONS SUBJECT TO CHANGE
- DIMENSIONS ARE IN INCHES [MM]

PROPERTY OF AMPHENOL AEROSPACE. ALL RIGHTS RESERVED.

Meets requirements
of MIL-DTL-38999
Base Material: Aluminum
Plating: Olive Drab Cadmium

AMPHENOL CORPORATION

40-60 DELAWARE AVENUE
SIDNEY, N.Y. 13638

RECEPTACLE
Electrical Connector
D38999/24

U

SIZE	CAGE CODE	CODED NUMBER	REV
C	77820	D38999/24WF35PN	P1

SHEET 1 OF 1

Insert Arrangement

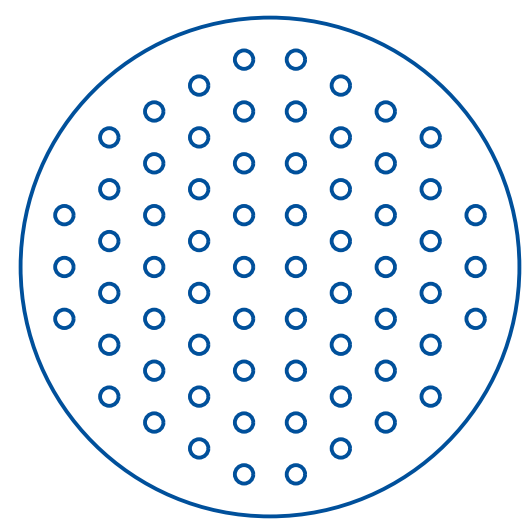

No. of Contacts	66
Contact Size	22D
Wire Size	28, 26, 24, 22

Shell Size	F
Arrangement	35
Service Rating	M
Test Current	5 AMPS

NOTE:
-DRAWING NOT TO SCALE
-DIMENSIONS SUBJECT TO CHANGE
-DIMENSIONS ARE IN INCHES [MM]

PROPERTY OF AMPHENOL AEROSPACE. ALL RIGHTS RESERVED.

AMPHENOL CORPORATION <small>40-60 DELAWARE AVENUE SIDNEY, N.Y. 13638</small>			
RECEPTACLE Electrical Connector D38999/24			U
SIZE C	CAGE CODE 77820	CODED NUMBER D38999/24WF35PN	REV P1
SHEET 1 OF 1			