

REVISIONS			
REV	DESCRIPTION, ECN, EAR NO.	DATE	APP'D
A	DRAWING PER EAR XXXX	TBD	TBD

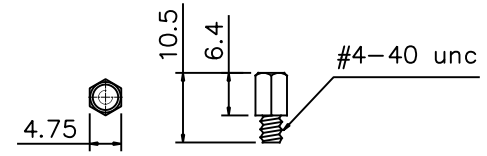

#4-40 unc screwlock installed

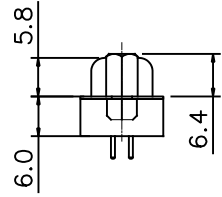
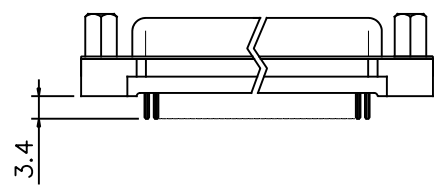
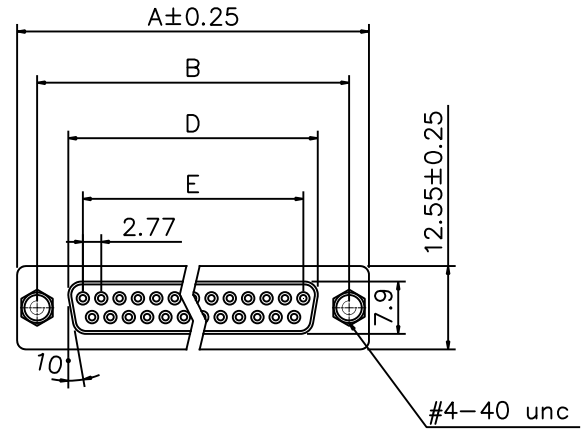
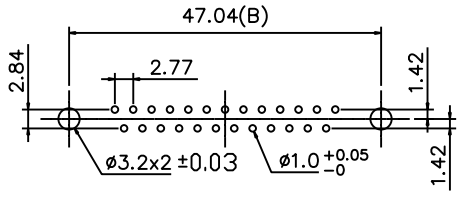

Recommended PCB Layout

Product Specification

Material

Insulator : See ordering info for colour type
 Contact : Copper alloy
 Shell : Steel, 80u" Tin Over 50u" min Copper
 Clinch Nut: Brass, 50u" min Nickel Plated.
 Screwlock :Steel, 50u" min Nickel Plated.

Electrical

Contact Resistance :20 milliohms
 Max at 1 AMP DC.
 Insulation Resistance :1000
 magohms at 500 VDC
 Dielectric Withstanding Voltage :
 1000 VAC/rms 60Hz for 1 minute
 Current Rating :3 AMP
 Volatge Rating :250 VAC/rms 60Hz

ORDERING CODE: NFD17-EXXSA-FE1C-A

NUMBER OF CONTACTS:

- 09: 09 POSITION
- 15: 15 POSITION
- 25: 25 POSITION
- 37: 37 POSITION

Dimensions

Positions	A	B	D	E
9	30.81	24.99	16.33	11.08
15	39.20	33.30	24.70	19.39
25	53.05	47.04	38.40	33.24
37	69.40	63.50	54.80	49.86

UNLESS SPECIFIED OTHERWISE	DRAWN ED.LIU	JUL22/22
PRIMARY UNITS MILLIMETERS	CHECKED TBD	TBD
SECONDARY	M.E. APP'D	
REFERENCE IN PARENTHESES	Q.A. APP'D	
GENERAL TOLERANCES	DWG APP'D TBD	TBD
1 DECIMAL PLACE ±0.38	ENG. REL. NO. EAR XXXX	
2 DECIMAL PLACES ±0.25	REF.	
3 DECIMAL PLACES	THIRD ANGLE PROJECTION	DO NOT SCALE DRAWING
ANGULAR DEGREES ±2°		

Amphenol Canada Corp. Commercial Products	
NFD17 SERIES FEMALE D-SUB CONNECTOR, RoHS COMPLIANT	
DWG NO.	P-NFD17-EXXSA-FE1C-A A
CODE ID NO. 03554	DWG SIZE X SCALE XX:1 SHEET 1 OF 1