

NOTES:

1. MATERIALS:
 CONTACT: BERYLLIUM COPPER
 ALL OTHER METAL PARTS: STAINLESS STEEL
 INSULATOR: ULTEM1000
2. FINISH:
 CONTACT: GOLD
 ALL OTHER METAL PARTS: PASSIVATED
3. MECHANICAL/ENVIRONMENTAL:
 DURABILITY: 500 CYCLES
 TEMP RANGE: -65°C to +165°C
4. ELECTRICAL:
 IMPEDANCE: 50Ω
 FREQUENCY RANGE: DC to 67GHz
 VSWR(dB): 1.2: 1(-20.8dB)

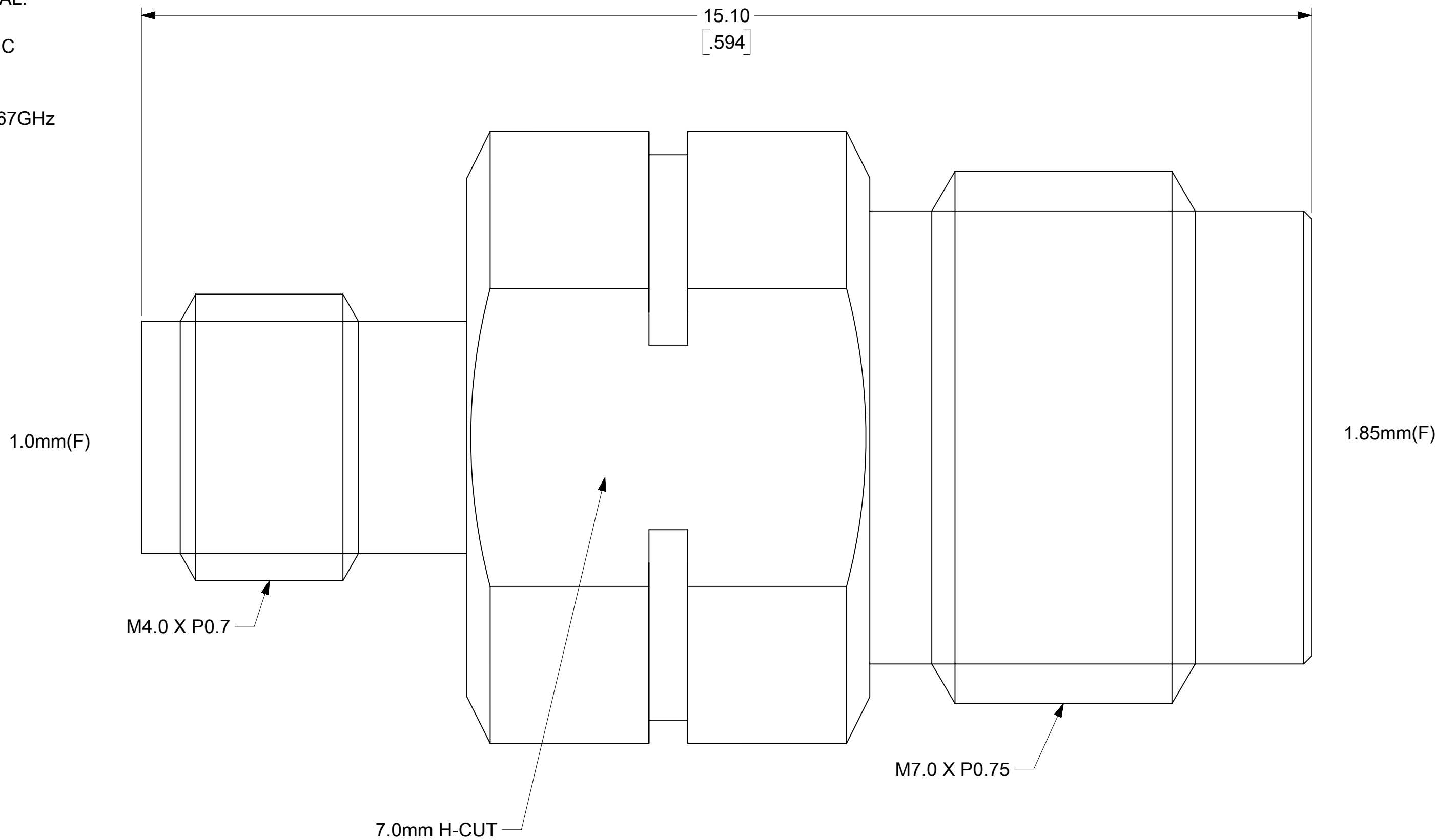

FUNCTIONAL SYMBOLS $\frac{F}{A} = 0$ $\frac{F}{C} = 0$ $\frac{F}{P} = 0$ DIVISIONAL SYMBOLS	THIS DRAWING CONTAINS INFORMATION THAT IS PROPRIETARY TO MOLEX ELECTRONIC TECHNOLOGIES, LLC AND SHOULD NOT BE USED WITHOUT WRITTEN PERMISSION											
	DIMENSION UNITS		SCALE		CURRENT REV DESC: UPDATED TO GENERAL MARKET							
	MM/INCH		NTS									
	GENERAL TOLERANCES (UNLESS SPECIFIED)										EC NO: 735515 DRWN: KTAGAN 2023/01/18 CHK'D: LMEIER 2023/01/18 APPR: JBORRELLI 2023/01/19	
			MM	INCH								
	4 PLACES		±	±								
	3 PLACES		±	±								
	2 PLACES		±	±								
	1 PLACE		±	±	INITIAL REVISION:							
	0 PLACES		±	±	DRWN: VISHNM2 2022/11/22		2022/12/15		DOCUMENT NUMBER		DOC TYPE	DOC PART
ANGULAR TOL		±	°	DRWN: LMEIER				733862240		PSD	000	A1
DRAFT WHERE APPLICABLE MUST REMAIN WITHIN DIMENSIONS				THIRD ANGLE PROJECTION		DRAWING	SERIES	MATERIAL NUMBER	CUSTOMER	SHEET NUMBER		
						C-SIZE	73386	733862240		1 OF 1		

DOCUMENT STATUS	P1	RELEASE DATE	2023/01/19	15:05:57
-----------------	----	--------------	------------	----------