

This document is the property of Amphenol Corporation and is delivered on a non-exclusive basis. It is to be used for the specific application for which it was prepared. It is not to be used for any other application without the prior consent, in writing, of Amphenol Corporation. It is to be used only in accordance with the terms and conditions set forth in this document.

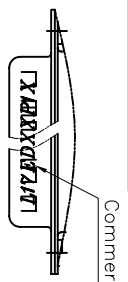

Commercial code

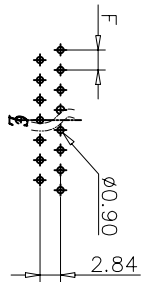
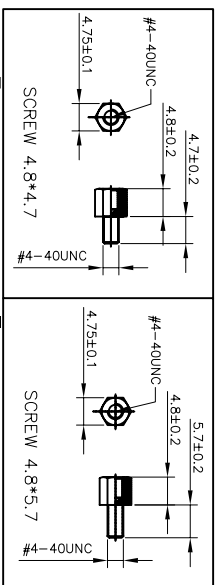
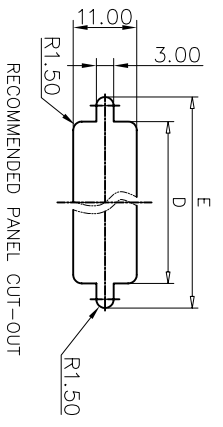
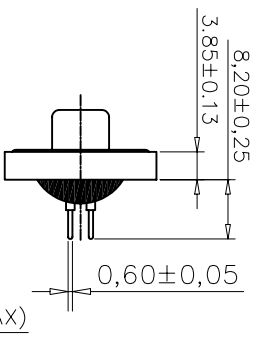
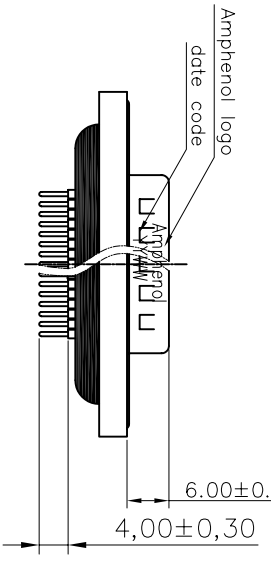
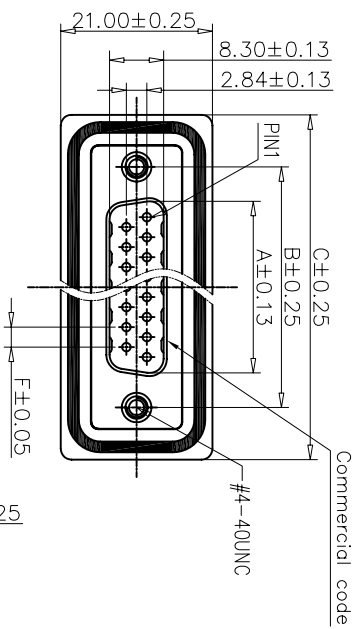

RECOMMENDED P.C.B LAYOUT
GENERAL TOLERANCE:±0.05mm

Customer drawing

POSITION	A	B	C	D	E	F(PITCH)
9	16.92	24.99	39.40	20.00	28.20	2.77
15	25.30	33.32	47.70	28.00	36.50	2.77
25	38.96	47.04	64.50	41.50	51.00	2.77
37	55.42	63.50	80.78	57.80	67.30	2.77

REVISONS				
S/N	EN	DESCRIPTION	DATE	APPROVED
1		New release	03/11/11	IP

D-SUB TECHNICAL DATA

SHELL : Steel, 1.25um(50u") min nickel
BODY : Glass filled thermoplastic.
 flame retardant to UL94 V-0 color Black
PLATE : Glass filled thermoplastic.
 flame retardant to UL94 V-0 color Black
CONTACTS : Brass, gold over 50u" min nickel(According to the P/N)
SCREWLOCK : Brass, 50u" min nickel
REAR INSERT : Brass, 50u" min nickel
O RING : Silicone Color: Blue
EPOXY : Color: Black
ELECTRICAL : Voltage rating : 300 V RMS at 50 Hz
 Current rating : 5A
 Insulation resistance >5000 M Ohms
 Contact resistance 20mOhms max.

MARKING : Amphenol logo
 Commercial code
 Manufacturing date(YYWW)

NOTE : Screw L=4.7 For Panel Thickness Under X=1.2mm
 Screw L=5.7 For Panel Thickness Between X=1.2~2.0mm



PRODUCT CODE

L17ED XX P 1 X

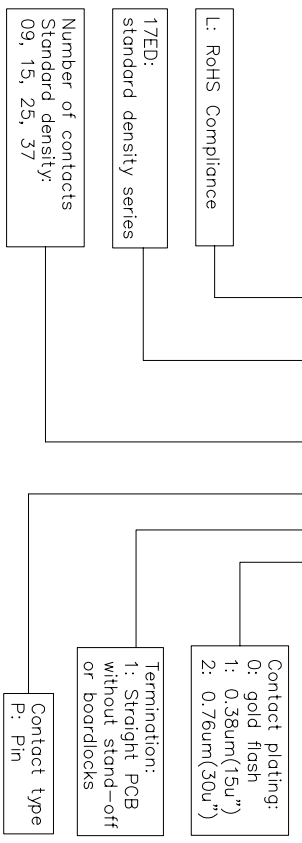

UNLESS OTHERWISE SPECIFIED		APPROVAL	DATE
TOLERANCES	AS SHOWN	DRAWN	09/09/11
FRACTIONS	1/16	CHECKED	09/09/11
DECIMALS	0.10		
ANGLES	1/16		
FOR MATERIALS AND FINISHES	SEE NOTES		
REMOVE SHARP EDGES			
DIMENSIONS			
TOLERANCES			
FINISH			
ANGLE OF PROJECTION			
SIZE	A4	SIZE	A4
DRAWING NO.	C L17EDXXP1X	REV.	1
SCALE	NONE	SHEET	1 OF 1
Amphenol Amphenol East Asia Limited			